

**KEY NOTES**

1. PROVIDE ONE OUTLET AT DOOR HEAD HEIGHT FOR SUB METER TRANSMITTERS, ACCESS CONTROL HARDWARE, AND ADDITIONAL MODEM OR TELECOM EQUIPMENT. COORDINATE EXACT EQUIPMENT REQUIREMENTS WITH OWNER PRIOR TO ROUGH-IN.

2. PROVIDE CARD READER/KEYPAD J-BOX AT LOCATION INDICATED WITH 3/4" CONDUIT TO TOP OF DOOR JAM. PROVIDE 3/4" CONDUIT FROM DOOR JAM J-BOX TO CONCEALED JUNCTION BOX ADJACENT TO STRIKE PLATE. ROUTE 1" CONDUIT TO ELEC/DATA ROOM DETERMINED BY OWNER. PROVIDE FIRE ALARM RELAY CONTROL AT SECURE DOOR CONTROLS SO THAT UPON FIRE ALARM OR POWER FAILURE DOOR DEFAULTS TO UNLOCKED OPEN POSITION. COORDINATE EXACT DOOR REQUIREMENTS WITH SECURITY VENDOR CONSULTANT.

**GENERAL NOTES (THIS SHEET ONLY)**

- INDICATES HVAC EQUIPMENT. SEE E8-01 FOR MECHANICAL EQUIPMENT CONNECTION SCHEDULE.
- DO NOT INSTALL DEVICES BACK TO BACK IN ANY FIRE RATED WALL. PROVIDE MINIMUM 24" HORIZONTAL SPACE BETWEEN SUCH OUTLETS.
- SEAL ALL PENETRATIONS IN EVERY FIRE RATED WALL AND FLOOR PER UL TO MAINTAIN THE WALL AND FLOOR ORIGINAL RATING.
- FINAL LIGHTING LOCATIONS AND SELECTIONS TO BE DETERMINED BY ARCHITECT/INTERIOR DESIGNER.
- PROVIDE #10 CONDUCTORS FOR ANY 120V CIRCUIT OVER 100'. PROVIDE #8 CONDUCTOR FOR ANY CIRCUIT OVER 150'.
- PROVIDE CONNECTION TO FIRE ALARM CONTROL PANEL FROM ALL FIRE ALARM DEVICES.
- TYPE N.M. WIRING FOR BRANCH CIRCUIT WIRING FOR TYPE III, IV AND V CONSTRUCTION IF ACCEPTABLE TO LOCAL AUTHORITY HAVING JURISDICTION. PROVIDE N.E. CABLE OR WIRE/EXIT CONDUIT FOR BRANCH CIRCUITS IN ALL OTHER CONSTRUCTION TYPES AND IN RETURN AIR PLENUM ROOMS OR SPACES.
- COORDINATE LOCATION AND QUANTITY OF FIRE/SMOKE AND/OR SMOKE DAMPERS WITH MECHANICAL CONTRACTOR PRIOR TO BID. COORDINATION OF LOCATIONS AND QUANTITIES WILL OVERRIDE LOCATIONS AND QUANTITIES INDICATED ON ELECTRICAL DRAWINGS. PROVIDE A 120V UNWITCHED CIRCUIT TO EACH FIRE/SMOKE DAMPER AND/OR SMOKE DAMPER. PROVIDE A DUCT MOUNTED SMOKE DETECTOR IN FIRE/SMOKE DAMPER SHORT CONNECT DUCT MOUNTED SMOKE DETECTOR AND FIRE/SMOKE AND/OR SMOKE DAMPER TO FIRE ALARM SYSTEM. A CHANGE ORDER WILL NOT BE ALLOWED FOR LACK OF COORDINATION BETWEEN THE ELECTRICAL AND MECHANICAL CONTRACTOR FOR LOCATION AND QUANTITY OF FIRE/SMOKE DAMPER AND/OR SMOKE DAMPERS.
- ALL CEILING MOUNTED CORRIDOR LIGHTING FIXTURES ARE TYPE 'A'.
- ALL UNIT ENTRY WALL SCONCE LIGHTING FIXTURES ARE TYPE 'B'.
- ALL STRIP FIXTURES ARE TYPE 'C/CE'.
- ALL STARWELL FIXTURES ARE TYPE 'DE'.
- ALL EMERGENCY LIGHTING FIXTURES ARE TYPE 'EM'.
- ALL EXIT SIGNS ARE TYPE 'EX'.

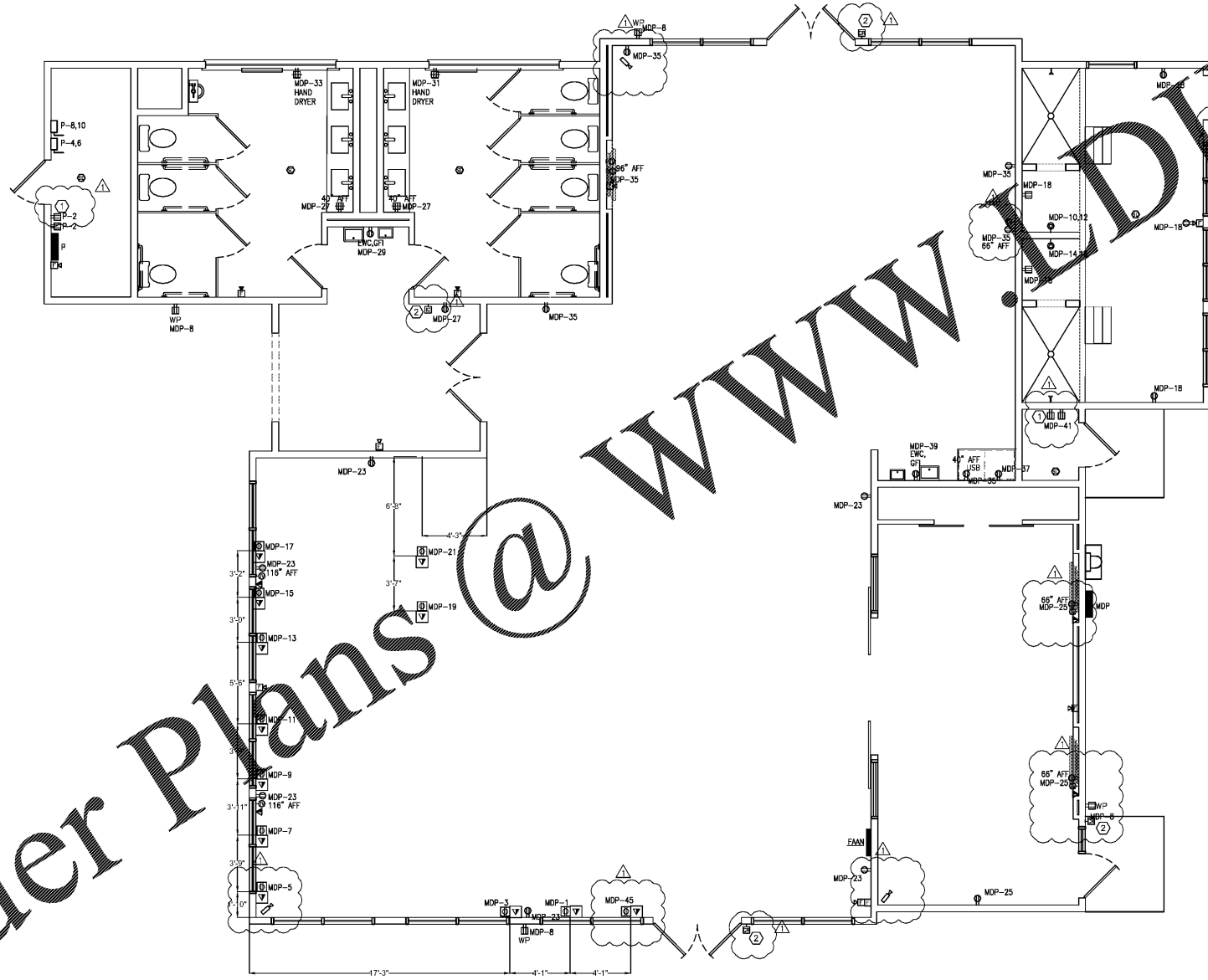

1 Fitness Power Plan - Electrical  
Scale: 1/4" = 1'-0"

Order Plans @

Seal

03-19-2021

**ZPA**

**POOLE & POOLE ARCHITECTURE**

3736 Winterfield Road, Suite 102  
Midlothian, Virginia 23113  
Telephone 804.275.0215  
www.zpa.net

Project: 1928  
CADD File:  
Drawn By: SW  
Checked By: WM

Permit Release:  
May 15, 2020  
Construction Release Set:  
May 15, 2020

Revisions

No.	Date	Description
1	03/19/21	Owner Comments

ASI / RFI Revisions

No.	Date	Description
-----	------	-------------

© 2019 Poole & Poole Architecture, LLC  
Design and specifications are the sole property of Poole & Poole Architecture, LLC and shall not be used for any other project without the written consent of Poole & Poole Architecture, LLC.

**POOLE & POOLE ARCHITECTURE, P.C.**

1010 N. BROADWAY  
SUITE 300  
CHAFFANOOGA, TN 37628

POOLE & POOLE ARCHITECTURE, P.C. IS AN EQUAL OPPORTUNITY AFFIRMATIVE ACTION EMPLOYER. MINORITY AND FEMALE OWNERSHIP AND PARTICIPATION ARE ENCOURAGED. POOLE & POOLE ARCHITECTURE, P.C. IS AN EQUAL OPPORTUNITY AFFIRMATIVE ACTION EMPLOYER. MINORITY AND FEMALE OWNERSHIP AND PARTICIPATION ARE ENCOURAGED. POOLE & POOLE ARCHITECTURE, P.C. IS AN EQUAL OPPORTUNITY AFFIRMATIVE ACTION EMPLOYER. MINORITY AND FEMALE OWNERSHIP AND PARTICIPATION ARE ENCOURAGED.

**Borough 33**  
an Apartment Community by  
33 Broad MF, LLC  
in Chattanooga, Tennessee



Drawing Title:  
Fitness Power Plan - Electrical

**E6.5**

REVISIONS: 03/19/21