

ZPA
POOLE & POOLE ARCHITECTURE
 3736 Winterfield Road, Suite 102
 Midlothian, Virginia 23113
 Telephone 804.275.0215
 www.zpa.net

Project: 1928
 CADD File:
 Drawn By: SW
 Checked By: WM

Permit Release:
 May 15, 2020
 Construction Release Set:
 May 15, 2020

Revisions
 No. Date Description
 1 03/19/21 Owner Comments

ASI / RFI Revisions
 No. Date Description

© 2019 Poole & Poole Architecture, LLC
 Drawing and specifications are the property of Poole & Poole Architecture, LLC and shall not be used or reproduced without the written consent of Poole & Poole Architecture, LLC.



Borough 33
 an Apartment Community by
 33 Broad MF, LLC
 in Chattanooga, Tennessee



Drawing Title:
 Building 3
 Building Plans - Electrical

E2.3b

- GENERAL NOTES (THIS SHEET ONLY)**
1. (E) INDICATES HVAC EQUIPMENT. SEE E8-01 FOR MECHANICAL EQUIPMENT CONNECTION SCHEDULE.
 2. DO NOT INSTALL DEVICES BACK TO BACK IN ANY FIRE RATED WALL. PROVIDE MINIMUM 24" HORIZONTAL SPACE BETWEEN SUCH OUTLETS
 3. SEAL ALL PENETRATIONS IN EVERY FIRE RATED WALL AND FLOOR PER UL TO MAINTAIN THE WALL AND FLOOR ORIGINAL RATING
 4. FINAL LIGHTING LOCATIONS AND SELECTIONS TO BE DETERMINED BY ARCHITECT/INTERIOR DESIGNER
 5. PROVIDE #10 CONDUCTORS FOR ANY 120V CIRCUIT OVER 100'. PROVIDE #8 CONDUCTOR FOR ANY CIRCUIT OVER 150'
 6. PROVIDE CONNECTION TO FIRE ALARM CONTROL PANEL FROM ALL FIRE ALARM DEVICES
 7. TYPE N.M. WIRING FOR BRANCH CIRCUIT WIRING FOR TYPE III, IV AND V CONSTRUCTION IF ACCEPTABLE TO LOCAL AUTHORITY HAVING JURISDICTION. PROVIDE M.C. CABLE OR WIRE/EMT CONDUIT FOR BRANCH CIRCUITS IN ALL OTHER CONSTRUCTION TYPES AND IN RETURN AIR PLenum ROOMS OR SPACES.
 8. COORDINATE LOCATION AND QUANTITY OF FIRE/SMOKE AND/OR SMOKE DAMPERS WITH MECHANICAL CONTRACTOR PRIOR TO BID. COORDINATION OF LOCATIONS AND QUANTITIES WILL OVERRIDE LOCATIONS AND QUANTITIES INDICATED ON ELECTRICAL DRAWINGS. PROVIDE A 120V UNSWITCHED CIRCUIT TO EACH FIRE/SMOKE DAMPER AND/OR SMOKE DAMPER. PROVIDE A DUCT MOUNTED SMOKE DETECTOR IN FIRE/SMOKE DAMPER SHUNT. CONNECT DUCT MOUNTED SMOKE DETECTOR AND FIRE/SMOKE AND/OR SMOKE DAMPER TO FIRE ALARM SYSTEM. A CHANGE ORDER WILL NOT BE ALLOWED FOR LACK OF COORDINATION BETWEEN THE ELECTRICAL AND MECHANICAL CONTRACTOR FOR LOCATION AND QUANTITY OF FIRE/SMOKE DAMPER AND/OR SMOKE DAMPERS.
 9. SEE SHEETS E1.1 THRU E1.10 FOR TYPICAL UNIT PLANS.
 10. ALL CEILING MOUNTED CORRIDOR LIGHTING FIXTURES ARE TYPE 'X'.
 11. ALL UNIT ENTRY WALL SCONCE LIGHTING FIXTURES ARE TYPE 'Y'.
 12. ALL STRIP FIXTURES ARE TYPE 'C/C'.
 13. ALL STAIRWELL FIXTURES ARE TYPE 'D'.
 14. ALL EMERGENCY LIGHTING FIXTURES ARE TYPE 'EM'.
 15. ALL EXIT SIGNS ARE TYPE 'X'.

- KEY NOTES**
1. PROVIDE TWO-WAY COMMUNICATIONS SYSTEM. COORDINATE EXACT LOCATION AND SYSTEM REQUIREMENTS WITH FIRE DEPARTMENT AND MANUFACTURER PRIOR TO COMMENCEMENT OF WORK. INSTRUCTIONS FOR REQUESTING ASSISTANCE VIA THE TWO-WAY COMMUNICATION SYSTEM AND WRITTEN IDENTIFICATION OF THE LOCATIONS SHALL BE POSTED ADJACENT TO EACH BOX IN ELEVATOR LOBBIES.
 2. PROVIDE DEDICATED TELEPHONE LINE FOR ELEVATOR CABIN, TERMINATE AT CONTROLLER. COORDINATE LOCATION WITH FINAL ELEVATOR SHOP DRAWINGS PRIOR TO INSTALLATION.
 3. PROVIDE FUSIBLE DISCONNECT SWITCH 30/2/15AF FOR ELEVATOR CAB LIGHTS. PROVIDE AUXILIARY CONTACTS AS REQUIRED BY ELEVATOR INSTALLER.
 4. ELEVATOR CONTROLLER FUSIBLE DISCONNECT. PROVIDE 100/3/50AF DISCONNECT SWITCH FOR CONNECTION TO ELEVATOR CONTROLLER WITH 3/2(CU), #8(CU) @ 2". CONTRACTOR SHALL FIELD VERIFY EXACT SIZE AND REQUIREMENTS PRIOR TO ROUGH-IN. PROVIDE AUXILIARY CONTACTS AS REQUIRED BY ELEVATOR INSTALLER.
 5. COORDINATE LOCATION OF LIGHT FIXTURE, SWITCH AND RECEPTACLE WITH ELEVATOR VENDOR PRIOR TO INSTALLATION.
 6. MOUNT SMOKE AND HEAT DETECTOR IN TOP OF SHAFT. INTERFACE WITH FIRE ALARM SYSTEM, ELEVATOR CONTROLLER.
 7. ELEVATOR NON-FUSED SAFETY DISCONNECT SWITCH FED FROM FUSIBLE DISCONNECT SWITCH IN ELEVATOR CONTROL ROOM. PROVIDE A 100A/3P/NF DISCONNECT FOR CONNECTION TO ELEVATOR CONTROLLER. PROVIDE AUXILIARY CONTACTS AS REQUIRED BY ELEVATOR INSTALLER.
 8. ELEVATOR CONTROLLER. CONTRACTOR SHALL PROVIDE (3) RELAYS FOR ELEVATOR RECALL SYSTEM. RECALL SYSTEM SHALL PROVIDE PRIMARY RECALL, SECONDARY RECALL AND SHUNT TRIP FUNCTIONS. RECALL SHALL BE PROVIDED FOR EACH ELEVATOR SYSTEM. COORDINATE WITH ELEVATOR INSTALLER PRIOR TO ROUGH-IN.
 9. PROVIDE ONE OUTLET AT DOOR HEAD HEIGHT FOR SUB METER TRANSMITTERS, ACCESS CONTROL HARDWARE, AND ADDITIONAL MODEM OR TELECOM EQUIPMENT. COORDINATE EXACT EQUIPMENT REQUIREMENTS WITH OWNER PRIOR TO ROUGH-IN.

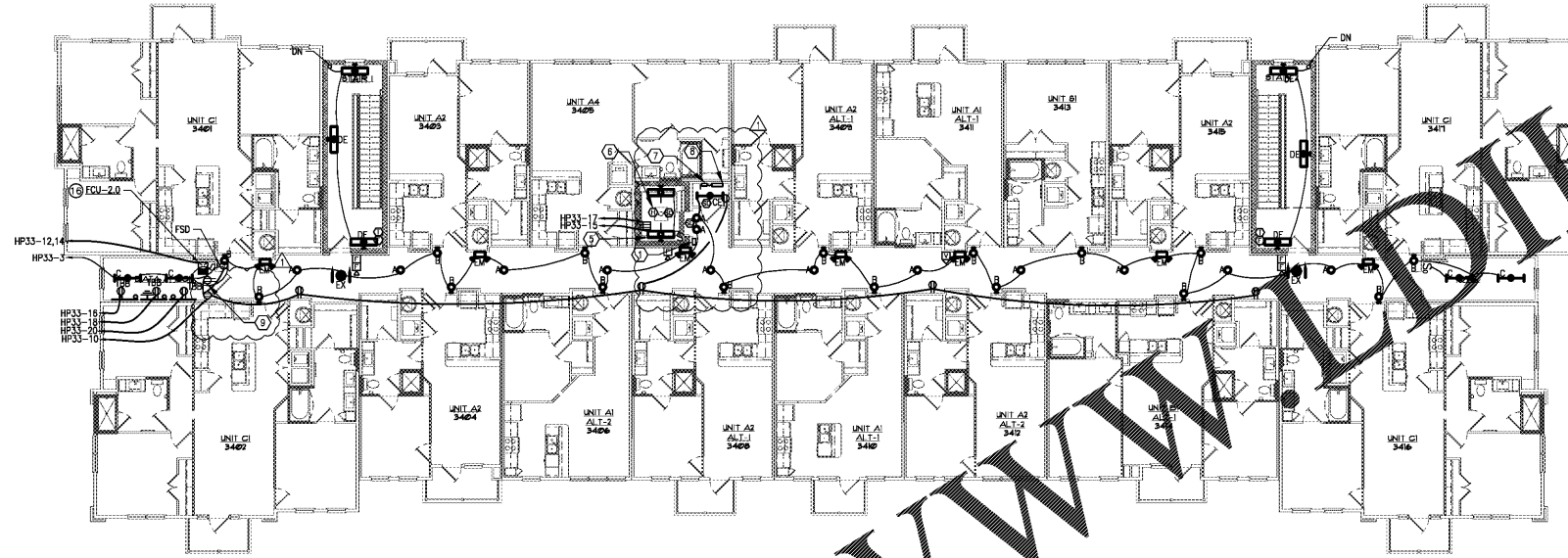

2 Building 3 - Fourth Level - Electrical
 Scale: 3/32" = 1'-0"
 Plan

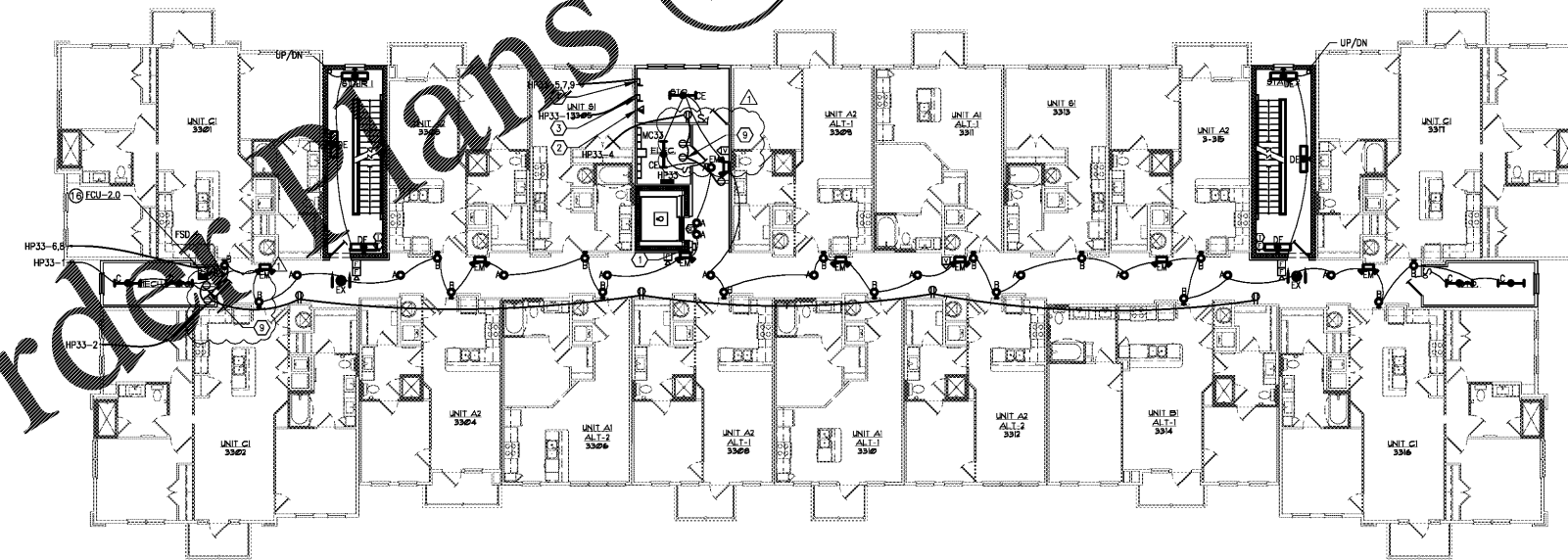

1 Building 3 - First Level - Electrical
 Scale: 3/32" = 1'-0"
 Plan

Order Plans @ www.dine.com