

Order Plans @ www.wpdll.com

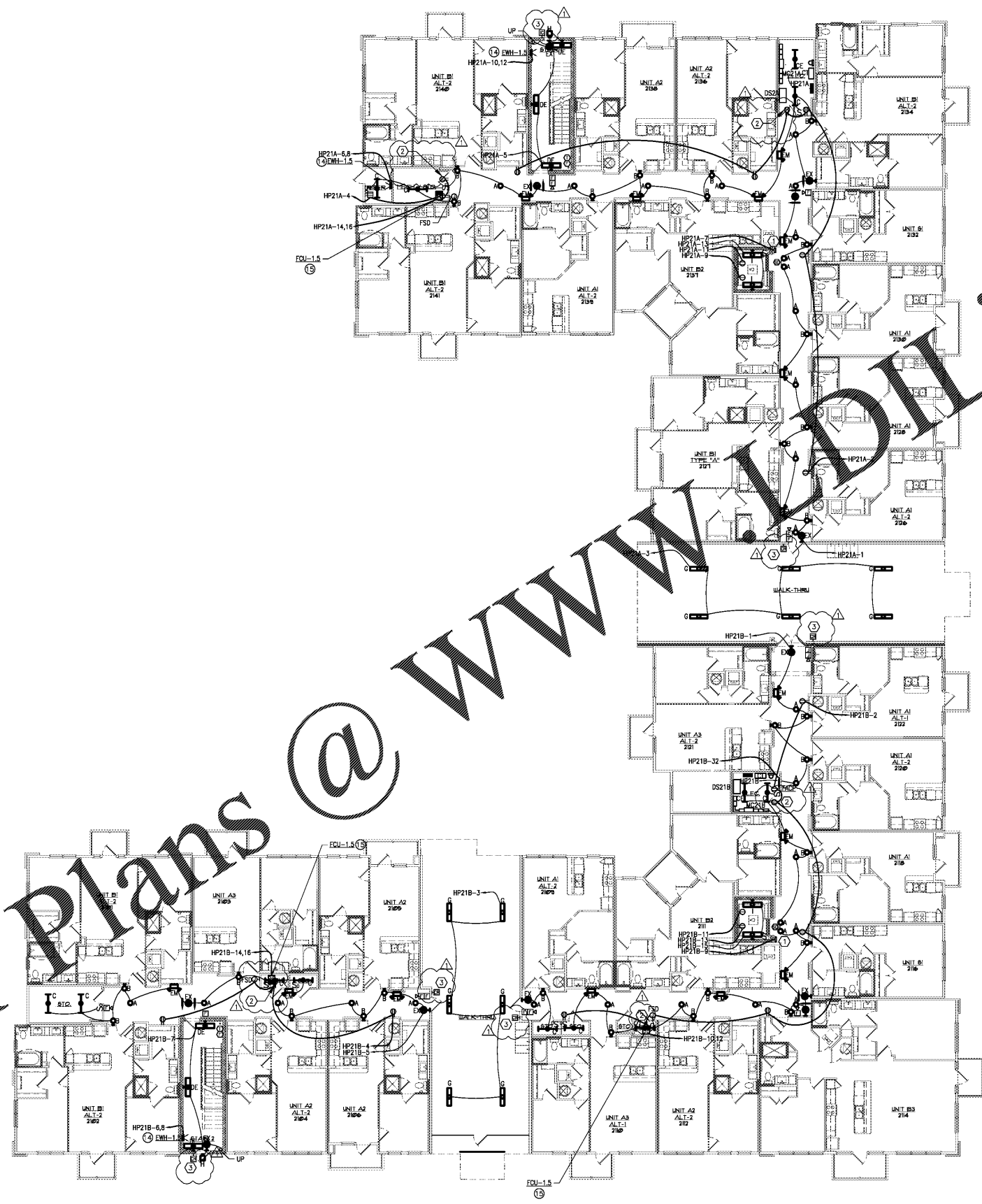

- GENERAL NOTES (THIS SHEET ONLY)**
- ① INDICATES HVAC EQUIPMENT. SEE E6-01 FOR MECHANICAL EQUIPMENT CONNECTION SCHEDULE.
 - DO NOT INSTALL DEVICES BACK TO BACK IN ANY FIRE RATED WALL. PROVIDE MINIMUM 24" HORIZONTAL SPACE BETWEEN SUCH OUTLETS
 - SEAL ALL PENETRATIONS IN EVERY FIRE RATED WALL AND FLOOR PER UL TO MAINTAIN THE WALL AND FLOOR ORIGINAL RATING
 - FINAL LIGHTING LOCATIONS AND SELECTIONS TO BE DETERMINED BY ARCHITECT/INTERIOR DESIGNER
 - PROVIDE #10 CONDUCTORS FOR ANY 120V CIRCUIT OVER 100'. PROVIDE #6 CONDUCTOR FOR ANY CIRCUIT OVER 150'
 - PROVIDE CONNECTION TO FIRE ALARM CONTROL PANEL FROM ALL FIRE ALARM DEVICES
 - TYPE NMB WIRING FOR BRANCH CIRCUIT WIRING FOR TYPE III, IV AND V CONSTRUCTION IF ACCEPTABLE TO LOCAL AUTHORITY HAVING JURISDICTION. PROVIDE I.C. CABLE OR MIBZ/DMT CONDUIT FOR BRANCH CIRCUITS IN ALL OTHER CONSTRUCTION TYPES AND IN RETURN AIR PLenums ROOMS OR SPACES.
 - COORDINATE LOCATION AND QUANTITY OF FIRE/SMOKE AND/OR SMOKE DAMPERS WITH MECHANICAL CONTRACTOR PRIOR TO BID. COORDINATION OF LOCATIONS AND QUANTITIES WILL OVERRIDE LOCATIONS AND QUANTITIES INDICATED ON ELECTRICAL DRAWINGS. PROVIDE A 120V UNWIRING CIRCUIT TO EACH FIRE/SMOKE DAMPER AND/OR SMOKE DAMPER. PROVIDE A DUCT MOUNTED SMOKE DETECTOR IN FIRE/SMOKE DAMPER SHAFT. CONNECT DUCT MOUNTED SMOKE DETECTOR AND FIRE/SMOKE AND/OR SMOKE DAMPER TO FIRE ALARM SYSTEM. A CHANGE ORDER WILL NOT BE ALLOWED FOR LACK OF COORDINATION BETWEEN THE ELECTRICAL AND MECHANICAL CONTRACTOR FOR LOCATION AND QUANTITY OF FIRE/SMOKE DAMPER AND/OR SMOKE DAMPERS.
 - SEE SHEETS E1.1 THRU E1.10 FOR TYPICAL UNIT PLANS.
 - ALL CEILING MOUNTED CORRIDOR LIGHTING FIXTURES ARE TYPE 'A'.
 - ALL UNIT ENTRY WALL SCONCE LIGHTING FIXTURES ARE TYPE 'B'.
 - ALL STRIP FIXTURES ARE TYPE 'C/CE'.
 - ALL STAIRWELL FIXTURES ARE TYPE 'DE'.
 - ALL EMERGENCY LIGHTING FIXTURES ARE TYPE 'EM'.
 - ALL EXIT SIGNS ARE TYPE 'X'.

- KEY NOTES**
- ① PROVIDE TWO WAY COMMUNICATIONS SYSTEM. COORDINATE EXACT LOCATION AND SYSTEM REQUIREMENTS WITH DEPARTMENT AND MANUFACTURER PRIOR TO COMMENCEMENT OF WORK. INSTRUCTIONS FOR REQUESTING ASSISTANCE FOR THE TWO WAY COMMUNICATION SYSTEM AND WRITING INSTRUCTIONS OF THE LOCATIONS SHALL BE POSTED ADJACENT TO EACH BOX IN THE COMMON AREA.
 - ② PROVIDE ONE (1) SET AT DOOR HEAD HEIGHT FOR SUB METER TRANSMITTERS, ACCESS CONTROL HARDWARE, AND SECURITY, MOBILE OR TELECOM EQUIPMENT. COORDINATE EXACT EQUIPMENT REQUIREMENTS WITH OWNER PRIOR TO ROUGH-IN.
 - ③ PROVIDE TWO READER/KEYPAD J-BOX AT LOCATION INDICATED WITH 3/4" CONDUIT TO TOP OF DOOR JAM. PROVIDE 3/4" CONDUIT FROM DOOR JAM J-BOX TO CONCEALED JUNCTION BOX ADJACENT TO FIRE PLATE. ROUTE 1" CONDUIT FROM DOOR JAM J-BOX TO ELEC/DATA ROOM DETERMINED BY OWNER. PROVIDE FIRE ALARM RELAY CONTROL AT SECURE DOOR CONTROLS SO THAT UPON FIRE ALARM OR POWER FAILURE DOOR DEFAULTS TO UNLOCKED OPEN POSITION. COORDINATE EXACT DOOR REQUIREMENTS WITH SECURITY VENDOR CONSULTANT.

Seal

ZPA
POOLE & POOLE ARCHITECTURE
 3736 Winterfield Road, Suite 102
 Midlothian, Virginia 23113
 Telephone 804.275.0215
 www.zpa.net

Project: 1928
 CADD File:
 Drawn By: SW
 Checked By: WM

Permit Release:
 May 15, 2020
 Construction Release Set:
 May 15, 2020

Revisions

No.	Date	Description
1	03/19/21	Owner Comments

© 2019 Poole & Poole Architecture, LLC
 Drawings and specifications are the intellectual property of Poole & Poole Architecture, LLC and shall not be used for any other project without the written consent of Poole & Poole Architecture, LLC.

PROFESSIONAL ENGINEER, F.C.
 Michael C. Poole
 License No. 2010-000001
 State of Tennessee

Borough 33
 an Apartment Community by
 33 Broad MF, LLC
 in Chattanooga, Tennessee



Drawing Title:
 Building 2
 Building Plan - Electrical

E2.2a

① Building 2 - First Level - Electrical
 Scale: 3/32" = 1'-0"