

LOAD CENTER B2 SCHEDULE												
VOLTAGE		200/120	1P	3 WIRE	UNGR	USA	NEC	SECTION	2017	REMARKS	Provide	
CIRCUIT		NO.	DESCRIPTION	LOAD (VA)	BRK	A	B	BRK	LOAD (VA)	DESCRIPTION	CIRCUIT	
1	Breaker (B)	1.2	20A	3.6	2000	2.3	750		3.6	750	2	
2	Breaker (B)	0.7	15A	3.0	3000	2.3	750		3.0	750	4	
3	Apppliance (A)	1.3	20A	3.4	3500	1.8	750		3.4	3500	6	
4	Apppliance (A)	1.5	20A	3.4	3500	1.8	750		3.4	3500	8	
5	Apppliance (A)	1.5	20A	3.4	3500	1.8	750		3.4	3500	10	
6	Apppliance (A)	1.5	20A	3.4	3500	1.8	750		3.4	3500	12	
7	Apppliance (A)	1.5	20A	3.4	3500	1.8	750		3.4	3500	14	
8	Apppliance (A)	1.5	20A	3.4	3500	1.8	750		3.4	3500	16	
9	Apppliance (A)	1.5	20A	3.4	3500	1.8	750		3.4	3500	18	
10	Apppliance (A)	1.5	20A	3.4	3500	1.8	750		3.4	3500	20	
11	Apppliance (A)	1.5	20A	3.4	3500	1.8	750		3.4	3500	22	
12	Apppliance (A)	1.5	20A	3.4	3500	1.8	750		3.4	3500	24	
13	Apppliance (A)	1.5	20A	3.4	3500	1.8	750		3.4	3500	26	
14	Apppliance (A)	1.5	20A	3.4	3500	1.8	750		3.4	3500	28	
15	Apppliance (A)	1.5	20A	3.4	3500	1.8	750		3.4	3500	30	
16	Apppliance (A)	1.5	20A	3.4	3500	1.8	750		3.4	3500	32	
17	Apppliance (A)	1.5	20A	3.4	3500	1.8	750		3.4	3500	34	
18	Apppliance (A)	1.5	20A	3.4	3500	1.8	750		3.4	3500	36	
19	Apppliance (A)	1.5	20A	3.4	3500	1.8	750		3.4	3500	38	
20	Apppliance (A)	1.5	20A	3.4	3500	1.8	750		3.4	3500	40	
21	Apppliance (A)	1.5	20A	3.4	3500	1.8	750		3.4	3500	42	
22	Apppliance (A)	1.5	20A	3.4	3500	1.8	750		3.4	3500	44	
23	Apppliance (A)	1.5	20A	3.4	3500	1.8	750		3.4	3500	46	
24	Apppliance (A)	1.5	20A	3.4	3500	1.8	750		3.4	3500	48	

(1) Provide 1/2" x 1/2" x 1/2" brass breaker for outdoor use.
(2) Provide 1/2" x 1/2" x 1/2" brass breaker for outdoor use.
(3) Provide 1/2" x 1/2" x 1/2" brass breaker for outdoor use.
(4) Provide 1/2" x 1/2" x 1/2" brass breaker for outdoor use.
(5) Provide 1/2" x 1/2" x 1/2" brass breaker for outdoor use.
(6) Provide 1/2" x 1/2" x 1/2" brass breaker for outdoor use.
(7) Provide 1/2" x 1/2" x 1/2" brass breaker for outdoor use.
(8) Provide 1/2" x 1/2" x 1/2" brass breaker for outdoor use.
(9) Provide 1/2" x 1/2" x 1/2" brass breaker for outdoor use.
(10) Provide 1/2" x 1/2" x 1/2" brass breaker for outdoor use.
(11) Provide 1/2" x 1/2" x 1/2" brass breaker for outdoor use.
(12) Provide 1/2" x 1/2" x 1/2" brass breaker for outdoor use.
(13) Provide 1/2" x 1/2" x 1/2" brass breaker for outdoor use.
(14) Provide 1/2" x 1/2" x 1/2" brass breaker for outdoor use.
(15) Provide 1/2" x 1/2" x 1/2" brass breaker for outdoor use.
(16) Provide 1/2" x 1/2" x 1/2" brass breaker for outdoor use.
(17) Provide 1/2" x 1/2" x 1/2" brass breaker for outdoor use.
(18) Provide 1/2" x 1/2" x 1/2" brass breaker for outdoor use.
(19) Provide 1/2" x 1/2" x 1/2" brass breaker for outdoor use.
(20) Provide 1/2" x 1/2" x 1/2" brass breaker for outdoor use.
(21) Provide 1/2" x 1/2" x 1/2" brass breaker for outdoor use.
(22) Provide 1/2" x 1/2" x 1/2" brass breaker for outdoor use.
(23) Provide 1/2" x 1/2" x 1/2" brass breaker for outdoor use.
(24) Provide 1/2" x 1/2" x 1/2" brass breaker for outdoor use.

LOADCENTER "B2" CALCULATION			
(PER 2017 NEC 220.62)			
LIGHTING AND RECEPTACLE LOAD	10.77	SP x 3W/SP	9,881 VA
TWO 20A APPLIANCE CIRCUITS			3,000 VA
LAUNDRY CIRCUIT			1,500 VA
RANGE			8,000 VA
WATER HEATER			4,500 VA
DISHWASHER			744 VA
CLOTHES DRYER			5,000 VA
REFRIGERATOR			1,200 VA
DISPOSAL			450 VA
MICROWAVE/OVEN			900 VA
RANGE FAN			385 VA
SUBTOTAL			29,659 VA
FIRST 10kVA @ 100%			10,000 VA
40% OF REMAINDER	18.659	VA x 0.4	7,464 VA
SUBTOTAL PER NEC 220.62(B)			17,464 VA
COMPRESSOR			2,864 VA
HEAT			3,000 VA
TOTAL HVAC			5,794 VA
HEAT @ 65% & COMP @ 100% PER NEC 220.62(C)			5,434 VA
SUBTOTAL PER NEC 220.62(B)			17,898 VA
NEC PER NEC 220.62(C)			5,434 VA
TOTAL DEMAND LOAD			23,332 VA

LOAD CENTER B1 SCHEDULE												
VOLTAGE		200/120	1P	3 WIRE	UNGR	USA	NEC	SECTION	2017	REMARKS	Provide	
CIRCUIT		NO.	DESCRIPTION	LOAD (VA)	BRK	A	B	BRK	LOAD (VA)	DESCRIPTION	CIRCUIT	
1	Breaker (B)	1.2	20A	3.6	2000	2.3	750		3.6	750	2	
2	Breaker (B)	0.7	15A	3.0	3000	2.3	750		3.0	750	4	
3	Apppliance (A)	1.3	20A	3.4	3500	1.8	750		3.4	3500	6	
4	Apppliance (A)	1.5	20A	3.4	3500	1.8	750		3.4	3500	8	
5	Apppliance (A)	1.5	20A	3.4	3500	1.8	750		3.4	3500	10	
6	Apppliance (A)	1.5	20A	3.4	3500	1.8	750		3.4	3500	12	
7	Apppliance (A)	1.5	20A	3.4	3500	1.8	750		3.4	3500	14	
8	Apppliance (A)	1.5	20A	3.4	3500	1.8	750		3.4	3500	16	
9	Apppliance (A)	1.5	20A	3.4	3500	1.8	750		3.4	3500	18	
10	Apppliance (A)	1.5	20A	3.4	3500	1.8	750		3.4	3500	20	
11	Apppliance (A)	1.5	20A	3.4	3500	1.8	750		3.4	3500	22	
12	Apppliance (A)	1.5	20A	3.4	3500	1.8	750		3.4	3500	24	
13	Apppliance (A)	1.5	20A	3.4	3500	1.8	750		3.4	3500	26	
14	Apppliance (A)	1.5	20A	3.4	3500	1.8	750		3.4	3500	28	
15	Apppliance (A)	1.5	20A	3.4	3500	1.8	750		3.4	3500	30	
16	Apppliance (A)	1.5	20A	3.4	3500	1.8	750		3.4	3500	32	
17	Apppliance (A)	1.5	20A	3.4	3500	1.8	750		3.4	3500	34	
18	Apppliance (A)	1.5	20A	3.4	3500	1.8	750		3.4	3500	36	
19	Apppliance (A)	1.5	20A	3.4	3500	1.8	750		3.4	3500	38	
20	Apppliance (A)	1.5	20A	3.4	3500	1.8	750		3.4	3500	40	
21	Apppliance (A)	1.5	20A	3.4	3500	1.8	750		3.4	3500	42	
22	Apppliance (A)	1.5	20A	3.4	3500	1.8	750		3.4	3500	44	
23	Apppliance (A)	1.5	20A	3.4	3500	1.8	750		3.4	3500	46	
24	Apppliance (A)	1.5	20A	3.4	3500	1.8	750		3.4	3500	48	

(1) Provide 1/2" x 1/2" x 1/2" brass breaker for outdoor use.
(2) Provide 1/2" x 1/2" x 1/2" brass breaker for outdoor use.
(3) Provide 1/2" x 1/2" x 1/2" brass breaker for outdoor use.
(4) Provide 1/2" x 1/2" x 1/2" brass breaker for outdoor use.
(5) Provide 1/2" x 1/2" x 1/2" brass breaker for outdoor use.
(6) Provide 1/2" x 1/2" x 1/2" brass breaker for outdoor use.
(7) Provide 1/2" x 1/2" x 1/2" brass breaker for outdoor use.
(8) Provide 1/2" x 1/2" x 1/2" brass breaker for outdoor use.
(9) Provide 1/2" x 1/2" x 1/2" brass breaker for outdoor use.
(10) Provide 1/2" x 1/2" x 1/2" brass breaker for outdoor use.
(11) Provide 1/2" x 1/2" x 1/2" brass breaker for outdoor use.
(12) Provide 1/2" x 1/2" x 1/2" brass breaker for outdoor use.
(13) Provide 1/2" x 1/2" x 1/2" brass breaker for outdoor use.
(14) Provide 1/2" x 1/2" x 1/2" brass breaker for outdoor use.
(15) Provide 1/2" x 1/2" x 1/2" brass breaker for outdoor use.
(16) Provide 1/2" x 1/2" x 1/2" brass breaker for outdoor use.
(17) Provide 1/2" x 1/2" x 1/2" brass breaker for outdoor use.
(18) Provide 1/2" x 1/2" x 1/2" brass breaker for outdoor use.
(19) Provide 1/2" x 1/2" x 1/2" brass breaker for outdoor use.
(20) Provide 1/2" x 1/2" x 1/2" brass breaker for outdoor use.
(21) Provide 1/2" x 1/2" x 1/2" brass breaker for outdoor use.
(22) Provide 1/2" x 1/2" x 1/2" brass breaker for outdoor use.
(23) Provide 1/2" x 1/2" x 1/2" brass breaker for outdoor use.
(24) Provide 1/2" x 1/2" x 1/2" brass breaker for outdoor use.

LOADCENTER "B1" CALCULATION			
(PER 2017 NEC 220.62)			
LIGHTING AND RECEPTACLE LOAD	9.84	SP x 3W/SP	2,952 VA
TWO 20A APPLIANCE CIRCUITS			3,000 VA
LAUNDRY CIRCUIT			1,500 VA
RANGE			8,000 VA
WATER HEATER			4,500 VA
DISHWASHER			744 VA
CLOTHES DRYER			5,000 VA
REFRIGERATOR			1,200 VA
DISPOSAL			450 VA
MICROWAVE/OVEN			900 VA
RANGE FAN			385 VA
SUBTOTAL			29,521 VA
FIRST 10kVA @ 100%			10,000 VA
40% OF REMAINDER	19.521	VA x 0.4	7,808 VA
SUBTOTAL PER NEC 220.62(B)			17,808 VA
COMPRESSOR			2,864 VA
HEAT			3,000 VA
TOTAL HVAC			5,794 VA
HEAT @ 65% & COMP @ 100% PER NEC 220.62(C)			5,434 VA
SUBTOTAL PER NEC 220.62(B)			17,898 VA
NEC PER NEC 220.62(C)			5,434 VA
TOTAL DEMAND LOAD			23,332 VA

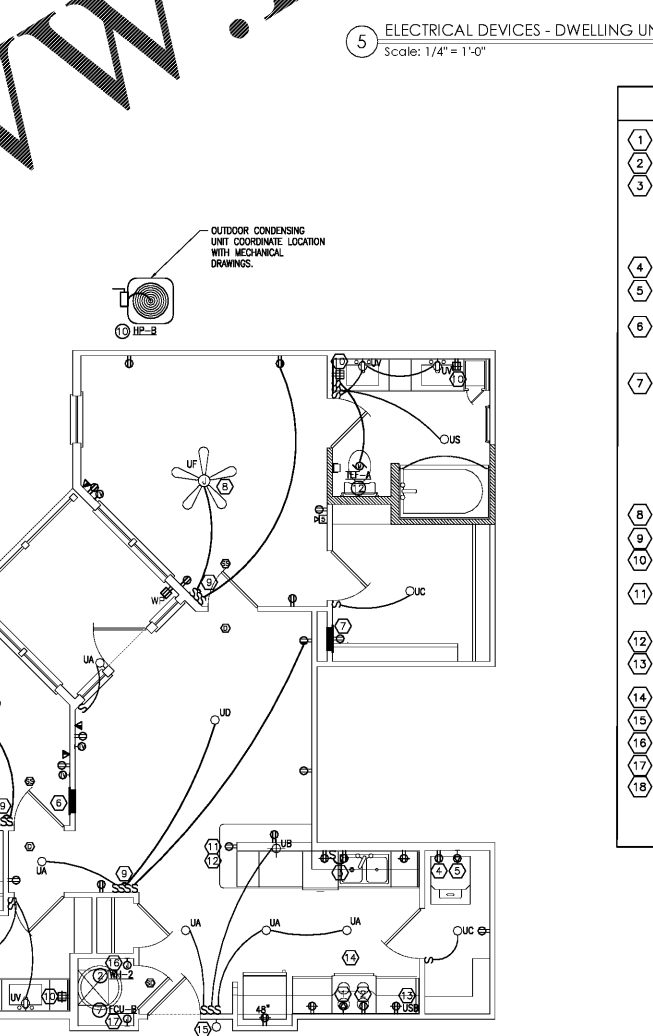
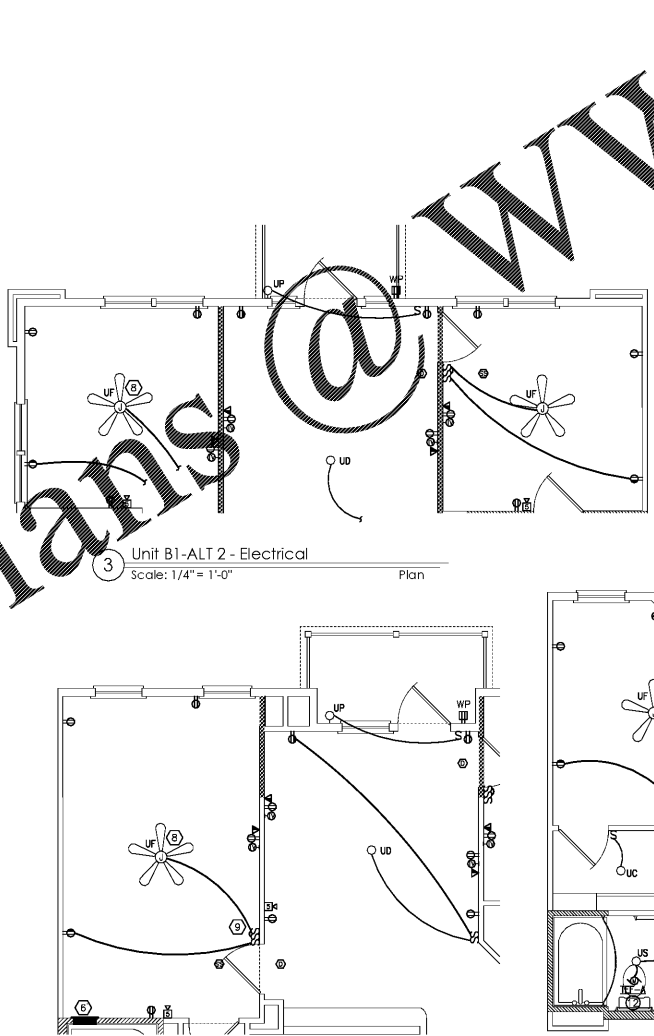
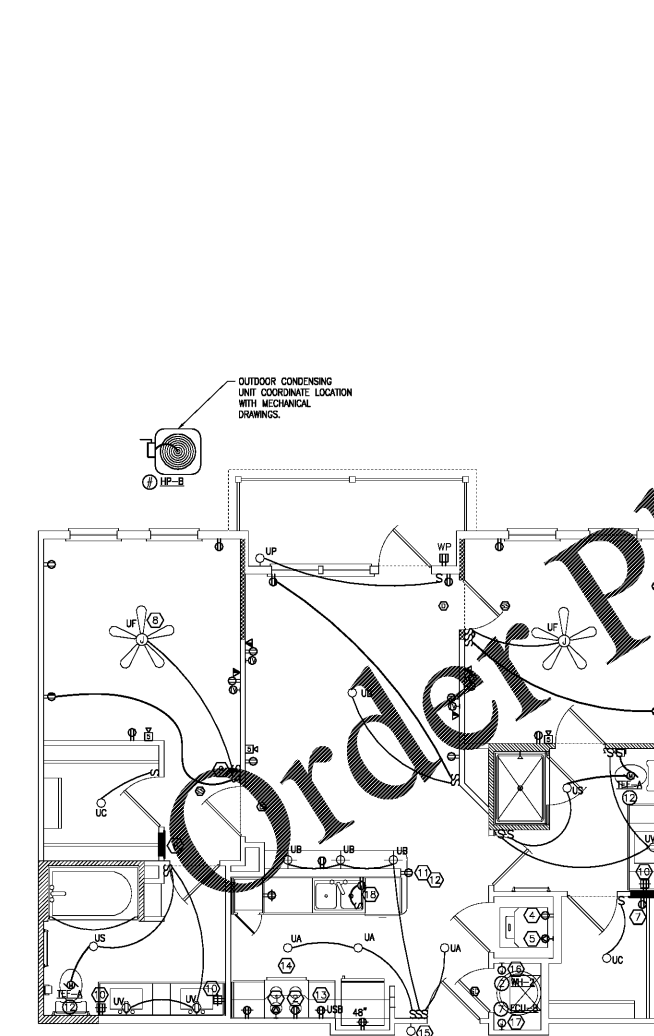
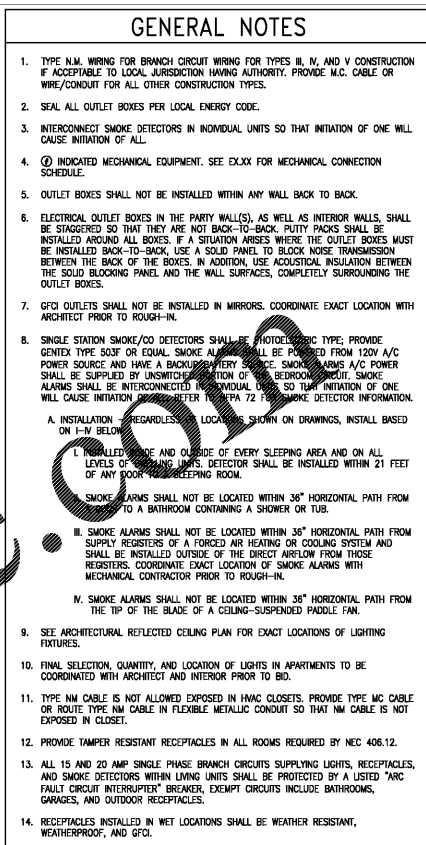
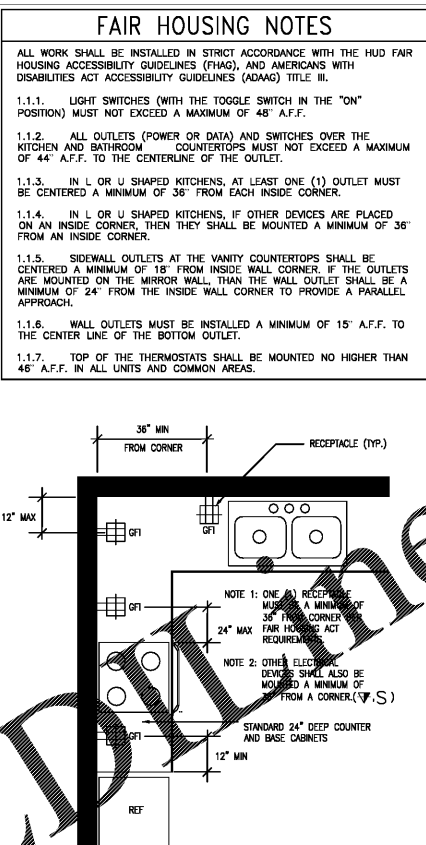

- UNIT PLAN KEY NOTES (THIS SHEET ONLY)**
- PROVIDE (NEMA 14-50R) RECEPTACLE W/3#6, #10G CIRCUIT FOR RANGE. PROVIDE RANGE CORD.
 - PROVIDE (NEMA 5-20R) RECEPTACLE W/2#12, #12G CIRCUIT FOR RANGE HOOD/MICROWAVE.
 - MOUNT INSIDE SINK BASE CABINET ADJACENT TO DISHWASHER AND BREAK TABS ON RECEPTACLE. TOP RECEPTACLE SHALL BE CONTROLLED BY WALL SWITCH (MOUNT IN SAME BOX AS ABOVE COUNTER TOP RECEPTACLE) FOR DISPOSAL. BOTTOM RECEPTACLE SHALL BE UNSWITCHED FOR DISHWASHER. PROVIDE 3 PRONG, 4' SO CORD WITH PLUG FOR DISHWASHER AND 3 PRONG, 3' SO CORD WITH PLUG FOR GARBAGE DISPOSAL. PROVIDE 2 CIRCUITS AS INDICATED ON THE LOAD CENTER SCHEDULE.
 - PROVIDE A (NEMA 5-20R) RECEPTACLE MTD 48" AFF WITH 2#12, #12G. FOR WASHER.
 - PROVIDE A (NEMA 14-30R) RECEPTACLE MTD 48" AFF WITH 3#10, #10G CIRCUIT FOR CLOTHES DRYER. PROVIDE DRYER CORD.
 - FLUSH MOUNTED LOAD CENTER (W/FLUSH MOUNT COVER, 1/2" OVERLAP); CONTRACTOR SHALL VERIFY THAT THERE IS NO PIPING AND/OR DUCTWORK INSTALLED ABOVE LOADCENTER. MOUNT TOP CIRCUIT BREAKER HANDLE AT 48" AFF. COORDINATE EXACT LOCATION AND REQUIREMENTS WITH ARCHITECT/INTERIOR DESIGNER/OWNER PRIOR TO BID/ROUGH-IN.
 - PROVIDE (MINIMUM 14" X 28" FLUSH MOUNTED STRUCTURED MEDIA ENCLOSURE WITH LOCKING DOOR, 1x8" BRIDGED TELEPHONE BOARD AND 6 WAY 1GHZ PASSIVE VIDEO SPLITTER. PROVIDE (1) CAT 6 CABLE FROM PUNCH DOWN BLOCK TO EACH DATA/TELEPHONE OUTLET (NO DAISSY CHANNING) AND (1) CAT 6 CABLE FROM PUNCH DOWN BLOCK TO TELEPHONE SERVICE DEMARCATION LOCATION. PROVIDE (1) RG11 COAXIAL CABLE FROM SPLITTER TO EACH TELEVISION OUTLET (NO DAISSY CHANNING) AND PROVIDE (1) RG11 COAXIAL CABLE FROM SPLITTER TO CABLE SERVICE DEMARCATION LOCATION. TERMINATE ALL CABLES ON APPROPRIATE TERMINATION POINTS. CLEARLY LABEL EACH PORT IDENTIFYING THE DESTINATION ADDRESS OF EACH CABLE. PROVIDE A MINIMUM OF 12" SLACK CABLE AT EACH OUTLET. PROVIDE (1) 20A DUPLEX RECEPTACLE MOUNTED WITHIN ENCLOSURE. MOUNT ENCLOSURE AT 36" AFF. FIELD VERIFY. SEE TELE/CATV RISER DIAGRAM.
 - PROVIDE A FAN-RATED JUNCTION BOX RECESSED FLUSH WITHIN CEILING.
 - 1 SWITCH SHALL CONTROL FAN. 1 SPST OR 3 WAY SWITCH SHALL CONTROL LIGHT.
 - MOUNT RECEPTACLE HORIZONTALLY WITHIN 12" OF FRONT EDGE OF COUNTER. COORDINATE WITH THE MILL WORK CONTRACTOR FOR OUTLET LOCATION WHEN NO SIDE WALL IS AVAILABLE.
 - MOUNT HORIZONTALLY 4" BELOW COUNTERTOP WHERE COUNTER OVERHANG DOES NOT EXTEND MORE THAN 6". COORDINATE WITH ARCHITECT.
 - CONNECT TO