

# Order Plans @

**BUILDING #3**

STACKS	3-110
ROOF	
LEVEL 4	A1-ALT1
LEVEL 3	A1-ALT1
LEVEL 2	A1-ALT1
LEVEL 1	WALK-THRU
REF PLAN #	3/S4.2

**UNIT FLOOR & WALL FRAMING PLAN NOTES:**

- FLOOR FRAMING SHALL BE AS FOLLOWS:
  - ALL FLOOR FRAMING SHALL BE 18" DEEP PRE-ENGINEERED OPEN WEB TRUSSES @ 24" O.C. UNO.
  - BALCONY JOIST FRAMING SHALL BE AS FOLLOWS:
    - PTL 2x10 @ 16" OC UP TO 8'-9" CLEAR SPAN
    - PTL 2x10 @ 12" OC UP TO 10'-3" CLEAR SPAN
    - PTL 2-2x10 @ 16" OC UP TO 12'-5" CLEAR SPAN
    - PTL 2-2x10 @ 12" OC UP TO 14'-3" CLEAR SPAN
- THE MIN. NUMBER OF WALL STUDS AT BEARING POINTS SHALL BE (SEE BUILT-UP COL. SCHEDULE ON S4.0 FOR ADD'L INFO.):
  - BUILT-UP MULTI-PLY FLUSH BEAMS: SEE 13/S7.1 FOR ADDITIONAL INFORMATION (SAWN LUMBER AND LVL) (3 STUDS MIN)
  - SHALL MATCH THE NUMBER OF PLYS OF THE GIRDER TRUSS (3 STUDS MIN) UNO ON PLAN
  - SEE: JAMB/KING STUD SCHEDULE
- HEADERS/DROP BEAMS:
  - THE CENTERLINE OF THE BEAM OR GT SHALL MATCH THE CENTERLINE OF THE SUPPORTING WALL STUDS.
  - ALL COL'S, INCLUDING STUD PACKS, MUST ALIGN FLOOR-TO-FLOOR WITH SOLID BLOKING OF THE SAME SIZE AND DIMENSION AS THE COL ABOVE, AT FLOOR CAVITY LOCATIONS. CONTINUE TO FDN OR BEAM SUPPORT BELOW.
- SEE S7.0a FOR ALLOWABLE WALL PLATE & STUD PENETRATIONS.
- SEE S7.0b FOR GENERAL SECTIONS AT BALCONY LEDGER PENETRATION, BALCONY GUARDRAIL ATTACHMENT AND FLOOR & STUD FRAMING AT WASHER BOX.
- WHERE STUD ALIGNMENT IS REQUIRED, SEE 2/S7.0 FOR ALLOWABLE OFFSET DISTANCE BETWEEN FLOOR TRUSS FRAMING AND WALL STUDS.
- SEE ARCH DWGS FOR EXACT FINISHED FLOOR ELEVATIONS.
- SEE GENERAL NOTES FOR LUMBER SPECS AND GRADE REQS.
- ALL CONNECTOR TYPES REFER TO SIMPSON STRONG-TIE SPECIFICATIONS UNO. SEE GENERAL NOTES FOR ADD'L INFO.
- SEE 1/S7.3 FOR TYPICAL WOOD OR STEEL BEAM TO BEAM AND BEAM TO HSS COLUMN CONNECTIONS NOT IDENTIFIED ON PLAN.
- EXTENTS OF WALL TYPE TAGS ARE FROM ONE INTERSECTING-WALL/WALL-CORNER/WALL-OPENING TO THE NEXT INTERSECTING-WALL/WALL-CORNER/WALL-OPENING UNO.
- DO NOT CORE BEAMS OR HEADERS UNLESS SPECIFIED BY EOR.
  - SEE S0.# SERIES FOR GENERAL NOTES
  - SEE S2.# SERIES FOR FLOOR FRAMING (STACK) PLANS
  - SEE S2.#X SERIES FOR FLOOR BRACING PLANS
  - SEE S3.# SERIES FOR ROOF FRAMING PLANS
  - SEE S4.0a-b FOR SHEARWALL/ANCHORAGE INFORMATION
  - SEE S4.0c FOR STUD/WALL/BUILT UP COL SCHEDs
  - SEE S4.# SERIES FOR INDIVIDUAL UNIT FRAMING PLANS
  - SEE S6.# SERIES FOR FOUNDATION/RETAINING WALL DETAILS
  - SEE S7.# SERIES FOR FLOOR FRAMING DETAILS
  - SEE S8.# SERIES FOR ROOF FRAMING DETAILS
  - SEE S9.# SERIES FOR MASONRY DETAILS
  - SEE S10.# SERIES FOR CLUB/FITNESS/VERANDA/GARAGE/TRASH ENCLOSURE PLANS
  - SEE S10.#X SERIES FOR CLUB/FITNESS/VERANDA/GARAGE/TRASH ENCLOSURE BRACING PLANS

**UNIT FLOOR & WALL FRAMING PLAN LEGEND**

- 210-2 DENOTES WOOD BEAM/HEADER DESIGNATION. SEE BEAM/HEADER SCHEDULE ON S4.0c FOR ADD'L INFO.
- BC4 DENOTES BUILT-UP COLUMN DESIGNATION. SEE BUILT-UP COL. SCHEDULE ON S4.0c FOR ADD'L INFO.
- GT DENOTES GIRDER TRUSS LOCATION.
- 2K/1J DENOTES QUANTITY OF KING STUDS (K) & JAMB STUDS (J) PER HEADER END. SEE S4.0c FOR STUD INFO.
- [Symbol] DENOTES LOCATION OF MECH DUCT PENETRATION THRU CEILING. TRUSS SUPPLIER SHALL COORDINATE LOCATION OF TRUSSES W/PENETRATION. SEE ARCH DWGS FOR EXACT LOCATION.
- 6X" DENOTES DISTANCE FROM TOP OF WALL BEAM FLANGE TO TOP OF SUBFLOOR. SEE 7/S7.0 FOR ADD'L INFO.
- [Symbol] LETTER IN [Symbol] DENOTES APPLICABLE BEAM OR BEAM TO COLUMN CONNECTION DETAIL PER S7.3.
- 0.8K DL 1.0K LL DENOTES DEAD & LIVE LOADS TO BE APPLIED AT GIRDER TRUSS JOINT IN ADDITION TO PRESCRIBED LOADING GIVEN IN GENERAL NOTES.
- [Symbol] DENOTES FLUSH BEAM WITH BOTTOM OF BEAM AT FLOOR BEARING.
- CON DENOTES HEADER WITHIN WALL FRAMING ABOVE OPENING.
- [Symbol] DENOTES CONTINUOUS, UNINTERRUPTED HEADER. USE KING/JAMB STUD QUANTITY CORRESPONDING TO FULL WIDTH OF HEADER ROUGH OPENING.
- [Symbol] DENOTES LOAD-BEARING WALL TYPE. SEE S4.0c FOR WALL FRAMING SCHEDULE & ADDITIONAL INFO.
- [Symbol] DENOTES MOMENT FRAME CONNECTION. SEE 2/S7.3

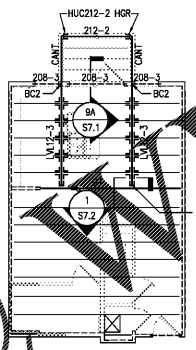

**UNIT A1-ALT1  
FLOOR FRAMING PLAN**

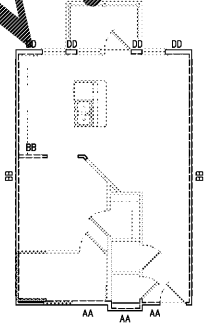

**UNIT A1-ALT1  
WALL FRAMING PLAN**

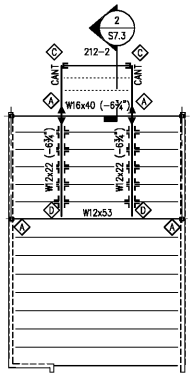

**WALK THRU UNDER UNIT A1-ALT1  
FLOOR FRAMING PLAN**

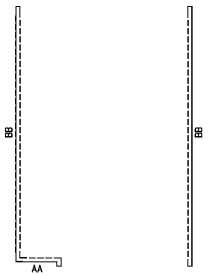

**WALK THRU UNDER UNIT A1-ALT1  
WALL FRAMING PLAN**

1 **STACK #** 3-110  
 S4.8 SCALE: 1/8" = 1'-0"

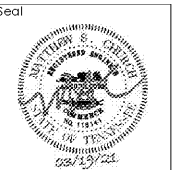

**ZPA**  
 POORE & POORE ARCHITECTURE  
 5736 Westchester Road, Suite 100  
 Memphis, TN 38119  
 Phone: (901) 673-0213  
 WWW.ZPA.TN.PE  
 INC ER#181972

**DAVIS & CHURCH**  
 STRUCTURAL ENGINEERS  
 7905 Westside Parkway, Ste. 200  
 Alhambra, CA 91808  
 (714) 612-1212

Project: 1928.00  
 CADD File:  
 Drawn By: AVG  
 Checked By: TQ

Permit Release:  
 May 15, 2020  
 Construction Release Set:  
 May 15, 2020

Revisions	
No.	Date Description

ASI / RFI Revisions  
 No. Date Description

**Borough 33**  
 an Apartment Community by  
 33 Broad MF, LLC  
 in Chattanooga, Tennessee

Drawing Title:  
 Unit Floor & Wall  
 Framing Plans

**S4.8**

ISSUED FOR CONSTRUCTION