

Order Plans

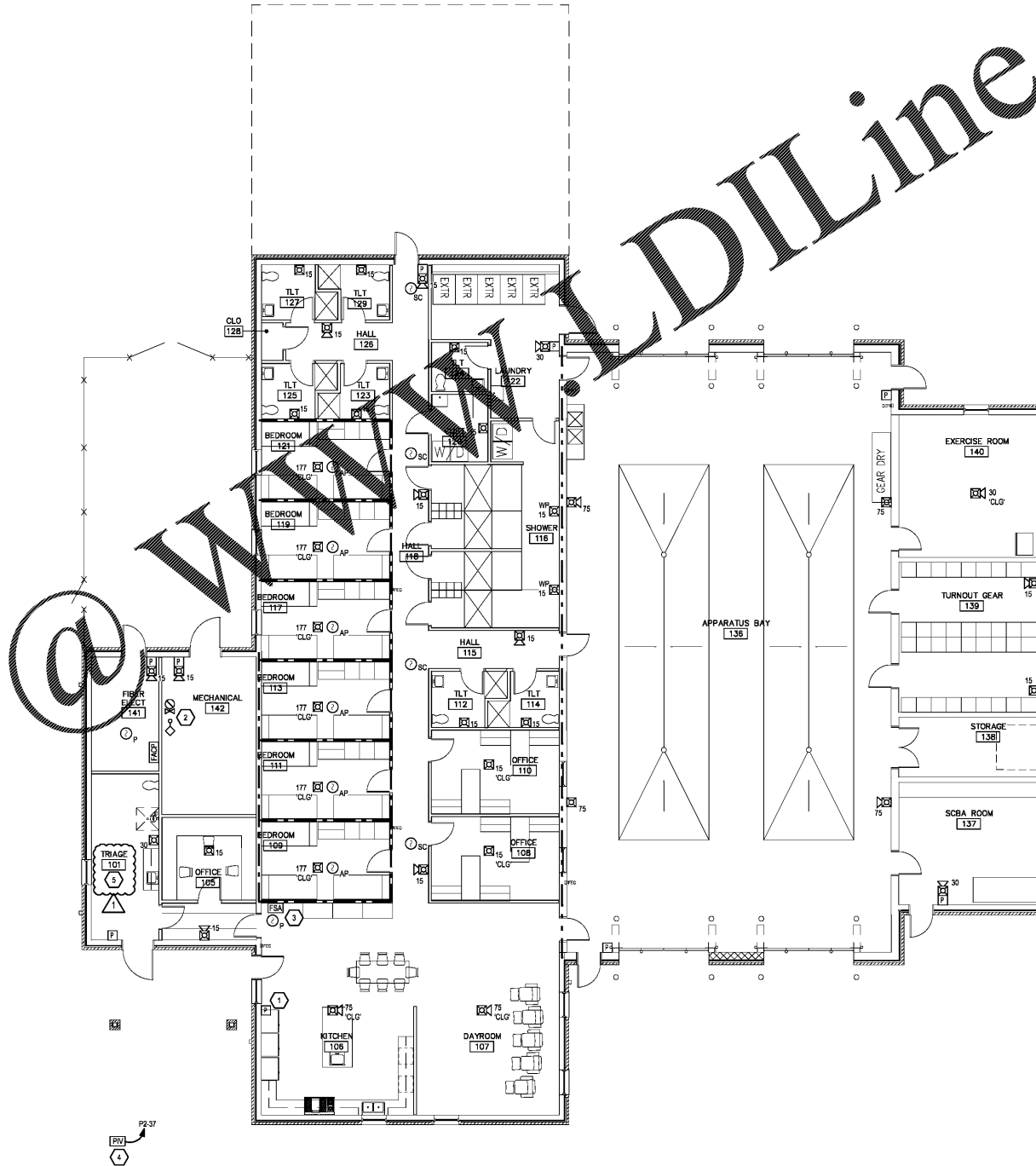

FIRE ALARM DECIBEL LEVEL NOTE
 FIRE ALARM CONTRACTOR SHALL PROVIDE ANY ADDITIONAL HORN STROBE TYPE NOTIFICATION DEVICES AS REQUIRED BEYOND THOSE INDICATED ON THE PLANS PER THE LOCAL FIRE DEPARTMENT INSPECTOR'S REQUIREMENTS IN ORDER TO MAINTAIN A DECIBEL LEVEL OF 15DBA ABOVE AMBIENT NOISE LEVELS THROUGHOUT ALL AREAS OF THE PROJECT SPACE IN ACCORDANCE WITH NFPA 72.

- NOTES KEYED TO PLAN**
- 1 MOUNT PULL STATION WITHIN 8'-0" OF DOOR.
 - 2 PROVIDE WIRING / CONNECTIONS BETWEEN FACP AND TAMPER / FLOW SWITCHES AS REQUIRED PER NFPA 72. COORDINATE EXACT LOCATION AND QUANTITY OF TAMPER / FLOW SWITCHES WITH FIRE PROTECTION CONTRACTOR.
 - 3 COORDINATE EXACT LOCATION OF FIRE ALARM ANNUNCIATOR PANEL WITH OWNER / ARCHITECT PRIOR TO ROUGH-IN.
 - 4 COORDINATE PIV LOCATION WITH CIVIL SITE PLANS AND FIRE PROTECTION CONTRACTOR.
 - 5 INSTALLATION METHODS UTILIZED FOR TRIAGE 101 SHALL COMPLY WITH APPLICABLE SECTIONS OF NEC ARTICLE 917 AS REQUIRED. REFER TO NEC 917 - HEALTH CARE SPACE NOTE ON SHEET FAN1 FOR ADDITIONAL REQUIREMENTS.

1 FIRST FLOOR - FIRE ALARM PLAN
 FA1.1 SCALE: 1/8"=1'-0"

RATED WALL LEGEND

---	1/2 HOUR RATED FIRE BARRIER
---	2 HOUR RATED FIRE BARRIER

REFER TO UL PENETRATION DETAILS FOR ADDITIONAL REQUIREMENTS



ENGINEERED DESIGNS INC.
 North Carolina License #C-1729
 North Carolina License #2758
 1151 SE Cary Parkway, Suite 200 Cary, North Carolina 27518
 P 919.851.6481 F 919.851.9703 www.engineereddesigns.com

City of Winston-Salem
FIRE STATION 3
 WINSTON-SALEM • NORTH CAROLINA



THESE DRAWINGS ARE INSTRUMENTS OF SERVICE AND SHALL REMAIN THE PROPERTY OF THE ARCHITECT UNLESS THE PROJECT HAS BEEN FULLY PAID FOR. NO PART OF THESE DRAWINGS SHALL BE REPRODUCED OR TRANSMITTED IN ANY FORM OR BY ANY MEANS WITHOUT THE WRITTEN PERMISSION OF ERSOY BRAKE APPELBY ARCHITECTS, P.A.

DRAWN : SG
 CHECKED : BW
 COMM. : 1904
 DATE : 03-17-21
 REVISION :
 FA1.1 OF 1