

**KEY NOTES**

- 1 DRYER VENT EXHAUST DUCT, SEE DETAIL.
- 2 EXTERIOR EXHAUST DUCT, PROVIDE EXTERIOR JACKET ON DUCTWORK.
- 3 PROVIDE CONCENTRIC VENT KIT AT FLUE DUCT ROOF PENETRATION.

**GENERAL NOTES**

1. ALL GRAVITY INTAKE VENTS TO BE LOCATED AT LEAST 10'-0" FROM EXHAUST OPENINGS.

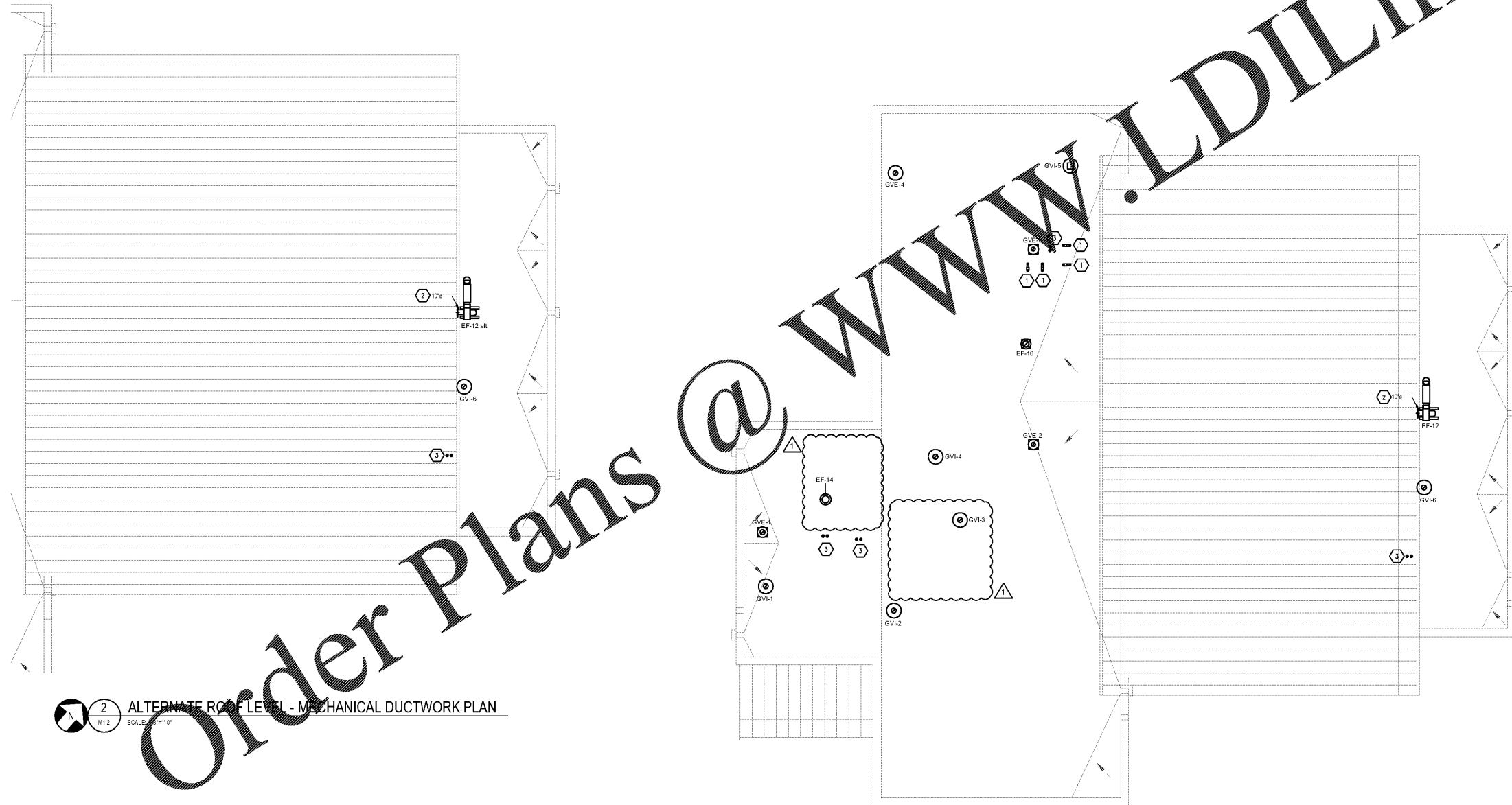

2 ALTERNATE ROOF LEVEL - MECHANICAL DUCTWORK PLAN  
M1.2 SCALE: 1/8"=1'-0"

1 ROOF LEVEL - MECHANICAL DUCTWORK PLAN  
M1.2 SCALE: 1/8"=1'-0"

RATED WALL LEGEND	
	12 HOUR RATED FIRE BARRIER
	2 HOUR RATED FIRE BARRIER

REFER TO UL PENETRATION DETAILS FOR ADDITIONAL REQUIREMENTS



**ENGINEERED DESIGNS INC.**  
North Carolina License #C-1729  
1151 SE Cary Parkway, Suite 200 Cary, North Carolina 27518  
P 919.851.9481 F 919.851.9703 www.engineereddesigns.com

City of Winston-Salem  
**FIRE STATION 3**  
WINSTON-SALEM • NORTH CAROLINA



THESE DRAWINGS ARE INSTRUMENTS OF SERVICE AND SHALL REMAIN THE PROPERTY OF THE ARCHITECT UNLESS THE PROJECT FOR WHICH THEY WERE MADE IS COMPLETED. ANY REUSE OR REPRODUCTION OF THESE DRAWINGS WITHOUT THE WRITTEN PERMISSION OF THE ARCHITECT IS STRICTLY PROHIBITED. ANY REUSE OR REPRODUCTION OF THESE DRAWINGS WITHOUT THE WRITTEN PERMISSION OF THE ARCHITECT IS STRICTLY PROHIBITED.

DRAWN: EG  
CHECKED: MS  
COMM: 1904  
DATE: 03-17-21  
REVISION: