

DRAWING ISSUE RECORD		
DATE:	REVISIONS:	NO.
4-8-2011	ISSUE TO BID	

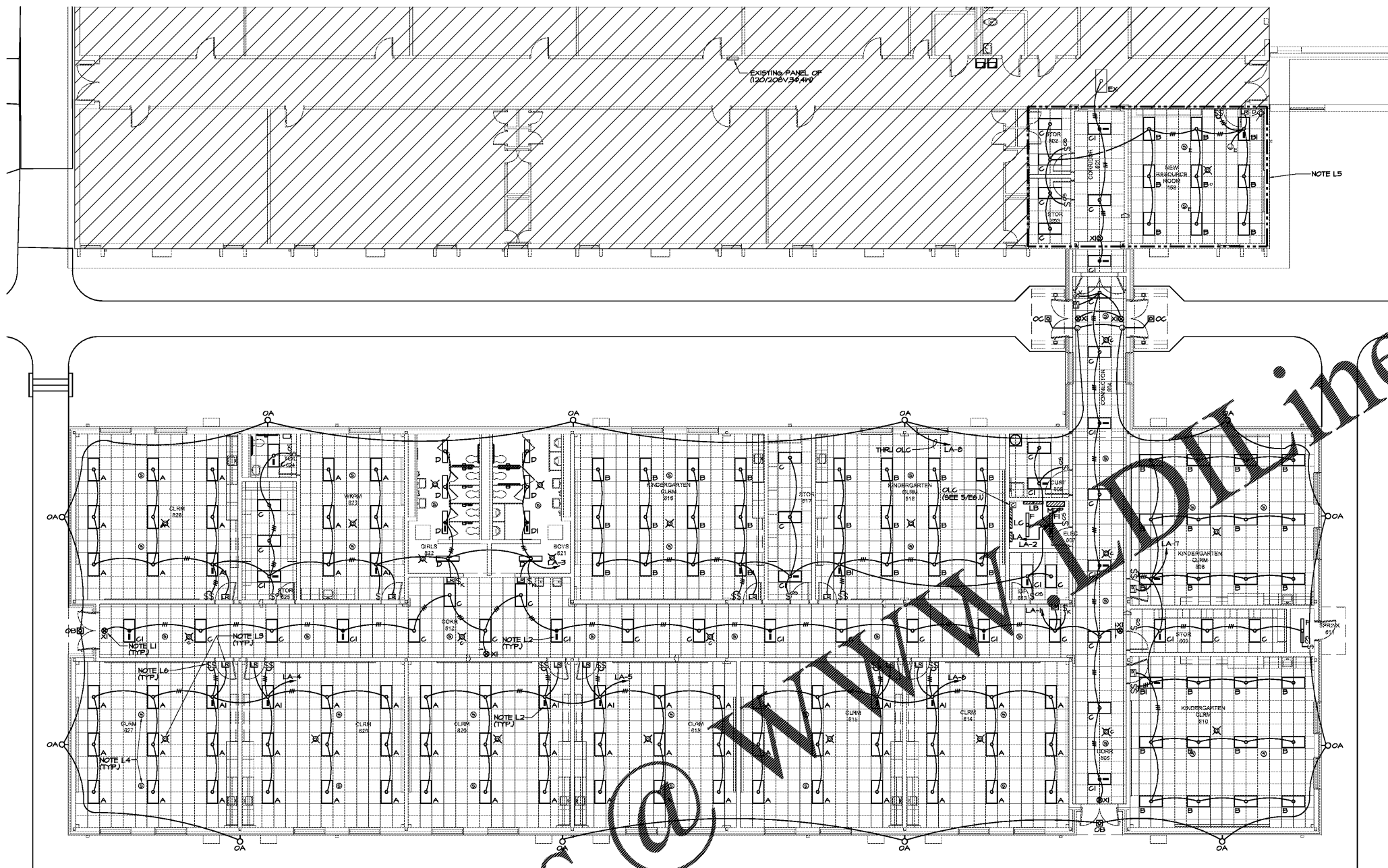

1 PARTIAL FLOOR PLAN - LIGHTING
E11 1/8"=1'-0"

- GENERAL NOTES:** (APPLIES TO ALL SHEETS)
- EXISTING CIRCUITING AND DEVICE LOCATIONS SHOWN ARE TAKEN FROM EXISTING BUILDING PLANS. VERIFY LOCATIONS IN FIELD BEFORE STARTING WORK AND NOTIFY ENGINEER OF ANY DISCREPANCIES THAT WOULD HINDER COMPLETION OF WORK BEFORE WORK IS BEGUN.
 - ALL EXISTING LIGHTING FIXTURES, DEVICES, CONDUIT AND CONDUCTORS SHALL REMAIN IN AREAS WHERE NO WORK IS SHOWN.
 - WHERE MATERIAL OR OBJECTS ARE REMOVED, RELOCATED OR MODIFIED, CONTRACTOR SHALL PATCH OR REPAIR DAMAGED SURFACE FROM WHICH THE ITEM WAS REMOVED, RELOCATED OR MODIFIED TO MATCH THE ADJACENT MATERIAL OR FINISH.
 - THE CONTRACTOR SHALL REMOVE EXISTING CEILING TILES, GRID AND/OR LIGHTS AS NECESSARY TO INSTALL WORK SHOWN ON THE DRAWINGS AND THEN REPLACE THEM WHEN THE WORK IS COMPLETE. ANY ITEMS BROKEN BY THE CONTRACTOR SHALL BE REPLACED WITH NEW ITEMS THAT MATCH EXISTING. IF NEW TILES DO NOT MATCH EXISTING THE CONTRACTOR SHALL INSTALL ALL NEW TILES IN ONE OR MORE ROOMS AND USE THE OLD TILES FOR REPLACEMENT THROUGHOUT THE BUILDING.
 - ALL PENETRATIONS THROUGH FIRE WALLS AND RATED FLOOR SLABS SHALL BE FIRE STOPPED WITH 3M FIRE BARRIER OR EQUAL PRODUCT MEETING UL 1474 OR ASTM E814 FIRE RATINGS IN ACCORDANCE WITH ARTICLE 900-21 OF THE NATIONAL ELECTRICAL CODE.
 - WHERE ABOVE CEILING IS USED AS A RETURN AIR FLENUM, ALL MATERIALS WITHIN FLENUMS ARE REQUIRED TO BE NONCOMBUSTIBLE OR SHALL HAVE A FLAME SPREAD INDEX OF NOT MORE THAN 25 AND A SMOKE DEVELOPED INDEX OF NOT MORE THAN 50 AS DETERMINED IN ACCORDANCE WITH ASTM E84.
 - WHERE DEVICES ARE SHOWN TO BE INSTALLED IN EXISTING WALLS, RUN FLEXIBLE METAL CONDUIT DOWN IN WALL FROM ABOVE CEILING TO NEW DEVICE. IF WALL IS INACCESSIBLE, RUN NEMOLD SURFACE METAL RACEWAY DOWN WALL FROM ABOVE CEILING TO NEMOLD SURFACE MOUNTED OUTLET BOX.
 - PAINT ALL EXPOSED CONDUIT INSTALLED IN THIS CONTRACT TO MATCH ADJACENT FINISH.

- REFERENCED LIGHTING NOTES:** (APPLIES TO THIS SHEET ONLY)
- DO NOT SWITCH BATTERY POWERED EXIT LIGHTS.
 - FIXTURES WITH EMERGENCY BATTERY PACKS SHALL BE CONNECTED AS NIGHT LIGHTS IN CORRIDORS. ALL OTHER FIXTURES SHOULD BE CONNECTED TO OPERATE BY SWITCH.
 - SEE 2/E6.1 FOR CIRCUITING OF OCCUPANCY SENSORS AND RELAYS.
 - DEVICES ARE SHOWN ON THIS DRAWING FOR LOCATION ONLY. SEE SHEET E4.1 FOR CIRCUITING OF INTERCOM SYSTEM.
 - IN RENOVATED AREAS - DISCONNECT AND REMOVE EXISTING LIGHTING FIXTURES, SWITCHES, CONDUCTORS AND ACCESSIBLE CONDUIT BACK TO THE NEXT DEVICE TO REMAIN. INSTALL NEW LIGHTING, SWITCHES AND WIRING AS SHOWN.
 - IN CLASSROOMS, SWITCH ROW OF FIXTURES AT MARKERBOARD WITH ONE SWITCH AND ALL OTHER FIXTURES IN THE ROOM WITH SECOND SWITCH FOR DUAL LEVEL LIGHTING.

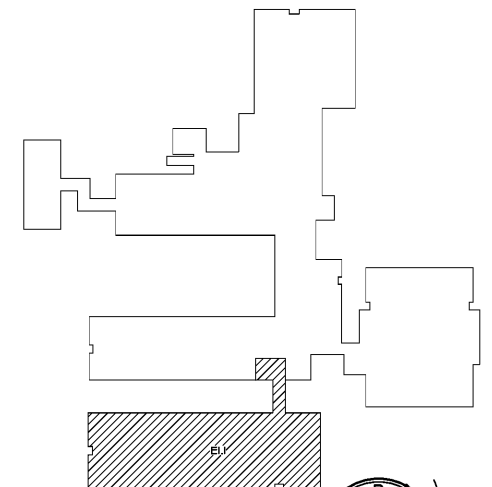

KEY PLAN

DO NOT DUPLICATE WITHOUT PERMISSION

SPURLOCK & ASSOCIATES, INC.
consulting engineers
2970 Clairmont Rd., Suite 620 | Atlanta, GA 30329
P: 404.633.0245 | F: 404.633.1736
GA JOB NO. 2-05

Order Plans @ www.dline.com

ADDITION TO COLHAM FERRY ELEMENTARY SCHOOL
191 COLHAM FERRY ROAD, MARIETTA, GA 30067
FOR THE BOARD OF EDUCATION
OCONEE COUNTY, GA
IDE FACILITY CODE 3555

DATE: DECEMBER 15, 2010
JOB NO. 01-L-2011-20
DWG. BY: G.T.R.
CHK. BY: G.L.K.

cunningham forhand matthews moore
cunningham, forhand, matthews & moore, architects, inc. - 2011 manchester street, n.e. - atlanta, georgia 30324 - phone (404) 873-2152

E11