

DRAWING ISSUE RECORD		
DATE	REVISIONS	NO.
4-8-2021	ISSUE TO BID	

FIRE MARSHAL NOTES: (ALL PLUMBING SHEETS)

- ALL PENETRATIONS THROUGH FIRE RATED WALLS AND FLOORS SHALL BE FIRE STOPPED WITH 3H FIRE BARRIER OR EQUAL PRODUCT MEETING UL 1479 OR ASTM E814 FIRE RATINGS IN ACCORDANCE WITH ARTICLE 900-21 OF THE NATIONAL ELECTRICAL CODE. SEE ARCHITECTURAL FOR DETAILS.
- SEE MECH DINGS FOR PORTIONS OF THE BUILDING WITH RETURN AIR FLENUMS. ALL MATERIALS EXPOSED WITHIN FLENUMS ARE REQUIRED TO BE NONCOMBUSTIBLE OR SHALL HAVE A FLAME SPREAD INDEX OF NOT MORE THAN 25 AND A SMOKE DEVELOPED INDEX OF NOT MORE THAN 50 AS DETERMINED IN ACCORDANCE WITH ASTM E84.
- A COMPLETE SET OF SPRINKLER SHOP DRAWINGS SHALL BE SUBMITTED TO THE COUNTY FIRE MARSHALL'S OFFICE, APPROVED, AND A PERMIT OBTAINED BEFORE ANY SPRINKLER WORK IS INSTALLED.
- CONTRACTOR TO OBTAIN COUNTY FIRE MARSHAL APPROVAL BEFORE MAKING MODIFICATIONS TO THE SPRINKLER SYSTEM. THIS MAY REQUIRE SPRINKLER SHOP DRAWINGS TO BE SUBMITTED. A PERMIT MUST BE OBTAINED BEFORE ANY SPRINKLER WORK IS INSTALLED.

REFERENCED NOTES: (ALL PLUMBING SHEETS)

- TRAP PRIMER ABOVE CEILING. SEE DETAIL 7/P-312
- FOR GAS CONNECTION SEE DETAIL 1/P-231 (TYPICAL)

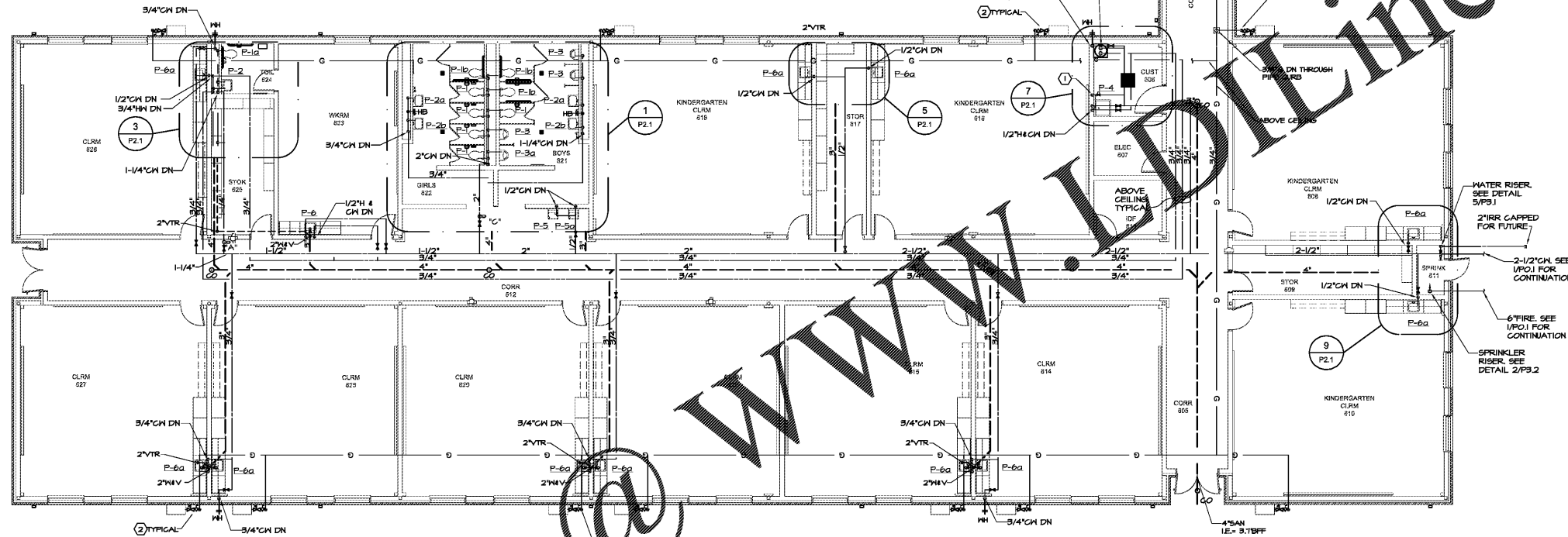

1 FLOOR PLAN - PLUMBING
1/8" = 1'-0"

GENERAL NOTES: (ALL PLUMBING SHEETS)

- CONTRACTOR SHALL NOTIFY ENGINEER IN WRITING OF ANY DISCREPANCIES OF EXISTING CONDITIONS FROM THAT SHOWN ON PLANS OR OF ANY CONDITION PROHIBITING WORK TO BE INSTALLED AS SHOWN ON PLANS BEFORE WORK IS BEGUN.
- DO NOT SCALE DRAWINGS FOR LOCATIONS OF PLUMBING FIXTURES OR ROOF DRAINS, EMERGENCY ROOF DRAINS, AND FLOOR DRAINS. SEE ARCHITECTURAL DRAWINGS FOR DIMENSIONS.
- VENTS THRU ROOF MUST BE LOCATED 10'-0" OR MORE FROM OUTSIDE AIR INTAKES ON HVAC SYSTEM AS PER CODE. SEE HVAC DRAWINGS FOR LOCATION OF INTAKES. PROVIDE OFFSETS IN VENTS AS NECESSARY TO MAINTAIN CLEARANCE.
- WHERE 2" VTR IS SHOWN ON PLANS, EXTEND 2" V UP TO BELOW ROOF, TRANSITION TO 3" VENT UP THRU ROOF TO ACCOMMODATE ROOF FLASHING.
- PLUMBING PIPING SHALL NOT BE INSTALLED IN HVAC SERVICE CLEARANCES. SEE MECHANICAL SHEETS AND DETAILS FOR COORDINATION BETWEEN THE TRADES IN CORRIDORS & BUILDING SECTIONS.
- WHERE HANDICAPPED WATER CLOSETS ARE NOT CENTERED IN THE STALL, ROUGH-IN COLD WATER PIPE SO THAT FLUSH VALVE HANDLE WILL BE ON WIDE SIDE OF STALL.
- ALL EXTERIOR GLEANOUTS TO BE LOCATED EQUIDISTANT FROM FACE OF EXTERIOR WALLS.
- INSTALL VALVES IN WATER LINES ABOVE CORRIDOR CEILINGSS SO THE VALVE HANDLES ARE ACCESSIBLE. VALVES MUST NOT BE MORE THAN 40" ABOVE CEILING.
- COLD & HOT WATER PIPING DROPS IN CHASES SHALL REMAIN FULL LINE SIZE THROUGHOUT CHASE, UNLESS NOTED OTHERWISE. SEE FIXTURE CONNECTION SCHEDULE FOR ALL BRANCH STUB-OUT PIPE SIZES. REFER TO TYPICAL WATER RISER DETAIL 3/P3.1.
- WHERE PIPING IS INSTALLED UNDER PERIMETER FOOTINGS, PIPING SHALL BE INSTALLED IN STEEL CASING. CASING SHALL EXTEND A MINIMUM OF 1'-0" BEYOND THE EDGE OF THE FOOTING.
- SEWER INVERTS SHOWN ARE REFERENCED FROM TOP OF FLOOR SLAB.
- CONTRACTOR SHALL COORDINATE ROUTING OF EXPOSED PIPING WITH ARCHITECT PRIOR TO INSTALLATION.
- ALL EXTERIOR GAS PRESSURE REGULATORS SHALL BE INSTALLED SO THAT THE RELIEF VENT DISCHARGES DOWN VIA REGULATORY ORIENTATION OR WITH 45 DEGREE ELBOW.
- CONTRACTOR SHALL COORDINATE WATER COOLER LOCATIONS WITH ELECTRICAL PRIOR TO INSTALLATION. ELECTRICAL OUTLETS SHALL BE LOCATED WITHIN WATER COOLER CABINET IN CUT OUT PROVIDED BY THE WATER COOLER MANUFACTURER, OR CENTERED AND DIRECTLY BELOW WATER COOLER CABINET, IF REQUIRED BY ELECTRICAL INSPECTOR TO BE LOCATED OUTSIDE OF WATER COOLER CABINET.
- CONTRACTOR SHALL PREP, PRIME, AND PAINT EXTERIOR GAS PIPING. COORDINATE COLOR WITH OWNER/ARCHITECT.
- CONTRACTOR SHALL COORDINATE EXACT LOCATION OF VALVES ABOVE HARD CEILING WITH ACCESS PANELS, PROVIDED UNDER ARCHITECTURAL SCOPE, PRIOR TO INSTALLATION.

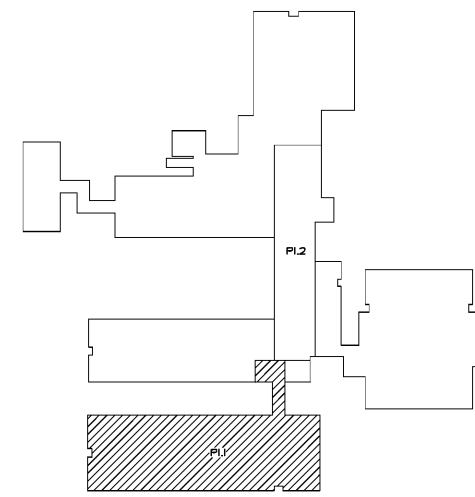

KEY PLAN

Order Plans

WWW.LDLine.com

cunningham foehand mattheus moore

ADDITION TO COLHAM FERRY
ELEMENTARY SCHOOL
191 COLHAM FERRY ROAD, WYKINSVILLE, GA 30677
FOR THE BOARD OF EDUCATION
OCONEE COUNTY, GA
OCONEE COUNTY, GA
DDE FACILITY CODE 3530

DATE: DECEMBER 15, 2021 JOB NO. B-L-2021-20 DWG. BY: J.C.F. CK. BY: M.W.D.

404 873-2152

cunningham, foehand, mattheus & moore, architects, inc. - 2011 manchester street, n.e. - atlanta, georgia 30324 - phone (404) 873-2152



SPURLOCK & ASSOCIATES, INC.
consulting engineers
2970 Clairmont Rd., Suite 620 | Atlanta, GA 30329
P: 404.633.0245 | F: 404.633.1736
SA JOB NO. 2103