

DRAWING ISSUE RECORD		
DATE	REVISION	NO.
4-4-2021	ISSUE TO BID	

**SITE GRADING PLAN**

ADDITION TO COLHAM FERRY  
ELEMENTARY SCHOOL  
181 COLHAM FERRY ROAD WATKINSVILLE, GA 30611  
FOR THE BOARD OF EDUCATION  
OCONEE COUNTY BOARD OF EDUCATION  
1000 W. STATE ST. WATKINSVILLE, GA 30678  
DCE FACILITY CODE 3000

DATE: DECEMBER 8, 2020  
JOB NO: 8-1-2017-20  
DWN BY: JCH  
CHK BY: TMS

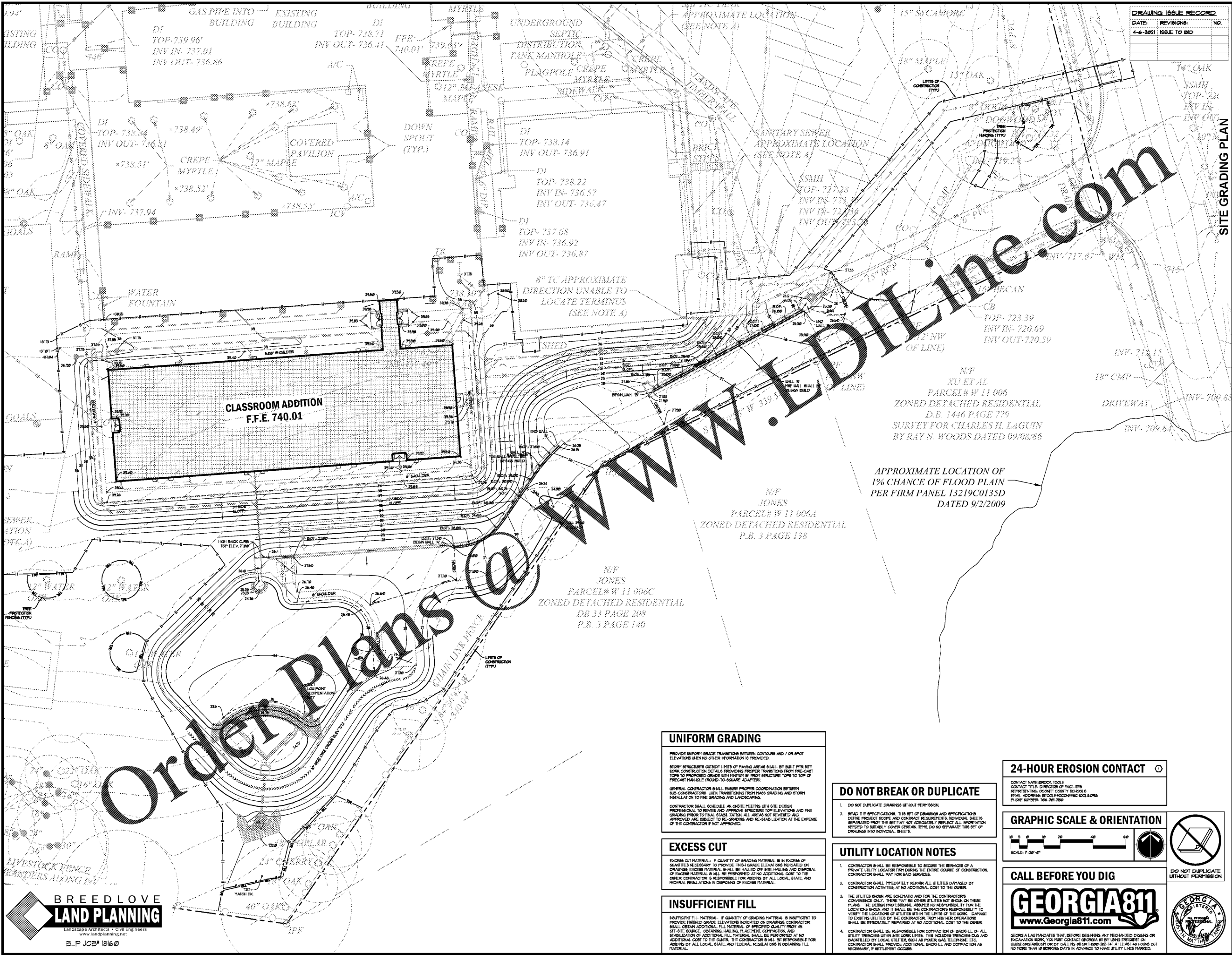

N/P JONES  
PARCEL # W 11 006C  
ZONED DETACHED RESIDENTIAL  
D.B. 33 PAGE 208  
P.B. 3 PAGE 140

N/P JONES  
PARCEL # W 11 006A  
ZONED DETACHED RESIDENTIAL  
P.B. 3 PAGE 158

APPROXIMATE LOCATION OF  
1% CHANCE OF FLOOD PLAIN  
PER FIRM PANEL 13219C0135D  
DATED 9/2/2009

N/P XU ET AL  
PARCEL # W 11 006  
ZONED DETACHED RESIDENTIAL  
D.B. 1446 PAGE 779  
SURVEY FOR CHARLES H. LAGUIN  
BY RAY N. WOODS DATED 09/08/86

Order Plans @ [www.LDOnline.com](http://www.LDOnline.com)

**UNIFORM GRADING**

PROVIDE UNIFORM GRADE TRANSITIONS BETWEEN CONTOURS AND / OR SPOT ELEVATIONS WHEN NO OTHER INFORMATION IS PROVIDED.

STONE STRUCTURES OUTSIDE LIMITS OF PAVING AREAS SHALL BE BUILT FOR SITE WORK CONSTRUCTION DETAILS PROVIDING PROPER TRANSITIONS FROM PRE-CAST CURBS TO FINISHED GRADE WITH FINISH FROM STRUCTURE TOPS TO TOP OF PRECAST MANHOLE (ROUND-TO-SQUARE ADAPTER).

GENERAL CONTRACTOR SHALL ENSURE PROPER COORDINATION BETWEEN SUB-CONTRACTORS WHEN TRANSITIONING FROM MASS GRADING AND STORM INSTALLATION TO THE GRASS AND LANDSCAPING.

CONTRACTOR SHALL SCHEDULE AN ON-SITE MEETING WITH SITE DESIGN PROFESSIONAL TO REVIEW AND APPROVE STRUCTURE TOP ELEVATIONS AND FINE GRADING PRIOR TO FINAL STABILIZATION. ALL AREAS NOT REVIEWED AND APPROVED ARE SUBJECT TO RE-GRADING AND RE-STABILIZATION AT THE EXPENSE OF THE CONTRACTOR IF NOT APPROVED.

---

**EXCESS CUT**

EXCESS CUT MATERIAL: IF QUANTITY OF GRADING MATERIAL IS IN EXCESS OF QUANTITIES NECESSARY TO PROVIDE FINISH GRADE ELEVATIONS INDICATED ON DRAWINGS, EXCESS MATERIAL SHALL BE HAUL TO OFF-SITE HAULING AND DISPOSAL. EXCESS MATERIAL SHALL BE REFORMED AT NO ADDITIONAL COST TO THE OWNER. CONTRACTOR IS RESPONSIBLE FOR ASBESTOS BY ALL LOCAL, STATE, AND FEDERAL REGULATIONS IN DISPOSING OF EXCESS MATERIAL.

---

**INSUFFICIENT FILL**

INSUFFICIENT FILL MATERIAL: IF QUANTITY OF GRADING MATERIAL IS INSUFFICIENT TO PROVIDE FINISHED GRADE, CONTRACTOR SHALL OBTAIN ADDITIONAL FILL MATERIAL OF SPECIFIED QUALITY FROM AN OFF-SITE SOURCE. OBTAINING, HAULING, PLACING, COMPACTING, AND STABILIZATION OF ADDITIONAL FILL MATERIAL SHALL BE PERFORMED AT NO ADDITIONAL COST TO THE OWNER. THE CONTRACTOR SHALL BE RESPONSIBLE FOR ASBESTOS BY ALL LOCAL, STATE, AND FEDERAL REGULATIONS IN OBTAINING FILL MATERIAL.

**DO NOT BREAK OR DUPLICATE**

- DO NOT DUPLICATE DRAWINGS WITHOUT PERMISSION.
- READ THE SPECIFICATIONS. THIS SET OF DRAWINGS AND SPECIFICATIONS DEFINE PROJECT SCOPE AND CONTRACT REQUIREMENTS. INDIVIDUAL SHEETS SEPARATED FROM THE SET MAY NOT ADEQUATELY REFLECT ALL INFORMATION NEEDED TO INSTANTLY REPAIR OR MAINTAIN THEM. DO NOT REPLICATE THE SET OF DRAWINGS INTO INDIVIDUAL SHEETS.

---

**UTILITY LOCATION NOTES**

- CONTRACTOR SHALL BE RESPONSIBLE TO SECURE THE SERVICES OF A PRIVATE UTILITY LOCATOR PRIOR DURING THE ENTIRE COURSE OF CONSTRUCTION. CONTRACTOR SHALL PAY FOR SAID SERVICES.
- CONTRACTOR SHALL IMMEDIATELY REPAIR ALL UTILITIES DAMAGED BY CONSTRUCTION ACTIVITIES AT NO ADDITIONAL COST TO THE OWNER.
- THE UTILITIES SHOWN ARE SCHEMATIC AND FOR THE CONTRACTOR'S CONVENIENCE ONLY. THERE MAY BE OTHER UTILITIES NOT SHOWN ON THESE PLANS. THE DESIGN PROFESSIONAL ASSUMES NO RESPONSIBILITY FOR THE LOCATION, DEPTH, AND TYPE OF UTILITIES. IT SHALL BE THE CONTRACTOR'S RESPONSIBILITY TO VERIFY THE LOCATIONS OF UTILITIES WITHIN THE LIMITS OF THE WORK. DAMAGE TO EXISTING UTILITIES BY THE CONTRACTOR FROM HER OPERATIONS SHALL BE IMMEDIATELY REPAIRED AT THE CONTRACTOR'S EXPENSE.
- CONTRACTOR SHALL BE RESPONSIBLE FOR PROTECTION OF BACKFILL OF ALL UTILITY TRENCHES WITHIN SITE WORK LIMITS. THIS INCLUDES TRENCHES CUT AND BACKFILLED BY LOCAL UTILITIES, SUCH AS POWER, GAS, TELEPHONE, ETC. CONTRACTOR SHALL PROVIDE ADDITIONAL BACKFILL AND PROTECTION AS NECESSARY, IF SETTLEMENT OCCURS.

**24-HOUR EROSION CONTACT**

CONTACT NAME: BREKOK 1001  
CONTACT TITLE: DIRECTOR OF FACILITIES  
REPRESENTING: OCONEE COUNTY SCHOOLS  
PHYSICAL ADDRESS: 8100 FRODOCTERWOOD BLVD  
PHONE NUMBER: 706-321-2882

---

**GRAPHIC SCALE & ORIENTATION**

SCALE: 1"=20'-0"

DO NOT DUPLICATE WITHOUT PERMISSION

---

**CALL BEFORE YOU DIG**

**GEORGIA811**  
[www.Georgia811.com](http://www.Georgia811.com)

GEORGIA LAW MANDATES THAT, BEFORE BEGINNING ANY MECHANIZED DIGGING OR EXCAVATION WORK, YOU MUST CONTACT GEORGIA 811 BY USING REQUEST ON WEBSITE OR BY CALLING 811 OR 1-800-368-5811 AT LEAST 48 HOURS BUT NO MORE THAN 10 WORKING DAYS IN ADVANCE TO HAVE UTILITY LINES MARKED.

**BREEDLOVE LAND PLANNING**  
Landscape Architects • Civil Engineers  
[www.landplanning.net](http://www.landplanning.net)  
BLP JOB# 18160

**cunningham forhand matthews moore**

cunningham, forhand, matthews & moore, architects, inc. - 2011 manchester street, n.e. - atlanta, georgia 30324 - phone (404) 873-2152

C3.00