

ADDITION TO COLHAM FERRY ELEMENTARY SCHOOL

DOE FACILITY CODE 3050
 191 COLHAM FERRY ROAD, WATKINSVILLE, GA 30677
 FOR THE OCONEE COUNTY BOARD OF EDUCATION
 OCONEE COUNTY, GA

DATE	REVISIONS	NO.
4-6-2021	ISSUE TO BID	

ADDITION TO COLHAM FERRY
 ELEMENTARY SCHOOL
 191 COLHAM FERRY ROAD, WATKINSVILLE, GA 30677
 FOR THE OCONEE COUNTY BOARD OF EDUCATION
 OCONEE COUNTY FACILITY CODE 3050

DATE: DECEMBER 15, 2020
 JOB NO. 84-15071-20
 DRAWN BY: AK
 CHECK BY:

cunningham, forehand, matthews & moore, architects, inc. - 2011 manchester street, n.e. - atlanta, georgia 30324 - phone (404) 873-2152

cunningham forehand matthews moore

CS

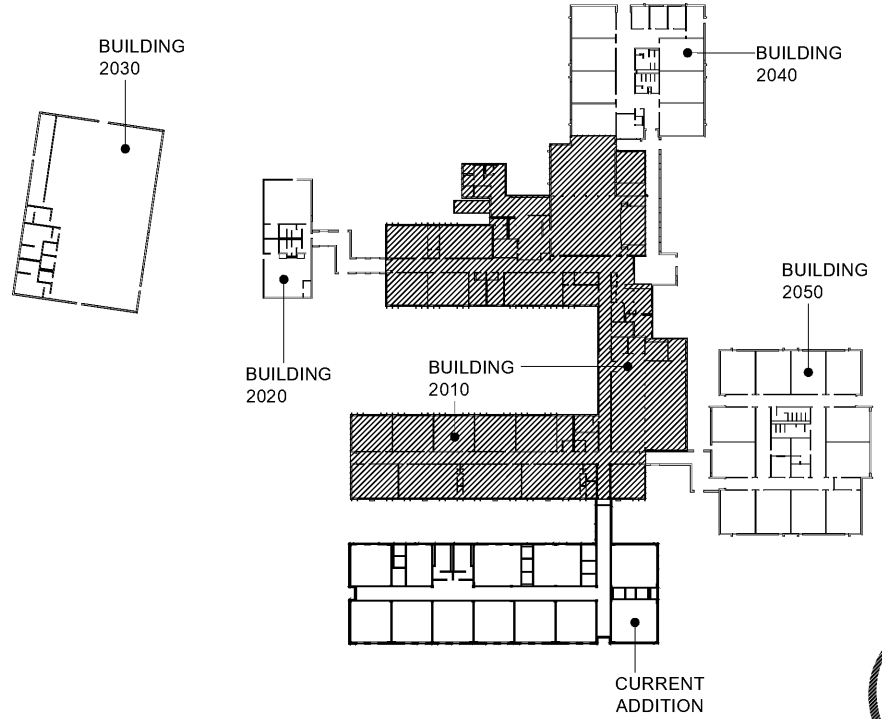

DRAWING INDEX:

- | | |
|---|--|
| CIVIL | ARCHITECTURAL |
| C0.00 GENERAL SITE NOTES | F1.1 FIRE RATING NOTES & DETAILS |
| C0.01 BOUNDARY & TOPOGRAPHIC SURVEY | D1.1 ENLARGED DEMOLITION PLAN & DETAILS |
| C1.00 OVERALL SITE PLAN | A1.1 OVERALL GRADING PLAN AND GENERAL NOTES |
| C1.50 SITE DEMOLITION PLAN | A2.1 1/8" ADDITION PLAN & FINISH SCHEDULE |
| C2.00 SITE LAYOUT & PAVING PLAN | A3.1 1/4" TOP OF FINISH PLANS, ELEVATIONS AND CASEWORK DETAILS |
| C2.10 SITE WALL ELEVATIONS | A4.1 DOOR SCHEDULE & DETAILS |
| C3.00 SITE GRADING PLAN | A5.1 1/8" BUILDING ADDITION ELEVATIONS & DETAILS |
| C3.10 STORM DRAINAGE PLAN | A6.1 BUILDING SECTIONS & DETAILS |
| C3.20 POND DETAIL, STORM PROFILES | A6.2 BUILDING SECTIONS & DETAILS |
| C4.00 NPDES NOTES | A6.3 BUILDING SECTIONS & DETAILS |
| C4.05 NPDES NOTES & DETAILS | A7.1 1/8" ADDITION ROOF PLAN & DETAILS |
| C4.10 INITIAL EROSION CONTROL PLAN | |
| C4.20 INTERMEDIATE EROSION CONTROL PLAN | PLUMBING |
| C4.30 FINAL EROSION CONTROL PLAN | P0.0.1 SITE PLAN - PLUMBING - DEMO |
| C4.40 ES&PC CALCULATIONS & REPRESENTATIVE PRACTICES | P0.1 SITE PLAN - PLUMBING |
| C4.45 ES&PC DETAILS | P0.2 SITE PLAN LEGEND & SITE DETAILS |
| C4.46 ES&PC DETAILS | P1.1 1/8" ADDITION PLAN - PLUMBING |
| C7.00 SITEWORK CONSTRUCTION DETAILS | P1.2 1/8" PARTIAL EXISTING PLAN - PLUMBING |
| | P2.1 ENLARGED PLUMBING PLANS & RISER DIAGRAMS |
| STRUCTURAL | P3.1 PLUMBING LEGEND, FIXTURE SCHEDULE & DETAILS |
| S1.1 GENERAL NOTES & SCHEDULES | P3.2 SPRINKLER RISER & DETAILS |
| S1.2 GENERAL NOTES & SCHEDULES | |
| S2.1 1/8" ADDITION FOUNDATION PLAN | MECHANICAL |
| S2.2 1/8" ADDITION ROOF FRAMING PLAN | M1.1 1/8" ADDITION PLAN - MECHANICAL |
| S3.1 FOUNDATION SECTIONS & DETAILS | M2.1 HVAC LEGENDS & DETAILS |
| S3.2 FOUNDATION SECTIONS & DETAILS | M3.1 ENERGY MANAGEMENT SYSTEM & AUTOMATIC TEMPERATURE CONTROLS DIAGRAM |
| S4.1 CMU WALL SECTIONS & DETAILS | |
| S5.1 SECTIONS & DETAILS | ELECTRICAL |
| S5.2 SECTIONS & DETAILS | E0.1 SITE PLAN - ELECTRICAL |
| | E1.1 1/8" ADDITION PLAN - LIGHTING |
| | E2.1 1/8" ADDITION PLAN - POWER |
| | E3.1 PARTIAL FLOOR PLAN - FIRE ALARM |
| | E4.1 PARTIAL FLOOR PLAN - INTERCOM |
| | E5.1 1/8" ADDITION PLAN - CABLE HOOKS |
| | E6.1 ELECTRICAL LEGENDS & DETAILS |
| | E6.2 PANEL SCHEDULES & POWER RISER DIAGRAM |

SPRINKLER NOTE:
 SPRINKLER SYSTEM TO BE PROVIDED IN ACCORDANCE WITH THE BARROW COUNTY FIRE PROTECTION AND LIFE SAFETY ORDINANCE. SPRINKLER CONTRACTOR SHALL OBTAIN A SPRINKLER SYSTEM PERMIT FROM THE BARROW COUNTY FIRE MARSHAL'S OFFICE PRIOR TO INSTALLATION. CONTRACTOR SHALL PROVIDE A SPRINKLER SYSTEM TEST CERTIFICATE AT THE TIME OF FINAL INSPECTION. SPRINKLER SYSTEMS SHALL BE OFF-SITE MONITORED AT A CONSTANTLY ATTENDED LOCATION.
 PLANS FOR FIRE-PROTECTION SPRINKLER PIPING INCLUDING COMPLETE SEISMIC SUPPORT DETAILS SHALL BE REVIEWED AND APPROVED BY THE BARROW COUNTY FIRE MARSHAL'S OFFICE PRIOR TO INSTALLATION FOR COMPLIANCE WITH 85C SECTION 16213.10.1 AND NFPA 13.

NOTE:
 FIRE ALARM SYSTEM TO BE PROVIDED IN ACCORDANCE WITH THE BARROW COUNTY FIRE PROTECTION AND LIFE SAFETY ORDINANCE AND NFPA 72. FIRE ALARM CONTRACTOR SHALL OBTAIN A FIRE ALARM SYSTEM PERMIT FROM THE BARROW COUNTY FIRE MARSHAL'S OFFICE PRIOR TO INSTALLATION. CONTRACTOR SHALL PROVIDE A FIRE ALARM SYSTEM TEST CERTIFICATE AT THE TIME OF FINAL INSPECTION.

NOTE:
 MATERIALS EXPOSED WITHIN FINISHES ARE REQUIRED TO BE NONCOMBUSTIBLE OR SHALL HAVE A FLAME SPREAD INDEX OF NOT MORE THAN 25 AND A SMOKE DEVELOPMENT INDEX OF NOT MORE THAN 50 AS DETERMINED IN ACCORDANCE WITH ASTM E 84 EXCEPT FOR TESTED AND LABELED WIRING, FIRE SPRINKLER PIPING, PNEUMATIC TUBING, AND ELECTRICAL EQUIPMENT (IBC SECTIONS 716.5 AND 1017.4), ALSO IBC 902.2.1).

NOTE:
 A SIGN CLEARLY STATING THAT SMOKING IS PROHIBITED SHALL BE CONSPICUOUSLY POSTED BY THE BUILDING OWNER, AGENT, OPERATOR, PERSON IN CHARGE OF PROPRIETOR AT EACH ENTRANCE OR IN A POSITION CLEARLY VISIBLE UPON ENTRY INTO THE BUILDING IN ACCORDANCE WITH GEORGIA SMOKEFREE AIR ACT OF 2005. ACCEPTABLE SIGNS SHALL DISPLAY EITHER "NO SMOKING", OR THE INTERNATIONAL "NO SMOKING" SYMBOL (CONSISTING OF A PICTORIAL REPRESENTATION OF A BURNING CIGARETTE ENCLOSED IN A RED CIRCLE WITH A RED BAR ACROSS IT).

NOTE:
 DO NOT REPRODUCE THESE DRAWINGS OR PROJECT MANUAL WITHOUT THE WRITTEN CONSENT OF CUNNINGHAM FOREHAND MATTHEWS & MOORE, ARCHITECTS, INC.

DO NOT BREAK THESE DOCUMENTS INTO PARTS AND SUB-PARTS. THE BARROW COUNTY BOARD OF EDUCATION ASSUMES NO RESPONSIBILITY FOR THE SEPARATION OF THESE DOCUMENTS BY ANY ENTITY OF THE CONTRACTING INDUSTRY. EACH CONTRACTING ENTITY SHALL BE RESPONSIBLE FOR ALL THE WORK RELATED TO THEIR TRADES WHERE EVER IT MAY BE SHOWN WITHIN THE CONTRACT DOCUMENTS PACKAGES.

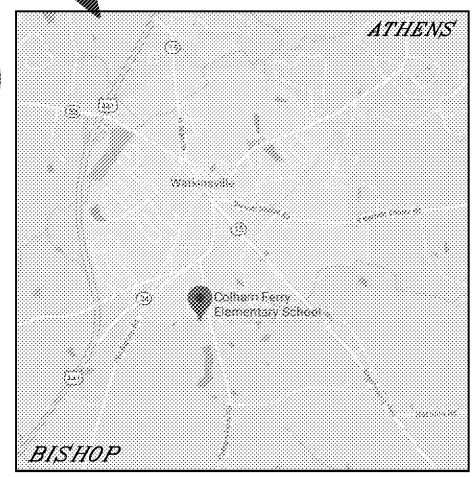

LOCATION MAP IN.T.S.J
 COLHAM FERRY ELEMENTARY SCHOOL

ALL BUILDINGS DESCRIBED IN THESE PLANS SHALL BE CONSTRUCTED IN COMPLIANCE WITH THE FOLLOWING CODES, WHICH INCLUDE REVISIONS, AMENDMENTS AND APPENDICES:
 INTERNATIONAL BUILDING CODE - 2018 EDITION WITH 2020 GEORGIA STATE AMENDMENTS
 INTERNATIONAL FUEL GAS CODE - 2018 EDITION WITH 2020 GEORGIA STATE AMENDMENTS
 INTERNATIONAL MECHANICAL CODE - 2018 EDITION WITH 2020 GEORGIA STATE AMENDMENTS
 INTERNATIONAL PLUMBING CODE - 2018 EDITION WITH 2020 GEORGIA STATE AMENDMENTS
 INTERNATIONAL FIRE CODE (IFC) - 2018 EDITION (NO GEORGIA AMENDMENTS)
 NATIONAL ELECTRICAL CODE - 2017 EDITION (NO GEORGIA AMENDMENTS)
 NATIONAL ENERGY CONSERVATION CODE - 2015 EDITION W/ 2020 GEORGIA STATE SUPPLEMENTS & AMENDMENTS
 NFPA 101 LIFE SAFETY CODE - 2018 EDITION WITH 2020 GEORGIA STATE AMENDMENTS
 GEORGIA ACCESSIBILITY CODE (CHAPTER) 120-3-20
 AMERICANS WITH DISABILITIES ACT - 2010 ADA STANDARDS

NOTE:
 REFERENCES IN THESE DOCUMENTS TO BUILDING SQUARE FOOTAGES ARE FOR OWNER'S PURPOSES ONLY. DO NOT RELY ON THESE NUMBERS FOR BIDDING PURPOSES. CONTRACTOR IS RESPONSIBLE FOR ESTIMATING ALL QUANTITIES.

BUILDING SQ. FT. EX. CLASS. BLDG: 50,640 SQ. FT. EX. GYM BLDG: 10,836 SQ. FT. ADDITION: 14,818 SQ. FT. TOTAL: 84,294 SQ. FT.	INSTRUCTIONAL UNITS EX. BLDG: 38 (-1 DEMOED) ADDITION: 10 (-1 RE-BUILT) TOTAL: 48
---	---

FTE
 EX. BLDG: 600 / ADDITION: 150 / TOTAL: 750

DESIGNERS OF RECORD:
ARCHITECT:
 JEFFREY G. ROBINSON
 CUNNINGHAM FOREHAND MATTHEWS & MOORE, ARCHITECTS, INC.
 2011 MANCHESTER STREET, N.E., ATLANTA, GEORGIA 30324
 PH: (404) 873-2152
PLUMBING, MECHANICAL ENGINEER:
 MIKE DILLON (SPURLOCK & ASSOCIATES, INC.)
 2910 CLAIRMONT ROAD, N.E., SUITE 620, ATLANTA, GA 30329
 PH: (404) 633-0245
ELECTRICAL ENGINEER:
 CLINTON KELLEY (SPURLOCK & ASSOCIATES, INC.)
 2910 CLAIRMONT RD., N.E., SUITE 620, ATLANTA, GA 30329
 PH: (404) 633-0245

THE LOCAL FIRE OFFICE HAVING JURISDICTION HAS REVIEWED AND APPROVED A SET OF DOCUMENTS IDENTICAL TO THIS SET OF DOCUMENTS ON _____ (DATE)

A CONSTRUCTION PERMIT WILL BE ISSUED TO THE CONTRACTOR AT THE START OF CONSTRUCTION
 (SIGNED) *Jeffrey G. Robinson*
 ARCHITECT

