

- STAGE 1**
1. MAINTAIN TRAFFIC ON EXISTING DELESSEPS AVE/LA ROCHE AVE.
 2. COMPLETE PROPOSED CONSTRUCTION UP TO ASPHALT BINDER.
 3. PLACE LEVELING ON EXISTING DELESSEPS/LA ROCHE AVE AS NEEDED TO MAINTAIN POSITIVE DRAINAGE.

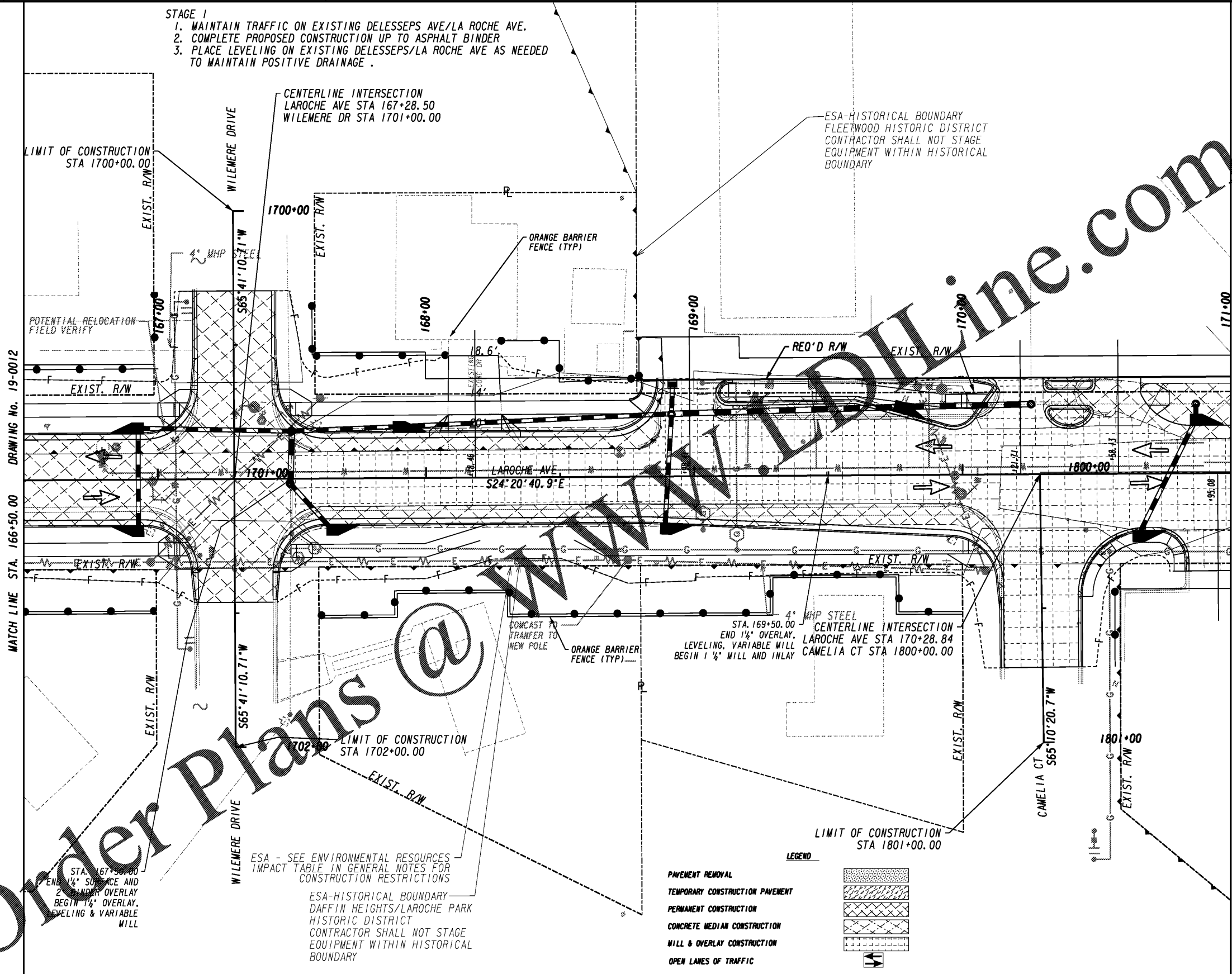

Order Plans @ www.newline.com

DRAWING No. 19-0012
MATCH LINE STA. 166+50.00

DRAWING No. 19-0014
MATCH LINE STA. 171+00.00

ESA - SEE ENVIRONMENTAL RESOURCES IMPACT TABLE IN GENERAL NOTES FOR CONSTRUCTION RESTRICTIONS

ESA-HISTORICAL BOUNDARY DAFFIN HEIGHTS/LAROCHE PARK HISTORIC DISTRICT CONTRACTOR SHALL NOT STAGE EQUIPMENT WITHIN HISTORICAL BOUNDARY

LEGEND

	PAVEMENT REMOVAL
	TEMPORARY CONSTRUCTION PAVEMENT
	PERMANENT CONSTRUCTION
	CONCRETE MEDIAN CONSTRUCTION
	MILL & OVERLAY CONSTRUCTION
	OPEN LANES OF TRAFFIC

	PROPERTY AND EXISTING R/W LINE
	REQUIRED R/W LINE
	CONSTRUCTION LIMITS
	EASEMENT FOR CONSTR & MAINTENANCE OF SLOPES
	EASEMENT FOR CONSTR OF SLOPES
	EASEMENT FOR CONSTR OF DRIVES

	BEGIN LIMIT OF ACCESS.....BLA
	END LIMIT OF ACCESS.....ELA
	LIMIT OF ACCESS
	REQ'D R/W & LIMIT OF ACCESS
	ORANGE BARRIER FENCE
	ESA - ENV. SENSITIVE AREA (SEE ERIT 4-)

THOMAS & HUTTON
Engineering | Surveying | Planning | GIS | Consulting
50 Park of Commerce Way • PO Box 2727
Savannah, GA 31402-2727 • 912.234.5300
www.thomasandhutton.com
Charleston, SC | Columbia, SC | Myrtle Beach, SC
Savannah, GA | Wilmington, NC

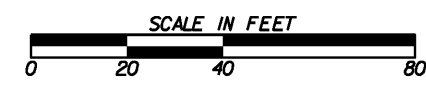

REVISION DATES	

CONSTRUCTION STAGING PLAN-STAGE 1			
DELESSEPS/LA ROCHE AVE FM			
WATERS AVE TO SKIDAWAY RD			
CHECKED:	DATE:	DRAWING No.	
BACKCHECKED:	DATE:	19-0013	
CORRECTED:	DATE:		
VERIFIED:	DATE:		