

KEYNOTES

- EXISTING SANITARY LINE AND ASSOCIATED PLUMBING FIXTURE PIPING TO REMAIN UNLESS SHOWN OTHERWISE. FIELD VERIFY EXACT LOCATION.
- CONNECT TO EXISTING WASTE LINE AS NOTED ON PLAN OF EQUAL OR LARGER SIZE. FIELD VERIFY SIZE, LOCATION, INVERT ELEVATION AND FLOW PREVENTION.
- 4" X 12" X 12" ABOVE SLAB LAUNDRY BASIN. COORDINATE WITH EQUIPMENT PROVIDER.
- ROUTE INDIRECT WASTE FROM NEW DRINK BAR EQUIPMENT TO EXISTING HUB DRAINS WITH AIR GAP.
- CONNECT TO EXISTING VENT LINE AS NOTED ON PLAN OF EQUAL OR LARGER SIZE. FIELD VERIFY SIZE, LOCATION, INVERT ELEVATION AND FLOW PREVENTION.

GENERAL NOTES

- ALL PLUMBING WORK SHALL BE PERFORMED IN STRICT ACCORDANCE WITH THE BASE BUILDING SPECIFICATION AND WITH THE LATEST EDITION OF THE PREVAILING STATE MECHANICAL/PLUMBING AND BUILDING CODES AS WELL AS ALL REGULATIONS THAT MAY APPLY. IN CASE OF CONFLICT BETWEEN THE CONTRACT DOCUMENTS AND A GOVERNING CODE OR ORDINANCE THE MORE STRINGENT STANDARD SHALL APPLY.
- INSTALL ALL REQUIRED CLEANOUTS TO CLEAR EQUIPMENT AND FIXTURES.
- SANITARY AND VENT PIPING SHALL BE SCHEDULE 40 PVC WITH INSTALLATION IN ACCORDANCE WITH ASTM D-232.1. ALL FITTINGS SHALL BE APPROVED SANITARY TYPE.
- ALL FIXTURES ARE PROVIDED WITH STANDARD TRAP AND CLEANOUT (NOT SHOWN).
- ALL WORK SHALL BE PROPERLY TESTED, BALANCED, CLEANED AND DISINFECTED. PROVIDE A ONE YEAR WARRANTY FROM DATE OF FINAL INSPECTION ON ALL PARTS AND LABOR.
- ALL WASTE PIPING 3"Ø AND SMALLER SHALL BE SLOPED AT 1/4" PER FOOT. PIPING LARGER THAN 3"Ø SHALL BE SLOPED AT 1/8" PER FT.
- REFER TO PLUMBING FIXTURE SCHEDULE FOR FIXTURE SPECIFICATIONS.
- UNDERFLOOR PLUMBING IS SHOWN SCHEMATICALLY FOR VIEWING PURPOSES ONLY. DURING INSTALLATION FIELD MODIFICATIONS TO ROUTING MAY BE REQUIRED.
- TERMINATE PLUMBING VENTS AT A MINIMUM OF 10 FEET FROM ALL AIR HANDLING EQUIPMENT INTAKE VENTS.
- CONTRACTOR SHALL VERIFY LOCAL CODE REQUIREMENTS FOR INDIRECT CONNECTIONS FOR FOOD PREP AREAS. CONNECTIONS SHALL BE PROVIDED WITH A MINIMUM 1" AIR GAP UNLESS REQUIRED OTHERWISE BY LOCAL HEALTH DEPARTMENT.
- CONDENSATE PIPING SHALL BE TYPE "L" HARD DRAWN SEAMLESS COPPER TUBE.
- CONTRACTOR SHALL PROVIDE 4" PVC SLEEVES THRU THE ROOF AS REQUIRED BY THE ROOF MOUNTED CONDENSING UNITS. REFER TO ARCHITECTURAL ROOF PLAN FOR THE LOCATIONS.
- CONTRACTOR SHALL PROVIDE AND INSTALL APPROPRIATE SLEEVES AND/OR CAULKING AT ALL PENETRATIONS TO ENSURE FIRE RATING IS MAINTAINED.
- NO PIPING SHOULD RUN EXPOSED IN FINISHED AREAS.
- PROVIDE ASSE 1072 BARRIER TYPE TRAP SEAL PROTECTION FOR ALL FLOOR DRAINS AND FLOOR SINKS EQUIVALENT TO SURE SEAL.
- DOMESTIC WATER SERVICE PIPE 4" AND SMALLER ABOVE SLAB SHALL BE TYPE "L" HARD DRAWN ASTM B88 COPPER TUBE.
- INSULATE ALL WATER PIPING EXCEPT EXPOSED TO FIXTURES WITH 1" FIBERGLASS INSULATION WITH NON-COMBUSTIBLE UL RATED VAPOR BARRIER OR CLOSED CELL FLEXIBLE INSULATION EQUAL TO ARMAFLEX II.
- RUN-OUT SIZES TO INDIVIDUAL PLUMBING FIXTURES TO BE EQUAL TO ROUGH-IN SIZE NOTED IN THE PLUMBING FIXTURE ROUGH-IN SCHEDULE.
- CONTRACTOR TO FURNISH AND INSTALL 3/8" FLEXIBLE S.S. BRAIDED WATER SUPPLY LINE FOR FINAL CONNECTION TO EQUIPMENT. FLEXIBLE SUPPLY LINE SHALL ALLOW 12" FLEXIBLE MOVEMENT OF EQUIPMENT.
- GAS PIPING SHALL BE SCHEDULE 40 BLACK STEEL PIPE WITH MALLEABLE IRON FITTINGS OR WELDED VALVES AND OTHER EQUIPMENT SHALL HAVE SCREWED JOINTS OR WELDED.
- TEST ALL LOW PRESSURE GAS PIPING FOR A PERIOD OF NOT LESS THAN TWO HOURS AT A PRESSURE OF NOT LESS THAN 60 PSIG. USING SOAP AND WATER OR SIMILAR MATERIALS AT ALL JOINTS WHEN LEAK TESTING. ALL EQUIPMENT MUST BE ISOLATED FROM THE GAS PIPING SYSTEM.
- PLUMBING PIPING IS SHOWN SCHEMATICALLY FOR VIEWING PURPOSES ONLY. DURING INSTALLATION FIELD MODIFICATIONS TO ROUTING MAY BE REQUIRED.
- ALL HORIZONTAL ROOF DRAINAGE PIPING SHALL BE SLOPED AT 1/2" PER FOOT MINIMUM, UNLESS NOTED OTHERWISE.

HFA
HARRISON FRENCH & ASSOCIATES, LTD.
 1705 S. Walton Blvd., Suite 3
 Bentonville, Arkansas 72712
 t 479.273.7780
 f 888.521.9685
 www.hfa-ae.com

STIPULATION FOR REUSE
 THIS DRAWING AND SPECIFICATIONS ARE THE PROPERTY OF HARRISON FRENCH & ASSOCIATES, LTD. (HFA) AND ARE TO BE USED ONLY FOR THE PROJECT AND SITE SPECIFICALLY IDENTIFIED HEREIN. ANY REUSE OF THIS DRAWING OR SPECIFICATIONS FOR ANY OTHER PROJECT WITHOUT THE WRITTEN PERMISSION OF HFA IS STRICTLY PROHIBITED. HFA SHALL BE NOTIFIED IN WRITING OF ANY SUCH REUSE. HFA SHALL BE RESPONSIBLE FOR THE PROTECTION OF THIS DRAWING AND SPECIFICATIONS FROM UNAUTHORIZED REUSE.

REMODEL
 STORE NUMBER: 417
 THIS DRAWING IS THE PROPERTY OF HARRISON FRENCH & ASSOCIATES, LTD.
 JOB NUMBER: 03-18-10417

ISSUE BLOCK

NO.	DATE	DESCRIPTION

CHECKED BY: JKR
 DRAWN BY: DNM
 DOCUMENT DATE: 02/05/21



DWV PLUMBING FLOOR PLANS
 SHEET: **P1.2**

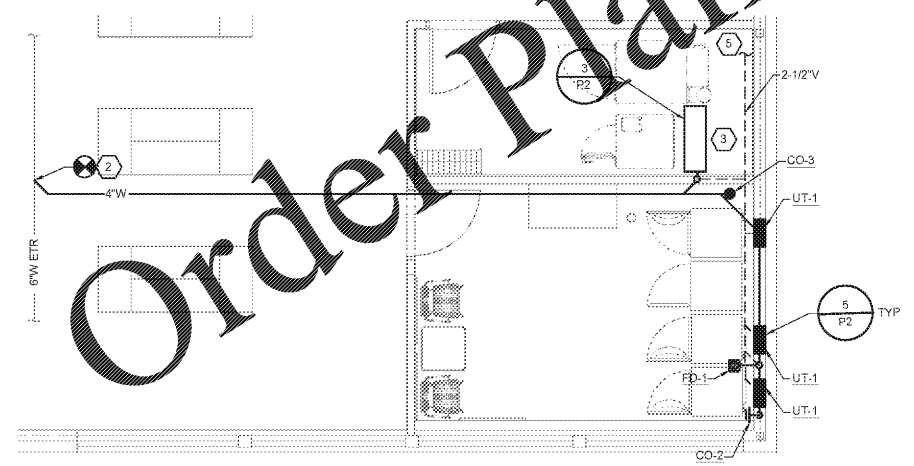

2 LAUNDRY ROOM WASTE AND VENT PLAN
 SCALE: 1/4" = 1'-0"

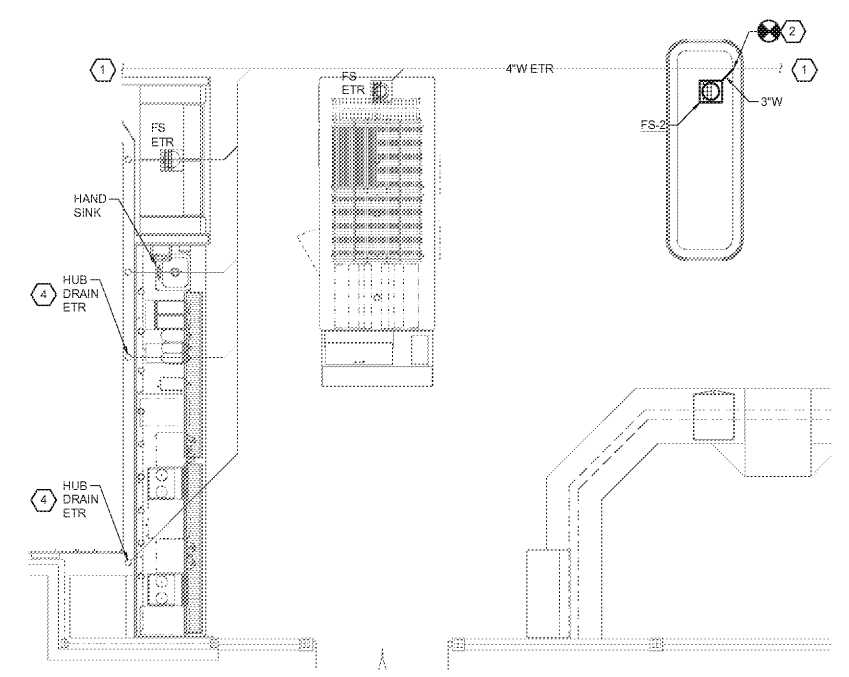

1 DRINK CENTER WASTE AND VENT PLAN
 SCALE: 1/4" = 1'-0"

EXISTING CONDITIONS WERE TAKEN FROM ORIGINAL DRAWINGS AND MAY NOT REFLECT EXACT "AS-BUILT" CONDITIONS. CONTRACTOR SHALL FIELD VERIFY ALL EXISTING CONDITIONS PRIOR TO SUBMITTING FINAL BIDS. CONTRACTOR SHALL CAREFULLY COORDINATE NEW WORK AND DEMOLITION WITH ALL OTHER DISCIPLINES AND EXISTING CONDITIONS.

EACH SUBCONTRACTOR IS RESPONSIBLE FOR HAVING A THOROUGH KNOWLEDGE OF ALL DRAWINGS AND SPECIFICATIONS IN THEIR RELATED FIELD. THE FAILURE TO ACQUAINT HIMSELF WITH THIS KNOWLEDGE DOES NOT RELIEVE THE RESPONSIBILITY OF PERFORMING HIS WORK PROPERLY. NO ADDITIONAL COMPENSATION SHALL BE ALLOWED BECAUSE OF CONDITIONS THAT OCCUR DUE TO FAILURE TO FAMILIARIZE WORKERS WITH THIS KNOWLEDGE.

P:\03_2021_3_Bldg_1\Rev\dwg\DWV PLUMBING FLOOR PLANS 417.dwg
 L:\030315-10417.dwg
 User: jkr
 Date: 02/05/21

Order Plans @ www.LDILine.com