

## GENERAL DEMOLITION NOTES

- THESE DEMOLITION PLANS ARE MEANT TO BE A CONVENIENCE TO THE CONTRACTOR. CONTRACTOR IS RESPONSIBLE FOR ALL DEMOLITION NECESSARY FOR INSTALLATION OF NEW WORK WHETHER SHOWN HERE OR NOT.
- DRAWINGS ARE BASED ON BUILDING PLANS PROVIDED BY OWNER AND UPON FIELD OBSERVATION.
- THE GENERAL CONTRACTOR SHALL FIELD VERIFY ALL DIMENSIONS AND CONDITIONS PRIOR TO THE DEMOLITION WORK. NOTIFY THE ARCHITECT OF ANY DISCREPANCIES PRIOR TO PROCEEDING.
- REMOVE ALL EXISTING CONSTRUCTION AND FINISHES NECESSARY FOR THE COMPLETION OF THE WORK AS DEPICTED ON THE DRAWINGS, INCLUDING BUT NOT LIMITED TO, ITEMS SHOWN ON THE PLANS WITH DASHED LINES. NECESSARY DISCONNECTS AND ALTERATIONS TO EXISTING MECHANICAL AND ELECTRICAL SYSTEMS SHALL BE INCLUDED. PATCH AS REQUIRED ALL CONSTRUCTIONS TO REMAIN IN ACCORDANCE WITH THE CONTRACT DRAWINGS. WHERE CONTRACTOR IS DESIGNATED TO MAKE REMOVALS, DISPOSITION OF MATERIALS IS THE RESPONSIBILITY OF THE CONTRACTOR. VERIFY WITH OWNER, THE DISPOSITION AND REMOVAL OF ANY COMPONENTS OF SALVAGEABLE VALUE.
- ALL REMOVALS AND SALVAGE, UNLESS SPECIFICALLY NOTED OR REQUESTED BY THE OWNER SHALL BECOME THE PROPERTY OF THE CONTRACTOR.
- CONTRACTOR IS RESPONSIBLE/REQUIRED TO INCORPORATE ANY WALL DUST, ETC. REDUCTION TECHNIQUES FEASIBLE TO MINIMIZE THE DISRUPTION OF EXISTING OCCUPANCY.
- AFTER REQUIRED DEMOLITION, PATCH/REPAIR EXISTING CEILING/WALL/FLOOR SURFACES AS NECESSARY TO RECREATE SCHEDULED NEW CONSTRUCTION/FINISH.
- PROTECT EXISTING CONSTRUCTION TO REMAIN TO PREVENT DAMAGE. REMOVE EXISTING CONSTRUCTION USING METHODS LEAST LIKELY TO DAMAGE ELEMENTS TO BE REMAINED OR ADJUSTED. DURING CONSTRUCTION, APPLY PROTECTIVE COVERING WHERE REQUIRED TO ENSURE PROTECTION FROM DAMAGE.
- EXISTING EXITS MUST BE MAINTAINED DURING CONSTRUCTION.
- REFER TO MECHANICAL, PLUMBING AND ELECTRICAL DRAWINGS FOR ADDITIONAL DEMOLITION REQUIREMENTS.

## DEMOLITION LEGEND

- DEMOLISH EXISTING PARTITION WALL
- ▨ EXISTING WALL TO REMAIN
- - - - - DEMOLISH EXISTING COMPONENT
- ⊗ DEMOLISH EXISTING PENDANT LIGHT FIXTURE
- ⊙ DEMOLISH EXISTING KEYLESS LAMP HOLDER
- DEMOLISH EXISTING RECESSED CAN LIGHT FIXTURE
- ▨ DEMOLISH EXISTING GYP BD CEILING, SOFFIT, OR BULKHEAD

## DEMOLITION KEY NOTES

A  
B



126 TICHENOR AVE  
AUBURN, AL 36830  
334.887.7010

IN ASSOCIATION WITH:

SEALS & SIGNATURES:

NOT RELEASED FOR CONSTRUCTION

REV	DESCRIPTION	DATE

101 N COLLEGE STREET

101 N. COLLEGE STREET  
AUBURN, AL 36830



Project No.: SNA Project #: 2021-04

Client Project No.: 210000X

Drawing Title:

DEMOLITION RCP

Date: 03/25/2021

Phase:

Designed: Designer

Drawing No.:

Drawn: Author

A1.1

Checked: Checker

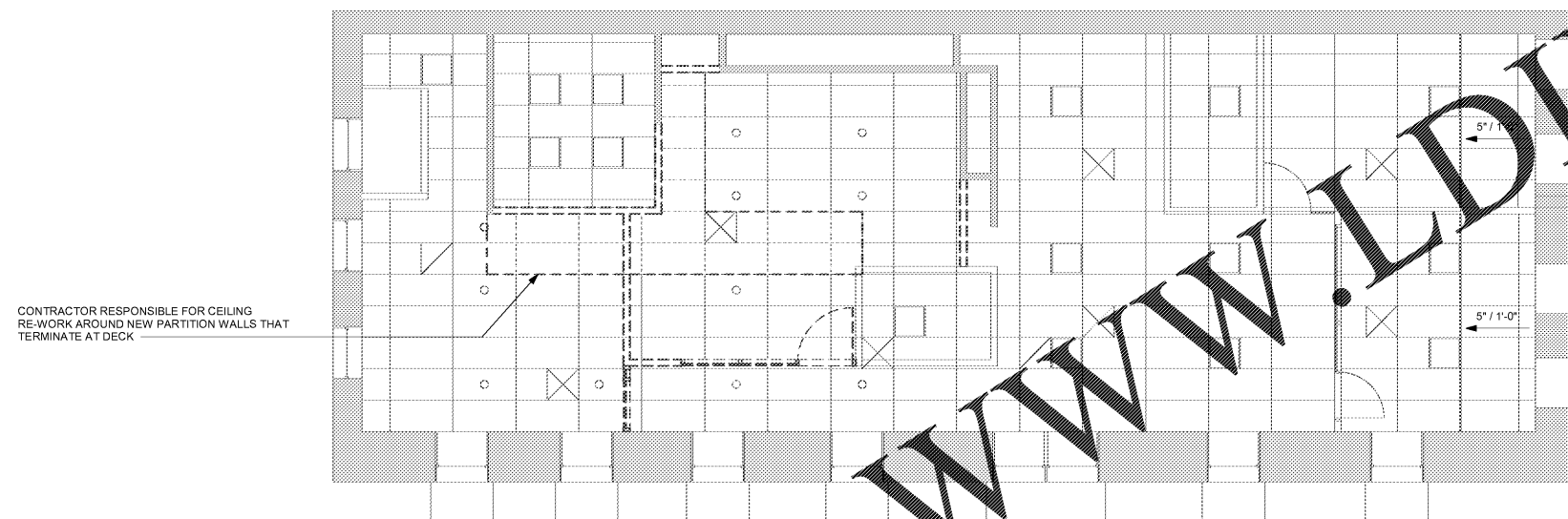

2 DEMOLITION RCP - 2ND FLOOR  
3/16" = 1'-0"

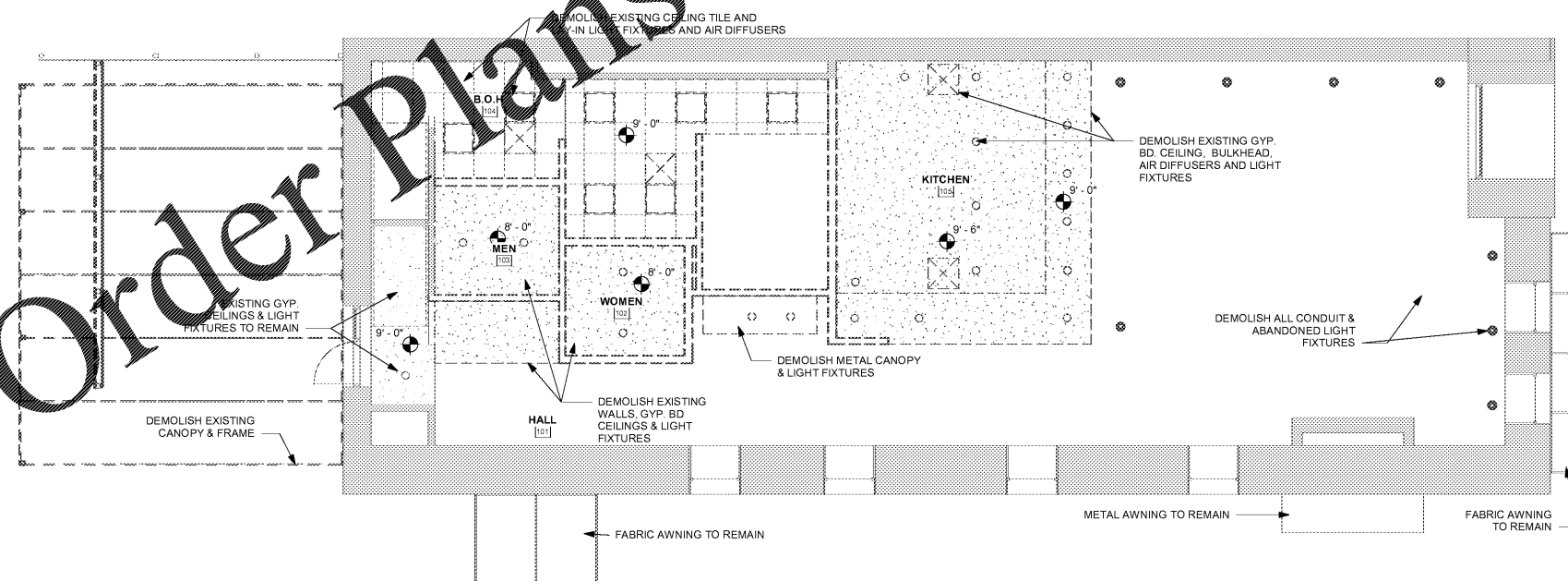

1 DEMOLITION RCP - 1ST FLOOR  
3/16" = 1'-0"