

FINISH PLAN KEYED NOTES

- 1 ALL SURFACES (TOP / BOTTOM / FRONT FACE) OF EXISTING SOFFIT ARE TO BE PAINTED P-1. ANY EXISTING HVAC VENTS WITHIN SOFFIT ARE TO BE CLEANED AND PAINTED P-1.
- 2 THE EXISTING GYP BOARD CEILING IS TO BE PAINTED P-1. ANY EXISTING HVAC VENTS WITHIN THE CEILING ARE TO BE CLEANED AND PAINTED P-1.
- 3 AS NOTED ON THE DEMOLITION PLAN THE EXISTING MULTI-COLORED TILE ON THE BATHROOM WALLS ARE TO BE REMOVED. DO NOT REMOVE ALL OF THE SUBWAY TILE ON THE WALL. THE CONTRACTOR IS TO PATCH IN NEW SUBWAY TILE TO MATCH THE EXISTING SIZE / COLOR.
- 4 THE EXISTING WOOD CEILING ABOVE IS TO REMAIN. DO NOT MODIFY.
- 5 INSTALL FRP ON INTERIOR SIDE OF NEW FRAMED WALL AT THIS LOCATION.

ARCHITECT:
JSO
 JOHN S. ODUM, ARCHITECT
 P.O. BOX 410384
 SAINT LOUIS, MISSOURI 63141
 PH: 1-417-243-2852
 WWW.JOHNSODUM.COM
 E-MAIL: JOHN@JOHNSODUM.COM
 CONTACT: JOHN S. ODUM

PROJECT:
 TENANT MODIFICATIONS FOR:
SLIM CHICKENS
 Life Changing Chicken
 4311 WASHINGTON ROAD
 EVANS, GEORGIA 30809

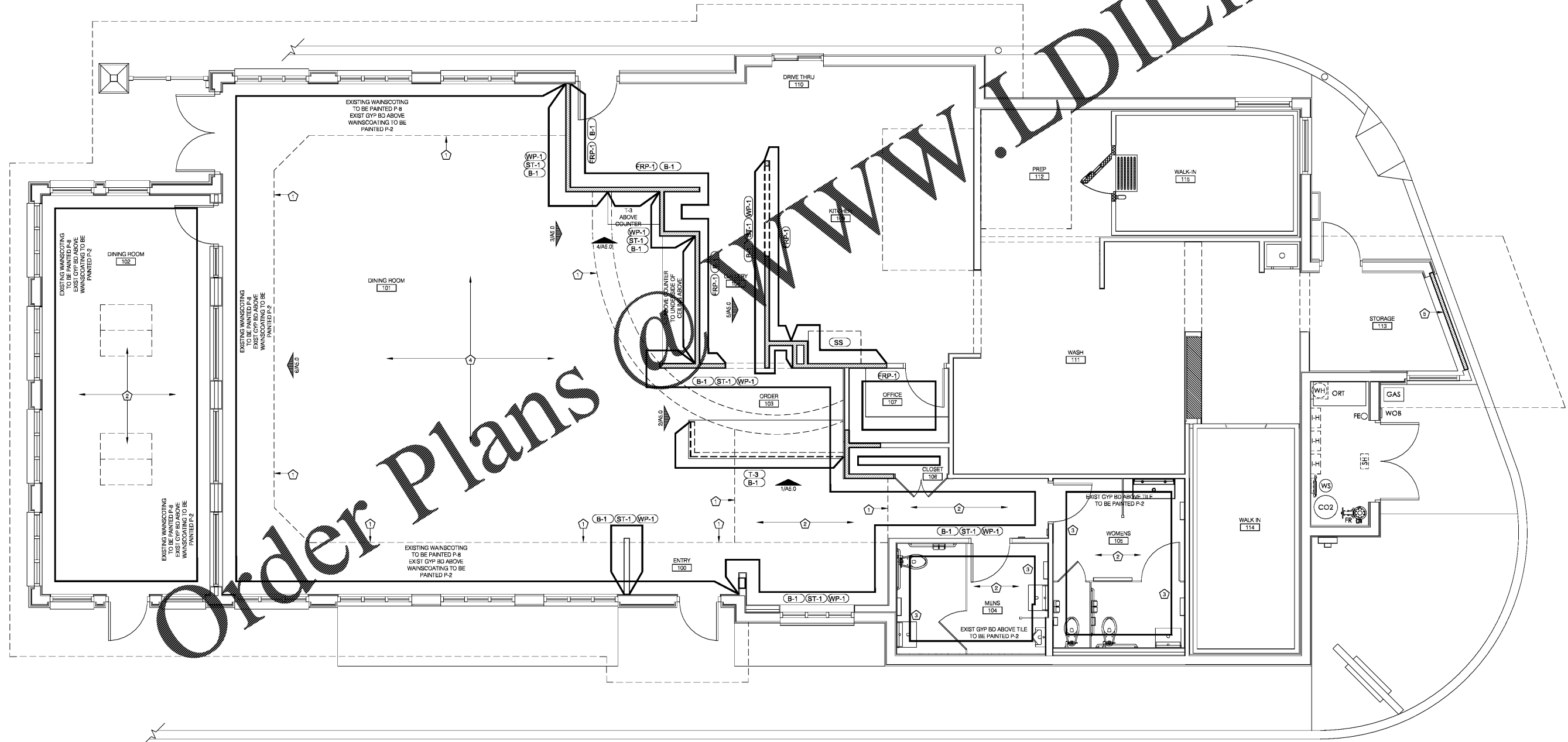

Order Plans



JOHN S. ODUM, ARCHITECT
 GEORGIA LICENSE NUMBER:
 RA014022
 THIS SEAL IS FOR ARCHITECTURAL
 INFORMATION ONLY

SPECIAL NOTICES
 In the event the client consents to allow, authorize or approve or changes to any plans, specifications or other construction documents, and these changes are not approved in writing by the design professional, the client agrees to release the design professional from any liability arising from the construction, use or result of such changes. In addition, the client agrees to the fullest extent permitted by law to indemnify and hold the design professional harmless from any and all claims, damages, including their legal expenses, caused by or for the work of design professional. All rights reserved. No part of this drawing may be reproduced by photocopying or by any other means, or stored, transmitted, or transmitted to any computer or other system without the prior written permission of the Architect.

Drawn: JSD Date: 09/28/21

A4.0
 FINISH PLAN