

DEMOLITION PLAN KEYNOTES

- 11 THE EXISTING NON-LOAD BEARING WALL AT THIS LOCATION IS TO BE REMOVED IN ITS ENTIRETY. SEE THE REVISED FLOOR PLAN FOR NEW WALL LOCATIONS. THE CONTRACTOR IS TO REMOVE THE BUILT-UP CONCRETE WALL CURB.
- 12 THE EXISTING LOAD BEARING EXTERIOR WALL AT THIS LOCATION IS TO BE REMOVED AS SHOWN FOR A NEW EXTERIOR DOOR LOCATION. INSTALL (3) 2X12 HEADERS AT THIS LOCATION FOR NEW OPENING.
- 13 THE EXISTING GYP BOARD CEILING SOFFIT IS TO BE REMOVED IF THE CONTRACTOR FINDS THESE CONDITIONS TO BE PRESENT: 1. ENOUGH OF THE GYP BOARD SOFFIT / STUD FRAMING CAN REMOVED THAT THE NEW ACCUSTICAL CEILING TRACK / TILE CAN BE INSTALLED AS SHOWN ON THE REFLECTED CEILING (CHECK EXISTING CEILING HEIGHT OF SOFFIT AGAINST THE EXISTING ACCUSTICAL CEILING IN THE KITCHEN). 2. THE EXISTING DUCT WORK WITHIN THE SOFFIT WILL NOT BE BELOW THE LINE OF THE NEW KITCHEN ACCUSTICAL CEILING TILE / TRACK.
- 14 THE EXISTING PLUMBING FIXTURE / SUPPLY / WASTE LINES ARE TO BE REMOVED FROM THIS LOCATION.
- 15 THE EXISTING MILLWORK / COUNTER IS TO BE REMOVED FROM THIS LOCATION. SEE THE REVISED FLOOR PLAN FOR NEW COUNTER LOCATIONS.
- 16 THE EXISTING NON-LOAD BEARING WALL AT THIS LOCATION IS TO BE REMOVED / REFRAMED PER THE REVISED FLOOR PLAN W/ STEEL STUDS FOR THE INSTALLATION OF A NEW HOOD. SEE THE MECHANICAL DRAWINGS FOR NEW HOOD LOCATION.
- 17 THE EXISTING DRIVE THRU WINDOW / ALUMINUM FRAMES ARE TO BE REMOVED FROM THIS LOCATION.
- 18 THE EXISTING INTERIOR THIN BRICK VENEER IS TO BE REMOVED FROM THIS LOCATION.
- 19 THE EXISTING MULTICOLORED TILE ON THE BATHROOM WALLS ARE TO BE REMOVED. DO NOT REMOVE ALL OF THE SUBWAY TILE ON THE WALL. THE CONTRACTOR IS TO PATCH IN NEW SUBWAY TILE TO MATCH THE EXISTING SIZE / COLOR.
- 20 THE EXISTING HOOD(S) ARE TO REMAIN IN PLACE AND BE REUSED. THE CONTRACTOR IS TO CONTACT CAPTAIN'S LOON FERRIS (404) 501.300.8460 TO DETERMINE A FULL SCOPE OF WORK TO REUSE THE EXISTING HOODS W/ THE NEW EQUIPMENT LAYOUT.
- 21 THE EXISTING DINING ROOM FURNITURE IS TO BE REMOVED / REFINISHED / REINSTALLED. THE CONTRACTOR IS TO COORDINATE THE REMOVAL / REINSTALLATION WITH THE OWNER.
- 22 THE EXISTING CULTURED STONE VENEER ON THE EXTERIOR WALL IS TO BE REMOVED IN ITS ENTIRETY. SEE THE REVISED EXTERIOR ELEVATIONS FOR NEW FINISHES.
- 23 THE CONTRACTOR IS TO REMOVE ANY DAMAGED FLOORING IN THE EXISTING DINING ROOM. SEE THE REVISED FINISH FLOOR PLAN FOR EXISTING FLOORING SPECIFICATION.
- 24 THE CONTRACTOR IS TO REMOVE THE EXISTING HALF-HIGH WALLS IN THE CENTER OF THE DINING ROOM. PILE IN FLOORING BELOW AS NEEDED.
- 25 REMOVE THE EXISTING WINDOW FROM THE CLEAR STORY ABOVE AT THIS LOCATION FOR NEW EXTERIOR SIGNAGE. SEE THE REVISED EXTERIOR ELEVATIONS. INFILL WINDOW OPENINGS W/ EXTERIOR MATERIALS AS SHOWN ON THE EXTERIOR ELEVATIONS.

ARCHITECT:
JSO
 JOHN S. ODOM, ARCHITECT
 P.O. BOX 410384
 SAINT LOUIS, MISSOURI 63141
 PH: 1-417-243-2852
 WWW.JOHNSODOM.COM
 E-MAIL: JOHN@JOHNSODOM.COM
 CONTACT: JOHN S. ODOM

PROJECT:
 TENANT MODIFICATIONS FOR:
SLIM CHICKENS
 4311 WASHINGTON ROAD
 EVANS, GEORGIA 30809

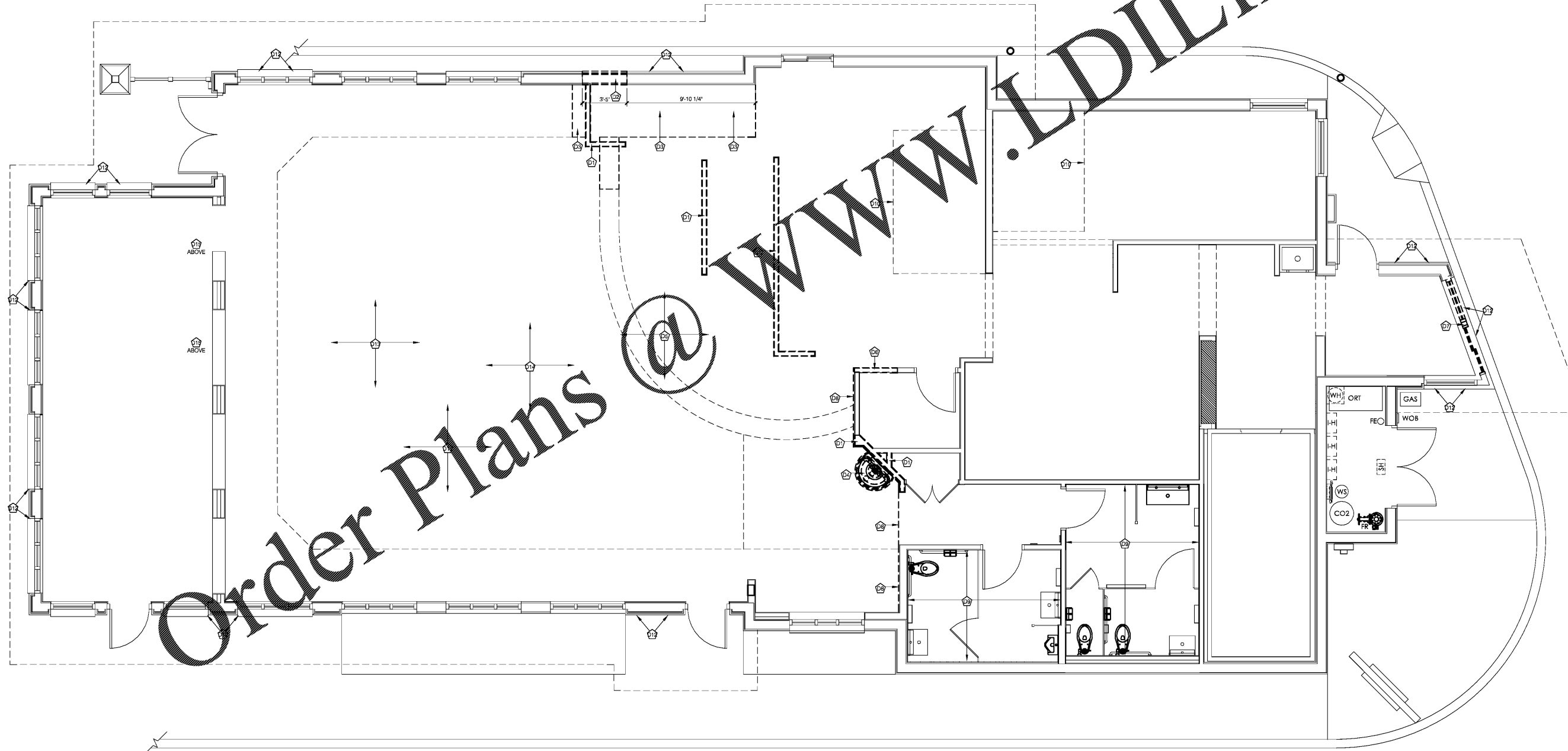

Order Plans @ WWW.LDILine.com



JOHN S. ODOM, ARCHITECT
 GEORGIA LICENSE NUMBER:
 RA014022
 THIS SEAL IS FOR ARCHITECTURAL INFORMATION ONLY

SPECIAL NOTICES
 In the event the client consents to allow, authorize or approve of changes to any plans, specifications or other construction documents, and these changes are not approved in writing by the design professional, the client agrees to release the design professional from any liability arising from the construction, use or result of such changes. In addition, the client agrees to the fullest extent permitted by law to indemnify and hold the design professional harmless from any and all claims, damages, losses, suits, actions, costs and costs of defense, including their own expenses. Copyright © 2021 by John S. Odom, Inc. All rights reserved. No part of this drawing may be reproduced by photocopy or by any other means, or stored, transmitted, or represented in any computer or other systems without the prior written permission of the Architect.

Drawn: JSO Date: 03/28/21