

REVISIONS			
REV #	DATE	APRVD BY	REVISION
1	03/17/21	NDH	ISSUE FOR PERMIT

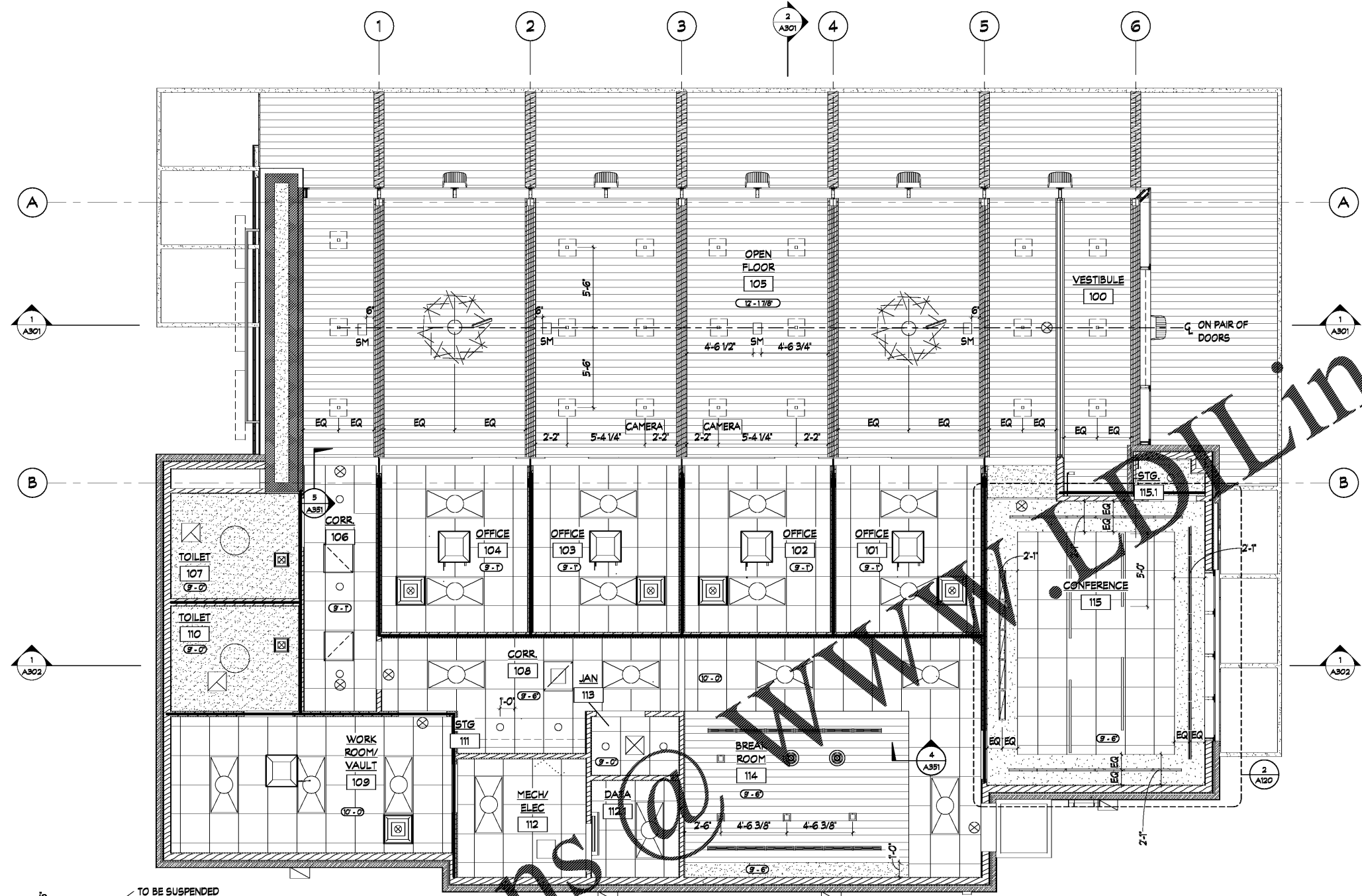

- WALL LEGEND:**
- TERMINATE WALL 6" ABOVE CEILING
 - ACOUSTICAL WALL TO EXTEND TO UNDERSIDE OF DECK

- CEILING LEGEND:**
- ACOUSTICAL CEILING PANEL (ACP-1)
 - CUSTOM BOARD CEILING
 - CMC-1 CEILING
 - ROUND RECESSED FIXTURE
 - SQUARE RECESSED FIXTURE
 - EMERGENCY FIXTURE
 - EXIT LIGHT
 - DECORATIVE PENDANT LIGHT
 - LINEAR PENDANT LIGHT
 - OPEN FLOOR SMALL PENDANT LIGHT
 - FLUSH MOUNT DRUM SHADE
 - OPEN FLOOR CHANDELIER
 - MECHANICAL SUPPLY AIR DEVICE
 - MECHANICAL RETURN AIR DEVICE
 - EXHAUST
 - CEILING ACCESS PANEL
 - LINEAR DIFFUSER
 - SOUND MASKING SPEAKER MOUNTED TO DECK; CONCEALED FROM VIEW

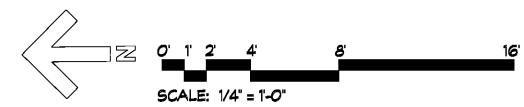

ADDITIVE ALTERNATIVES

ADDITIVE ALTERNATE PROVIDE GEOMETRIC ACOUSTICAL CEILING PANELS (ACP-2) IN LIEU OF ACP-1 IN CONFERENCE RM 115. REFER TO MECH SECTION 051000

- ACP-2 MANUFACTURER: ARMSTRONG
PRODUCT: LANDSCAPE; INDIVIDUALLY SUSPENDED PANELS
SERIES - 60 DEGREES; 7/8" THICK PANELS
DRYWALL HANGING ACCESSORIES TO BE INCLUDED
- A - TRIANGLE (710101); DIMENSIONS: 3'-3" X 3'-9"
CUSTOM COLOR: TO MATCH SHERWIN WILLIAMS 6748 GREENS
 - B - TRAPEZOID (7101201); DIMENSIONS: 3'-4" X 7'-9.5"
STANDARD COLOR: STONE (SE)
 - C - PARALLELOGRAM (710101); DIMENSIONS: 3'-4" X 5'-9"
CUSTOM COLOR: TO MATCH SHERWIN WILLIAMS 6692 ATTIC
 - D - PARALLELOGRAM (710101); DIMENSIONS: 3'-4" X 5'-9"
CUSTOM COLOR: TO MATCH SHERWIN WILLIAMS 6099 SADDLE UP
 - E - TRIANGLE (710101); DIMENSIONS: 3'-3" X 3'-9"
STANDARD COLOR: WHITE
 - F - TRAPEZOID (7101201); DIMENSIONS: 3'-4" X 7'-9.5"
STANDARD COLOR: BLACK (BK)
 - G - PARALLELOGRAM (710101); DIMENSIONS: 3'-4" X 5'-9"
CUSTOM COLOR: TO MATCH SHERWIN WILLIAMS 6748 GREENS
 - H - TRIANGLE (710101); DIMENSIONS: 3'-3" X 3'-9"
CUSTOM COLOR: TO MATCH SHERWIN WILLIAMS 6099 SADDLE UP

1 REFLECTED CEILING PLAN
SCALE: 1/4" = 1'-0"

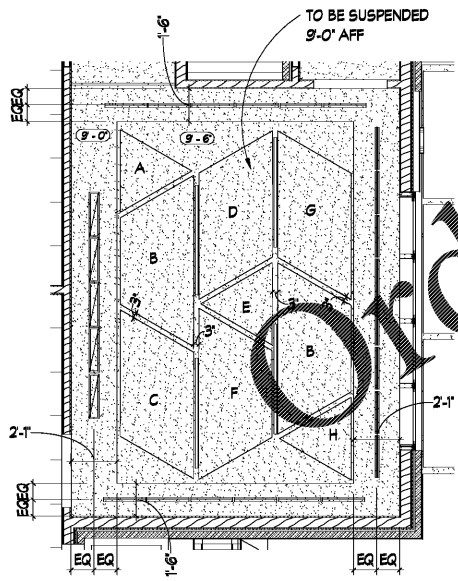

2 ADD ALT CEILING AT CONFERENCE ROOM
SCALE: 1/4" = 1'-0"