

1 TYPICAL EAVE DETAIL - BASE BID  
A6.1 SCALE: 3" = 1'-0"

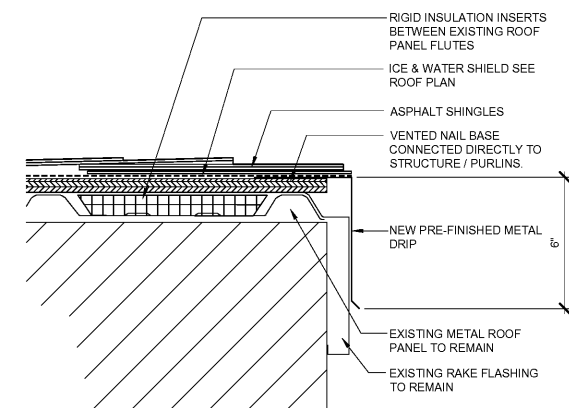

2 TYPICAL RAKE DETAIL - BASE BID  
A6.1 SCALE: 3" = 1'-0"

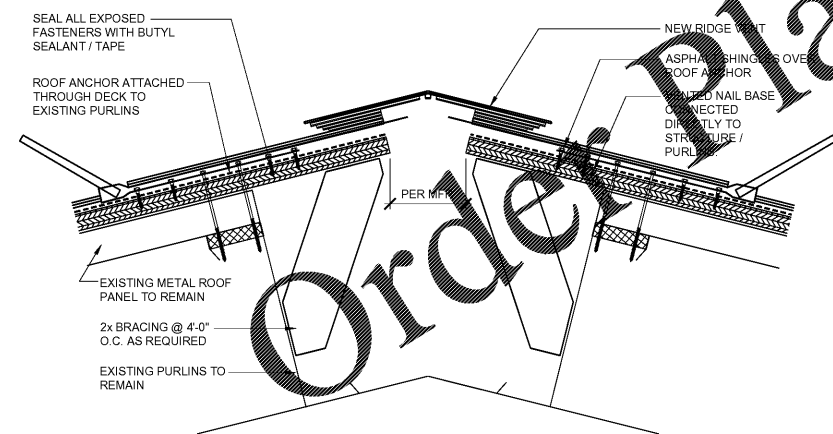

3 TYPICAL RAKE DETAIL - BASE BID  
A6.1 SCALE: 3" = 1'-0"

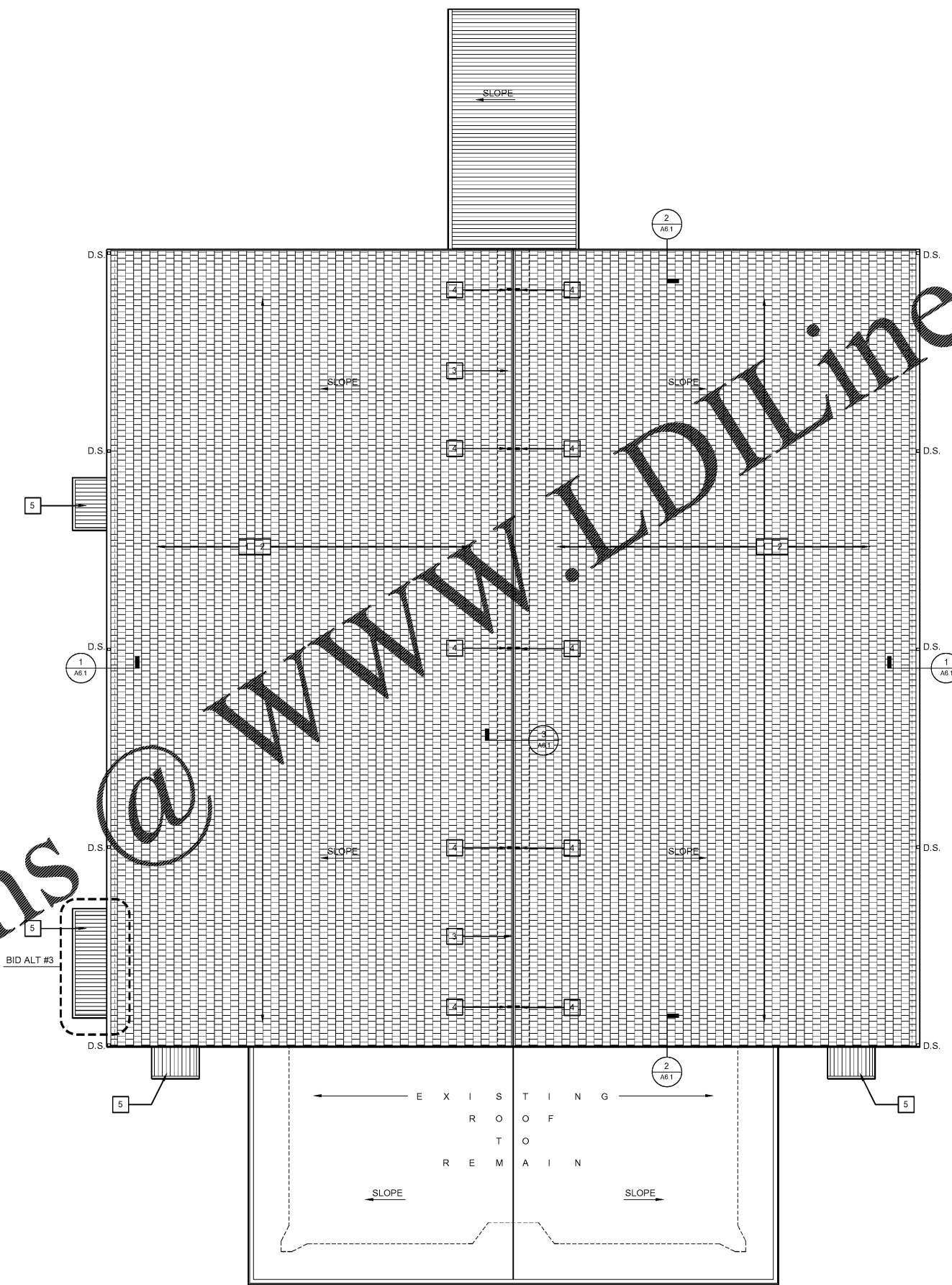

ROOF PLAN  
SCALE: 1/8" = 1'-0"

GENERAL ROOF NOTES

1. THE PROPOSED WORK CONSISTS OF FURNISHING ALL PLANT, LABOR, MATERIALS, TOOLS AND EQUIPMENT AND PERFORMING ALL OPERATIONS IN STRICT ACCORDANCE WITH THESE PLANS AND SPECIFICATIONS NECESSARY FOR COATING THE EXISTING ROOF UNDER BASE BID, OVER LAYING EXISTING ROOF UNDER ALTERNATE. ALL WORK SHALL CONSTITUTE A COMPLETE AND FUNCTIONAL ROOF SYSTEM AS REQUIRED AND SPECIFIED.
2. THE LISTED WORK SHALL BE PERFORMED PURSUANT TO APPLICABLE FEDERAL, STATE AND LOCAL REGULATION GUIDELINES, AND MANUFACTURERS RECOMMENDATIONS AND PERFORMED IN A NEAT AND SKILLED MANNER WITH THE SITE LEFT FREE OF ALL DEBRIS. IT IS THE CONTRACTORS RESPONSIBILITY TO OBTAIN ALL APPLICABLE PERMITS. THE INFORMATION IS FOR THE REQUIREMENT OF CONSTRUCTION AND MAY NOT BE INCLUSIVE OF ALL FEDERAL, STATE AND LOCAL REGULATIONS. THE CONTRACTOR WILL BE REQUIRED TO COMPLY WITH ALL REGULATIONS, WHETHER STATED OR IMPLIED.
3. SEE MECHANICAL, PLUMBING, ELECTRICAL AND STRUCTURAL SHEETS FOR LOCATION OF THE COORDINATION OF RESPECTIVE WORK. IN CASE OF A CONFLICT, NOTIFY ARCHITECT.
4. COORDINATE EF AND VTR QUANTITIES WITH MPE DWGS.
5. EF AND VTR PENETRATIONS SHALL BE A MINIMUM OF 4'-0" FROM THE EDGE OF ROOF, RAKE, DROPS, AND OTHER PERMANENT ITEMS - UNO.
6. PROVIDE ALL COMPONENTS FOR A COMPLETE ROOF SYSTEM AND FLASHING WHEN IF NOT SPECIFICALLY NOTED TO PROVIDE COMPLETE AND TIGHT CONDITION.
7. ALL CONTINUOUS MTL. CLEATS AND/OR REVERSE MTL. CLEATS SHALL BE MIN. GAUGE HEAVIER THAN SPECIFIED THICKNESS OF MTL. FLASHING.
8. ALL ROOFING AND SHEET MTL. FLASHING WORK SHALL BE DONE IN ACCORDANCE WITH ALL CURRENT PRACTICES OF SMACNA AND NRCA.
9. REFER TO MECHANICAL DRAWINGS FOR LOCATIONS OF INTAKE AND EXHAUST LOUVERS/ FANS FOR VENTILATION OF ATTIC SPACE.
10. PROVIDE ALL MATERIALS AND LABOR REQUIRED FOR INSTALLATION OF A WEATHERTIGHT/ BONDED ROOF WHETHER SPECIFICALLY INDICATED BY THE DRAWINGS OF SPECIFICATIONS OR NOT.
11. SEE MECHANICAL, PLUMBING AND ELECTRICAL DRAWINGS FOR ADDITIONAL INFORMATION REGARDING ROOF TOP MOUNTED EQUIPMENT. ROOFING CONTRACTOR TO COORDINATE ROOFING WORK WITH ALL TRADES TO PROVIDE NECESSARY MATERIALS TO FLASH ALL ROOF PENETRATIONS WHETHER SPECIFICALLY SHOWN ON ROOF PLAN OR REQUIRED BY OTHER DOCUMENTS DEFINING THE WORK OF THIS CONTRACT. FLASHING OF ALL PENETRATIONS SHALL BE AS RECOMMENDED BY THE ROOF MANUFACTURER TO MEET THE REQUIREMENTS FOR A BONDED ROOF.
12. FLASHING OF ALL PENETRATIONS SHALL BE AS RECOMMENDED BY THE ROOF MANUFACTURER TO MEET THE REQUIREMENTS FOR A BONDED ROOF, AS SHOWN ON THE ROOF PLAN, AND/OR AS REQUIRED BY OTHERS DOCUMENTS DEFINING THE WORK OF THIS CONTRACT.
13. ALL INCIDENTAL WOOD BLOCKING SHALL BE PRESSURE TREATED MATERIAL AS DEFINED BY THE SPECIFICATIONS. COORDINATE WITH ROOF MANUFACTURER TO INSURE COMPATIBILITY WITH THE ROOFING SYSTEM.
14. NEW MATERIALS SHALL BE DISBURSED ON EXISTING ROOF TO AVOID OVERLOAD OF EXISTING STRUCTURE. G.C. SHALL PROTECT EXISTING BUILDING COMPONENTS AND WILL BE RESPONSIBLE TO REPAIR/RESTORE ANY DAMAGES INCURRED DURING NEW CONSTRUCTION.
15. ALL ABANDONED ROOF PENETRATING DEVICES/ PIPES/ VENTS/ CONDUITS/ ETC. TO BE CUT OFF BELOW ROOF DECK. PATCH/ INFILL/ MATCH EXISTING ADJACENT CONSTRUCTION.
16. PROVIDE MOISTURE PROTECTIONS FOR EXPOSED OPENINGS THROUGH ROOF TO SPACES BELOW DURING WORK.
17. G.C. TO REMOVE ALL DEBRIS, CONSTRUCTION MATERIALS, ETC. AFTER ALL ROOF WORK COMPLETED.
18. CONTRACTOR SHALL BE RESPONSIBLE FOR THE PATCH AND REPAIR OF EXISTING TO REMAIN BUILDING COMPONENTS TO INCLUDE OR ASSOCIATED WITH, BUT NOT LIMITED TO EXTERIOR WALL FINISHES, ROOF, TRIM, LOUVERS, GUTTERS, EQUIPMENT SUPPORTS, ETC. DAMAGE BY THE CONTRACTOR OR HIS SUBS DURING THE PROCESS OF THE WORK. THE CONTRACTOR AND HIS SUBCONTRACTORS SHALL BECOME FULLY AWARE OF THE SCOPE OF DEMOLITION AND ITS EFFECT ON BUILDING SYSTEMS TO REMAIN OR TO BE CONSTRUCTED SO AS TO ANTICIPATE ANY PATCHING OR REPAIR REQUIRED TO COMPLETE THE PROJECT AS OUTLINED IN THE CONSTRUCTION DOCUMENTS.
19. FURNISH AND INSTALL NEW HIGH TEMP ICE AND WATER SHIELD IN ACCORDANCE WITH THE FOLLOWING:
  - 3'-0" AT ALL EAVE EDGES
  - 3'-0" AT BOTH SIDES OF RIDGE
  - 3'-0" AT ALL RAKE EDGES
  - 3'-0" AT ALL VALLEYS - 1'-6" EACH SIDE

WORK SCHEDULE- ROOF

1. UNDER BASE BID - FURNISH AND INSTALL NEW ASPHALT SHINGLE OVERLAY ROOF SYSTEM OVER EXISTING STANDING SEAM METAL ROOF. REFER TO DETAILS
2. UNDER ALTERNATE - FURNISH AND INSTALL NEW STANDING SEAM OVERLAY ROOF SYSTEM OVER EXISTING STANDING SEAM METAL ROOF SYSTEM. REFER TO DETAILS
3. UNDER BASE BID - REMOVE EXISTING RIDGE CAP AND ANY ASSOCIATED ROOF ACCESSORIES AS REQUIRED, FURNISH AND INSTALL NEW ASPHALT SHINGLE RIDGE CAP. REFER TO DETAILS AND SPECS.
4. FURNISH AND INSTALL NEW ROOF ANCHOR. CONTRACTOR TO ENSURE ANCHORS ARE ATTACHED THROUGH THE EXISTING PURLINS FOR PROPER SECUREMENT. SEE SPECS.
5. FURNISH AND INSTALL NEW PRE-FINISHED ALUMINUM CANOPY SYSTEM.



Facilities Management  
1161 West Samford Avenue  
Auburn University, AL 36849  
Phone: (334) 844-4810  
Fax: (334) 844-9458  
Safety is our first priority.  
Think Safety. Act Safely.

No.	Revision	Date
-	-	00/00/00

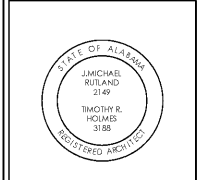

JMR-H Architecture, PC  
446 Geneva Avenue  
Montgomery, AL 36104  
Phone: (334) 420-5672  
Fax: (334) 420-5692  
JMR-H Project Number: 19-968  
Drawn By: DT

Auburn University Building  
Ham Wilson Arena Renovations  
Project Number 19-451

SHEET TITLE:  
ROOF PLAN

DRAWN BY:  
DT  
CHECKED BY:  
J. CAHILL  
DATE:  
JANUARY 21, 2021  
FILE NUMBER:  
-  
PROJECT NUMBER:  
19-451  
SHEET NUMBER:

A6.1  
30 of 61