

Facilities Management
 1161 West Samford Avenue
 Auburn University, AL 36849
 Phone: (334) 844-4810
 Fax: (334) 844-9458
*Safety is our first priority.
 Think Safety. Act Safely.*

| No. | Revision | Date |
|-----|----------|----------|
| - | - | 00/00/00 |
| | | |
| | | |
| | | |
| | | |
| | | |
| | | |
| | | |

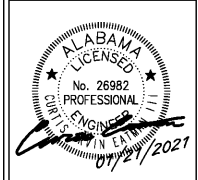

JMR+H
 Architecture, P.C.
 440 Geneva Avenue
 Montgomery, AL 36104
 Phone: (334) 420-5672
 Fax: (334) 420-5692
 JMR+H Project Number: 19-968
 Drawn By: DT

**Auburn University Building
 Ham Wilson Arena Renovations
 Project Number 19-451**

SHEET TITLE:
 EROSION CONTROL
 PLAN

DRAWN BY:
 WLH
 CHECKED BY:
 CLT
 DATE:
 JANUARY 21, 2021
 FILE NUMBER:
 -
 PROJECT NUMBER:
 19-451
 SHEET NUMBER:

C4.0

Order Plans @ www.WLDLine.com

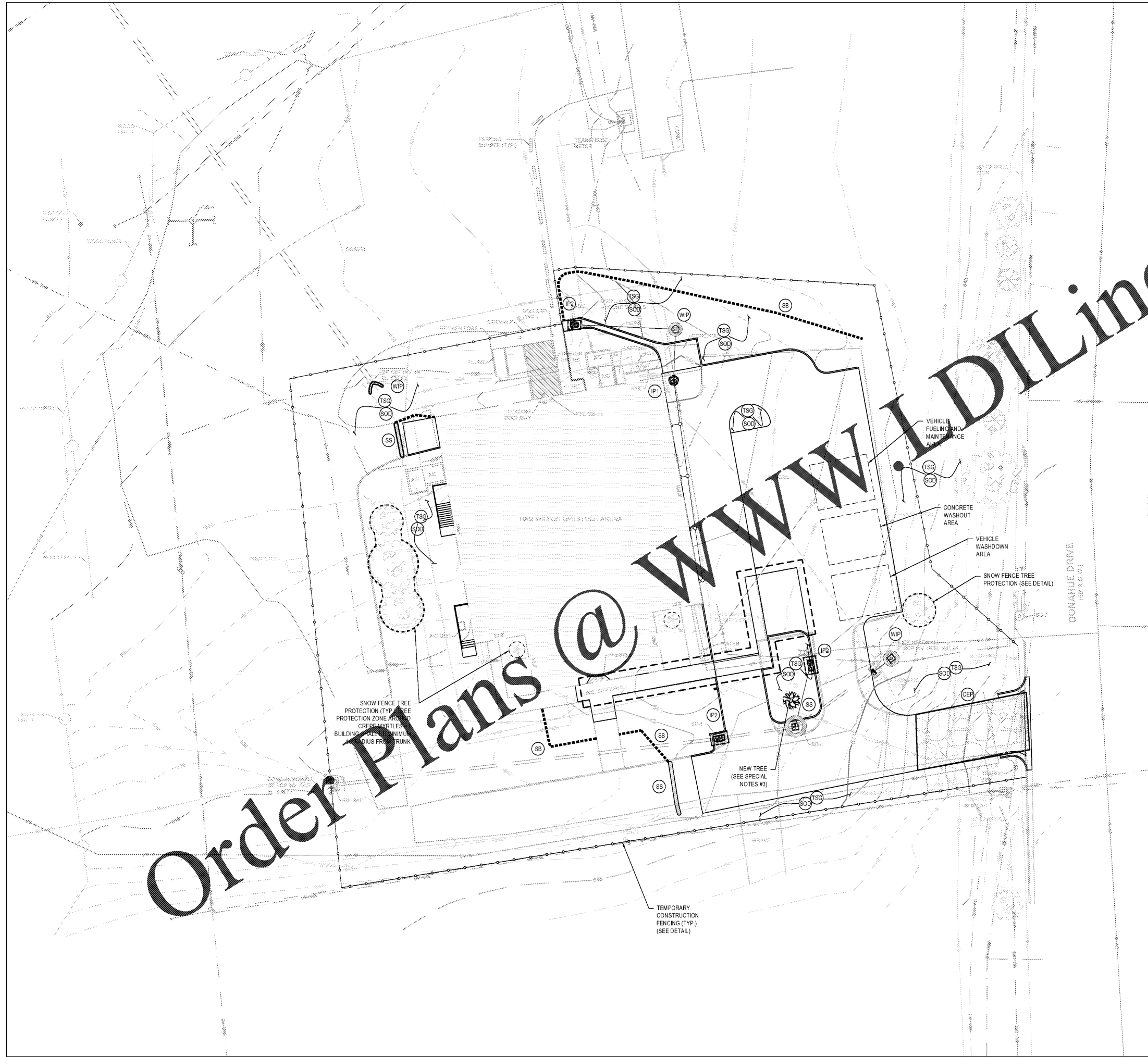

- SPECIAL NOTES:**
1. ALL DISTURBED AREAS NOT PROPOSED TO BE PAVED SHALL RECEIVE 4" OF TOP SOIL AND ROLLED TIFFANY 419 ROLLED BERMUDA SOD. CONTRACTOR TO FERTILIZE AND IRRIGATE UNTIL SOD IS ESTABLISHED. SEE SHEET C0.0 FOR APPLICABLE GENERAL EROSION CONTROL NOTES.
 2. REPLACE EXISTING TREE IN LANDSCAPE ISLAND IN LIKE KIND TO EXISTING.

EROSION CONTROL LEGEND

| | | |
|--|-----|-----------------------------|
| | SS | SILT SOXX |
| | WIP | WATTLE INLET PROTECTION |
| | SB | SILT FENCE |
| | IP1 | SILT SAVER INLET PROTECTION |
| | IP2 | DANDY SACK INLET PROTECTION |
| | CEP | CONSTRUCTION EXIT PAD |

