

UNIT MIX TABULATION											
UNIT SIZES	5 x 5	5 x 10	5 x 15	10 x 10	10 x 15	10 x 20	10 x 25	10 x 30			
S.F. PER INDIV. UNIT	25	50	75	100	150	200	250	300			
EXISTING - FIRST FLOOR									72,180	GROSS S.F.	
UNIT QUANTITY	-	-	-	-	-	-	-	-	TOTAL UNITS		
TOTAL S.F.	-	-	-	-	-	-	-	-	NET RENTABLE		
ADDITION - FIRST FLOOR									10,752	GROSS S.F.	
UNIT QUANTITY	1	5	2	28*	12	11	-	-	TOTAL UNITS		
TOTAL S.F.	24	249	148	2,794	1,770	2,173	-	-	NET RENTABLE		
ADDITION - SECOND FLOOR									10,752	GROSS S.F.	
UNIT QUANTITY	3	23	6	27	21	-	-	-	TOTAL UNITS		
TOTAL S.F.	71	1,119	437	2,627	3,111	-	-	-	NET RENTABLE		
ADDITION - TOTAL									21,504	GROSS S.F.	
UNIT QUANTITY	4	28	9	55	33	11	-	-	TOTAL UNITS		
TOTAL S.F.	95	1,368	585	5,421	4,881	2,173	-	-	NET RENTABLE		
ACCESSIBLE	5% FOR FIRST 200 UNITS + 2% FOR REMAINING										
UNIT QUANTITY	1	2	1	3	2	1	-	-	TOTAL UNITS		

\* INCLUDES 5 NEW UNITS IN THE EXISTING BUILDING

INTERIOR WALL & CEILING FINISHES FLAME SPREAD TABLE (SPRINKLERED)			
OCCUPANCY GROUP:	EXIT ENCLOSURES & EXIT PASSAGEWAYS	CORRIDORS	ROOMS / ENCL. SPACES
S (OFFICE)	CLASS C	CLASS C	CLASS C
B (BUSINESS)	CLASS B	CLASS C	CLASS C

WALL & CEILING FINISH RATINGS  
 CLASS A: FLAME SPREAD 0-25, SMOKE DEVELOPED 0-450.  
 CLASS B: FLAME SPREAD 26-75, SMOKE DEVELOPED 0-450.  
 CLASS C: FLAME SPREAD 76-200, SMOKE DEVELOPED 0-450.

ROOM MATERIAL / FINISH SCHEDULE														
NO.	ROOM NAME	FLOOR		WALLS								CEILING		REMARKS
		FLR.	BASE	WEST	NORTH	EAST	SOUTH	MATERIAL	FIN.	MATERIAL	FIN.			
100	LOBBY	CONC.	SEAL	CMU	FL.	EXISTING CMU	FL.	MTL PANEL	FL.	MTL PANEL	FL.	ACT	FL.	
101	OFFICE	CONC.	SEAL	MTL PANEL	FL.	EXISTING CMU	FL.	MTL PANEL	FL.	MTL PANEL	FL.	ACT	FL.	
102	BREAK RM.	CONC.	SEAL	MTL PANEL	FL.	EXISTING CMU	FL.	MTL PANEL	FL.	MTL PANEL	FL.	EXPOSED	FL.	
103	ELEVATOR MACHINE ROOM	CONC.	SEAL	CMU / TYPE X GWB	FL.	CMU	FL.	TYPE X GWB	FL.	MTL PANEL	FL.	EXPOSED	FL.	
104	SPRINKLER RM.	CONC.	SEAL	MTL PANEL	FL.	CMU	FL.	MTL PANEL	FL.	MTL PANEL	FL.	EXPOSED	FL.	
105	NEW ELEC. ROOM	EX. CONC.	SEAL	EXISTING	FL.	EXISTING	FL.	EXISTING CMU	FL.	EXISTING	FL.	EXPOSED	FL.	
106	MECHANICAL	CONC.	SEAL	MTL PANEL	FL.	EXISTING CMU	FL.	MTL PANEL	FL.	MTL PANEL	FL.	EXPOSED	FL.	
107	MECH.	CONC.	SEAL	MTL PANEL	FL.	EXISTING CMU	FL.	MTL PANEL	FL.	MTL PANEL	FL.	EXPOSED	FL.	
108	MECH.	CONC.	SEAL	MTL PANEL	FL.	EXISTING CMU	FL.	MTL PANEL	FL.	MTL PANEL	FL.	EXPOSED	FL.	
109	MECH.	CONC.	SEAL	MTL PANEL	FL.	EXISTING CMU	FL.	MTL PANEL	FL.	MTL PANEL	FL.	EXPOSED	FL.	
201	MECH.	CONC.	SEAL	MTL PANEL	FL.	EXISTING CMU	FL.	MTL PANEL	FL.	MTL PANEL	FL.	EXPOSED	FL.	
202	MECH.	CONC.	SEAL	MTL PANEL	FL.	EXISTING CMU	FL.	MTL PANEL	FL.	MTL PANEL	FL.	EXPOSED	FL.	
203	MECH.	CONC.	SEAL	MTL PANEL	FL.	EXISTING CMU	FL.	MTL PANEL	FL.	MTL PANEL	FL.	EXPOSED	FL.	
203	MECH.	CONC.	SEAL	MTL PANEL	FL.	EXISTING CMU	FL.	MTL PANEL	FL.	MTL PANEL	FL.	EXPOSED	FL.	
204	MECH.	CONC.	SEAL	MTL PANEL	FL.	EXISTING CMU	FL.	MTL PANEL	FL.	MTL PANEL	FL.	EXPOSED	FL.	
A1	STAIR A	CONC.	SEAL	CMU	FL.	CMU	FL.	CMU	FL.	CMU	FL.	EXPOSED	FL.	
A2	STAIR A	CONC.	SEAL	CMU	FL.	CMU	FL.	CMU	FL.	CMU	FL.	EXPOSED	FL.	
B1	STAIR B	CONC.	SEAL	CMU	FL.	CMU	FL.	CMU	FL.	CMU	FL.	EXPOSED	FL.	
B2	STAIR B	CONC.	SEAL	CMU	FL.	CMU	FL.	CMU	FL.	CMU	FL.	EXPOSED	FL.	

FINISH SCHEDULE NOTES:	
1.	FINISH UNSCHEDULED CLOSETS AND SPACES TO MATCH ADJOINING ROOMS.
2.	PAINT HOLLOW METAL DOORS AND FRAMES - SHERWIN WILLIAMS SW2038 'LIFE STORAGE BEIGE' GLOSS
3.	PAINT STAIR RAILS, RISERS, CHANNELS, AND FANS - SHERWIN WILLIAMS SW6811 'HONORABLE BLUE'
4.	PAINT EXPOSED CMU WALLS INSIDE STAIRWAYS AND ABOVE HALLWAY SYSTEMS - SHERWIN WILLIAMS SW7028 'INCREDIBLE WHITE'
5.	PAINT CEILING IN STAIRWAY - SHERWIN WILLIAMS SW7028 'INCREDIBLE WHITE'
6.	PROVIDE 4" x 4" x 18" x 48" HIGH ALUM. DIAMOND PLATE CORNER GUARDS AT ALL CORRIDOR/LOBBY OUTSIDE CORNERS.
7.	PROVIDE HALLWAY SYSTEM SMOOTH PANELS PAINTED SEASIDE WHITE - SHERWIN WILLIAMS SW1111 'SEASIDE WHITE', AND CORNER GUARDS PAINTED SEASIDE GLOSS ENAMEL - SHERWIN WILLIAMS SW1111 'SEASIDE WHITE'.
8.	FLOOR COAT TO BE APPLIED TO SLAB WITH CLEAN, DRY, SMOOTH, AND PARAFFIN SEAL COATERS. APPLY TWO COATS IN HALLWAY ONLY.

DOOR TYPE SCHEDULE							
VIEW	A	B	C	D	E	F	G
TYPE	A	B	C	D	E	F	G
DIMS	8'-8" x 7'-0"	3'-8" x 7'-0"	6'-0" x 8'-8"	8'-8" x 8'-0"	3'-0" x 7'-0"	3'-0" x 7'-0"	3'-0" x 7'-0"
NOTES	ROLL UP	ROLL UP		DURASTORM 3000 BY STANLEY OR EQUIV.	PROVIDE FIRE RATED GLAZING	PROVIDE FIRE RATED GLAZING TO 1.0 SQ. MAX.	DOOR TO BE PROVIDED BY MANUF. OF HALLWAY SYSTEM

DOOR SCHEDULE													
ID	DOOR			GLAZING	RATING	HW GRP	TYPE	FRAME		DETAILS		REMARKS	
	W.	H.	THK.					MAT.	FIN.	HEAD	SILL		
1	6'-0"	8'-8"	2"	ALUM. / GLASS	ANCD. ALUM.	1"	TEMP INSUL.	ALUM.	ANCD.	2/A7.1	2/A7.1		
2	8'-8"	8'-0"	1 3/4"	ALUM. / GLASS	ANCD. ALUM.	1"	TEMP INSUL.	ALUM.	ANCD.	3/A7.1	3/A7.1	EMERGENCY EXIT BREAKAWAY FEATURE	
3	3'-0"	7'-0"	1 3/4"	H.M. / GLASS	PAINT		TEMPERED	HM	PT		17/A7.1		
4	3'-0"	7'-0"	1 3/4"	H.M. / GLASS	PAINT		TEMPERED	HM	PT		16/A7.1		
5	3'-0"	7'-0"	1 3/4"	H.M. / GLASS	PAINT		TEMPERED	HM	PT		16/A7.1		
6	3'-0"	7'-0"	1 3/4"	H.M. / GLASS	PAINT		FIRE RATED VISION GL.	HM	PT	4/A9.0	8/A9.0	ALL HARDWARE TO BE FIRE RATED	
7	3'-0"	7'-0"	1 3/4"	H.M. / GLASS	PAINT		FIRE RATED VISION GL.	HM	PT	4/A9.0	8/A9.0	ALL HARDWARE TO BE FIRE RATED	
8	3'-6"	7'-0"	1 3/4"	H.M.	PAINT			HM	PT	1/A9.0	5/A9.0		
9	3'-0"	7'-0"	1 3/4"	H.M.	PAINT			HM	PT	3/A9.0	7/A9.0		
10	3'-0"	7'-0"	1 3/4"	H.M.	PAINT			HM	PT	3/A9.0	7/A9.0		
11	3'-6"	7'-0"	1 3/4"	H.M.	PAINT			HM	PT	4/A9.0	8/A9.0		
12	3'-6"	7'-0"	1 3/4"	H.M.	PAINT			HM	PT	4/A9.0	8/A9.0		
13	3'-0"	7'-0"	1 3/4"	H.M.	PAINT			HM	PT	1/A9.0	5/A9.0		
14	3'-0"	7'-0"	1 3/4"	H.M.	PAINT			HM	PT	2/A9.0	6/A9.0		
15	3'-0"	7'-0"	1 3/4"	H.M. / GLASS	PAINT		FIRE RATED VISION GL.	HM	PT	4/A9.0	8/A9.0	ALL HARDWARE TO BE FIRE RATED	
16	3'-0"	7'-0"	1 3/4"	H.M. / GLASS	PAINT		FIRE RATED VISION GL.	HM	PT	4/A9.0	8/A9.0	ALL HARDWARE TO BE FIRE RATED	
17	3'-0"	7'-0"	1 3/4"	H.M.	PAINT			HM	PT	1/A9.0	5/A9.0		
18	3'-0"	7'-0"	1 3/4"	H.M.	PAINT			HM	PT	1/A9.0	5/A9.0		
19	3'-0"	7'-0"	1 3/4"	H.M.	PAINT			HM	PT	1/A9.0	5/A9.0		
20	3'-0"	7'-0"	1 3/4"	H.M.	PAINT			HM	PT	1/A9.0	5/A9.0		
21	3'-0"	7'-0"	1 3/4"	H.M.	PAINT			HM	PT	1/A9.0	5/A9.0		
22	3'-0"	7'-0"	1 3/4"	H.M.	PAINT			HM	PT	1/A9.0	5/A9.0		
23	3'-0"	7'-0"	1 3/4"	H.M.	PAINT			HM	PT	1/A9.0	5/A9.0		
24	3'-0"	7'-0"	1 3/4"	H.M.	PAINT			HM	PT	1/A9.0	5/A9.0		
25	3'-0"	7'-0"	1 3/4"	H.M.	PAINT			HM	PT	1/A9.0	5/A9.0		

DOOR HARDWARE SCHEDULE			
NOTES			
1.	ALL HARDWARE FINISH SHALL BE COORDINATED WITH OWNER.		
2.	ANY HARDWARE ITEM NOT SPECIFICALLY CALLED OUT, BUT REQUIRED TO MAKE ANY ASSEMBLY OPERATIONAL, SHALL BE INCLUDED BY THE HARDWARE SUPPLIER.		
3.	CONTRACTOR SHALL COORDINATE ANY SPECIALLY DOORS, FRAMES AND/OR HARDWARE REQUIREMENTS WITH OWNER IN FIELD PRIOR TO CONSTRUCTION.		
4.	ALL HARDWARE TO BE ADA COMPLIANT.		
5.	AT FIRE RATED DOORS, PROVIDE COMPLETE HARDWARE SET, FIRE RATED, INCLUDING PANIC OPENING HARDWARE, AUTOMATIC CLOSER & ELSE REGD BY CODE.		
6.	KEYING: PROVIDE 6 PIN CYLINDERS FOR ALL LOCKS. RE-KEY ALL LOCKS AT END OF CONSTRUCTION IN MASTERKEY SYSTEM AS DIRECTED BY OWNER. PROVIDE OWNER WITH 8 MASTERKEYS AND 2 CHANGE KEYS FOR EACH LOCK.		
HARDWARE GROUP 1			
MAIN OFFICE ENTRY:			
2.0	EA.	TOP PIVOTS	H180 (B) RISSON (C)
4.0	EA.	INT. PIVOTS	H119 (B) RISSON (C)
2.0	EA.	BOTTOM PIVOTS	L1147 (B) RISSON (C)
1.0	EA.	OH. CONCEALED CLOSERS	2030 (B) LCN
2.0	EA.	EXIT DEVICES	8600-02-CD (C) 629 ADAMS RITE
2.0	EA.	CYLINDERS	SHC CONST. CORE 629 SCHLAGE
2.0	EA.	PULLS	(B) ISE
2.0	EA.	DIST. PROOF STRIKES	MANUF. STD. 625 ISE
2.0	EA.	OVERHEAD STOPS	9028 (C) (D) DORMA (D)
1.0	EA.	THRESHOLD	229A (B) FEMKO (D)
1.0	EA.	DOOR SWEEP	MANUF. STD. (B) ISE
1.0	SET	WEATHERSTRIP	MANUF. STD. (D) ISE
(C) PROVIDED BY ALUMINUM ENTRANCE MANUFACTURER			
(D) MATCH STOREROOM FINISH			
HARDWARE GROUP 2			
AUTOMATIC SLIDING DOORS:			
UNLESS OTHERWISE INDICATED, ALL HARDWARE SHALL BE PROVIDED AS PART OF THE DOOR PACKAGE BY DOOR MANUFACTURER.			
HARDWARE GROUP 3			
EXTERIOR H.M. DOORS:			
3.0	EA.	HINGES	FBB 199 4.5x4.5 NRP 630
1.0	EA.	EXIT DEVICES	8600-02-CD (C) 629 ADAMS RITE
1.0	EA.	PARALLEL ARM CLOSER	ALUM.
1.0	EA.	PULL HANDLE	ALUM.
1.0	EA.	THRESHOLD	229A (B) FEMKO (D)
1.0	EA.	DOOR SWEEP	MANUF. STD. (B) ISE
1.0	SET	WEATHERSTRIP	MANUF. STD. (D) ISE
HARDWARE GROUP 4			
INTERIOR H.M. RATED DOORS:			
3.0	EA.	HINGES	FBB 199 4.5x4.5 652
1.0	EA.	EXIT DEVICES	8600-02-CD (C) 629 ADAMS RITE
1.0	EA.	LEVER HANDLE (PASSAGE) (FULL SIDE ONLY)	626
1.0	EA.	CLOSER	ALUM.
1.0	EA.	WALL STOP	652
1.0	SET	GASKE/SMOKE SEAL (HEAD & JAMB) (REQUIRED AT RATED DOORS)	
HARDWARE GROUP 5			
INTERIOR H.M. DOORS:			
3.0	EA.	HINGES	FBB 199 4.5x4.5 NRP 652
1.0	EA.	LEVER HANDLE (SECURE)	626
1.0	EA.	CLOSER	ALUM.
1.0	EA.	WALL STOP	652
3.0	EA.	SILENCERS	
HARDWARE GROUP 6			
NOT USED			
HARDWARE GROUP 7			
NOT USED			
HARDWARE GROUP 8			
MECHANICAL & ELECTRICAL ROOMS:			
3.0	EA.	HINGES	FBB 199 4.5x4.5 652 (C)
1.0	EA.	LEVER HANDLE (STOREROOM LOCK)	626
1.0	EA.	PARALLEL ARM CLOSER	ALUM. (C)
1.0	EA.	WALL STOP	652
3.0	EA.	SILENCERS	
(C) 180 DEGREE MOTION WHEN SHOWN ON PLAN			
HARDWARE GROUP 9			
ELEVATOR EQUIPMENT ROOM:			
3.0	EA.	HINGES	FBB 199 4.5x4.5 652
1.0	EA.	LEVER HANDLE (STOREROOM LOCK)	626
1.0	EA.	PARALLEL ARM CLOSER	ALUM.
1.0	EA.	WALL STOP	652
1	SET	GASKE/SMOKE SEAL (HEAD & JAMB)	

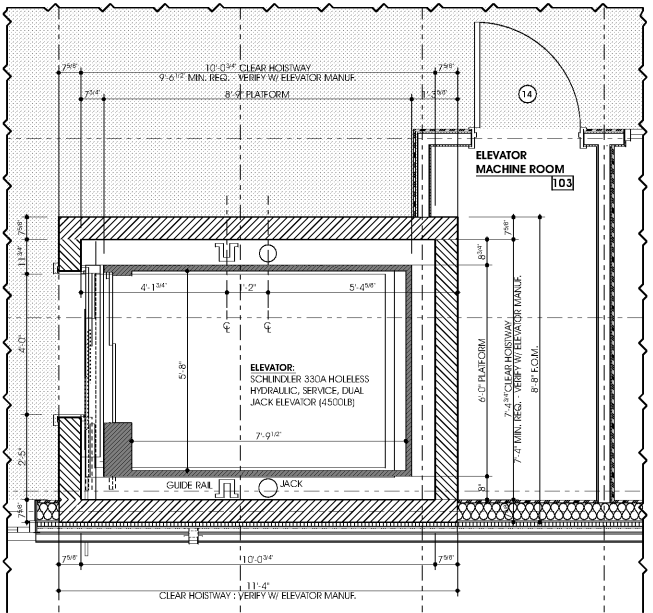

1 DETAILED FLOOR PLAN @ ELEVATOR SCALE: 1/2"=1'-0"

ELEVATOR SCHEDULE	
MANUFACTURER	SCHINDLER
MODEL	330A HYDRAULIC ELEVATOR
CLASSIFICATION	HOSPITAL / SERVICE
JACK SYSTEM	HOLESSE TELESCOPING DUAL JACK
QUANTITY	1
CAPACITY	4,500 LBS
SPEED	100 FPM
DOOR TYPE	TWO SPEED SIDE OPENING
CAB HEIGHT	9'-0"
HOISTWAY ENTRANCE DIMENSIONS	4'-0" W x 8'-0" H
ENTRANCE RATING	1 HOUR
POWER SUPPLY	SEE ELECTRICAL DRAWINGS
ELEVATOR CAB FINISHES	
DOORS	STAINLESS STEEL
FRONT WALL RETURN	STAINLESS STEEL
WALL	PATCH SHERWIN WILLIAMS SW6811 - HONORABLE BLUE. SECTION MUST BE APPROVED BY LIFE STORAGE PROJECT MANAGER.
WALL PANELS	SCHEINER MINUS SUSPENSION SYSTEM WITH LEXAN PANELS
CEILING	ALUMINUM
THRESHOLD	ALUMINUM DIAMOND PLATE FLOORING
FINISH FLOOR	FLAT 1/2" x 2" #4 STAINLESS STEEL
HANDRAIL TYPE	ROW AT SIDES AND REAR WALL
HANDRAIL LOCATION	1 SET
PROTECTIVE BLANKETS	TYPE HT - BLACK LEXAN WITH #4 STAINLESS STEEL
CAB FIXTURES	
HOIST	