

ABBREVIATIONS

AB	ABOVE	FR.P	FIBERGLASS REINFORCED POLYESTER BOARD	Q.T.	QUARRY TILE
ACT	ACOUSTIC	FR.T	FIRE RESISTANT TREATED	R	RISER (RADIUS)
ACST	ACOUSTIC	FR.Z	FREZZER	RAD	RADIATOR
AD	ADJUSTABLE	GA	GALVANIZED	RB	RUBBER BASE
ALUM	ALUMINUM	GL	GLASS	REF	REGISTER
APFH	APPROXIMATE FLOOR FINISH	GR	GRADE	REFG	REINFORCING (REINFORCED)
A.F.F.	ALUMINUM THRESHOLD	GRD	GROUND	REQ	REQUIRED
A.T.	ALUMINUM THRESHOLD	G.P.	GYP-SUM BOARD	R.D.	ROOF DRAIN
B/	BOTTOM OF	G.P.P.	GYP-SUM BOARD	R.O.	ROUGH OPENING
BAL	BALANCE	HT	HEIGHT	RUB	RUBBER
BO	BOARD	H.M.	HOLLOW METAL	RM	ROOM
B.F.F.	BELOW FINISH FLOOR	I.D.	INSIDE DIAMETER	R.T.L.U.	ROOM TOP UNIT
BK	BLOCK	INSUL	INSULATION	RWL	RAIN WATER LEADER
BSMT	BASEMENT	INT/INT	INTERIOR	SDI	SADDLE SECTION
BS	BOTH SIDES	INT/INT	INTERIOR	SECT	SECTION
C	COURSES/CHANNEL	JAN	JANITOR	SFC	STONE FIXTURE INSTALLATION CONTRACTOR
C.B.	CATCH BASIN	JT	JOINT	SHT	SHEET
C.I.	CAST IRON	KAL	KALAMEN	SV	SLEEVE
CAB	CABINET	L	ANGLE	S.S.	SERVICE SINK
CEM	CEMENT	LAM	LAMINATE	SPEC	SPECIFICATION
CEM	CEMENT	LG	LENGTH	SQ	SQUARE
CEM	CEMENT	LN	LENGTH	STD	STANDARD
C.L.	CENTER LINE	LN	LENGTH	STL	STAINLESS STEEL
CLG	CEILING	L.W.O.D.	LESS WIDTH OF DOOR	STR	STRUCTURE
CLB	CHALK BOARD	MACH	MACHINE	SUSP	SUSPENDED
C.M.P.	CONCRETE MASONRY UNIT	MAR	MARBLE	SW	SWITCH
C.O.	CLEAN OUT	MAS	MASONRY	T	TOP OF
COL	COLUMN	M.D.	MASONRY OPENING	T.B.B.	TILE BACKING BOARD
CONC.	CONCRETE	MAT	MATERIAL	TER	TERRAZZO
COND	CONDUIT	MCH	MECHANICAL	T.C.	TERRA COTTA
CONSTR	CONSTRUCTION	M.C.	MEDICINE CABINET	T & G	TONGUE & GROOVE
CONTR	CONTRACTOR	M.H.	MAN HOLE	TP	TYPICAL
CONV	CONVEYOR	MISC	MISCELLANEOUS	T.B.D.	TACK BOARD
COV	COVER	MIS	MISCELLANEOUS	TEMP	TEMPERED
COMPO	COMPOSITION	MIN	MINIMUM	T.S.	TUBE STEEL
COMPR	COMPRESSION	MISG	MISCELLANEOUS	UNFIN	UNFINISHED
CONR	CORNER	MOP	MOP RECEPTOR	U.O.N.	UNLESS OTHERWISE NOTED
C.J.	CONTROL JOINT	MOP	MOP RECEPTOR	UNIT	UNIT
CPT	CARPET	MOP	MOP RECEPTOR	UV	UNIT VENTILATOR
C.R.	COLD ROLLED	MOP	MOP RECEPTOR	V.B.	VINYL WALLBASE / VAPOR BARRIER
C.T.	CERAMIC TILE	MOP	MOP RECEPTOR	VCT	VINYL COMPOSITION TILE
D	DRYWALL/GYP BD.	MOP	MOP RECEPTOR	V.F.	VERIFY IN FIELD
D.F.	DRINKING FOUNTAIN	MOP	MOP RECEPTOR	VENT	VENTILATOR
DET	DETAIL	MOP	MOP RECEPTOR	VEST	VESTIBULE
DI	DIAMETER	MOP	MOP RECEPTOR	VWC	VINYL WALL COVERING
DIAM	DIAMETER	MOP	MOP RECEPTOR	WCP	WEATHERCAP
DM	DIMENSION	MOP	MOP RECEPTOR	W.CE.	WATER COOLER
DO	DITTO	MOP	MOP RECEPTOR	WD	WOOD
DIV	DIVISION	MOP	MOP RECEPTOR	WF	WIDE FLANGE
DN	DOWN	MOP	MOP RECEPTOR	WL	WATER LINE
DR	DRAIN	MOP	MOP RECEPTOR	WP	WATER PROOFING
DWG	DRAWING	MOP	MOP RECEPTOR	WT	WATER TABLE
ELEV	ELEVATION	MOP	MOP RECEPTOR	WI	WROUGHT IRON
ELEC	ELECTRIC	MOP	MOP RECEPTOR	W.V.	WATER VALVE
EQUIP	EQUIPMENT	MOP	MOP RECEPTOR	W.W.F.	WELDED WIRE FABRIC
EQ	EQUIPMENT	MOP	MOP RECEPTOR		
EXP	EXPOSED	MOP	MOP RECEPTOR		
EXT	EXTERIOR	MOP	MOP RECEPTOR		
EXTR	EXTRUDED	MOP	MOP RECEPTOR		
EXG./EXIST	EXISTING	MOP	MOP RECEPTOR		
F.D.	FLOOR DRAIN	MOP	MOP RECEPTOR		
F.E.	FIRE EXTINGUISHER	MOP	MOP RECEPTOR		
FF	FINISH FLOOR	MOP	MOP RECEPTOR		
FL	FLOOR	MOP	MOP RECEPTOR		
FLR	FLOOR FINISH	MOP	MOP RECEPTOR		
FIN	FINISH	MOP	MOP RECEPTOR		
F.O.	FRAMED OPENING	MOP	MOP RECEPTOR		

SYMBOLS

	BUILDING SECTION IDENTIFICATION		DOOR NUMBER		CONCRETE
	WALL SECTION IDENTIFICATION		REVISION NUMBER		CRUSHED STONE
	PARTIAL SECTION OR DETAIL IDENTIFICATION		WINDOW NUMBER		EARTH
	PLAN DETAIL IDENTIFICATION		WALL TYPE		BATT INSULATION
	ENLARGED AREA IDENTIFICATION		FINISH MATERIAL BOX		GYP-SUM BOARD
	INTERIOR ELEVATION IDENTIFICATION		ROOM NAME & NUMBER		MASONRY BLOCK
	ELEVATION TARGET		NORTH ARROW		MASONRY BRICK
	DRAWING TITLE IDENTIFICATION				RIGID INSULATION
					STEEL
					WOOD
					PLYWOOD

NOTE: ARCHITECTURAL SITE PLAN IS PROVIDED FOR REFERENCE, REFER TO CIVIL DRAWINGS

tmm architect
 5800 Brookshire Blvd., Suite 100
 Charlotte, NC 28216
 Phone: 704.531.1111
 Fax: 704.531.1112
 www.tmmarchitect.com

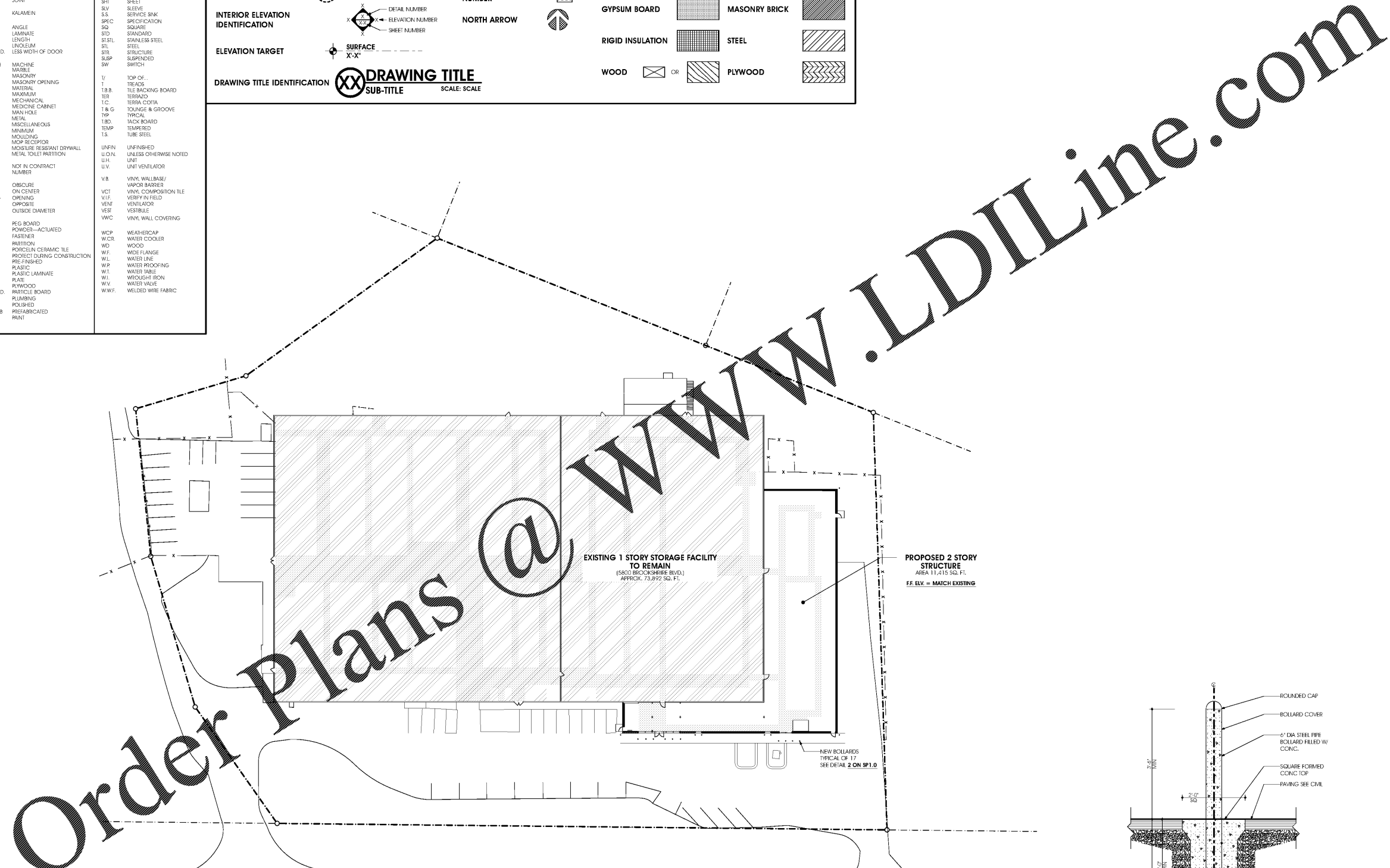

1 ARCHITECTURAL SITE PLAN

SCALE: 1"=30'

2 DETAIL BOLLARD

SCALE: 3/4"=1'-0"

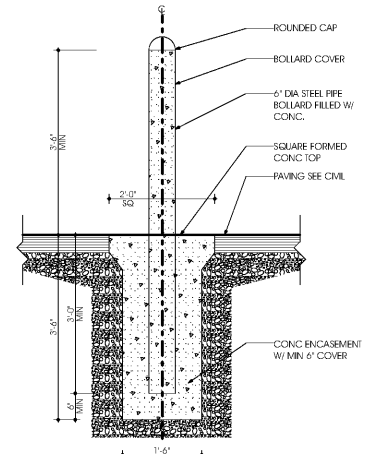

LIFE STORAGE, INC.
 Life Storage #497
 5800 Brookshire Blvd. · Charlotte, NC 28216

ISSUE	DATE	REVISIONS
1	1/18/2021	ISSUED FOR CLIENT REVIEW
2	1/18/2021	ISSUED FOR BID
3	1/18/2021	

SITE PLAN

DRAWN BY: CR
 SCALE: AS NOTED
 DATE: 1/18/2020
 JOB NUMBER: 3771

SP1.0