

THIS DOCUMENT, THE IDEAS AND DESIGNS INCORPORATED HEREIN, AS AN INSTRUMENT OF PROFESSIONAL SERVICE, IS THE PROPERTY OF WYNN L. WARNER ARCHITECT AND IS NOT TO BE USED, IN WHOLE OR IN PART, FOR ANY OTHER PROJECT WITHOUT THE WRITTEN AUTHORIZATION OF WYNN L. WARNER ARCHITECT.

WYNN L. WARNER ARCHITECT  
 5292 camden lake parkway  
 acworth, GA 30101  
 (770)365-6638

DUNKIN DONUTS  
 3020 FIVE FORKS TRICKUM ROAD  
 LILBURN, GA 30047

Drawn By: WJW  
 Checked By: WJW  
 Date: OCTOBER XX, 2019  
 Job No.:  
 Drawing Number:

P01

RELEASED FOR CONSTRUCTION

- PLUMBING GENERAL NOTES:**
- WORK COVERED BY THESE DOCUMENTS INCLUDES LABOR, MATERIAL, EQUIPMENT, FIXTURES AND SERVICES FOR AND INCIDENTAL TO, THE INSTALLATION OF THE PLUMBING SYSTEMS INDICATED WITHIN THESE CONSTRUCTION DOCUMENTS.
  - PRIOR TO SUBMITTING A BID, THIS CONTRACTOR SHALL VISIT THE PROJECT SITE TO VERIFY FIELD CONDITIONS. PRIOR TO BID, NOTIFY ARCHITECT OF ANY DISCREPANCIES WHICH MAY HINDER THE INSTALLATION OF THE SYSTEM AS INDICATED ON THESE DOCUMENTS.
  - ALL CUTTING AND CORING OF THE EXISTING FLOORS, WALLS, ETC. SHALL BE PATCHED AND SEALED TO MATCH THE EXISTING CONDITIONS.
  - ALL WORK SHALL BE PERFORMED TO COMPLY WITH LOCAL, STATE AND FEDERAL REGULATIONS. THIS CONTRACTOR IS RESPONSIBLE FOR THE LABOR AND COSTS ASSOCIATED WITH OBTAINING CONSTRUCTION PERMITS.
  - EXCEPT WHERE DIMENSIONS ARE SPECIFICALLY SHOWN, THESE DRAWINGS ARE DIAGRAMMATIC AND SHALL NOT BE SCALED. THE EQUIPMENT'S ACTUAL SIZE WAS USED IN THE DEVELOPMENT OF THESE DOCUMENTS.
  - REFER TO ARCHITECTURAL AND STRUCTURAL DRAWINGS FOR DIMENSIONS AND PENETRATION LOCATIONS.
  - THE DOCUMENTS DO NOT SHOW ALL NECESSARY FITTINGS AND SETS FOR COMPLETE INSTALLATION. ALTHOUGH NOT SHOWN, IT IS THIS CONTRACTOR'S RESPONSIBILITY TO PROVIDE ALL NECESSARY FITTINGS AND FUNCTIONING SYSTEM UPON THE COMPLETION OF THE PROJECT.
  - PRIOR TO ORDERING ANY EQUIPMENT, THIS CONTRACTOR SHALL COORDINATE WITH THE ELECTRICAL SUBCONTRACTOR AND GENERAL CONTRACTOR. THIS CONTRACTOR SHALL PROVIDE PHASE, AMPERAGE, AND VOLTAGE OF ALL EQUIPMENT TO THE ELECTRICAL SUBCONTRACTOR AND WEIGHTS AND DIMENSIONS TO THE GENERAL CONTRACTOR. ANY COST ISSUES SHALL BE DETERMINED PRIOR TO ORDERING THE EQUIPMENT.
  - VALVES AND FITTINGS SHALL BE THE SAME SIZE AS THE PIPING IN WHICH THEY ARE INSTALLED.
  - FOR ALL PENETRATIONS THROUGH EXTERIORS WALLS OR ROOF, SEAL WITH WATER PROOFING AND MAKE LEAK TIGHT.
  - FOR ALL PENETRATIONS THROUGH FIRE RATED WALLS, FLOORS AND BARRIERS PROVIDE FIRE STOPPING TO MAINTAIN FIRE RATING.
  - PROVIDE PIPE SUPPORTS AS REQUIRED BY THE LOCAL CODES IN EFFECT AS NECESSARY TO PREVENT SWAY.
  - CHANGES IN DIRECTION OF SANITARY PIPING SHALL NOT BE MADE WITH FITTINGS WHICH WILL REDUCE THE FLOW VELOCITY OR CREATE ANY OTHER ADVERSE EFFECT ON THE GRAVITY FLOW OF THE SYSTEM.
  - ROUTE ALL PIPING CONCEALED ABOVE CEILINGS, WITHIN WALLS, OR CHASES AS SHOWN IN THESE DOCUMENTS. PIPING ROUTED IN EXPOSED AREAS SHALL BE HELD TIGHT TO STRUCTURE AND PAINTED TO MATCH THE SURROUNDING STRUCTURE. PIPING IN MECHANICAL SPACES DO NOT REQUIRE PAINTING.
  - PROVIDE ACCESS PANELS FOR ALL VALVES. FIELD COORDINATE ACCESS PANEL LOCATIONS.
  - CONTRACTOR SHALL FIELD VERIFY INVERT ELEVATIONS PRIOR TO INSTALLATION AND AT THE INITIAL SITE VISIT.
  - CONTRACTOR SHALL INSTALL DIELECTRIC UNIONS AT CONNECTIONS OF DISSIMILAR METALS.
  - CONTRACTOR SHALL ROUGH-IN ALL WASTES AND SUPPLIES TO EQUIPMENT USING MANUFACTURER'S CERTIFIED SHOP DRAWINGS AND MAKE FINAL CONNECTIONS. ALL SUPPLIES SHALL BE VALVED IN AN ACCESSIBLE LOCATION. INSTALL VACUUM BREAKERS WHERE REQUIRED BY LOCAL AUTHORITIES.
  - INTERIOR PIPING SHALL BE ROUTED PARALLEL AND PERPENDICULAR TO WALLS IN A WORKMANLIKE MANNER. PROVIDE OFFSETS AS REQUIRED TO AVOID INTERFERENCES WITH ARCHITECTURAL OR STRUCTURAL COMPONENTS.
  - REFER TO ARCHITECTURAL AND INTERIOR DESIGN DOCUMENTS FOR ACTUAL MOUNTING HEIGHTS AND LOCATIONS OF PLUMBING FIXTURES.
  - ALL EXPOSED PIPING AT PLUMBING FIXTURES SHALL BE CHROME PLATED BRASS WITH ESCUTHEON PLATES AT THE WALL, FLOOR OR CEILING PENETRATION.
  - THE OWNER, OPERATOR, ARCHITECTURAL NOR ENGINEER ARE RESPONSIBLE FOR THE CONTRACTOR'S SAFETY PRECAUTIONS, MEANS AND METHODS, WORK TECHNIQUES, CONSTRUCTION SEQUENCE OR PROCEDURES REQUIRED TO COMPLETE THE PROJECT.
  - SANITARY WASTE AND VENT PIPING LOCATED IN FIRE RATED WALL ASSEMBLIES SHALL BE CASERON WITH NO-HUB OR BELL AND SPIGOT FITTINGS.
  - ALL FLOOR DRAINS TO THE TRAP PRIMER CONNECTIONS.
  - SANITARY ABOVE AND BELOW GRADE SERVICE WEIGHT CAST IRON, NO-HUB PLUG END MEETING ASTM A-888 AND 150# STANDARD JOI. COUPLINGS SHALL BE STAINLESS STEEL, HEAVY DUTY, NO-HUB. PVC SOCKET TYPE, SOLVENT WELDED PVC PLASTIC.
  - VENTS AND CHIMNEYS: SERVICE WEIGHT CAST IRON, NO-HUB, PLUG END MEETING ASTM A-888 AND 150# STANDARD JOI. COUPLINGS SHALL BE STAINLESS STEEL, HEAVY DUTY, NO-HUB. PVC SOCKET TYPE, SOLVENT WELDED PVC PLASTIC.
  - DOMESTIC WATER: ABOVE GRADE DOMESTIC WATER PIPE: TYPE L HARD DRAWN COPPER TUBING WITH WROUGHT COPPER FITTINGS, SOLDERED JOINTS, LEAD FREE SOLDER. 3/4" COLD WATER AND 1" HOT WATER THICK FIBERGLAS OR ARMAFLEX INSULATION. BELOW GRADE DOMESTIC WATER PIPING: TYPE K HARD DRAWN COPPER. NO JOINTS SHALL BE MADE BELOW GRADE.
  - ALL EQUIPMENT, FIXTURES, PIPING, VALVES AND FITTINGS SHALL BE CLEANED OF GREASE, OIL, PINT, METL SHAVINGS AND CONSTRUCTION DEBRIS BEFORE FINAL INSPECTION.
  - VALVES: DOMESTIC WATER: NIBCO, CRANE, OR MILWAUKEE.
  - INSTALLATION: ALL EQUIPMENT AND PRODUCTS SHALL BE INSTALLED PER MANUFACTURER'S WRITTEN REQUIREMENTS. PROVIDE ACCESS AND CLEARANCE FOR ALL EQUIPMENT REQUIRING MAINTENANCE.
  - TESTING: TEST SANITARY AND VENT PIPING PRIOR TO THE INSTALLATION OF FIXTURES. HYDROSTATIC TEST SHALL BE PERFORMED WITH PIPE CAPPED AT FIXTURE CONNECTIONS. FILL PIPING WITH WATER AND ALLOW TO STAND FOR ONE HOUR. TEST DOMESTIC WATER PIPING PRIOR TO THE INSTALLATION OF FIXTURES. HYDROSTATIC TEST SHALL BE PERFORMED WITH PIPE CAPPED AT FIXTURE CONNECTIONS. HYDROSTATIC TEST PRESSURE SHALL BE 150 PSI AND HELD FOR ONE HOUR.
  - DOMESTIC WATER PIPING SHALL BE DISINFECTED PRIOR TO BEING BACK INTO SERVICE. DISINFECTION SHALL MEET THE REQUIREMENTS OF AWWA AND THOSE OF THE LOCAL AUTHORITY.
  - ALL PLUMBING FIXTURES SHALL BE HIGH EFFICIENT.

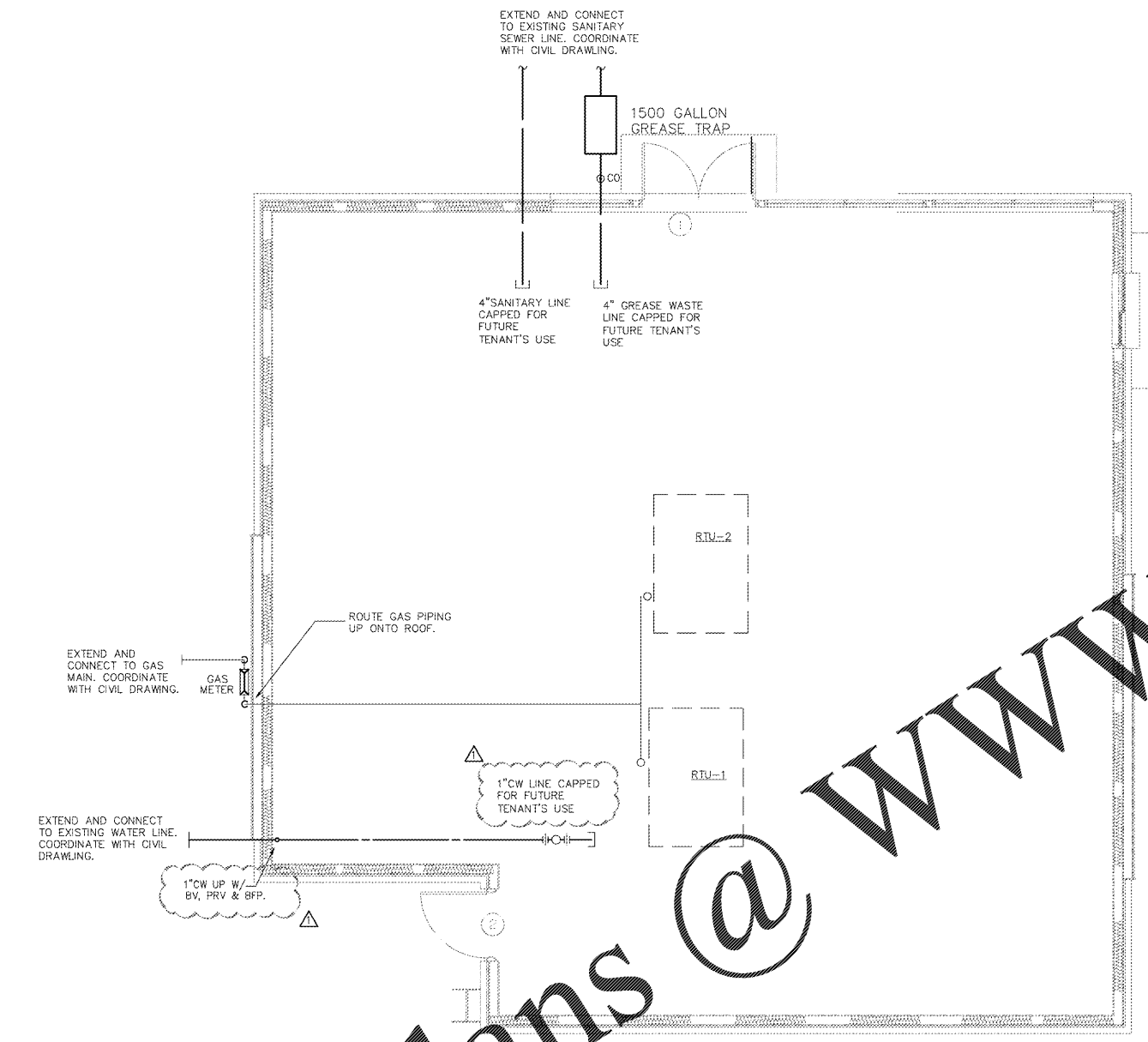

**1 Plumbing Shell Floor Plan**  
 Scale: 1/4" = 1'-0"

TYPE OF GAS:  
 NATURAL GAS  
 MATERIAL OF GAS PIPING: SCHEDULE 40 BLACK STEEL  
 SYSTEM:  
 SINGLE STAGE SYSTEM

LONGEST LENGTH METHOD (2012-IFGS A3.1) IS USED FOR GAS PIPE SIZING. TABLE 402.4(2) IS USED TO DETERMINE THE SIZE OF EACH SECTION.  
 TOTAL DEMAND=360 MBH. @ 7"WC.  
 TOTAL DEVELOPED LENGTH=60ft..

GAS EQUIPMENT SCHEDULE			
NO.	DESCRIPTION	QUAN	GAS
A	RTU-1	1	180,000 BTU
B	RTU-2	1	180,000 BTU
TOTAL GAS LOAD			360,000 BTUH

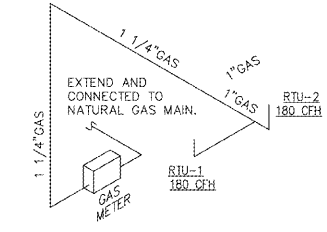

**2 Natural Gas Riser**  
 Scale: None

Order Plans @ www.dunkinonline.com

