

Notes:  
 1- Shrubs shall be of quality as prescribed in the root observations detail and specification.  
 2- See specifications for further requirements related to this detail.

**SHRUB ON SLOPE 5% (20:1) TO 50% (2:1) - UNMODIFIED SOIL**

URBAN TREE FOUNDATION © 2014  
 OPEN SOURCE FREE TO USE  
 pdt\_shrub\_on\_slope\_unmodified\_soil

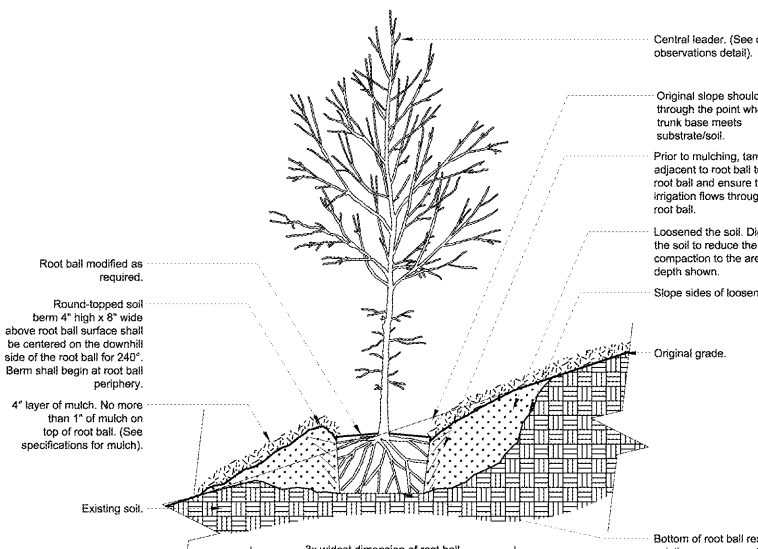

**TREE ON SLOPE 5% (20:1) TO 50% (2:1) - UNMODIFIED SOIL**

URBAN TREE FOUNDATION © 2014  
 OPEN SOURCE FREE TO USE  
 L\_tree\_planting\_slope\_unmodified\_soil

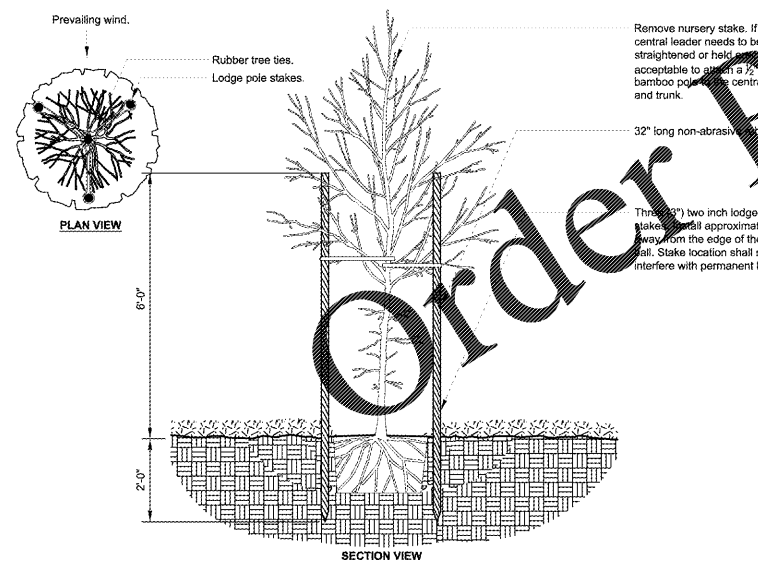

**TREE STAKING - LODGE POLES (3)**

URBAN TREE FOUNDATION © 2014  
 OPEN SOURCE FREE TO USE  
 L\_tree\_staking\_lodgepoles x 3

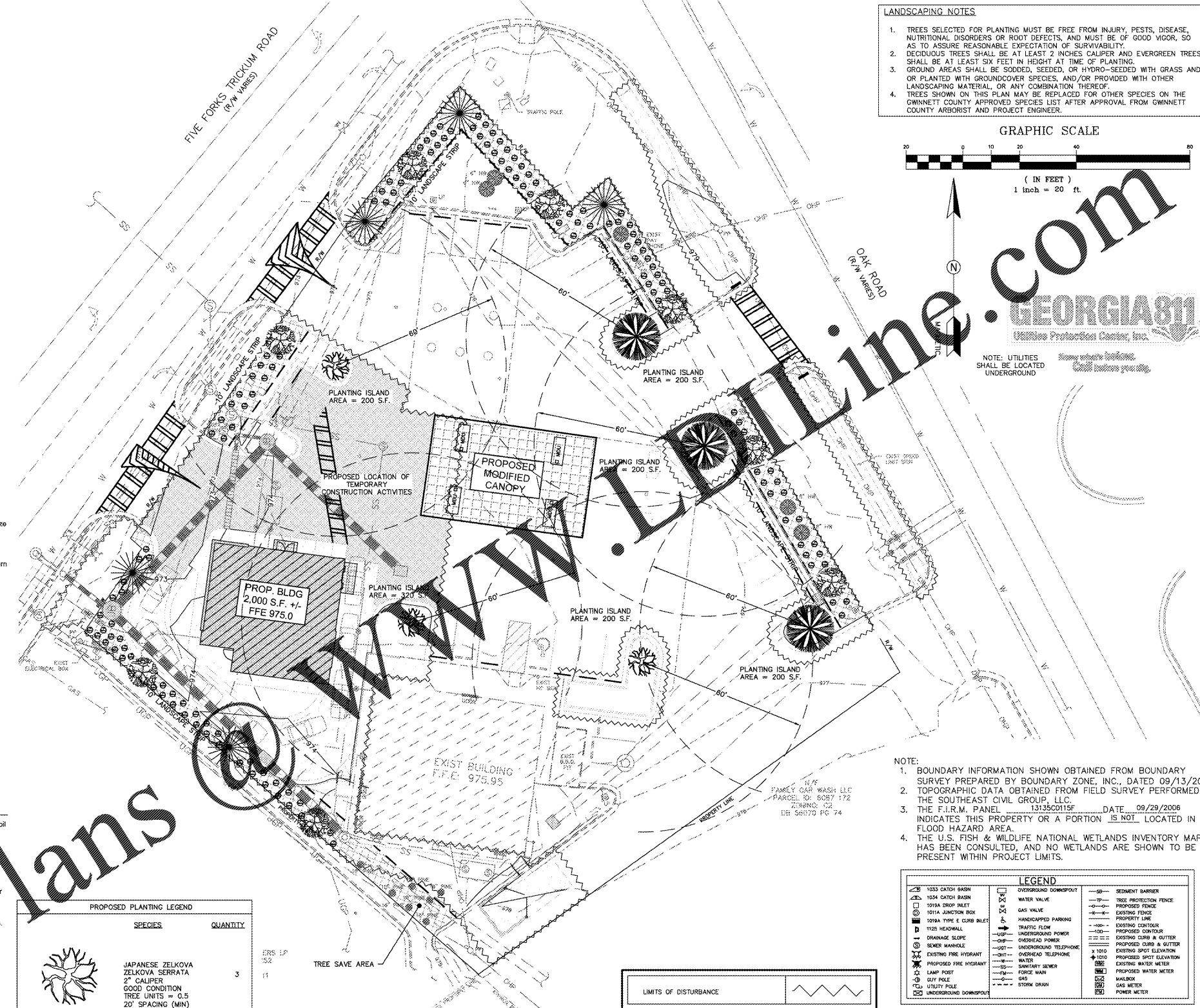

- LANDSCAPING NOTES**
- TREES SELECTED FOR PLANTING MUST BE FREE FROM INJURY, PESTS, DISEASE, NUTRITIONAL DISORDERS OR ROOT DEFECTS, AND MUST BE OF GOOD WOOD, SO AS TO ASSURE REASONABLE EXPECTATION OF SURVIVABILITY.
  - DECIDUOUS TREES SHALL BE AT LEAST 2 INCHES CALIPER AND EVERGREEN TREES SHALL BE AT LEAST SIX FEET IN HEIGHT AT TIME OF PLANTING.
  - GROUND AREAS SHALL BE SODED, SEEDED, OR HYDRO-SEEDED WITH GRASS AND/OR PLANTED WITH GROUND COVER SPECIES, AND/OR PROVIDED WITH OTHER LANDSCAPING MATERIAL, OR ANY COMBINATION THEREOF.
  - TREES SHOWN ON THIS PLAN MAY BE REPLACED FOR OTHER SPECIES ON THE GWINNETT COUNTY APPROVED SPECIES LIST AFTER APPROVAL FROM GWINNETT COUNTY ARBORIST AND PROJECT ENGINEER.

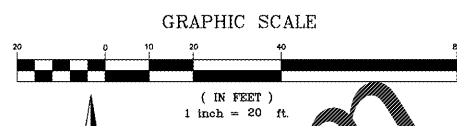

- NOTE:
- BOUNDARY INFORMATION SHOWN OBTAINED FROM BOUNDARY SURVEY PREPARED BY BOUNDARY ZONE, INC., DATED 09/13/2016.
  - TOPOGRAPHIC DATA OBTAINED FROM FIELD SURVEY PERFORMED BY THE SOUTHEAST CIVIL GROUP, LLC.
  - THE F.I.R.M. PANEL 13135C0115F DATE 09/29/2006 INDICATES THIS PROPERTY OR A PORTION IS NOT LOCATED IN A FLOOD HAZARD AREA.
  - THE U.S. FISH & WILDLIFE NATIONAL WETLANDS INVENTORY MAP HAS BEEN CONSULTED, AND NO WETLANDS ARE SHOWN TO BE PRESENT WITHIN PROJECT LIMITS.

**LEGEND**

1033 CATCH BASIN	OVERGROUND DOWNSPOUT	SEDIMENT BARRIER
1034 CATCH BASIN	WATER VALVE	TREE PROTECTION FENCE
1019A DROP INLET	GAS VALVE	PROPOSED FENCE
1019A JUNCTION BOX	HANDICAPPED PARKING	EXISTING FENCE
1019A TYPE E CURB INLET	TRAFFIC FLOW	PROPERTY LINE
1125 MEDICAL	UNDERGROUND POWER	PROPOSED CONTOUR
DRAINAGE SLOPE	EXISTING CURB & GUTTER	EXISTING CONTOUR
SEWER MANHOLE	UNDERGROUND TELEPHONE	PROPOSED CURB & GUTTER
EXISTING FIRE HYDRANT	OVERHEAD TELEPHONE	EXISTING SPOT ELEVATION
PROPOSED FIRE HYDRANT	WATER	PROPOSED SPOT ELEVATION
ACER SERRATA	SANITARY SEWER	EXISTING WATER METER
LAIR POLE	WATER	PROPOSED WATER METER
UTILITY POLE	GAS	WALKBOX
UNDERGROUND DOWNSPOUT	STORM DRAIN	GAS METER
		POWER METER

**PROPOSED PLANTING LEGEND**

SPECIES	QUANTITY
JAPANESE ZELKOVA ZELKOVA SERRATA 2\" CALIPER GOOD CONDITION TREE UNITS = 0.5 20' SPACING (MIN)	3
RED MAPLE, DWARF VARIETY ACER RUBRUM 2\" CALIPER GOOD CONDITION TREE UNITS = 0.5 20' SPACING (MIN)	3
FLOWERING DOGWOOD CORNUS FLORIDA 2\" CALIPER GOOD CONDITION TREE UNITS = 0.5 20' SPACING (MIN)	8
TRIDENT MAPLE ACER BUERGERIANUM 2\" CALIPER GOOD CONDITION TREE UNITS = 0.5 20' SPACING (MIN)	5
"EVERGREEN SHRUB" KOREAN BOXWOOD/BUXUS MICROPHYLLA VAR. KOREANA	136

**PROPOSED PLANTING CALCULATIONS**

<b>OAK ROAD LANDSCAPE STRIP</b> • REQUIRED = (194 FT - 35.4 FT DRIVEWAY WIDTH)/40 = 4 TREES • EXISTING = 0 TREES • PROPOSED = 5 TREES	<b>TREE DENSITY CALCULATIONS</b> = 1.10 AC x 16 TREE UNITS = 17.6 TREE UNITS
<b>FIVE FORKS TRICKUM ROAD LANDSCAPE STRIP</b> • REQUIRED = (260 FT - 75 FT DRIVEWAY WIDTH)/40 = 5 TREES • EXISTING = 0 TREES • PROPOSED = 5 TREES	<b>EXISTING TREE UNITS</b> = 24.45 <b>PROPOSED TREE UNITS</b> = 9.5
<b>PROPERTY LINE LANDSCAPE STRIP</b> • REQUIRED = (189 FT)/40 = 5 TREES • EXISTING = 6 TREES • PROPOSED = 3 TREES	<b>TOTAL POST-DEVELOPMENT TREE UNITS</b> = 24.45 + 9.5 = 33.95
<b>REQUIRED PARKING LOT TREES</b> = 1 TREE UNIT PER 7 SPACES = 28 SPACES / 7 SPACES = 4 TREES	<b>TOTAL TREE UNITS</b> = 33.95 + 4 = 37.95
<b>PROPOSED PARKING LOT TREES</b> = 6 TREES	<b>EXISTING TREE CANOPY</b> = 1,330 S.F. <b>PROPOSED TREE CANOPY</b> = 7,910 S.F. <b>PROPOSED CANOPY TOTAL</b> = 9,240 S.F.
<b>REQUIRED EVERGREEN SHRUBS</b> = 1 SHRUB PER 4 L.F. OF LANDSCAPE STRIP = 541 L.F. / 4 L.F. = 136 SHRUBS	<b>TOTAL SITE</b> = 48,190 S.F. <b>PERCENT CALCULATION:</b> (9,240 S.F./48,190 S.F.) * 100 = 19.2%
<b>PROPOSED EVERGREEN SHRUBS</b> = 136	<b>EXISTING TREE LIST (TO REMAIN)</b> -6\" HW (x5)/ 1.35 UNITS PER TREE/ 6.75 TOTAL UNITS -10\" PINE (x2)/ 1.95 UNITS PER TREE/ 3.9 TOTAL UNITS -16\" PINE (x2)/ 4.2 UNITS PER TREE/ 8.4 TOTAL UNITS -18\" PINE (x1)/ 5.4 UNITS PER TREE/ 5.4 TOTAL UNITS

**GENUS CALCULATIONS:**

REQUIREMENT: NO MORE THAN 33.3% OF ONE GENUS SHALL OCCUPY THE SITE.

GENUS	PERCENT
ACER	30.8%
ZELKOVA	11.5%
CORNUS	30.8%
PINUS	26.9%

REV.	DATE	DESCRIPTION
3	02/05/2020	REVISED PLANTING LEGEND AND CALCULATIONS
2	12/13/2019	REVISED PER GWINNETT COUNTY COMMENTS
1	10/16/2019	REVISED LANDSCAPE PLAN

**THE SOUTHEAST CIVIL GROUP**  
 ENGINEERING • CONSULTING  
 8805 BALDWIN PARKWAY, SUITE 2014  
 DUBLIN, GEORGIA 30128  
 PHONE: 478-276-0898  
 EMAIL: INFO@SECGROUP.COM

**GEORGIA**  
 REGISTERED PROFESSIONAL ENGINEER  
 No. 61102  
 MICHAEL G. FURLEY

**GWINNETT COUNTY**  
 Department of Planning and Development  
 These project documents have been reviewed by applicable County Departments and have been found to be in substantial compliance with the applicable codes and regulations.  
 Jun 02, 2020  
 AUTHORIZED

**3020 FIVE FORKS TRICKUM ROAD**

LOCATED IN L1, S7, DISTRICT 06  
 GWINNETT COUNTY, GEORGIA

JOB #: 181101  
 SCALE: 1"=20'  
 DATE: 5/17/2019  
 DESIGN BY: MGF

SHEET: C-5.0