

LEGEND	
1033 CATCH BASIN	OVERGROUND DOWNSPOUT
1034 CATCH BASIN	WATER VALVE
1034 DRIP INLET	GAS VALVE
1011A JUNCTION BOX	HANDICAPPED PARKING
1011A TYPE E CURB INLET	TRAFFIC FLOW
1125 HEADWALL	UNDERGROUND POWER
DRAINAGE SLOPE	OVERHEAD POWER
SEWER MANHOLE	UNDERGROUND TELEPHONE
EXISTING FIRE HYDRANT	OVERHEAD TELEPHONE
PROPOSED FIRE HYDRANT	WATER
LAMP POST	SANITARY SEWER
QUIF POLE	FORCE MAIN
UTILITY POLE	GAS
UNDERGROUND DOWNSPOUT	STORM DRAIN
SEMENT BARRIER	TREE PROTECTION FENCE
PROPOSED FENCE	EXISTING FENCE
PROPERTY LINE	EXISTING CONTOUR
PROPOSED CONTOUR	PROPOSED CURB & GUTTER
EXISTING CURB & GUTTER	PROPOSED CURB & GUTTER
EXISTING SPOT ELEVATION	PROPOSED SPOT ELEVATION
EXISTING WATER METER	PROPOSED WATER METER
MANHOLE	GAS METER
GAS METER	POWER METER

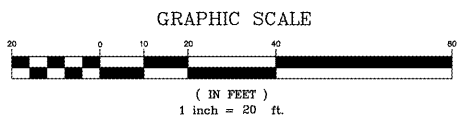

- NOTE:
- BOUNDARY INFORMATION SHOWN OBTAINED FROM BOUNDARY SURVEY PREPARED BY BOUNDARY ZONE, INC., DATED 09/13/2016.
  - TOPOGRAPHIC DATA OBTAINED FROM FIELD SURVEY PERFORMED BY THE SOUTHEAST CIVIL GROUP, LLC.
  - THE F.I.R.M. PANEL 133500115F DATE 09/29/2006 INDICATES THIS PROPERTY OR A PORTION IS NOT LOCATED IN A FLOOD HAZARD AREA.
  - THE U.S. FISH & WILDLIFE NATIONAL WETLANDS INVENTORY MAP HAS BEEN CONSULTED, AND NO WETLANDS ARE SHOWN TO BE PRESENT WITHIN PROJECT LIMITS.



NOTE: UTILITIES SHALL BE LOCATED UNDERGROUND

Department of Water Resources

654 West Peachtree Highway • Lawrenceville, GA 30045-5042  
770.762.7970 • www.gwinnettdwr.com

**Fire Flow Test Report** Report Date: 10/17/2019

Work Request #: 19-010675

Development Type: Commercial Test Type: Dual Hydrant Test Date: 10/17/2019

Main Size: 16.00 in Test Valid Until: 10/17/2020

Location: 3020 FIVE FORKS TRUCKUM RD Parcel ID: 6087 002

Start Time: 9:50 am End Time: 9:50 am Total Flow Time: 5:00 min

Residual Hydrant ID: 33601 Static Pressure (psi): 120.00 Residual Pressure (psi): 115.00

Flow @ 20 psi (gpm): 3445.4 Flow Rate (gpm): 1,760.40

Flow Hydrant ID	Pitot Pressure	Nozzle Size (in)	Coefficient	Conversion Factor	Test Flow (gpm)
3445.4	110.00	2.90	29.94	1760.40	

Flow Hydrant Results

- UTILITY NOTES**
- CONTRACTOR SHALL FIELD VERIFY ALL EXISTING UTILITY LOCATIONS & INVERTS PRIOR TO CONSTRUCTION.
  - CONTRACTOR TO CONFIRM LOCATION & ELEVATION OF UTILITIES INTO BUILDING WITH PLUMBING PLANS PRIOR TO CONSTRUCTION.
  - CONTRACTOR TO FIELD VERIFY ALL DIMENSIONS PRIOR TO CONSTRUCTION.
  - CONSTRUCTION & MATERIALS SHALL COMPLY WITH THE APPROPRIATE GOVERNING AUTHORITY'S STANDARDS & SPECIFICATIONS.
  - UTILITIES LOCATIONS SHOWN ARE APPROXIMATE. BEWARE OF HIDDEN UTILITIES NOT SHOWN. CONTACT APPROPRIATE UTILITY COMPANIES PRIOR TO EXCAVATION.
  - BUILDING FOOTPRINT SHOWN IS APPROXIMATE. SEE ARCHITECTURAL PLANS.

- GWINNETT COUNTY WATER NOTES**
- THE DESIGNER AND DEVELOPER ACKNOWLEDGE THAT ALL WORK REPRESENTED IN THESE CONSTRUCTION DOCUMENTS HAS BEEN DESIGNED TO FULLY COMPLY WITH THE CURRENT GWINNETT COUNTY WATER MAIN AND SANITARY SEWER DESIGN AND CONSTRUCTION STANDARDS AND SPECIFICATIONS. ACTUAL FIELD CONDITIONS COULD INDICATE MORE STRINGENT REQUIREMENTS. IF DEEMED NECESSARY BY THE COUNTY INSPECTOR, IN CASE OF CONFLICT BETWEEN THE PERMITTED DOCUMENTS AND THE CURRENT GWINNETT COUNTY WATER MAIN AND SANITARY SEWER DESIGN AND CONSTRUCTION STANDARDS AND SPECIFICATIONS, THE COUNTY SPECIFICATIONS SHALL GOVERN THE RIGHTS AND OBLIGATIONS OF THE PARTIES.
  - DOUBLE CHECK BACKFLOW PREVENTION DEVICES FOR ALL METERS AND/OR FIRE LINES MUST BE TESTED AND APPROVED BEFORE ISSUANCE OF FINAL CERTIFICATE OF OCCUPANCY.
  - PER THE FEE RESOLUTION THERE IS A 'PENALTY FEE' OF 100% OF THE PERMIT FEE FOR SITE ACTIVITY PRIOR TO ISSUANCE OF APPROPRIATE PERMITS. (LAND DISTURBANCE, DEVELOPMENT, UTILITY CONSTRUCTION, OR GREASE TRAP INSTALLATIONS)
  - ALL WATER, SANITARY SEWER AND STORM SEWER TO BE INSPECTED BY DEPARTMENT OF WATER RESOURCES.

- GWINNETT COUNTY SANITARY SEWER NOTES**
- THE DESIGNER AND DEVELOPER ACKNOWLEDGE THAT ALL WORK REPRESENTED IN THESE CONSTRUCTION DOCUMENTS HAS BEEN DESIGNED TO FULLY COMPLY WITH THE CURRENT GWINNETT COUNTY WATER MAIN AND SANITARY SEWER DESIGN AND CONSTRUCTION STANDARDS AND SPECIFICATIONS. ACTUAL FIELD CONDITIONS COULD INDICATE MORE STRINGENT REQUIREMENTS. IF DEEMED NECESSARY BY THE COUNTY INSPECTOR, IN CASE OF CONFLICT BETWEEN THE PERMITTED DOCUMENTS AND THE CURRENT GWINNETT COUNTY WATER MAIN AND SANITARY SEWER DESIGN AND CONSTRUCTION STANDARDS AND SPECIFICATIONS, THE COUNTY SPECIFICATIONS SHALL GOVERN THE RIGHTS AND OBLIGATIONS OF THE PARTIES.
  - A UTILITY CONSTRUCTION PERMIT IS TO BE ACQUIRED BY THE APPROVED CONTRACTOR PRIOR TO INSTALLATION. CALL 678-519-8174 FOR INFORMATION AND COPY OF APPROVED CONTRACTOR'S LIST. A MANDATORY PRE-CONSTRUCTION CONFERENCE WITH INSPECTOR, BY APPOINTMENT ONLY, IS REQUIRED 48 HOURS PRIOR TO ANY UTILITY CONSTRUCTION. ANY UTILITY DESIGN CHANGES MUST BE APPROVED BY THE WATER AND SEWER REVIEW SECTION OF PAD PRIOR TO INSTALLATION.
  - IN THE FIRST NEWLY INSTALLED MANHOLE UPSTREAM OF THE EXISTING TIE-IN MANHOLE, CONTRACTOR SHALL INSTALL TEMPORARY MECHANICAL PLUGS ON THE INFLOW AND OUTFLOW INVERTS. SAID MECHANICAL PLUGS SHALL BE TIED TO MANHOLE STEP WITH STEEL CABLE AND PADLOCKED TO PREVENT TAMPERING AND GODWR SHALL INSTALL A LOCKING COVER.
  - AS-BUILT/RECORD DRAWINGS FOR SEWER SYSTEM REQUIRED PRIOR TO REQUESTING FINAL PLAT APPROVAL, TEMPORARY CERTIFICATE OF OCCUPANCY OR ISSUANCE OF CERTIFICATE OF OCCUPANCY. ALLOW A MINIMUM 6 WEEKS FOR INITIAL REVIEW AND ADDITIONAL TIME FOR RE-REVIEW(S). DRAWINGS TO BE SUBMITTED TO, REVIEWED AND APPROVED BY DEPARTMENT OF WATER RESOURCES.
  - PER THE FEE RESOLUTION THERE IS A 'PENALTY FEE' OF 100% OF THE PERMIT FEE FOR SITE ACTIVITY PRIOR TO ISSUANCE OF APPROPRIATE PERMITS. (LAND DISTURBANCE, DEVELOPMENT, UTILITY CONSTRUCTION, OR GREASE TRAP INSTALLATIONS)
  - EXTERIOR GREASE TRAPS WILL BE REQUIRED FOR ALL ESTABLISHMENTS PROVIDING FOOD SERVICE.
  - ALL WATER, SANITARY SEWER AND STORM SEWER TO BE INSPECTED BY DEPARTMENT OF WATER RESOURCES.
  - THERE ARE NO UPGRADE UN-SEWERED PROPERTIES ASSOCIATED WITH OR ADJACENT TO THIS PROJECT.

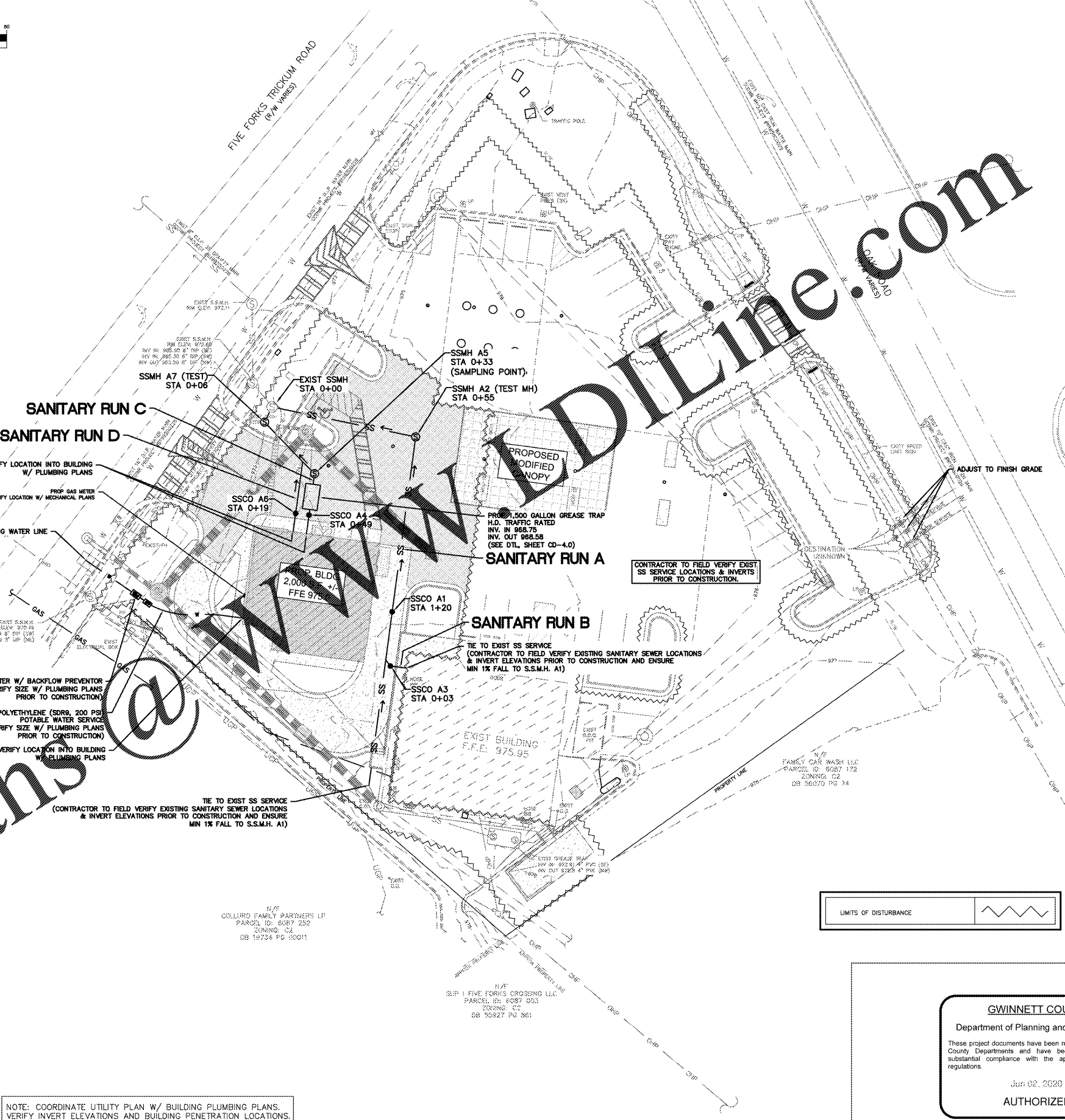

NOTE: COORDINATE UTILITY PLAN W/ BUILDING PLUMBING PLANS. VERIFY INVERT ELEVATIONS AND BUILDING PENETRATION LOCATIONS.

NOTE: THIS SITE PLAN INDICATES POTABLE WATER SERVICE LINES AND SANITARY SEWER LATERALS. GEORGIA STATE LAW REQUIRES THIS WORK TO BE INSTALLED BY A GEORGIA LICENSED MASTER PLUMBER. THIS PLUMBING INSTALLATION REQUIRES A SEPARATE SITE PLUMBING PERMIT WHICH CAN BE OBTAINED FROM THE GWINNETT COUNTY BUILDING PERMITS. ALL WORK SHALL BE INSPECTED BY THE GWINNETT COUNTY PLUMBING INSPECTIONS.

NOTE: THERE ARE NO UPGRADE UN-SEWERED PROPERTIES ADJACENT TO THIS PROJECT. SANITARY SEWER MAIN NOR SANITARY SEWER EASEMENTS ARE PROPOSED.

H.M.F.O.  
MICHAEL FORLAW, PE  
DATE: 5/17/2019

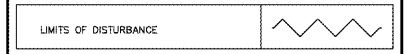

GWINNETT COUNTY  
Department of Planning and Development

These project documents have been reviewed by applicable County Departments and have been found to be in substantial compliance with the applicable codes and regulations.

Jun 02, 2020

AUTHORIZED

3020 FIVE FORKS TRUCKUM ROAD

LOCATED IN 41.87 DISTRICT 06 GWINNETT COUNTY, GEORGIA

REV.	DATE	DESCRIPTION
4	03/30/2020	REVISED PER WATER AND SEWER COMMENTS
3	02/05/2020	REVISED PER GWINNETT COUNTY COMMENTS
2	12/13/2019	REVISED PER GWINNETT COUNTY COMMENTS
1	10/16/2019	REVISED UTILITY PLAN



**THE SOUTHEAST CIVIL GROUP**

ENGINEERING • CONSULTING

8802 BALDWIN PARKWAY, SUITE 201-A  
DUBLIN, GA 31009  
PHONE: 478-854-8888  
EMAIL: INFO@SECGROUP.COM

JOB #: 181101

SCALE: 1"=20'

DATE: 5/17/2019

DESIGN BY: MGF

SHEET: C-4.0