

NOTE: UTILITIES SHALL BE LOCATED UNDERGROUND

**6957M2 Trench Grate**

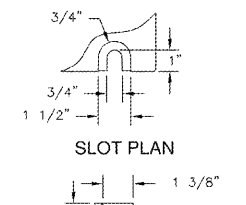
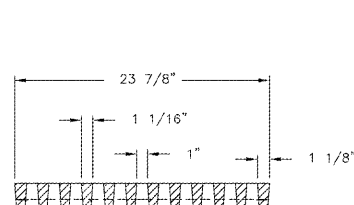
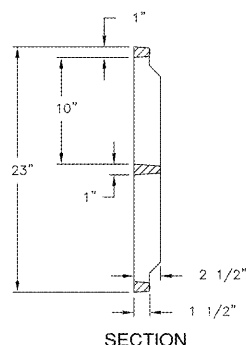
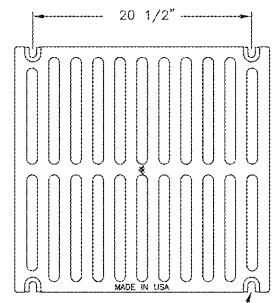

Product Number  
06957M2  
Design Features  
- Materials  
- Frame Iron (CS-50B)  
- Design Load  
- Heavy Duty  
- Open Area  
- 2 1/2 Sq. inches  
- Coating  
- Landscaped  
- Designated Manufacture Surface

Certification  
- ASTM A48  
-  
- Country of Origin USA

Drawing Revision  
04/15/2012, Designer: SHB  
10/24/2015, Revised By: DVS

SCALE:  
VERT: 1" = 2'  
HORZ: 1" = 20'

**GRAPHIC SCALE**

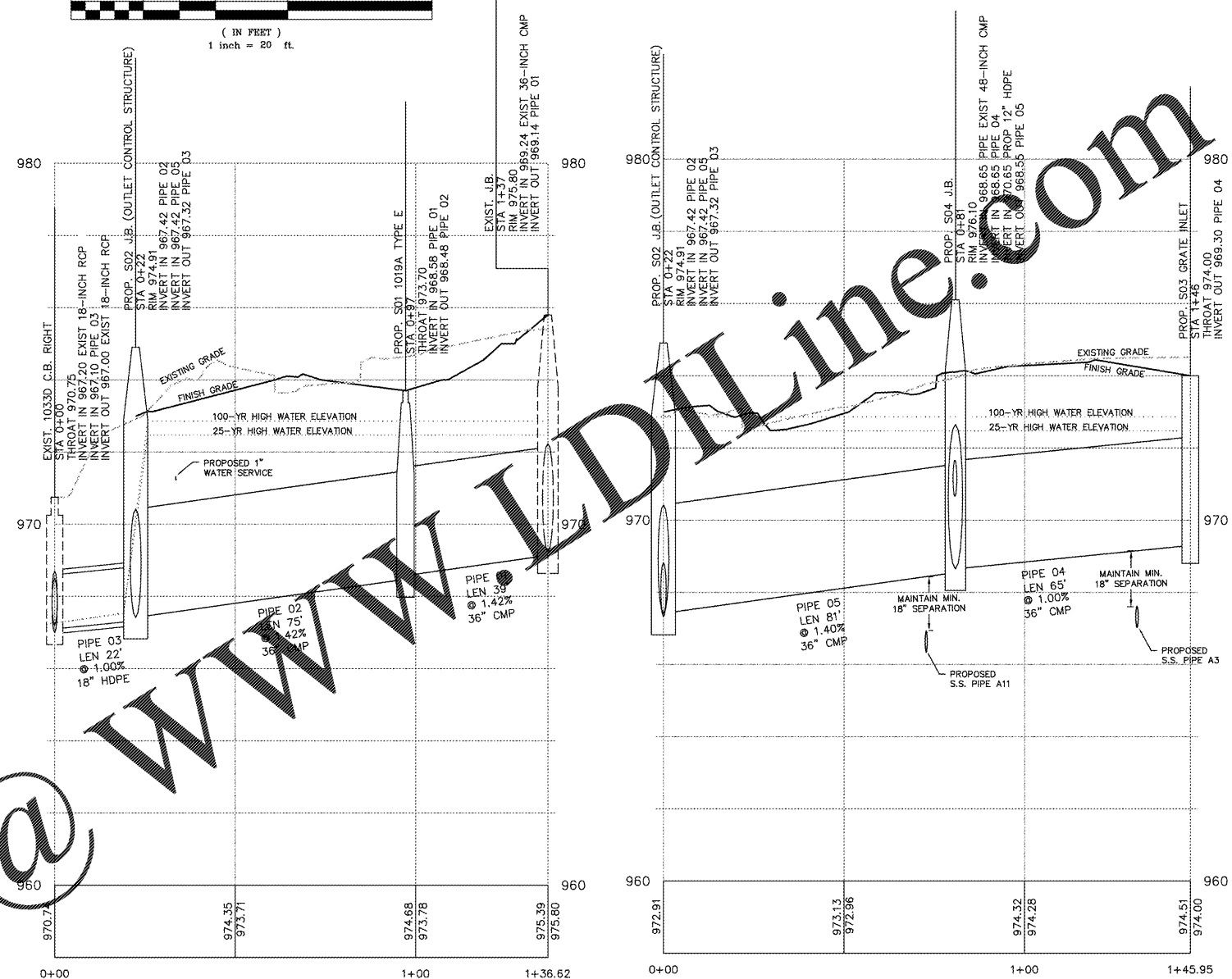
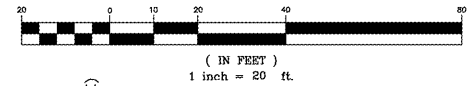

**Storm Sewer Tabulation-25 YR**

Station	Line	To Line	Len (ft)	Drng Area (ac)	Rooft coeff (C)	Area x C	Tc	Rain (in/hr)	Total flow (cfs)	Cap full (cfs)	el (ft/s)	Pipe Size (in)	Slope (%)	Invert Elev (ft)	HGL Elev (ft)	Grnd / Rim Elev (ft)	Line ID				
EXIST SWCB	EXIST JB	10,967	0.40	2.06	0.95	0.38	1.96	5.0	1031.2	0.4	0.88	10.52	2.80	18	1.00	968.89	967.23	967.34	968.89	970.75	EXIST 18-INCH RCP

**Storm Sewer Tabulation-100 YR**

Station	Line	To Line	Len (ft)	Drng Area (ac)	Rooft coeff (C)	Area x C	Tc	Rain (in/hr)	Total flow (cfs)	Cap full (cfs)	el (ft/s)	Pipe Size (in)	Slope (%)	Invert Elev (ft)	HGL Elev (ft)	Grnd / Rim Elev (ft)	Line ID				
EXIST SWCB	EXIST JB	10,967	0.40	2.06	0.95	0.38	1.96	5.0	1031.2	0.4	0.88	10.52	2.80	18	1.00	968.89	967.23	967.34	968.89	970.75	EXIST 18-INCH

**GRADING & STORM DRAINAGE NOTES**

- FOR STRUCTURE TYPE, PIPE SIZES & INVERT ELEVATIONS SEE PROFILE.
- ALL STORM DRAIN PIPE SHALL BE HDPE PER GADOT SPECIFICATION 845 OR ALUMINUM COATED TYPE 2 CORRUGATED STEEL PIPE PER GADOT SPECIFICATION 844.08. MINIMUM CMP PIPE THICKNESS SHALL BE 14 GAUGE.
- ALL STORM DRAIN PIPE SHALL CONFORM TO GADOT STANDARD 1030D OR 1030P FOR STRUCTURAL REQUIREMENTS.
- ALL PRECAST STRUCTURES SHALL BE PER GADOT STANDARD 1040.
- "GRATE INLET" SHALL HAVE GDOT STANDARD 1019A FRAME AND GRATE.
- ALL DISCHARGE HEADWALLS TO BE ENERGY DISSIPATING HEADWALL UNLESS NOTED OTHERWISE.
- COMPACTION STANDARDS:
  - ALL FILL TO BE COMPACTED TO 95% STANDARD PROCTOR.
  - THE TOP 2' OF ALL AREAS TO RECEIVE PAVEMENT OR STRUCTURES SHALL BE COMPACTED TO 100% STANDARD PROCTOR DENSITY.
- ALL SPOT ELEVATIONS SHOWN AT CURBS REPRESENT ELEVATION OF GUTTER AT FACE OF CURB UNLESS NOTED OTHERWISE.
- ALL PROPOSED RETAINING WALLS TO BE DESIGNED BY A GEORGIA REGISTERED PROFESSIONAL ENGINEER.
- ALL RETAINING WALLS OVER 30" IN HEIGHT SHALL HAVE PEDESTRIAN GUARDRAIL.
- CONTRACTOR TO FIELD VERIFY ALL DIMENSIONS PRIOR TO CONSTRUCTION.
- CONSTRUCTION & MATERIALS SHALL COMPLY WITH THE APPROPRIATE GOVERNING AUTHORITY'S STANDARDS & SPECIFICATIONS.
- UTILITY LOCATIONS SHOWN ARE APPROXIMATE. BEWARE OF HIDDEN UTILITIES NOT SHOWN. CONTACT APPROPRIATE UTILITY COMPANIES PRIOR TO EXCAVATION.
- BUILDING FOOTPRINT SHOWN IS APPROXIMATE. SEE ARCHITECTURAL PLANS.

RAINFALL EVENT (YR)	RELEASE (CFS)	VOLUME (CF)	ELEVATION (FT)
1	1,853	3,004	970.96
2	1,749	3,747	971.34
5	3,196	4,723	971.87
10	5,148	5,250	972.17
25	7,940	5,798	972.47
50	10,17	6,100	972.71
100	12.44	6,283	972.86

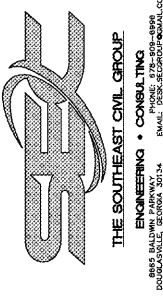
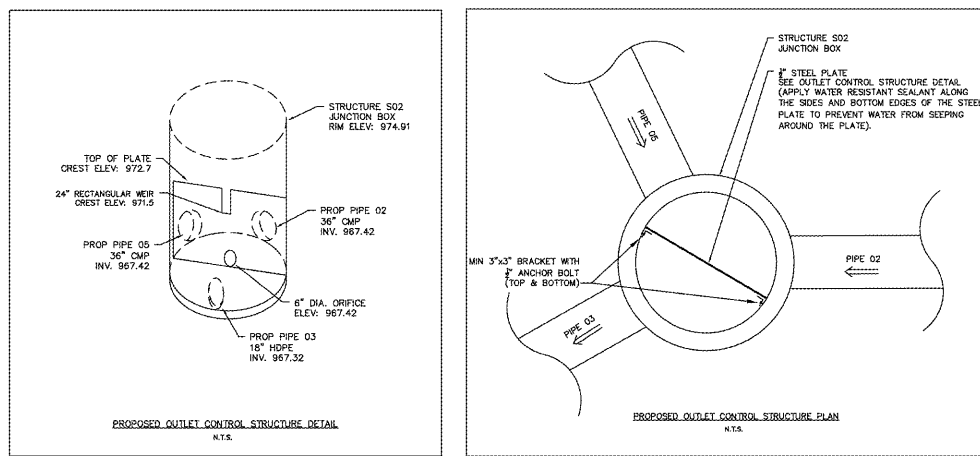

JOB #: 181101  
SCALE: AS SHOWN  
DATE: 5/17/2019  
DESIGN BY: MGF

**GWINNETT COUNTY**  
Department of Planning and Development  
These project documents have been reviewed by applicable County Departments and have been found to be in substantial compliance with the applicable codes and regulations.  
Jun 02, 2020  
**AUTHORIZED**

**3020 FEE FORKS TRUCKWROAD**  
LOCATED IN LI 87, DISTRICT 06, GWINNETT COUNTY, GEORGIA