

GENERAL NOTES

- A. ROUTE DUCTWORK HIGH IN CEILING.
- B. PROVIDE BALANCING DAMPER AT ALL BRANCH TAKE OFFS.
- C. PROVIDE ACOUSTICAL DUCT LINER AS SPECIFIED ON INTERIOR SURFACE OF THE SUPPLY, EXHAUST AND RETURN AIR DUCTS IMMEDIATELY ADJACENT TO EACH ROOFTOP UNIT (RTU) AND EXTENDING FOR A DUCT LENGTH OF 10 FEET FROM EACH RTU'S DUCT CONNECTIONS.

City of Asheville Parks & Recreation
DR. WESLEY GRANT SR. CENTER EXPANSION
 285 LIVINGSTON STREET
 ASHEVILLE, NC 28801

DESIGNER
CLARK NEXSEN
 440 Martin Luther King Jr Blvd
 Macon, Georgia 31201
 478.743.8415
 www.clarknexsen.com

KEY NOTES

1. TRANSITION TO ROUND SPIRAL DUCT AFTER WALL PENETRATION.
2. DUCT TRANSITION DOWN.
3. DUCT TRANSITION UP.
4. DUCTWORK UP TO RTU-1.
5. DUCTWORK UP TO RTU-2.
6. DUCTWORK UP TO RTU-3.
7. UP TO EF-2.
8. UP TO EF-3. ROUTE DUCT FROM 13" AFF (HIGH), COVER WITH WIRE MESH.
9. UP TO EF-4. ROUTE DUCT FROM 12" AFF (LOW), COVER WITH WIRE MESH.
10. UP TO EF-5.
11. DUCTWORK TURNS UP. SEE MH102 FOR CONTINUATION.



SUBMITTAL
 3.12.2021
CONSTRUCTION DOCUMENTS

REVISIONS

NO.	DESCRIPTION

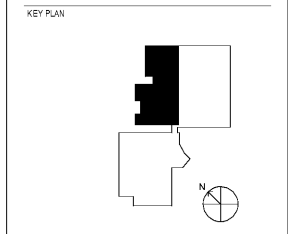

SHEET
HVAC FIRST FLOOR PLAN

MH101

GRAPHIC SCALE(S)

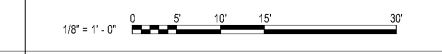

DESIGN: JPN
 DRAWN: JPN
 REVIEW: RHF
 CN 7904-A

Order Plans @ www.LDILine.com

1 FIRST FLOOR PLAN
 1/4" = 1'-0"

3/11/2021 6:16:26 PM
 C:\Users\jnh\OneDrive\Documents\7904_Southside Facilities MH101_john.nexsen.rvt