

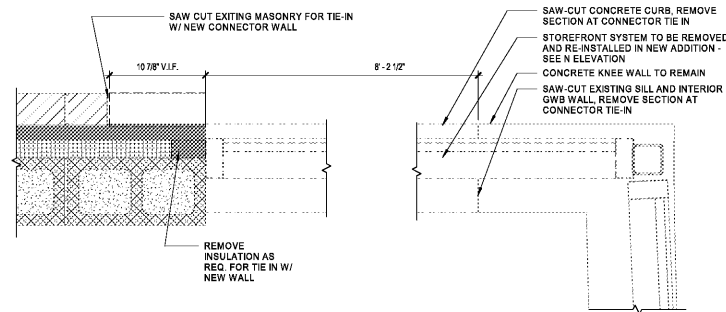

NO.	DATE	DESCRIPTION

1. ALL ITEMS SALVAGED FOR OWNER SHALL BE PRESENTED TO THE OWNER FOR THE FIRST RIGHT OF REFUSAL. IF OWNER CHOOSES TO RETAIN ITEMS, THE CONTRACTOR WILL MOVE ITEMS TO THE LOCATION OF THE OWNER'S CHOOSING ON SITE. IF OWNER CHOOSES TO NOT RETAIN ITEMS, CONTRACTOR IS TO DISPOSE OF ITEMS LEGALLY OFF SITE.
2. ALL ITEMS SALVAGED FOR REINSTALLATION SHALL BE PROTECTED FROM DAMAGE AND STORED ON SITE IN A SECURE LOCATION. ITEMS TO BE REINSTALLED WILL BE CLEANED PRIOR TO INSTALLATION. IF ITEM IS DAMAGED IN ACT OF REMOVAL FROM ITS CURRENT LOCATION, NOTIFY OWNER AND ARCHITECT IMMEDIATELY.

- EXISTING WALL TO REMAIN
- - - - - EXISTING WALL TO BE REMOVED IN ITS ENTIRETY
- X - Y - PORTION OF EXISTING WALL TO BE DEMOLISHED TO RECEIVE NEW WORK (REFER TO NEW WORK PLANS)
- EXISTING DOOR TO REMAIN
- - - EXISTING DOOR AND HARDWARE TO BE REMOVED, FRAME TO REMAIN IN PLACE (REFER TO NEW WORK FLOOR PLANS FOR DOOR TYPE)
- - - EXISTING WALL, DOOR, FRAME AND HARDWARE TO BE REMOVED IN THEIR ENTIRETY
- EXISTING PLUMBING FIXTURES TO BE REMOVED
- NEW OPENING IN EXISTING FLOOR SLAB (REFER TO STRUCTURAL)



**4 DEMO - PLAN DETAIL @ N LOBBY**  
 AD101 1 1/2" = 1'-0" REF 1 / AD101

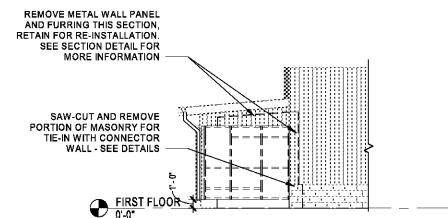

**3 DEMO - ELEVATION @ N LOBBY**  
 AD101 1/8" = 1'-0" REF 1 / AD101

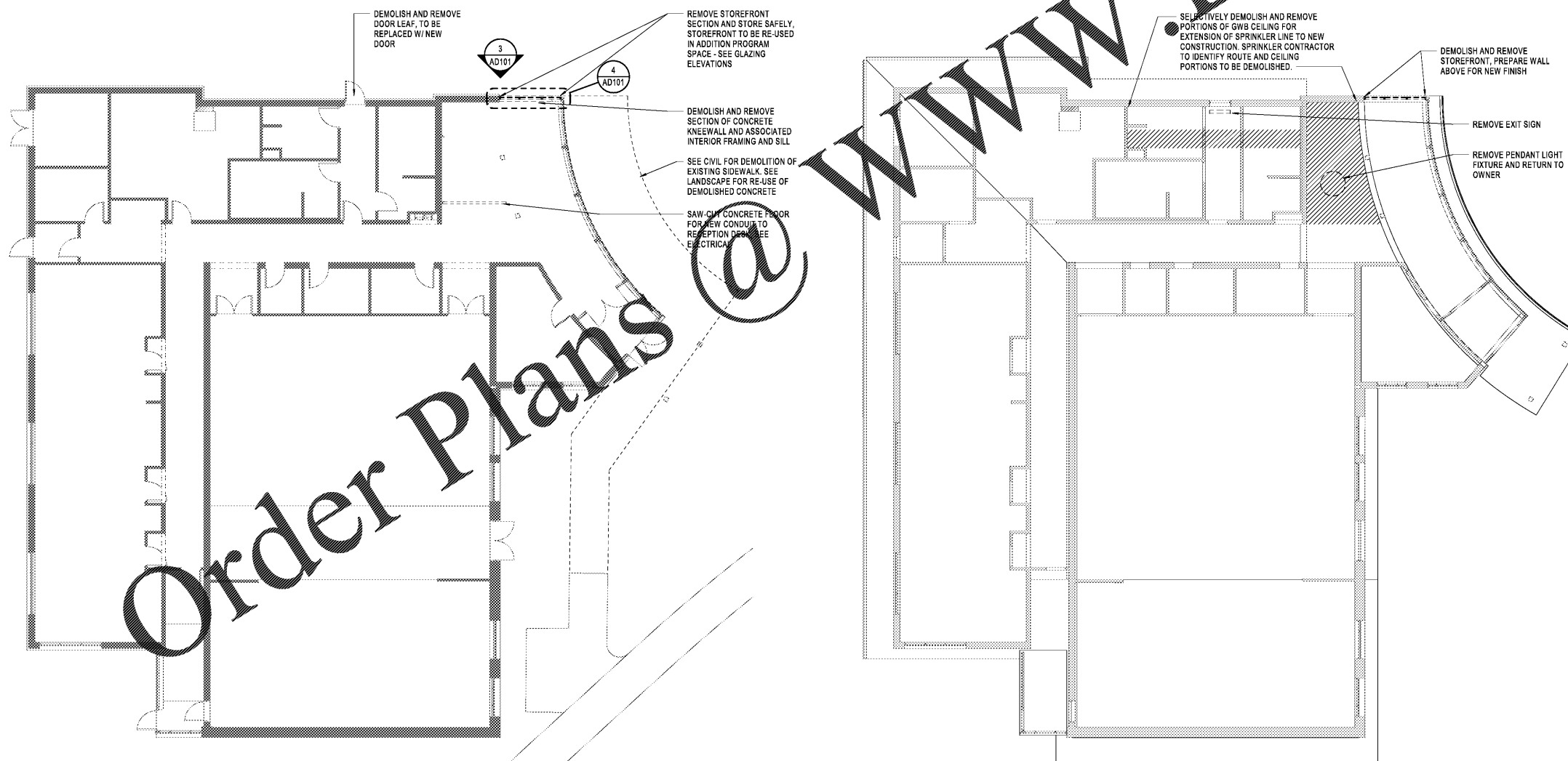

**1 DEMO - FIRST FLOOR PLAN**  
 AD101 1/8" = 1'-0" REF 3 / AD101

**2 DEMO - FIRST FLOOR REFLECTED CEILING PLAN**  
 AD101 1/8" = 1'-0" REF 3 / AD101

P:\Projects\14-001-0000\14-001-0000.dwg  
 C:\Users\adbutler\Documents\14-001-0000.dwg

Order Plans @ www.LDILine.com

www.LDILine.com