

285 LIVINGS STREET
 ASHEVILLE, NC 28801

ARCHITECTURAL SITE PLAN NOTES

1. ARCHITECTURAL SITE PLAN FOR REFERENCE ONLY - SEE CIVIL AND LANDSCAPE DRAWINGS FOR ALL SITE INFORMATION AND DETAILS.
2. ALL FENCING TO BE 6'-0" BLACK VINYL COATED CHAIN LINK FENCE. ALL GATES AT EXTERIOR FENCE PERIMETER TO HAVE PANIC HARDWARE AND KEYS LOCKS. SEE POOL DECK PLAN 2/AE201 FOR DETAILS.

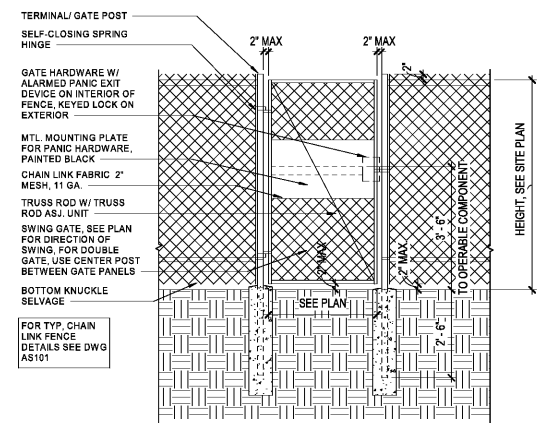

2 TYP. CHAIN LINK FENCE SWING GATE
 AS101 1/2" = 1'-0"

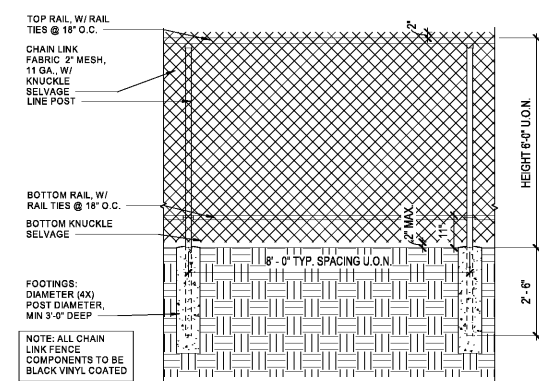

3 TYP. CHAIN LINK FENCE
 AS101 1/2" = 1'-0"

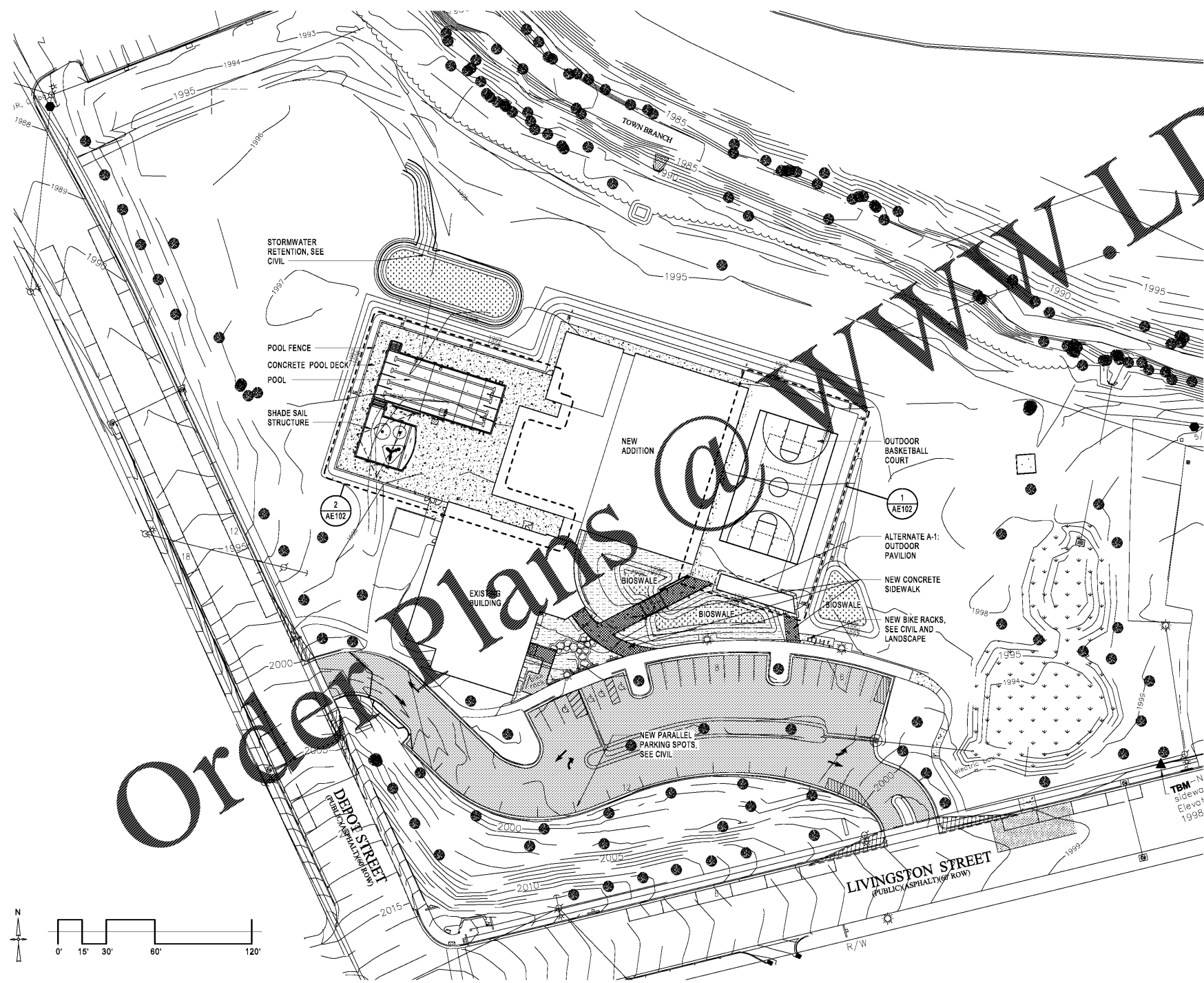

1 ARCHITECTURAL SITE PLAN
 AS101 1" = 30'-0" REF 3 / AD101

CLARK NEXSEN
 301 COLLEGE STREET, SUITE 300
 ASHEVILLE, NORTH CAROLINA 28801
 828.232.9898
 CLARK NEXSEN LICENSE NUMBER: C-1929

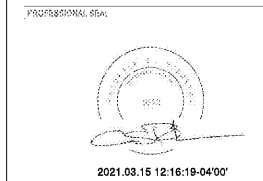

DATE: 03.12.2021
CONSTRUCTION DOCUMENTS

REVISIONS

NO.	DATE	DESCRIPTION

KEY PLAN

SHEET:
**ARCHITECTURAL SITE PLAN &
 SITE DETAILS**

AS101

DESIGN: JG
 DRAWING: JG
 REVIEW: JG
 CN 7904-A

Order Plans @ www.LDILine.com

P:\2021\03\15\12:16:19-04:00\AS101.dwg
 C:\Users\jg\OneDrive\Documents\AS101.dwg
 03/12/2021 12:16:19 PM