

DEMOLITION PLAN

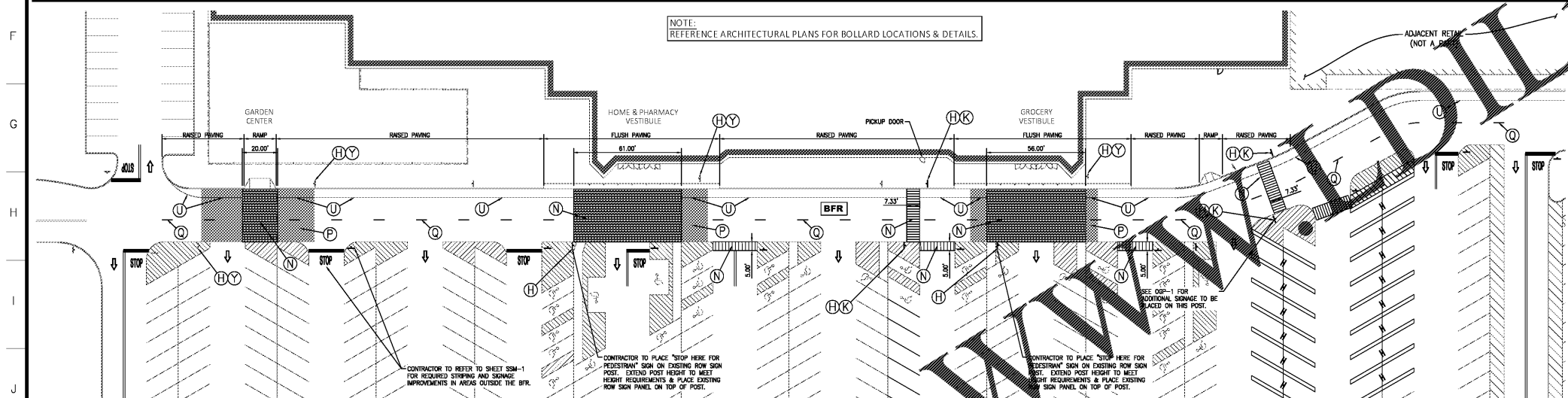

SITE PLAN

NOTES TO CONTRACTOR:

1. REFERENCE SITE CONSTRUCTION PLAN FOR SITE SPECIFIC DIMENSIONS OF CROSSWALK STRIPING AND LOCATION OF SIGNAGE.
2. PROVIDE A COMPREHENSIVE CONSTRUCTION PHASING PLAN FOR THIS WORK TO THE STORE MANAGER 7 DAYS PRIOR TO STARTING ANY WORK. IT IS TO PROVIDE FOR DATES, TIMES AND DURATION OF LANE CLOSURES, TEMPORARY VEHICLE AND PEDESTRIAN TRAFFIC CONTROL.
3. ALL EXISTING STRIPING AND PAVEMENT MARKINGS OR TEXT ALONG THE BFR (BUILDING FRONTAGE ROAD) SHALL BE REMOVED. GRIND OUT ANY DIRECTIONAL ARROWS OR STOP BARS/TEXT THAT ARE NOT CORRECTLY LOCATED OR INCONSISTENT WITH THE DETAILS PROVIDED. APPLY SEAL COAT TO THE COMPLETE EXTENT THAT THE STRIPING OR TEXT HAS BEEN REMOVED IN A SINGLE COMPLETE RECTANGLE TO COVER ALL REMOVED STRIPING (DO NOT APPLY SEAL COAT OVER EXISTING STRIPING OR CONCRETE). INSTALL NEW STRIPING AND SIGNAGE AS SHOWN ON THE SITE CONSTRUCTION PLAN.
4. ALL SIGNS LOCATED ON THE BUILDING SIDE OF THE BFR SHALL BE INSTALLED ON A SINGLE POST WITH BOLLARD.

SITE AND DEMOLITION LEGEND

- REFERENCE DETAIL SHEET
- (A) EXISTING PEDESTRIAN CROSSING SIGN TO BE REMOVED.
 - (B) EXISTING STOP SIGN TO BE REMOVED.
 - (C) EXISTING SIGN POST AND BASE TO BE REMOVED.
 - (D) EXISTING SIGN POST AND BASE TO REMAIN.
 - (E) EXISTING CROSSWALK STRIPING TO BE REMOVED.
 - (F) EXISTING YIELD PAVEMENT MARKING TO BE REMOVED.
 - (G) EXISTING CENTERLINE STRIPING TO REMAIN AND BE REFRESHED.
 - (H) NEW "STOP HERE FOR PEDESTRIANS" SIGN.
 - (I) NEW 30"x30" STOP SIGN.
 - (J) NEW SIGN MOUNTING AND BASE WITH BOLLARD.
 - (K) NEW "STOP" AND/OR "ONLY" TEXT AND STOP BAR WITH 4" DOUBLE YELLOW SOLID YELLOW LINE.
 - (L) EXISTING 4" WIDE PAINTED YELLOW STRIPES AT 45° TO REMAIN AND BE REFRESHED.
 - (M) NEW CROSSWALK MARKINGS - 6" WIDE PAINTED WHITE STRIPING PARALLEL TO DIRECTION OF TRAFFIC AT 2'-0" O.C. AND (1)-8" WHITE STRIPES PERPENDICULAR ON BOTH ENDS UNLESS NOTED OTHERWISE. SEE SITE PLAN FOR DIMENSIONS. ENTIRE CROSSWALK SHALL BE RE-STRIPED INCLUDING "NO PARKING FIRELANE" AND "NO RED STRIPES TO MATCH EXISTING.
 - (N) LIMITS OF SEAL COAT. APPLY SEAL COAT OVER WHERE STRIPING AND PAVEMENT MARKINGS WERE REMOVED AND WHERE NEW STRIPING AND PAVEMENT MARKINGS WILL BE APPLIED. APPLY NEW STRIPING AND PAVEMENT MARKINGS OVER SEAL COAT.
 - (O) NEW 4" WIDE PAINTED YELLOW STRIPES - 6' LONG WITH 18" GAPS.
 - (P) EXISTING STOP BAR AND STOP TEXT PAVEMENT MARKINGS / DOUBLE YELLOW LINES TO BE REMOVED.
 - (Q) NEW OPEN ARROW PAVEMENT MARKINGS.
 - (R) EXISTING ARROW PAVEMENT MARKINGS TO BE REMOVED.
 - (S) EXISTING FIRE LANE STRIPING AND/OR YELLOW STRIPING TO REMAIN AND BE REFRESHED.
 - (T) NEW 4" WIDE DOUBLE SOLID YELLOW STRIPES.
 - (U) EXISTING STOP SIGN TO REMAIN AND BE REUSED.
 - (V) EXISTING STOP SIGN TO BE RAISED / RELOCATED TO MATCH CURRENT DETAILS/GUIDELINES.
 - (W) EXISTING SIGN POST AND BOLLARD TO BE REPAINTED.
 - (X) NEW SIGN MOUNTING AND BASE WITH BREAK AWAY POST.
 - (Y) EXISTING PICKUP PAVING MARKINGS TO BE REMOVED.
 - (Z) NEW 36" X 36" STOP SIGN WITH DOUBLE SIGN MOUNTING, BREAK AWAY POST, AND BASES.
 - (AA) NEW ODP CROSSWALK MARKINGS, SEE DETAIL.
 - (AB) EXISTING ISLAND STRIPING TO BE REMOVED.
 - (AC) NEW CHANNELIZATION AT ODP DOOR, SEE DETAIL.
 - (AD) EXISTING STOP PAVEMENT MARKINGS "STOP" TEXT AND/OR "ONLY" TEXT TO BE REUSED/REFRESHED TO MATCH CURRENT DETAILS.
 - (AE) EXISTING CROSSWALK TO REMAIN AND BE REFRESHED.
 - (AF) EXISTING OPEN ARROW PAVEMENT MARKINGS TO BE REUSED/REFRESHED TO MATCH CURRENT DETAILS.
 - (AG) EXISTING MISCELLANEOUS TRAFFIC AND/OR INFORMATION SIGN TO REMAIN AND BE REUSED.
 - (AH) NEW ALL WAY PLaque.
 - (AI) NEW TRAFFIC FROM RIGHT DOES NOT STOP PLaque.
 - (AJ) NEW ONCOMING TRAFFIC DOES NOT STOP PLaque.
 - (AK) NEW CROSS TRAFFIC DOES NOT STOP PLaque.
 - (AL) EXISTING SOLID ARROW PAVEMENT MARKINGS TO BE REUSED/REFRESHED TO MATCH CURRENT DETAILS.
 - (AM) EXISTING 4" WIDE DOUBLE YELLOW AND/OR WHITE SINGLE STRIPED TO REMAIN / BE REFRESHED.
 - (AN) NEW SOLID ARROW PAVEMENT MARKING.
 - (AO) EXISTING NO PARKING FIRE LANE SIGN TO REMAIN.
 - (AP) EXISTING PICKUP GRAPHIC AND ORANGE ARROW PAVEMENT MARKINGS TO REMAIN (NOT TO BE REFRESHED).
 - (AQ) EXISTING PICKUP SIGN TO REMAIN.
 - (AR) NEW "STOP" TEXT AND STOP BAR.
 - (AS) TRIM TREE TO IMPROVE VISIBILITY TO SIGN.
 - (AT) EXISTING LANE STRIPING TO BE REFRESHED.
 - (AU) EXISTING CENTERLINE STRIPING TO BE REMOVED.
 - (AV) NEW TRAFFIC FROM LEFT DOES NOT STOP PLaque.
 - (AW) NEW "ONLY" PAVEMENT MARKING.

| REVISION | BY |
|----------|----|
| | |
| | |
| | |
| | |

914 E Bayou Road
 Thibodaux, LA 70301
 Office: 985-447-0060
 Fax: 985-447-7009
 www.ddgpc.com



Signature: *[Signature]*
 DATE: 03-31-2021
 STAMP: [Professional Engineer Seal]

SUPERCENTER #00483-249
 1903 COBBS FORD RD
 PRATTVILLE, ALTAUGA COUNTY, ALABAMA
 WAL-MART STORES, INC.
 BENTONVILLE, AR



| | |
|-------------|------------------|
| DRAWN | GJP |
| CHECKED | GRL |
| ISSUED DATE | 09-21-21 |
| ISSUED FOR | PERMIT |
| PROJECT NO. | 20-556 |
| FILE | 20-556 SITE PLAN |
| SHEET | SECP-1 |

DEMOLITION & SITE CONSTRUCTION PLAN

Order Plans @ www.ddgpc.com

J:\CAD\DWG\WAL-MART\2020\20-556\20-556 SITE PLAN.dwg