

| KEYNOTES | SHEET NOTES |
|---|--|
| 10.44 PROVIDE TACTILE "EXIT" SIGN. REF H1 | <ol style="list-style-type: none"> ALL ELECTRICAL WORK INCLUDING DATA AND POWER DISCONNECTION BY GC. REMOVAL AND REINSTALLATION OF POWER POLES BY GC. INSTALLATION OF NEW POWER POLES BY GC. ALL REGISTERS TO BE REMOVED AND REINSTALLED OR INSTALLED NEW BY WALMART. GENERAL CONTRACTOR RESPONSIBLE FOR ALL ELECTRICAL WORK. GENERAL CONTRACTOR RESPONSIBLE FOR ANCHORS AND ALL GONDOLA ANCHORAGE. GENERAL CONTRACTOR TO REPAIR FLOOR AS REQUIRED AT LOCATIONS OF REMOVED REGISTERS AND FIXTURES. GENERAL CONTRACTOR TO REFER TO FIXTURE ANCHORAGE PLAN FOR ANCHORAGE REQUIREMENTS. GENERAL CONTRACTOR TO ACCESS GENERAL CONTRACTOR PERMIT INFORMATION FOLDER ON WORKSPACE FOR GRID WALL INSTALLATION INSTRUCTIONS. GENERAL CONTRACTOR TO INSTALL RAILING PER MANUFACTURER'S RECOMMENDATIONS AND INSTRUCTIONS FOR INSTALLATION AND ANCHORING. CAULK BASES AND ALL CHECKOUTS TO FLOOR WHEN LOCATIONS FINISHED. |

SGA Design Group, P.C.
1437 South Boulder, Suite 550
Tulsa, Oklahoma 74116
T: (918) 587-8800
F: (918) 587-8901
www.sgadesigngroup.com

STIPULATION FOR REUSE
THIS DRAWING IS THE PROPERTY OF SGA DESIGN GROUP. IT IS TO BE USED ONLY FOR THE PROJECT AND SITE SPECIFICALLY IDENTIFIED HEREIN. IT IS NOT TO BE REPRODUCED, COPIED, REUSED, OR TRANSMITTED IN ANY FORM OR BY ANY MEANS, ELECTRONIC OR MECHANICAL, INCLUDING PHOTOCOPYING, RECORDING, OR BY ANY INFORMATION STORAGE AND RETRIEVAL SYSTEM, WITHOUT THE WRITTEN PERMISSION OF SGA DESIGN GROUP. ANY UNAUTHORIZED REUSE OF THIS DRAWING IS PROHIBITED AND WILL BE PROSECUTED TO THE FULL EXTENT OF THE LAW.

CONSULTANTS

Walmart
PRATTVILLE, AL
1903 COBBES FORD RD
STORE NO. 0465-249
2084898 | PHOTO
2021 MAJOR PROJECT

ISSUE BLOCK

| NO. | DESCRIPTION | DATE |
|-----|-------------|------|
| | | |
| | | |
| | | |
| | | |
| | | |
| | | |
| | | |
| | | |
| | | |
| | | |
| | | |

CHECKED BY: ATRIO ATRIO
DRAWN BY: AR
PROTO CYCLE: 01/29/21
DOCUMENT DATE: 03/11/21

THE RECORD COPY OF THIS DRAWING IS TO BE KEPT AT THE OFFICES OF SGA DESIGN GROUP. THIS ELECTRONIC DOCUMENT IS RELEASED FOR THE PURPOSE OF REFERENCE, COORDINATION, AND/OR FACILITY MANAGEMENT. THIS DRAWING SHALL NOT BE CONSIDERED FINAL OR COMPLETE UNLESS IT IS SIGNED AND SEALED BY THE ARCHITECT.

STATE OF ALABAMA
ARIANE V. TATTERSHALL
8016
Ariane V. Tattershall
03/31/2021

ENLARGED PLANS AND DETAILS

SHEET: A5.4

Order Plans

WWW.WALMARTDLINE.COM

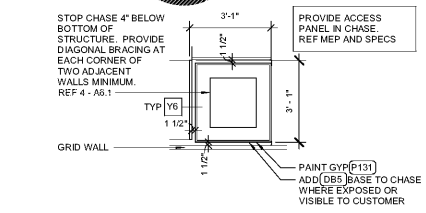

1 GR ENLARGED CHECKOUT PLAN
1/8" = 1'-0"

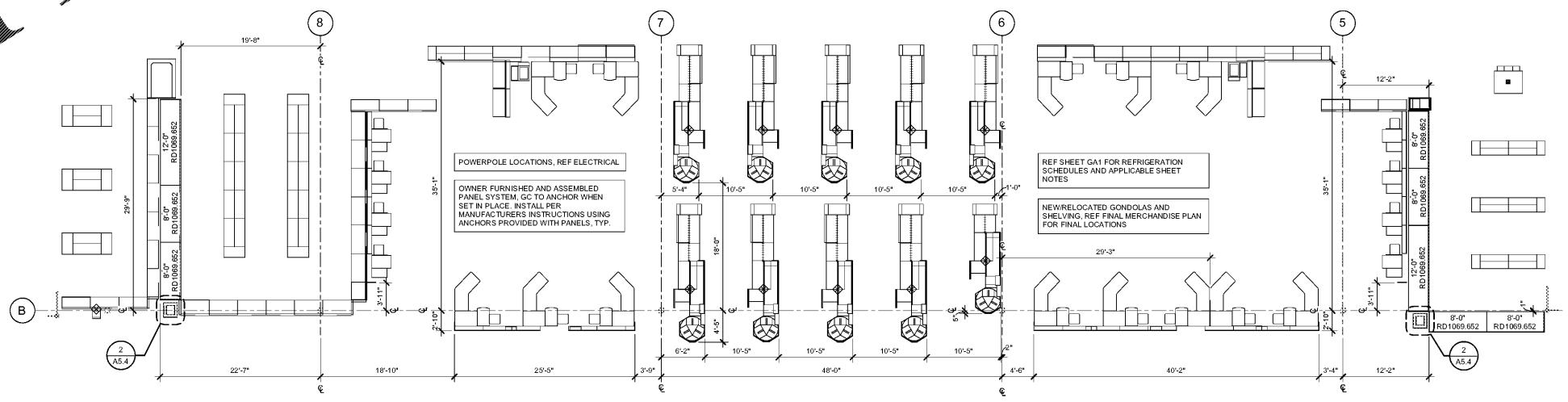

163 ALCOVE

WALLS

- PAINT ALL WALLS P209 WITH P57 WANSKOT AND DB5 BASE UNO.
- DEMISING WALL ON SALES FLOOR. PAINT P209 WITH P57 WANSKOT AND DB5 BASE. REF 1-A3.

FLOOR

- REF SHEET A1.1 FLOOR FINISH PLAN.

CEILING

- REF SHEET SA1 FOR CEILING SCHEDULE.

129 (ALCOVES TO EXIT CORRIDOR)

WALLS

- PAINT WALLS P131 TO CEILING IF EXISTING WALL HEIGHT WHERE OPEN TO STRUCTURE. PAINT TO AND WOOD ANCHORS WHERE EXISTING.

FLOOR

- REF SHEET A1.1 FLOOR FINISH PLAN

CEILING

- OPEN TO STRUCTURE. CLEAN AND PAINT EXPOSED HVAC DUCT WORK AND PLUMBING TO MATCH PAINTED STRUCTURE UNLESS SCHEDULED OR UNPAINTED.

4 ALCOVE/SITE TO STORE PLAN
1/4" = 1'-0"

3 PHOTO LAB
1/4" = 1'-0"

PREMANUFACTURED WALL SCHEDULE

| | |
|---|---------------------------------|
| A | 4'-0" LONG WALL PANEL ASSEMBLY. |
| B | 2'-0" LONG WALL PANEL ASSEMBLY. |
| C | CORNER ASSEMBLY. |
| D | 1'-0" LONG WALL PANEL ASSEMBLY. |

