

DETAIL NOTES:

1. PROVIDE 1/4" X 5 7/8" BAR, DRILLED AND TAPPED AS REQUIRED. INSULATORS SHALL BE 2.7KV RATED.

3 GROUNDING BUSS BAR
E3.1 N.T.S.

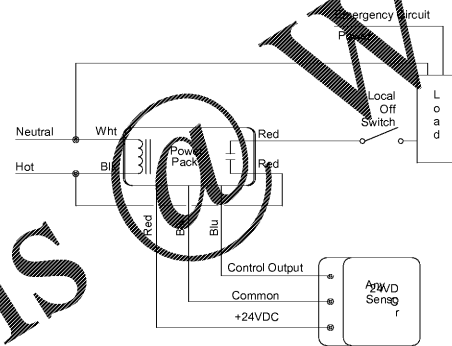

4 LIGHTING CONTROL DETAIL - POWER PACK SCHEMATIC
E3.1 N.T.S.

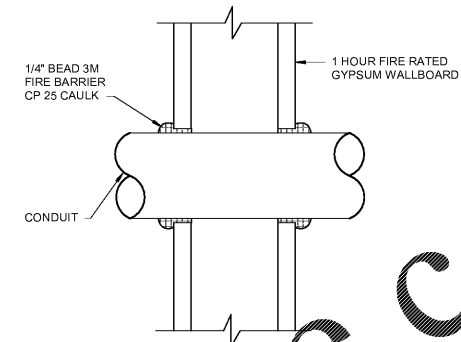

DETAIL

PENETRATION FIRESTOP FOR NOMINAL 6" DIAMETER (OR SMALLER) RIGID METAL CONDUIT OR 4" OR SMALLER EMT CONDUIT.

1 HOUR RATING UL SYSTEM # W-L-1001

1 1 HOUR RATING - WALL
E3.1 N.T.S.

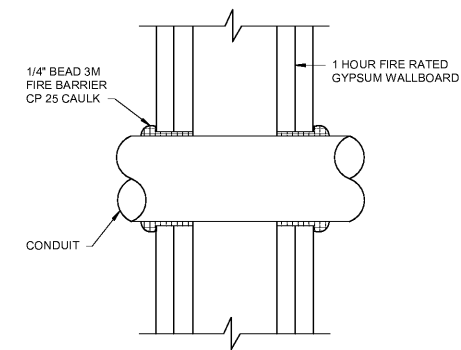

DETAIL

PENETRATION FIRESTOP FOR NOMINAL 6" DIAMETER (OR SMALLER) RIGID METAL CONDUIT OR 4" OR SMALLER EMT CONDUIT.

2 HOUR RATING UL SYSTEM # W-L-1001

2 2 HOUR RATING A - WALL
E3.1 N.T.S.

JOB NUMBER: 19221
CHECKED BY: Checker

PLANNING
ARCHITECTURE
INTERIORS

CALBERT
DESIGN GROUP

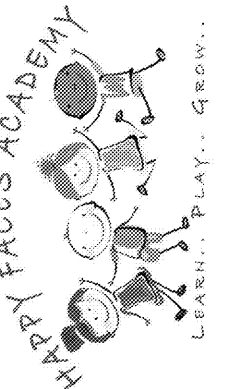

PROJECT LOCATION:

2865 WEBB ROAD
MILTON, GA 30004

REVISIONS

NO	DATE:	DESCRIPTION:

DETAILS - ELECTRICAL

E3.1

DATE 10/21/20

THOMPSON EHLE CO.
50 TECHNOLOGY PKWY
PEACHTREE CORNERS, GA 30092
Tel: 404.266.1400
TEC #22021

Order Plans

WWW.LDILine.com