

- GENERAL NOTES:**
- HVAC & LIGHTING FIXTURES SHOWN ARE FOR GRAPHIC PURPOSES ONLY. GC TO REFER TO PME DRAWINGS AND SPRINKLER PIPING SHOP DRAWINGS. NOTIFY THE ARCHITECT IMMEDIATELY OF ANY CONFLICTS OR DISCREPANCIES.
 - GC TO INSTALL WIRE HANGERS AT ALL CORNERS OF LIGHT FIXTURES, REGISTERS, AND GRILLES.
 - REFER TO INTERIOR AND EXTERIOR SECTIONS FOR ADDITIONAL CEILING DETAILS NOT NOTED ON THIS SHEET.
 - ALL RECESSED LIGHTING SHALL BE CENTERED WITHIN THE SOFFIT, U.N.O.
 - WHERE ACT IS LOCATED, ALL FIXTURES INCLUDING BUT NOT LIMITED TO MOTION DETECTORS, FIRE ALARM DEVICES, AND SPRINKLER HEADS ARE TO BE LOCATED IN THE CENTER OF THE TILE.
 - GENERAL NOTE - CENTER LIGHT FIXTURES IN ROOMS UNLESS NOTED OTHERWISE.

JOB NUMBER: 19221
CHECKED BY: RKC

- CONSTRUCTION KEY NOTES:**
- TYPICAL 2x2 ACOUSTIC TILE INTERIOR CEILING:
 - MOUNTED AT 9'-6" A.F.F.
 - MOUNTED AT 10'-0" A.F.F.
 - 5/8 INCH DRYWALL WITH SEMI-GLOSS PAINT FINISH. ATTACH DRYWALL WITH 1 1/4" DRYWALL SCREWS SPACED AT 8" O.C. MAX. ALONG JOINTS AND IN THE FIELD.
 - MOUNTED AT 9'-0" A.F.F.
 - MOUNTED AT 9'-0" A.F.F.
 - MOUNTED AT 10'-0" A.F.F.
 - MOUNTED AT 10'-0" A.F.F.
 - 1x6 TONGUE AND GROOVE LINING WITH FURRING STRIPS TO FINISH PERIMETER EDGE. STAIN TO MATCH CEILING SIDING PER SHEET A2.1.
 - WAS. SLOPE UP FLUSH WITH STRUCTURE.
 - MOUNTED AT 10'-0" A.F.F.
- GENERAL NOTE - CENTER LIGHT FIXTURES IN ROOMS UNLESS NOTED OTHERWISE.

REFLECTED CEILING LEGEND:

	EXTERIOR TONGUE & GROOVE CEILING. SEE EXTERIOR FINISH SCHEDULE.		2x4 FLOURESCENT LIGHT FIXTURE
	DRYWALL CEILING		2x4 FLOURESCENT LIGHT FIXTURE WITH BATTERY BACK-UP
	2x2' SUSPENDED ACOUSTIC CEILING SYSTEM		1x4 FLOURESCENT LIGHT FIXTURE
	BULKHEAD ABOVE - SEE STRUCT. DWGS		EMERGENCY/EXIT LIGHT
	1 HR FIRE RATED BEARING WALL - SEE S3 FOR EXACT BEARING LOCATIONS		SMOKE DETECTOR
	PULL DOWN STAIR, SEE DETAIL 12/A5.3		SUPPLY AIR DIFFUSER
	RECESSED LIGHT		RETURN AIR GRILLE
	RECESSED LIGHT WITH BATTERY BACK-UP		1x1' EXHAUST FAN
	GOOSE NECK LIGHT MOUNTED AT 9'-0" A.F.F. AT DOORS AND AT 15'-6" AFF OVER ENTRY GABLE SIGNAGE WITH BATTERY BACK-UP POWER SUPPLY		2x2' EXHAUST FAN
			FLOOD LIGHTS

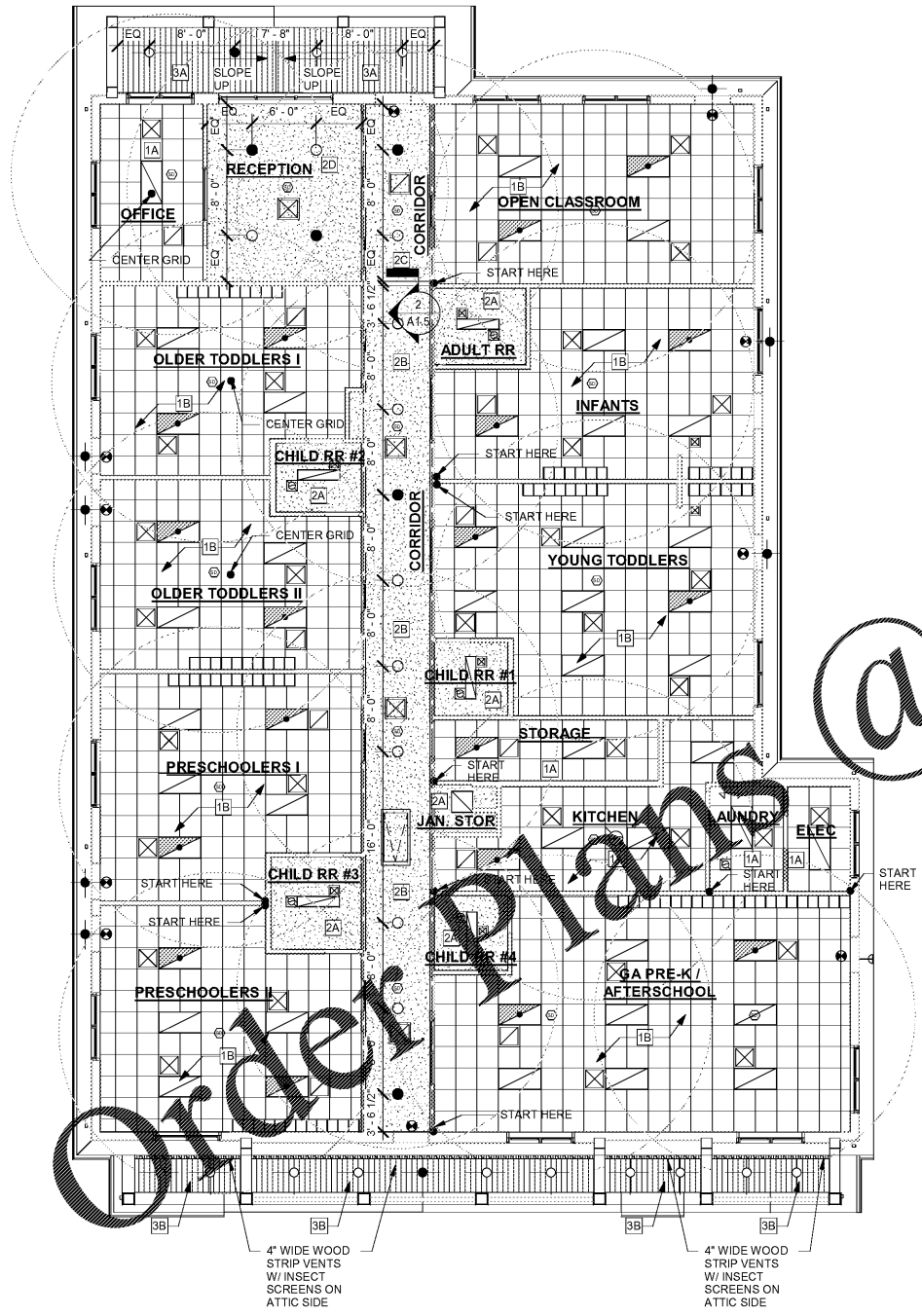

www.LDILLINE.com

1 REFLECTED CEILING PLAN
A1.5 1/8" = 1'-0"



2 SOFFIT DETAIL @ CORRIDOR
A1.5 3/4" = 1'-0"

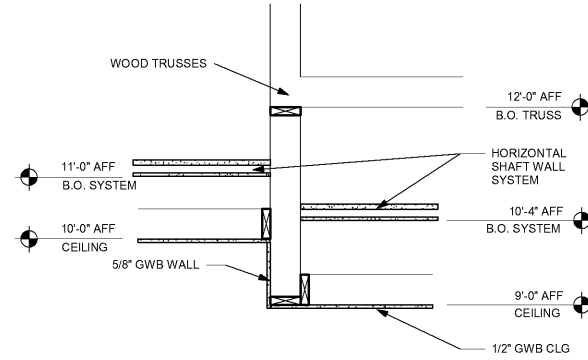

3 CONTROL JOINT DETAIL
A1.5 6" = 1'-0"

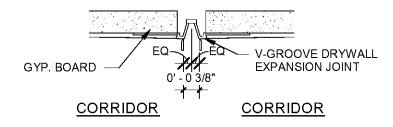

PLANNING ARCHITECTURE INTERIORS
CALBERT DESIGN GROUP
 INFO@CALBERTDESIGN.COM | 815.395.1744 | 2955 CHEVY ST. SUITE 600, KENNESAW, GA 30144

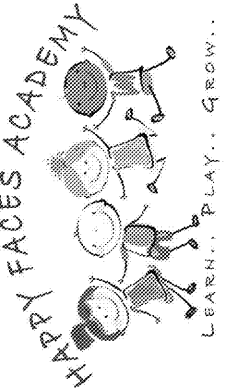

PROJECT LOCATION:
2865 WEBB ROAD
MILTON, GA 30004

REVISIONS		
NO	DATE:	DESCRIPTION:

REFLECTED CEILING PLAN
A1.5
DATE