

**GENERAL NOTES:**

- A. ALL INTERIOR DIMENSIONS ARE NOMINAL AND ARE TO FACE OF STUDS, UNO.
- B. PROVIDE BLOCKING IN WALL BEHIND ALL WALL MOUNTED FIXTURES AND CASEWORK, TYP.
- C. CONTROLS AND OPERATING MECHANISMS:  
CONTROLS SPECIFICALLY INTENDED FOR ADULTS SUCH AS INTERCOMS, THERMOSTATS, ETC. SHALL BE MOUNTED AT 48" AFF TO THE OPERATING PARTS. CONTROLS SUCH AS LIGHT SWITCHES AND ALARM CONTROLS SHALL BE MOUNTED AT 48" AFF TO THE OPERATING PARTS. VERIFY WITH OWNER PRIOR TO INSTALLATION.
- D. SECURITY SYSTEM NOTES:  
1. THIS IS A REQUIRED SYSTEM. THE OWNER IS RESPONSIBLE FOR HIRING A LICENSED SECURITY FIRM FOR THEIR SCHOOL.  
2. SECURITY SYSTEM SUBCONTRACTOR TO SEAL ALL WIRING PENETRATIONS FOR SECURITY SYSTEM AT POINTS OF CONTACT. GC TO VERIFY WORK.
- E. BUILDING ADDRESS MUST BE VISIBLE FROM THE STREET.
- F. CLEAR FLOOR SPACE COMPLYING WITH SECTION 11188.4 THAT ALLOWS A FORWARD OR PARALLEL APPROACH BY A PERSON USING A WHEELCHAIR SHALL BE PROVIDED AT CONTROLS, DISPENSERS, RECEPTACLES, AND OTHER EQUIPMENT.
- G. THE HIGHEST OPERABLE PART OF ALL CONTROLS, DISPENSER, RECEPTACLES AND OTHER OPERABLE EQUIPMENT SHALL BE WITHIN 15" AFF AND 48" AFF. SEE DETAIL 13/AS.3. IF THE CLEAR FLOOR SPACE ALLOWS ONLY FORWARD APPROACH TO AN OBJECT, THE MAXIMUM HIGH FORWARD REACH ALLOWED SHALL BE 48". THE MAXIMUM HIGH FORWARD REACH IS 15" IF THE CLEAR FLOOR SPACE ALLOWS PARALLEL APPROACH BY PERSON USING A WHEELCHAIR. THE MAXIMUM HIGH SIDE REACH ALLOWED SHALL BE 54" AND THE LOW SIDE REACH SHALL BE NO LESS THAN 9" ABOVE THE FLOOR. IF THE SIDE REACH IS OVER AN OBSTRUCTION, THE REACH AND CLEARANCES SHALL BE A MAXIMUM OF 48" HIGH AND NO LOWER THAN 34" ABOVE THE FLOOR.
- H. CONTROLS AND OPERATION MECHANISMS SHALL BE OPERABLE WITH ONE HAND AND SHALL NOT REQUIRE TIGHT GRASPING, PINCHING OR TWISTING OF THE WRIST. THE FORCE REQUIRED TO ACTIVATE CONTROLS SHALL BE NO GREATER THAN 5 POUNDS OF FORCE.
- I. ALL INTERIOR DOORS ARE LOCATED 1'-10" FROM FACE OF STUD OR ADJACENT WALL UNLESS NOTED OTHERWISE.

**KEY NOTES:**

- 1. SET FLOOR DRAINS 3/8" BELOW FINISH FLOOR UNLESS NOTED OTHERWISE. SLOPE SLAB TO DRAIN AS INDICATED. TYPICAL AT ALL FLOOR DRAINS. UNO. MAINTAIN A SLOPE OF NO MORE THAN 2% IN ALL DIRECTIONS TO COMPLY WITH A LEVEL ACCESSIBLE CLEAR FLOOR SPACE.
- 2. THE LAUNDRY ROOM AND WARMING KITCHEN: PROVIDE DRAIN AT 1/2" BELOW FINISH FLOOR. MAINTAIN A SLOPE OF NO MORE THAN 2% IN ALL DIRECTIONS TO COMPLY WITH A LEVEL ACCESSIBLE CLEAR FLOOR SPACE.
- 3. PROVIDE A KEY LOCK BOX (LIKE A "KNOX" BOX) NEAR THE FRONT ENTRANCE FOR FIRE DEPARTMENT ACCESS.
- 4. PROVIDE FLOOR SINK DRAIN PER PLUMBING DRAWINGS.

**WALL TYPE AND LOCATION IN BLDG:**

- WALL TYPE #1  
EXT. PERIMETER
- WALL TYPE #2  
EXT. PERIMETER
- WALL TYPE #3  
INTERIOR 1-HOUR  
LOAD BEARING
- WALL TYPE #4  
TYP. INTERIOR
- WALL TYPE #5  
INTERIOR SOUND  
INSULATED

**WALL TYPES:**

- WALL TYPE #1: TYPICAL EXTERIOR LOAD BEARING WOOD STUD WALL WITH BRICK AND SIDING ON EXTERIOR AND GYPSUM BOARD ON INTERIOR SIDE. SEE WALL SECTIONS AND DETAIL 1/T1.2.
- WALL TYPE #2: TYPICAL EXTERIOR LOAD BEARING WOOD STUD WALL WITH BRICK VENEER ON EXTERIOR SIDE AND GYPSUM BOARD ON INTERIOR SIDE. SEE WALL SECTIONS AND DETAIL 2/T1.2.
- WALL TYPE #3: TYPICAL INTERIOR 1-HOUR RATED LOAD BEARING WALL: 3-1/2" WOOD STUDS AT 16" O.C. WITH BATT INSULATION AND 1 LAYER 5/8" TYPE "X" GYPSUM BOARD ON BOTH SIDES. WET SIDE OF RESTROOM, LAUNDRY, AND KITCHEN WALL TO BE 5/8" CEMENTITIOUS BOARD TO 4'-0" A.F.F. EXTEND TO HORIZONTAL SHAFT ASSEMBLY. SEE WALL SECTIONS AND DETAIL 3/T1.2.
- WALL TYPE #4: TYPICAL INTERIOR NON-LOAD BEARING WALL: 3-1/2" WOOD STUDS AT 16" O.C. WITH 5/8" GYPSUM BOARD ON BOTH SIDES. WET SIDE OF RESTROOM, LAUNDRY, AND KITCHEN WALL TO BE 5/8" CEMENTITIOUS BOARD TO 4'-0" A.F.F. SEE WALL SECTIONS AND DETAIL 4/T1.2.
- WALL TYPE #5: TYPICAL INTERIOR SOUND WALL: 3-1/2" WOOD STUDS AT 16" O.C. WITH BATT INSULATION AND 5/8" GYPSUM BOARD ON BOTH SIDES. EXTEND TO ROOF DECK FOR SOUND INSULATION. SEE WALL SECTIONS AND DETAIL 5/T1.2.

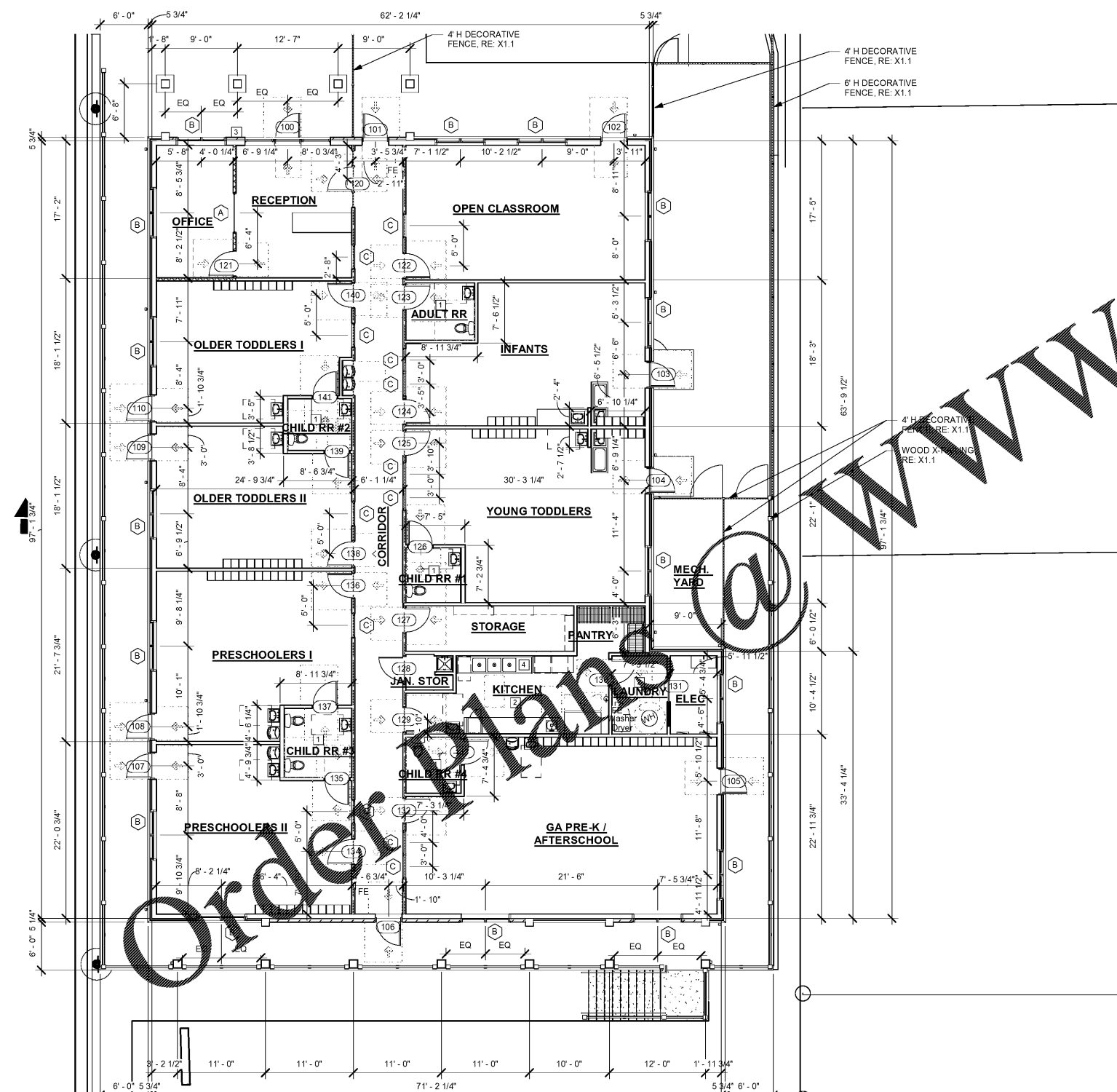

1 FLOOR PLAN  
A1.1 1/8" = 1'-0"

JOB NUMBER: 19221  
CHECKED BY: RKC

PLANNING  
ARCHITECTURE  
INTERIORS

CALBERT  
DESIGN GROUP

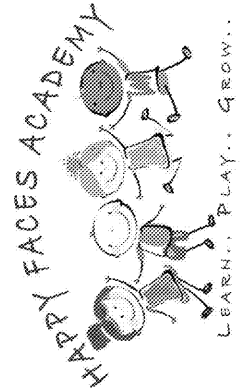

PROJECT LOCATION:  
2865 WEBB ROAD  
MILTON, GA 30004

REVISIONS		
NO	DATE:	DESCRIPTION:

FLOOR PLAN  
**A1.1**  
DATE