

Order Plans

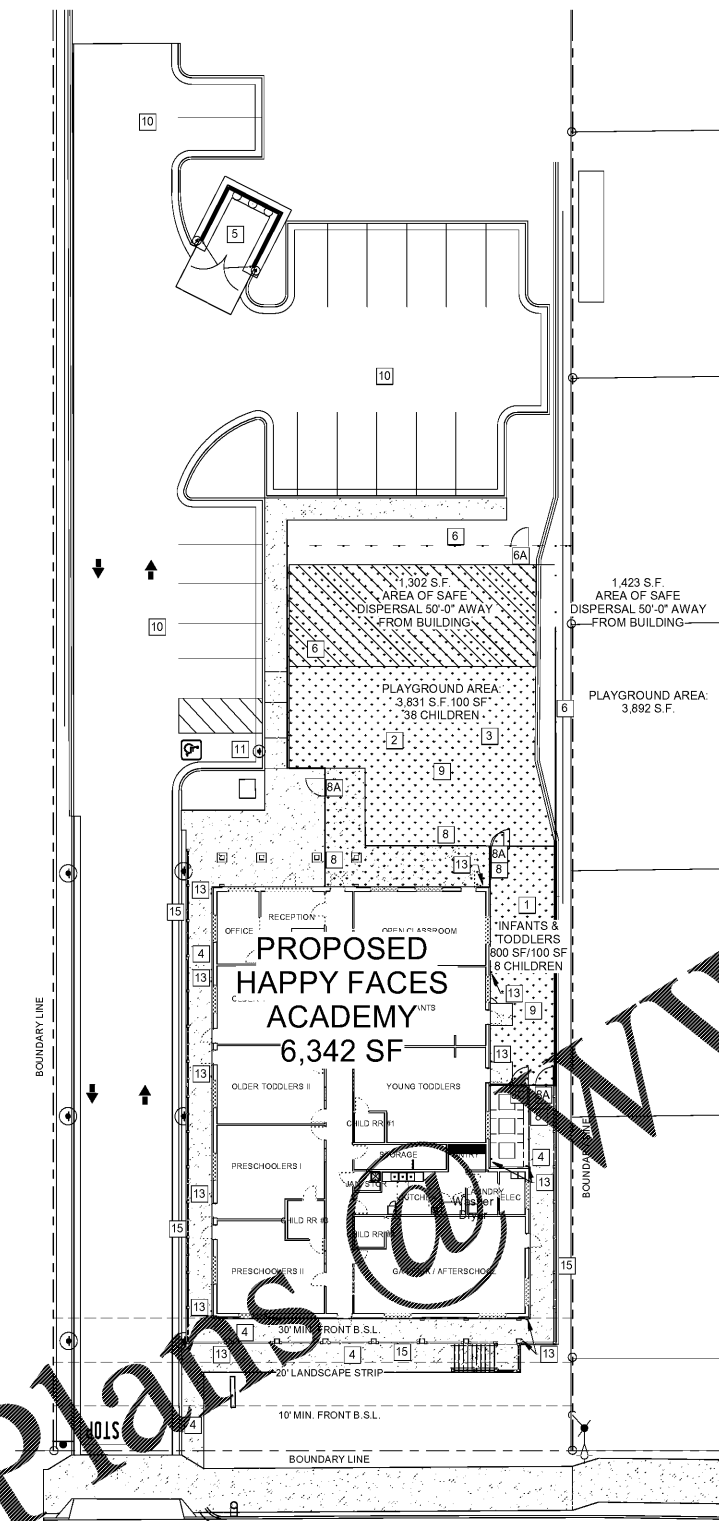

1 SITE PLAN
X1.1 1" = 20'-0"

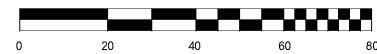

BUILDING AREA	6,342 S.F.
PARKING AREA	9,897 S.F. (20 STALLS, INCLUDING 1 HANDICAP STALL)
PLAYGROUND AREA	4,692 S.F.
MISCELLANEOUS AREA	25,199 S.F.
TOTAL SITE AREA	46,130 S.F. = 1.059 ACRES

CHILDCARE COMPLIANCE SITE REQUIREMENTS:

- ALL PLAYGROUND AREAS MUST COMPLY WITH CPSC (CONSUMER PRODUCT SAFETY COMMISSION) AND LOCAL ACCESSIBILITY LAWS.
 - ENTRAPMENT: THE DISTANCE BETWEEN ANY OPPOSING SURFACES SHALL NOT BE GREATER THAN 3-1/2" AND LESS THAN 9". THERE SHALL BE NO AREAS OF ENTRAPMENT WITHIN THE PLAYGROUNDS, INCLUDING FENCING.
 - CONTRACTOR TO FURNISH, ASSEMBLE AND INSTALL PER MANUFACTURER'S INSTRUCTIONS ALL EQUIPMENT LISTED ON THIS PLAN UNLESS OTHERWISE NOTED.
 - CONCRETE EXPANSION JOINTS ARE TO BE PLANNED AND SET WITH CONSIDERATION TO OVERALL SITE LAYOUT AND DESIGN. EXPANSION JOINTS SHALL OCCUR TO CREATE SQUARES NO GREATER THAN 20' IN EACH DIRECTION. CONTROL JOINTS SHALL BE 1/2" DEEP TOOLED JOINTS AND CRATE SQUARES NO GREATER THAN 10'x10'.
 - CONCRETE WALKS SHALL BE FLUSH AT FINISH FLOOR WITH A 2% MAX. SLOPE AWAY FROM BUILDING. SIDEWALKS ELSEWHERE SHALL BE 2" MIN. BELOW FINISH FLOOR. SLOPE AWAY FROM THE BUILDING AT 2% MAX. SLOPE ACROSS PLAY SURFACING SHALL BE 2% AT FALL SURFACES, SOD AREAS 8%. PATH OF TRAVEL FROM PUBLIC WALK TO FRONT DOOR SHALL BE 5% MAX. WITH A 1% MAX. CROSS SLOPE.
 - DO NOT USE TOXIC PLANTS. EXISTING PLANTS SHALL BE EVALUATED AND HAZARDOUS PLANTS REMOVED. CONTACT OWNER FOR LIST OF POISONOUS PLANTS. CONTRACTOR IS RESPONSIBLE FOR ENSURING NO POISONOUS PLANTS ARE USED. TREES WITH FRUITS THAT POSE A CHOKING HAZARD SHALL NOT BE USED. PLANTS WITH OTHER HAZARDOUS SUCH AS THORNS SHALL NOT BE USED. EXISTING VEGETATION SHALL BE PROTECTED WHERE POSSIBLE. SEE CIVIL FOR LANDSCAPE DETAILS.
 - NO TREES SHALL BE PLANTED WITHIN 10' OF A UTILITY TOWER UNLESS APPROVED BY OWNER.
 - TREES AND SHRUBS SHALL NOT INTERFERE WITH PHYSICAL OR SIGHT CLEARANCES REQUIRED FOR VEHICLE OR PEDESTRIAN TRAFFIC WITHIN AND ACCESSING THE SITE, BOTH INITIALLY AND THROUGH MAINTENANCE. IF A METAL OR CONCRETE GROW STRIP IS USED, IT SHALL BE FLUSH WITH GRADE AND PREFERABLY INSIDE OF THE PLAYGROUND FENCE. THERE SHALL BE NO PROTRUDING OBJECTS ON THE PLAYGROUND.
 - IF A METAL OR CONCRETE GROW STRIP IS USED, IT SHALL BE FLUSH WITH GRADE AND PREFERABLY OUTSIDE OF THE PLAYGROUND FENCE. THERE SHALL BE NO PROTRUDING OBJECTS ON THE PLAYGROUND.
- GC IS RESPONSIBLE FOR FINAL CLEANING OF ALL PLAYGROUND EQUIPMENT AT THE END OF CONSTRUCTION.

SETBACKS:

FROM PROPERTY LINE:
FRONT MIN: 10'-0"
FRONT MAX: 30'-0"
SIDE: 0'-0"
REAR: 3'-0"

LANDSCAPE BUFFERS:
FRONT: 20'-0"
SIDE: 0'-0"
REAR: 0'-0"

MAX. BUILDING HEIGHT: 30'-0"

PARKING REQUIREMENTS:

ONE PARKING SPACE FOR EVERY 4 EMPLOYEES, 1.7 SPACES FOR EVERY 1000 S.F.

REQUIRED:
17 SPACES
1 ADA SPACES

PROVIDED:
20 SPACES
1 ADA SPACES

KEYNOTES :

NO	DESCRIPTION
1	INFANT/TODDLER PLAYGROUND EQUIPMENT
2	EARLY PRESCHOOL PLAYGROUND EQUIPMENT
3	PRESCHOOL PLAYGROUND EQUIPMENT
4	CONCRETE SIDEWALK, JOINTS SPACED APPROX. 5'-0" APART, SEE DETAIL 2/X2.1
5	TRASH ENCLOSURE, SEE SHEET X2.3
6	6" ORNAMENTAL FENCE - SEE DETAILS 1-4/X2.2
6A	6" H X 4' W ORNAMENTAL GATE WITH PANIC BAR, SEE 3/X2.2
6B	6" H X 4' W ORNAMENTAL GATE WITH PULL-UP LATCH @ 3' H, SEE 3/X2.2 NOT USED
6C	6" H X 4' W ORNAMENTAL GATE WITH SERVICE LATCH @ 3' H, SEE 3/X2.2 NOT USED
7A	4" H X 4' W CHAIN LINK GATE WITH PANIC BAR, SEE DETAIL 3/X2.2 NOT USED
7B	4" H X 4' W CHAIN LINK GATE WITH PULL-UP LATCH, SEE DETAIL 3/X2.2 NOT USED
7C	4" H X 4' W CHAIN LINK GATE WITH SERVICE LATCH, SEE DETAIL 3/X2.2 NOT USED
8	4" H VINYL FENCE, SEE DETAILS 9-12/X2.2
8A	4" H X 4' W VINYL GATE WITH PANIC BAR, SEE DETAIL 11/X2.2
8B	4" H X 4' W VINYL GATE WITH PULL-UP LATCH, SEE DETAIL 11/X2.2 NOT USED
8C	4" H X 4' W VINYL GATE WITH SERVICE LATCH, SEE DETAIL 11/X2.2
9	SYNTHETIC TURF WITHIN PLAYGROUND EQUIPMENT FALL ZONES OUTLINED W/ 3"W CONC. TRIKE PATH, SEE DETAILS 4,5/X2.1
10	PARKING LOT WITH STRIPING, SEE CIVIL DRAWINGS
11	HC PARKING SIGNAGE, SEE CIVIL DRAWINGS
12	BIKE RACK, SEE DETAIL 8/X2.1 NOT USED
13	DOWNSPOUTS CONNECTED TO UNDERGROUND STORM DRAIN, TYP. ALL DOWNSPOUTS WITHIN FENCED AREAS, SEE DETAIL 1/X2.1
14	8" W X 20" L CHILDREN'S OUTDOOR GARDEN, SEE DETAIL 6 & 7/X2.1 NOT USED
15	WOOD X-RAILING, SEE DETAILS X2.2

JOB NUMBER: 19221
CHECKED BY: Checker

PLANNING
ARCHITECTURE
INTERIORS

CALBERT
DESIGN GROUP

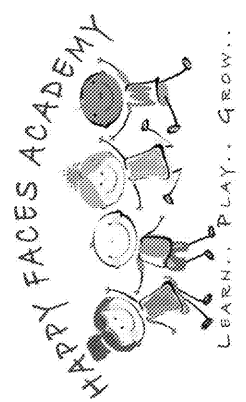

PROJECT LOCATION:
2865 WEBB ROAD
MILTON, GA 30004

REVISIONS		
NO	DATE:	DESCRIPTION:

ARCHITECTURAL SITE PLAN

X1.1

DATE