

EROSION, SEDIMENTATION, AND POLLUTION CONTROL PLANS (ESPCP) FOR: DAY CARE FACILITY - WEBB ROAD

IN ACCORDANCE WITH GEORGIA NPDES PERMIT GAR #100001
2865 WEBB ROAD
MILTON, GA 30004

EROSION CONTROL SHEET INDEX	
C-4.1	EROSION, SEDIMENTATION, & POLLUTION CONTROL NOTES
C-4.2	EROSION, SEDIMENTATION, & POLLUTION CONTROL NOTES
C-4.3	INITIAL EROSION, SEDIMENTATION, & POLLUTION CONTROL PLAN
C-4.4	INTERMEDIATE EROSION, SEDIMENTATION, & POLLUTION CONTROL PLAN
C-4.5	FINAL EROSION, SEDIMENTATION, & POLLUTION CONTROL PLAN
C-4.6	EROSION, SEDIMENTATION, & POLLUTION CONTROL DETAILS
C-4.7	EROSION, SEDIMENTATION, & POLLUTION CONTROL DETAILS
C-4.8	EROSION, SEDIMENTATION, & POLLUTION CONTROL DETAILS
C-4.9	EROSION, SEDIMENTATION, & POLLUTION CONTROL DETAILS

SITE DISTURBED AREA = 1.3 AC.

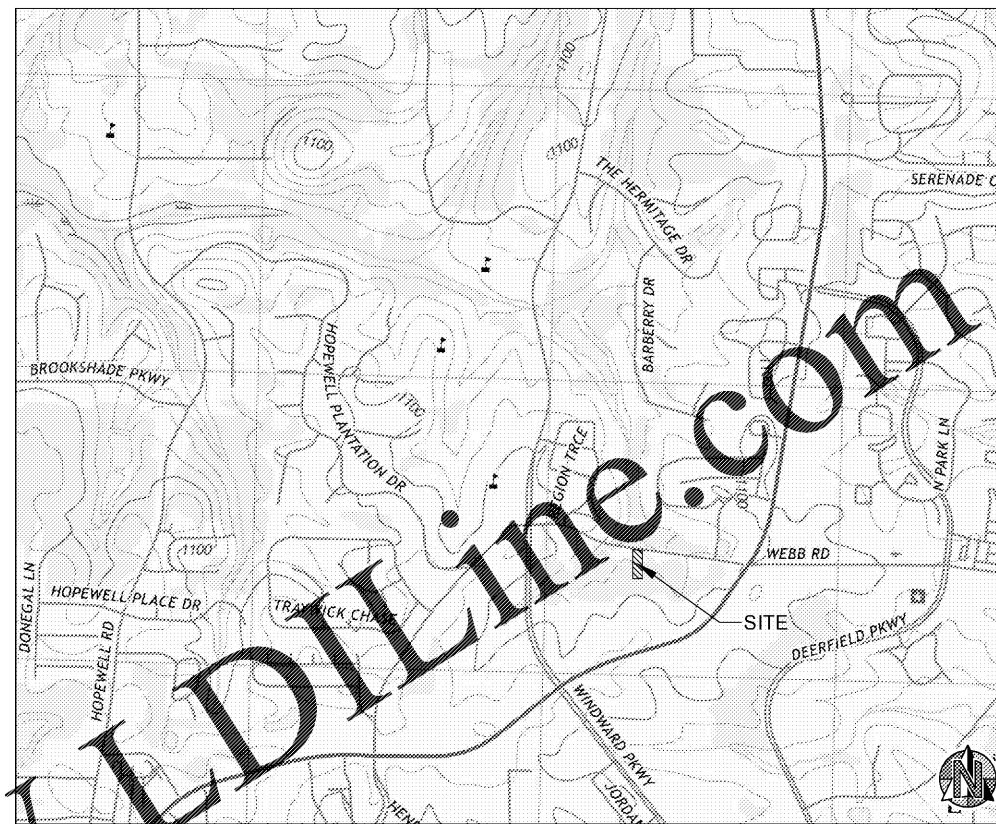

VICINITY MAP, SCALE: 1"=1000'

PHASE-I WATER SAMPLING LOCATION SCHEDULE									
MONITORING SITE	TYPE OF SITE (SEE KEY)	TOTAL BASIN AREA		ON-SITE BASIN AREA	RECOMMENDED FOR MONITORING	RECEIVING WATER NAME	IMPAIRED? ***	NTU LIMIT FROM PERMIT **	COLD WATER?
		ACRES	SQ. MI.						
MS-A	OF	1.66	0.003	1.66	YES	UNNAMED TRIBUTARY OF COPPER SAND CREEK	NO	75	NO

*** O.C.G.A. Sec. 12-7-6 STATES "A discharge of STORMWATER runoff from disturbed areas where best management practices have not been properly designed, installed, and maintained shall constitute a separate violation of any land-disturbing permit issued by a local issuing authority or of any state general permit issued by the division pursuant to subsection (f) of Code Section 12-5-30 for each day on which such discharge results in the turbidity of receiving waters being increased by more than 25 nephelometric turbidity units for waters supporting warm water fisheries or by more than ten nephelometric turbidity units for waters classified as trout waters."

KEY:
OF: OUTFALL
RW-D: RECEIVING WATER- DOWNSTREAM OF SITE
RW-U: RECEIVING WATER- UPSTREAM OF SITE

*** Impaired indicates the site discharges into, or is within one mile upstream of and within the same watershed, as a portion of an impaired stream segment for the criteria validated "Bio F" (Impaired Fish Community) and/or "Bio M" (Impaired Macroinvertebrate Community), within Category 4a, 4b, or 5, and the potential cause is either "NP" (nonpoint source) or "UR" (urban runoff) on the latest published impaired streams list maintained by the Georgia Environmental Protection Division.

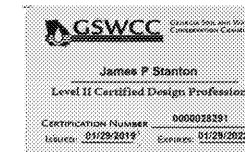

SITE DETAILS:

- THIS SITE IS AN EXISTING 1.359 ACRE TRACT THAT IS CURRENTLY OCCUPIED WITH A ONE-STORY BRICK/SOTNE BUILDING, A MODULAR BUILDING WITH ASSOCIATED CONCRETE PARKING AND DRIVE AISLES. THE PROPOSED PROJECT WILL REMOVE THE EXISTING BUILDINGS, CONCRETE PARKING, AND CONCRETE DRIVE AISLES AND CONSTRUCT A 6,323 SF DAY CARE BUILDING. CONSTRUCTION INCLUDES ASPHALT PARKING, PLAYGROUND AREA, STORMWATER MANAGEMENT AREA, ASSOCIATED STORM DRAIN PIPING, AND ALL NECESSARY UTILITIES.
- TOTAL AREA OF THE SITE = 1.359298 ACRES
- THERE ARE NO KNOWN STATE WATERS PRESENT ON SITE. THERE ARE NO KNOWN STATE WATERS WITHIN 200 FEET OF THE SITE. APPROXIMATE LOCATION OF OFF-SITE WATERS AND RECEIVING WATER ARE SHOWN ON THE LOCATION MAP (THIS SHEET)
- THERE ARE NO KNOWN WETLANDS ON THE SITE. ALL WETLANDS DELINEATED ARE SHOWN IN THIS PLAN.
- NO PORTION OF THE SUBJECT PROPERTY LIES WITHIN A 100 YEAR FLOOD HAZARD AREA PER FIRM MAP NUMBER 13121C0057 G DATED 06/19/2020

A COPY OF THIS APPROVED PLAN MUST BE RETAINED ON-SITE OR AT A READILY ACCESSIBLE LOCATION

THIS PLAN SHALL BE AMENDED WHEN A CHANGE IN DESIGN, CONSTRUCTION, OPERATION, OR MAINTENANCE HAS A SIGNIFICANT EFFECT ON BMP'S WITH HYDRAULIC COMPONENT (INCLUDING SpB, Sd2, Sd3, Sd4, Rt, Ss, Rd, AND OTHER MEASURES IN CONCENTRATED FLOW AREAS). SUCH AMENDMENTS MUST BE CERTIFIED BY THE ENGINEER.

CONTRACTOR SHALL NOTIFY ENGINEER IMMEDIATELY UPON START OF CONSTRUCTION IN ORDER FOR ENGINEER TO SCHEDULE THE INITIAL 7 DAY EROSION CONTROL INSPECTION. THE CONTRACTOR SHALL VERIFY THAT ALL EXISTING INITIAL BMP'S ARE INSTALLED PROPERLY. ALL COMPENSATION FOR DESIGN ENGINEER'S REINSPECTION TO VERIFY THAT THE INITIAL BMP'S ARE PROPERLY INSTALLED WILL BE THE RESPONSIBILITY OF THE CONTRACTOR.

PREPARED BY:



24 HR CONTACT:
RUPESH MANUGULA
201-519-6037

Foresite Group, Inc.
5185 Peachtree Pkwy.
Suite 240
Norcross, GA 30092
o | 770.368.1399
f | 770.368.1944
w | www.fg-inc.net

ISSUED:
<MONTH DDAY, 20YY>
1418.001

ANTICIPATED ACTIVITY SCHEDULE						
ACTIVITY	BEGIN CONSTRUCTION: 9/01/2020 END CONSTRUCTION: 9/01/2021					
	1.0 MTH	2.0 MTH	3.0 MTH	4.0 MTH	5.0 MTH	6.0 MTH
1. INSTALL SEDIMENT CONTROLS	█					
2. DEMOLITION	█					
3. CLEARING, GRUBBING, & GRADING	█	█	█	█	█	█
4. GRASS TEMP.	█	█	█	█	█	█
5. BUILDING CONSTRUCTION		█	█	█	█	█
6. MAINTAIN EROSION CONTROL	█	█	█	█	█	█
7. PAVING			█	█	█	█
8. FINAL LANDSCAPING						█
9. DISPOSITION OF TEMP. SEDIMENT CONTROLS						█

DESIGN PROFESSIONAL CERTIFICATION

I CERTIFY THAT THE PERMITTEE'S EROSION, SEDIMENTATION, AND POLLUTION CONTROL PLAN PROVIDES FOR AN APPROPRIATE AND COMPREHENSIVE SYSTEM OF BEST MANAGEMENT PRACTICES REQUIRED BY THE GEORGIA WATER QUALITY CONTROL ACT AND THE DOCUMENT "MANUAL FOR EROSION AND SEDIMENT CONTROL IN GEORGIA" (MANUAL) PUBLISHED BY THE STATE SOIL AND WATER CONSERVATION COMMISSION AS OF JANUARY 1 OF THE YEAR IN WHICH THE LAND-DISTURBING ACTIVITY WAS PERMITTED, PROVIDES FOR THE SAMPLING OF THE RECEIVING WATER(S) OR THE SAMPLING OF THE STORM WATER OUTFALLS AND THAT THE DESIGNED SYSTEM OF THE BEST MANAGEMENT PRACTICES AND SAMPLING METHODS IS EXPECTED TO MEET THE REQUIREMENTS CONTAINED IN THE GENERAL NPDES PERMIT NO. GAR 100001.

I CERTIFY UNDER PENALTY OF LAW THAT THIS PLAN WAS PREPARED AFTER A SITE VISIT TO THE LOCATIONS DESCRIBED HEREIN BY MYSELF OR MY AUTHORIZED AGENT, UNDER MY SUPERVISION.

James P. Stanton
SIGNATURE OF ENGINEER
DATE: 1/13/21
000028291
CERTIFICATION # EXPIRATION

OWNER CERTIFICATION

"I CERTIFY UNDER PENALTY OF LAW THAT THIS DOCUMENT AND ALL ATTACHMENTS WERE PREPARED UNDER MY DIRECTION OR SUPERVISION IN ACCORDANCE WITH A SYSTEM DESIGNED TO ASSURE THAT CERTIFIED PERSONNEL PROPERLY GATHER AND EVALUATE THE INFORMATION SUBMITTED BASED ON MY INQUIRY OF THE PERSON OR PERSONS WHO MANAGE THE SYSTEM, OR THOSE PERSONS DIRECTLY RESPONSIBLE FOR GATHERING THE INFORMATION. THE INFORMATION SUBMITTED IS, TO THE BEST OF MY KNOWLEDGE AND BELIEF, TRUE, ACCURATE, AND COMPLETE. I AM AWARE THAT THERE ARE SIGNIFICANT PENALTIES FOR SUBMITTING FALSE INFORMATION, INCLUDING THE POSSIBILITY OF FINE AND IMPRISONMENT FOR KNOWING VIOLATIONS."

SIGNATURE OF OWNER DATE

ENGINEER:
FORESITE group
Foresite Group, Inc.
3740 Davinci Ct.
Suite 100
Peachtree Corners, GA 30092
w | www.fg-inc.net
o | 770.368.1399
f | 770.368.1944

DEVELOPER:

JAI RADHE KRISHNA ENTERPRISES, LLC
568 PEACHTREE PARKWAY
CUMMING, GA 30041
CONTACT: RUPESH MANUGULA

PROJECT:
DAY CARE FACILITY - WEBB ROAD
2865 WEBB ROAD
MILTON, GA 30004
L.L. 1048, 2ND DISTRICT, 2ND SECTION
PARCEL #22 527010482814, FULTON CO PERMIT # 20-050WR

SEAL:

REVISIONS	DATE
ENVIRONMENTAL HEALTH	08-12-2020
CITY COMMENTS	10-7-2020

PROJECT MANAGER: JPS
DRAWING BY: JCW
JURISDICTION: MILTON, GA
DATE: 07-15-2020
SCALE: AS SHOWN
TITLE:

EROSION, SEDIMENTATION, & POLLUTION CONTROL COVER

SHEET NUMBER: **C-4**
COMMENTS: NOT RELEASED FOR CONSTRUCTION
JOB/FILE NUMBER: 1418.001



DATE PLOTTED: 08/15/2022 10:58:11 AM BY: JAI RADHE KRISHNA ENTERPRISES, LLC