

GENERAL NOTES:

- ALL SPOT ELEVATIONS SHOWN ARE AT THE EDGE OF PAVEMENT UNLESS OTHERWISE NOTED.
 - ALL PROPOSED SIDEWALKS SHALL BE BUILT WITH A 1.5% CROSS-SLOPE AWAY FROM THE BUILDING.
 - ALL HEAD WALL SECTIONS SHALL BE CONSTRUCTED TO BE FLUSH WITH THE EXISTING DITCH BANK AND PROPOSED EMBANKMENT SLOPES.
- SITE NOTES:**
- THE CONTRACTOR SHALL CLEAN OUT ACCUMULATED SILT IN STORM WATER CONVEYANCE CHANNELS AND PIPES AT END OF CONSTRUCTION WHEN DISTURBED AREAS HAVE BEEN STABILIZED.
 - COORDINATE WITH THE CITY OF MILTON INSPECTIONS DURING CONSTRUCTION.
 - NO CERTIFICATE OF OCCUPANCY WILL BE ISSUED UNTIL ALL SITE IMPROVEMENTS HAVE BEEN COMPLETED.
 - CONSTRUCT EROSION CONTROL BARRIERS PER THE CITY OF MILTON INSPECTOR AND MAINTAIN UNTIL PERMANENT VEGETATION IS ESTABLISHED.
 - THE CONTRACTOR SHALL RE-ESTABLISH ALL RIGHT OF WAY AREA WHICH IS DAMAGED OR DISTURBED TO ORIGINAL CONDITIONS OR BETTER DURING AUTHORIZED WORK. ALL WORK IN THE CITY OF MILTON RIGHT OF WAY SHALL COMPLY WITH GADOT SPECIFICATIONS.
 - ALL CURBED LANDSCAPE ISLANDS SHALL BE FILLED TO TOP OF CURB WITH TOPSOIL AND SEEDED.
 - MAXIMUM CUT OR FILL SLOPES IS 2H:1V.
 - TREE PROTECTION FENCE SHALL BE INSTALLED PRIOR TO ANY CLEARING OR GRADING ACTIVITIES.
 - ALL PLASTIC STORM PIPE SHOWN ON THIS PLAN SHALL BE WRAPPED WITH LOCATION WIRE AND TAPE.
 - ALL CMP STORM PIPE SHALL BE TYPE 2 ALUMINIZED. ALL HDPE SHALL BE AASHTO TYPE "S" AND SHALL BE INSTALLED IN ACCORDANCE TO ASTM D2321 OR AASHTO SECTION 30 STANDARD PRACTICES AND AS RECOMMENDED BY THE MANUFACTURER. ALL RCP STORM PIPE SHALL BE CLASS III.
 - IN ALL AREAS OF FILL OR OTHERWISE DISTURBANCE OF EXISTING CONDITIONS, UNLESS OTHERWISE NOTED, THE CONTRACTOR SHALL FULLY AND COMPLETELY REMOVE AND LEGALLY DISPOSE OFF-SITE. ALL PLANT MATERIALS INCLUDING BUT NOT LIMITED TO ROOT SYSTEMS, CONCRETE, REINFORCED CONCRETE, ASPHALT DEBRIS, UNDERBUSH, TOPSOIL, AND OTHER DELETERIOUS MATERIAL. THE SUBGRADE TO REMAIN SHALL BE COMPACTED TO 95% STANDARD PROCTOR MAXIMUM DRY DENSITY FOLLOWING FULL REMOVAL OF THESE MATERIALS.
 - REFER TO SUBSURFACE EXPLORATION AND GEOTECHNICAL ENGINEERING EVALUATION REPORTS AS PROVIDED BY OWNER FOR RECOMMENDATIONS ASSOCIATED WITH GENERAL SITE PREPARATION, BUILDING PAD PREPARATION, SUBGRADE PREP, AREAS TO RECEIVE FILL, AREAS TO BE OVEREXCAVATED, PAVEMENT SECTIONS, FILL, SLOPES AND EXCAVATION. THE CONTRACTOR SHALL HAVE THIS REPORT ON THE JOB SITE FOR REFERENCE AT ALL TIMES. THE CONTRACTOR SHALL PROVIDE EARTHWORK OPERATIONS AND CONSTRUCTION PHASE MONITORING TO ENSURE THAT ALL COMPACTION IS COMPLETED IN ACCORDANCE WITH THE GEOTECHNICAL REPORT. THE CONTRACTOR SHALL PROVIDE TESTING REPORTS TO THE OWNER REGARDING COMPACTION TESTING PER THE TESTING PROTOCOL IN THE GEOTECHNICAL REPORT.
 - IT IS THE RESPONSIBILITY OF THE CONTRACTOR TO OBTAIN QUALIFIED PROFESSIONAL ADVICE WHEN QUESTIONS ARISE CONCERNING DESIGN AND EFFECTIVENESS OF EROSION CONTROL DEVICES. 24 HR. CONTACT: RUPESH MANUGULA 201-519-6037
 - NO PORTION OF THIS PROPERTY LIES WITHIN A SPECIAL FLOOD HAZARD AREA PER PANEL 13121C0057 G DATED 06/19/2020
 - DETENTION FACILITIES AND EROSION CONTROL MEASURES ARE TO BE ACCOMPLISHED PRIOR TO ANY OTHER CONSTRUCTION ON THE SITE AND MAINTAINED UNTIL PERMANENT GROUND COVER IS ESTABLISHED.
 - EXTREME CAUTION SHALL BE USED WHEN WORKING WITHIN THE VICINITY OF THE EXISTING OVERHEAD POWER LINES. CONTRACTORS SHALL NOTIFY/COORDINATE WITH SAUNEE EMC PRIOR TO CONSTRUCTION.
 - STORM WATER MANAGEMENT SHALL BE IN ACCORDANCE WITH COUNTY, STATE, AND OTHER APPROPRIATE ORDINANCES AND REGULATIONS IN EFFECT AT TIME OF CONSTRUCTION PLAN APPROVAL.
 - IN HEAVY DUTY PAVEMENT AREAS G.A.B. SHALL EXTEND UNDER THE GUTTER TO PROVIDE ADDITIONAL STABILITY FOR TRUCK TRAVEL.
 - CONTRACTOR SHALL INSTALL DOWNSTREAM STORM PIPE CONNECTION IN THE RIGHT-OF-WAY PRIOR TO INSTALLATION OF ON-SITE STORM PIPING AND/OR STORM WATER DETENTION FACILITY. CONTRACTOR SHALL FIELD VERIFY ALL EXISTING UTILITIES SHOWN ON THE PLANS BY POT HOLING THE LINES. THE CONTRACTOR SHALL HAVE THE LINES SURVEYED, INCLUDING HORIZONTAL AND VERTICAL LOCATION, AND THE SURVEYED POINTS SENT TO THE PROJECT ENGINEER TO DETERMINE IF ANY UTILITY CONFLICTS WILL AFFECT THE CURRENT STORM DRAINAGE DESIGN.

LEGEND

| | |
|--|--|
| | EXISTING CONTOURS |
| | PROPOSED CONTOURS |
| | EXISTING STORM PIPE |
| | PROPOSED STORM PIPE |
| | EXISTING SPOT ELEVATION |
| | PROPOSED SPOT ELEVATION |
| | PROPOSED SPOT ELEVATION FOR TOP OF WALL / BOTTOM OF WALL AT FINISHED SURFACE GRADE (SEE STRUCTURAL FOR FOOTING ELEVATIONS) |

FIRE APPARATUS ACCESS ROAD SHALL NOT EXCEED 10% GRADE

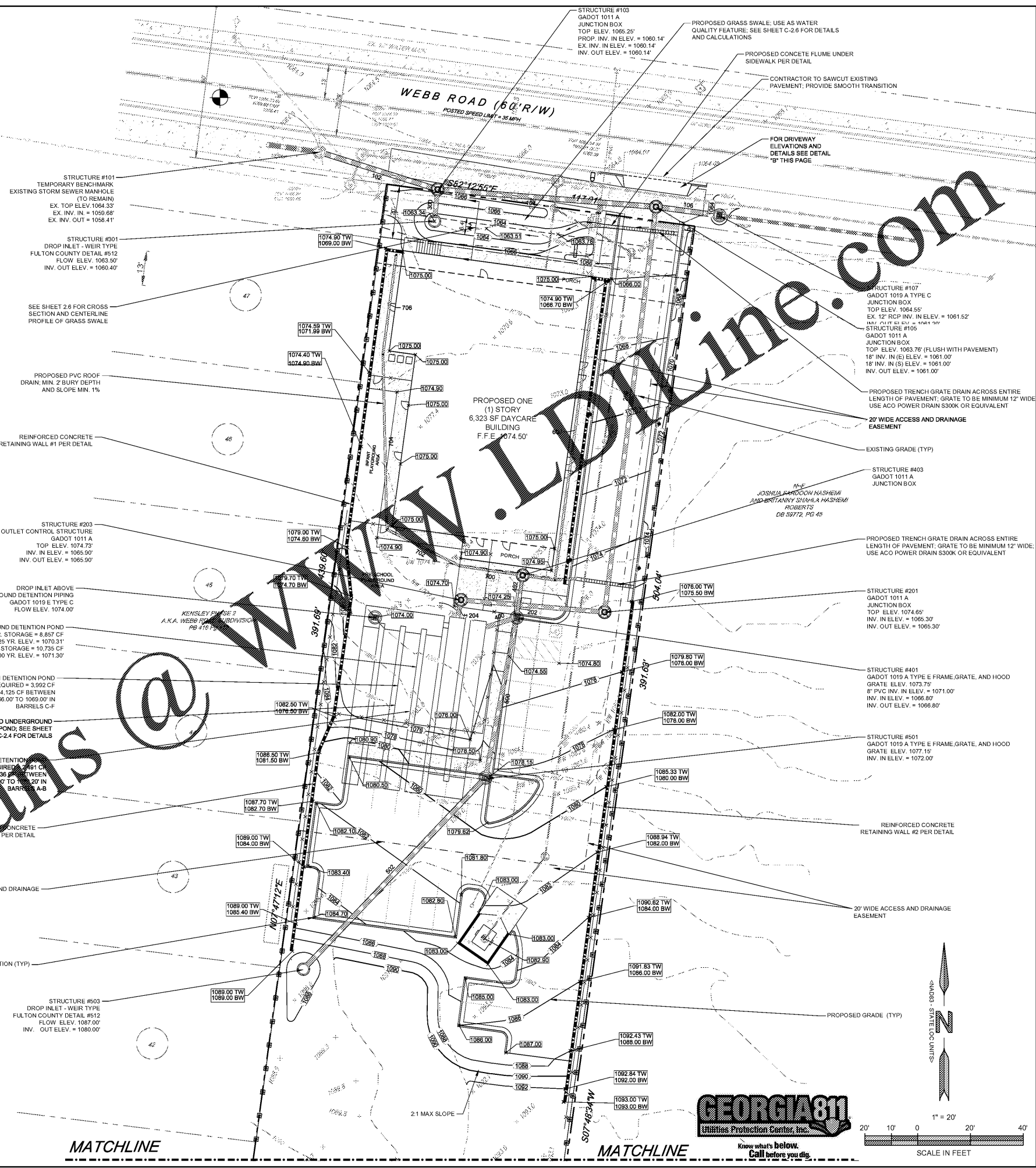
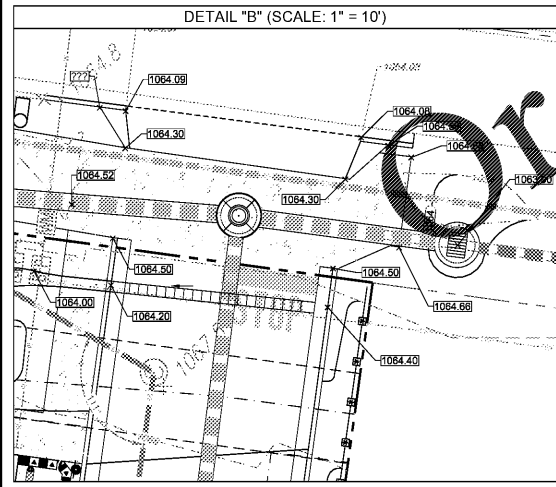

Order Plans @ www.dnline.com

ENGINEER:

FORESITE group

Foresite Group, Inc.
3740 Davinci Ct.
Suite 100
Peachtree Corners, GA 30092

w | www.fg-inc.net
o | 770.368.1399
f | 770.368.1944

DEVELOPER:

JAI RADHE KRISHNA ENTERPRISES, LLC
568 PEACHTREE PARKWAY
CUMMING, GA 30041

CONTACT: RUPESH MANUGULA

PROJECT:

DAY CARE FACILITY - WEBB ROAD

2685 WEBB ROAD
MILTON, GA 30004
LL 1048, 2ND DISTRICT, 2ND SECTION
PARCEL #22 527010482814, FULTON CO PERMIT # 20-050WR

SEAL:

| REVISIONS | DATE |
|------------------------|------------|
| ENVIRONMENTAL HEALTH | 08-12-2020 |
| CITY COMMENTS | 10-7-2020 |
| FULTON COUNTY COMMENTS | 11-10-2020 |
| CITY COMMENTS | 1-13-2021 |

PROJECT MANAGER: JPS
DRAWING BY: JCW
JURISDICTION: MILTON, GA
DATE: 07-15-2020
SCALE: 1" = 20'
TITLE:

GRADING & DRAINAGE PLAN

SHEET NUMBER: **C-2**

COMMENTS: NOT RELEASED FOR CONSTRUCTION

JOB/FILE NUMBER: 1418.001

GEORGIA811
Utilities Protection Center, Inc.
Know what's below.
Call before you dig.

SCALE IN FEET
1" = 20'