

SITE DEVELOPMENT PLANS FOR:

DAY CARE FACILITY - WEBB ROAD

2865 WEBB ROAD
MILTON, GA 30004
L.L. 1048, 2ND DISTRICT, 2ND SECTION, PARCEL #: 22 527010482814
ZONED: T-4 OPEN

SHEET INDEX

- G-1 COVER
- G-2 GENERAL NOTES
- G-2.1 GENERAL NOTES
- V-1 SURVEY
- C-0 EXISTING CONDITIONS & DEMOLITION PLAN
- C-1 SITE AND PAVING PLAN
- C-2 GRADING & DRAINAGE PLAN
- C-2.1 GRADING AND DRAINAGE PLAN
- C-2.2 STORM DRAINAGE PROFILES
- C-2.3 STORM DRAINAGE CALCULATIONS
- C-2.4 STORM DRAINAGE CALCULATIONS
- C-2.5 STORM DRAINAGE MAP
- C-2.6 GRASS SWALE PROFILES AND DETAILS
- C-2.7 STORMWATER MANAGEMENT DETAILS
- C-2.8 UNDERGROUND DETENTION POND DETAILS
- C-2.9 RETAINING WALL PROFILES
- C-3 UTILITIES PLAN
- C-3.1 WATER AND SEWER NOTES
- C-3.2 SANITARY SEWER PROFILES
- C-4 EROSION, SEDIMENTATION, & POLLUTION CONTROL COVER
- C-4.1 EROSION, SEDIMENTATION, & POLLUTION CONTROL NOTES
- C-4.2 EROSION, SEDIMENTATION, & POLLUTION CONTROL NOTES
- C-4.3 INITIAL EROSION, SEDIMENTATION, & POLLUTION CONTROL PLAN
- C-4.4 INTERMEDIATE EROSION, SEDIMENTATION, & POLLUTION CONTROL PLAN
- C-4.5 FINAL EROSION, SEDIMENTATION, & POLLUTION CONTROL PLAN
- C-4.6 EROSION, SEDIMENTATION, & POLLUTION CONTROL DETAILS
- C-4.7 EROSION, SEDIMENTATION, & POLLUTION CONTROL DETAILS
- C-4.8 EROSION, SEDIMENTATION, & POLLUTION CONTROL DETAILS
- C-5 PAVING DETAILS
- C-6 CONSTRUCTION DETAILS
- C-6.1 CONSTRUCTION DETAILS
- C-6.2 CONSTRUCTION DETAILS
- C-6.3 CONSTRUCTION DETAILS
- C-7 UTILITY DETAILS
- C-7.1 UTILITY DETAILS
- C-7.2 UTILITY DETAILS
- C-7.3 UTILITY DETAILS
- L-1 LANDSCAPE PLAN
- L-2 LANDSCAPE DETAILS
- ESP1 SITE PLAN - LIGHTING

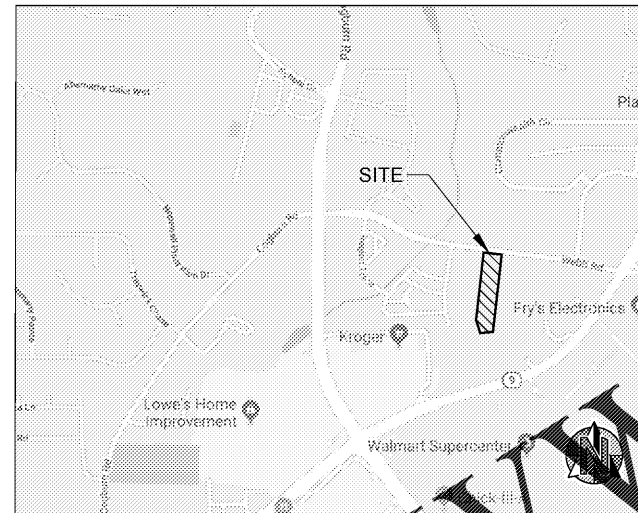

VICINITY MAP
NOT TO SCALE

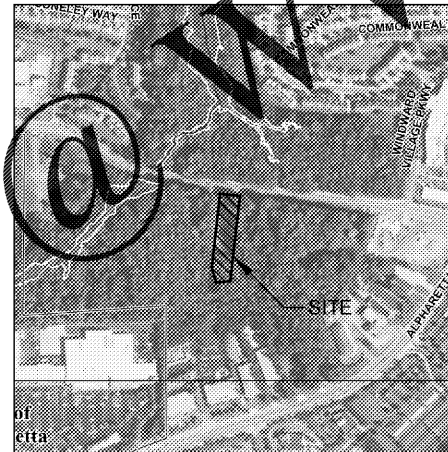

FEMA FLOOD MAP / NOT TO SCALE

NO PORTION OF THE SUBJECT PROPERTY LIES WITHIN A 100 YEAR FLOOD HAZARD AREA PER FIRM MAP NUMBER 13121C0057G DATED JUNE 19, 2020.

SITE DISTURBED AREA = 1.3 AC.

ANTICIPATED ACTIVITY SCHEDULE							
		BEGIN CONSTRUCTION: 9/01/2020 END CONSTRUCTION: 9/01/2021					
ACTIVITY	1.0 MTH	2.0 MTH	3.0 MTH	4.0 MTH	5.0 MTH	6.0 MTH	
1	INSTALL SEDIMENT CONTROLS	█					
2	DEMOLITION	█	█				
3	CLEARING, GRUBBING, & GRADING	█	█	█			
4	GRASS TEMP.	█	█	█			
5	BUILDING CONSTRUCTION	█	█	█	█		
6	MAINTAIN EROSION CONTROL	█	█	█	█	█	
7	PAVING			█	█		
8	FINAL LANDSCAPING					█	█
9	DISPOSITION OF TEMP. SEDIMENT CONTROLS						█

PROJECT DIRECTORY

OWNER
JAI RADHE KRISHNA ENTERPRISES, LLC
568 PEACHTREE PARKWAY
CUMMING, GA 30041
201-519-6037
CONTACT: RUPESH MANUGULA

DEVELOPER
JAI RADHE KRISHNA ENTERPRISES, LLC
568 PEACHTREE PARKWAY
CUMMING, GA 30041
201-519-6037
CONTACT: RUPESH MANUGULA

CIVIL ENGINEER
FORESITE GROUP, INC.
3740 DAVINCI COURT SUITE 100
PEACHTREE CORENRS, GA 30092
201-519-6037
CONTACT: RUPESH MANUGULA

ARCHITECT
CALBERT DESIGN GROUP, LLC
2950 CHEROKEE STREET NW SUITE 600
KENNESAW, GA 30144
678-333-7744
CONTACT: REBECCA CALBERT

UTILITY PROVIDERS

WATER SERVICE PROVIDER
FULTON COUNTY WATER
141 PRYOR STREET SW
ATLANTA, GA 30303
404-612-4000

SANITARY SEWER SERVICE PROVIDER
FULTON COUNTY SEWE
7472 COCHRAN ROAD
ATLANTA, GA 30349
404-612-4000

ELECTRICAL SERVICE PROVIDER
SAWNEE EMC
543 ATLANTA HWY.
CUMMING, GA 30040
770-887-2636

SURVEYOR
SURVEYS PLUS, INC.
3565 SOUTH COBB DRIVE, S.E.
SMYRNA, GA 30080
770-444-9736
CONTACT: JOSEPH T. BAKER

LOCAL ISSUING AUTHORITY
CITY OF MILTON COMMUNITY DEVELOPMENT
2006 HERITAGE WALK
MILTON, GA 30004
678-242-2555
CONTACT: PARAG AGRAWAL

DEPARTMENT OF TRANSPORTATION
CITY OF MILTON
2006 HERITAGE WALK
MILTON, GA 30004
678-242-2524
CONTACT: ROBERT DREWRY

GAS SERVICE PROVIDER
ATLANTA GAS LIGHT
10 PEACHTREE STREET NE
ATLANTA, GA 30309
1-800-427-5463

TELEPHONE SERVICE PROVIDER
AT&T
1025 LENOX PARK BLVD. NE
ATLANTA, GA 30319
888-722-1787

ENGINEER:
FORESITE group
Foresite Group, Inc.
3740 Davinci Ct.
Suite 100
Peachtree Corners, GA 30092
w | www.fg-inc.net
o | 770.368.1399
f | 770.368.1944

DEVELOPER:

JAI RADHE KRISHNA ENTERPRISES, LLC
568 PEACHTREE PARKWAY
CUMMING, GA 30041
CONTACT: RUPESH MANUGULA

PROJECT:
DAY CARE FACILITY - WEBB ROAD
2865 WEBB ROAD
MILTON, GA 30004
L.L. 1048, 2ND DISTRICT, 2ND SECTION
PARCEL #: 22 527010482814

SEAL:

REVISIONS	DATE
ENVIRONMENTAL HEALTH	08-12-2020
CITY COMMENTS	10-7-2020

PROJECT MANAGER: JPS
DRAWING BY: JCW
JURISDICTION: MILTON, GA
DATE: 07-15-2020
SCALE: AS SHOWN
TITLE:

COVER
SHEET NUMBER: **G-1**
COMMENTS: NOT RELEASED FOR CONSTRUCTION
JOB/FILE NUMBER: 1418.001

PREPARED BY:

FORESITE group

Foresite Group, Inc. w | www.fg-inc.net
3740 Davinci Ct. o | 770.368.1399
Suite 100 f | 770.368.1944
Peachtree Corners, GA 30092

24 HR CONTACT:
RUPESH MANUGULA
201-519-6037

CONTRACTOR SHALL NOTIFY ENGINEER IMMEDIATELY UPON COMPLETION OF INITIAL EROSION BMP'S AS SHOWN ON SHEET C-4 IN ORDER FOR ENGINEER TO SCHEDULE THE INITIAL 7 DAY EROSION CONTROL INSPECTION. THE CONTRACTOR SHALL VERIFY THAT ALL EXISTING INITIAL BMP'S ARE INSTALLED PROPERLY. ALL COMPENSATION FOR DESIGN ENGINEER'S REINSPECTION TO VERIFY THAT THE INITIAL BMP'S ARE PROPERLY INSTALLED WILL BE THE RESPONSIBILITY OF THE CONTRACTOR.

GEORGIA811
Utilities Protection Center, Inc.
Know what's below.
Call before you dig.