

CONCRETE FINISH SPECIFICATIONS

8 Step Concrete Floor Polishing Process:

1. Cut and clean out, prep and then fill the concrete floor joints throughout the facility with Euclid QWIKJOINT UVR polyurea joint filler or ("RetroPlate CreteFill Pro 75 joint filler")
2. Grind concrete floor with a Combo set of 60 Grit Resin Bond Diamonds (Brown H.T.C. E.Z. B.B. Series brown 4's or equivalent) and 100 Grit Resin Bond Diamonds (Black H.T.C. E.Z. B.B. Series 5's or equal)
3. Thoroughly clean the concrete floor and apply Euclid Diamond Hard liquid densifier and sealer at 225 square feet per gallon or ("RetroPlate 99 liquid densifier at 200 square feet per gallon.")
4. Polish concrete floor with a combo set of 100 Grit Resin Bond Diamonds (Black H.T.C. E.Z. M.R. series or equivalent) and 200 Grit Resin Bond Diamonds (H.T.C. E.Z. M.R. series blue's or equivalent.)
5. Polish concrete floor with 400 Grit Resin Bond Diamonds (H.T.C. E.Z. S.R. series red's or equivalent).
6. Thoroughly clean concrete floor and then apply Euclid Diamond Hard liquid densifier and sealer at 700 square feet per gallon (spiff coat). Or ("RetroPlate 99 liquid densifier at 700 square feet per gallon as a spiff coat")
7. Burnish / Polish concrete floor with 800 Grit Diamond Impregnated twister pads (H.T.C. White TWISTERS or equivalent)
8. Burnish / Polish concrete floor with 1500 Grit Diamond Impregnated twister pads (H.T.C. Yellow TWISTERS or equivalent)

*The process can be used in both "Wet" and "Dry" applications.

*This process assumes a quality concrete finish by the floor finisher. If the floor to be polished is rough or has bad areas, additional grinding could be required at the GC/floor finisher's expense.

* See the attached Technical Data sheets "Diamond Hard TD 06111" and "QWIKJOINT TD Sheet 120312" for recommended joint filler and sealer/hardener. Equal Substitutions by Retro-Plate are allowed but must meet or exceed the composition outlined in the Technical Data sheets provided.

All Applicators must be certified by Euclid or Retro-Plate.

Required Vendors:

The Euclid Chemical Company
Phil Brandt
877-438-3826
PBrandt@euclidchemical.com

Retro-Plate Systems
Curtis Turnbull
888-942-3144
corporateaccounts@retroplatesystem.com



RETRO PLATE
POLYUREA JOINT FILLER

RETRO PLATE 99 is a polyurea joint filler for concrete joints. It is a two-part, moisture-curing, self-healing joint filler that provides a strong, durable, and long-lasting repair. It is used in conjunction with the RetroPlate 99 liquid densifier and sealer.

TECHNICAL DATA
Applicable Standards:
1. ASTM C1171 - Standard Test Method for Compressive Strength of Mortar
2. ASTM C1170 - Standard Test Method for Compressive Strength of Mortar
3. ASTM C1172 - Standard Test Method for Compressive Strength of Mortar

PACKAGING
RetroPlate 99 is packaged in 5-gallon buckets. Each bucket contains 1.5 gallons of Part A and 1.5 gallons of Part B. The total weight of the bucket is approximately 15.5 lbs.

INSTALLATION
RetroPlate 99 is applied to joints in concrete slabs. The joints should be cleaned and prepared before application. The product is applied in a 1:1 ratio of Part A to Part B.

FINISHES
RetroPlate 99 is used in conjunction with the RetroPlate 99 liquid densifier and sealer to provide a finished appearance to the concrete floor.

STORAGE
RetroPlate 99 should be stored in a cool, dry place. The product has a shelf life of 12 months.

SAFETY
RetroPlate 99 is a low-VOC product. It is safe for use in occupied spaces. Always wear proper PPE when handling the product.

CONTACT
For more information, contact RetroPlate Systems at 888-942-3144 or visit our website at www.retroplatesystem.com.

EUCO DIAMOND HARD

LIQUID DENSIFIER AND SEALER FOR CONCRETE

DESCRIPTION
EUCO DIAMOND HARD is a water-based liquid densifier and sealer for concrete. It penetrates the concrete surface and reacts with the free lime to form a hard, durable, and long-lasting finish. It is used in conjunction with the RetroPlate 99 liquid densifier and sealer.

PRIMARY APPLICATIONS
• Interior and exterior
• Warehouse floors
• Commercial and retail floors
• Manufacturing plants
• Distribution centers
• Industrial facilities

FEATURES/BENEFITS
• Increases abrasion and increases durability of the concrete surface
• Provides a smooth, polished appearance
• Reduces dust and dirt
• Easy to apply and easy to maintain

TECHNICAL INFORMATION
Coverage: 225 sq. ft. per gallon
Drying Time: 24 hours
Application: Spray or brush

PACKAGING
EUCO DIAMOND HARD is packaged in 5-gallon buckets. Each bucket contains 1.5 gallons of Part A and 1.5 gallons of Part B.

STORAGE
EUCO DIAMOND HARD should be stored in a cool, dry place. The product has a shelf life of 12 months.

SAFETY
EUCO DIAMOND HARD is a low-VOC product. It is safe for use in occupied spaces. Always wear proper PPE when handling the product.

CONTACT
For more information, contact The Euclid Chemical Company at 877-438-3826 or visit our website at www.euclidchemical.com.

EUCO QWIKJOINT UVR

UV-RESISTANT POLYUREA FLOOR JOINT FILLER

DESCRIPTION
EUCO QWIKJOINT UVR is a polyurea joint filler for concrete joints. It is a two-part, moisture-curing, self-healing joint filler that provides a strong, durable, and long-lasting repair. It is used in conjunction with the RetroPlate 99 liquid densifier and sealer.

PRIMARY APPLICATIONS
• Interior and exterior floors
• Warehouse floors
• Commercial and retail floors
• Manufacturing plants
• Distribution centers
• Industrial facilities

FEATURES/BENEFITS
• Unparalleled UV resistance
• Fast setting
• Easy to apply and easy to maintain

TECHNICAL INFORMATION
Coverage: 225 sq. ft. per gallon
Drying Time: 24 hours
Application: Spray or brush

PACKAGING
EUCO QWIKJOINT UVR is packaged in 5-gallon buckets. Each bucket contains 1.5 gallons of Part A and 1.5 gallons of Part B.

STORAGE
EUCO QWIKJOINT UVR should be stored in a cool, dry place. The product has a shelf life of 12 months.

SAFETY
EUCO QWIKJOINT UVR is a low-VOC product. It is safe for use in occupied spaces. Always wear proper PPE when handling the product.

CONTACT
For more information, contact The Euclid Chemical Company at 877-438-3826 or visit our website at www.euclidchemical.com.

CRETEFILL PRO 75

CONCRETE FILLER

DESCRIPTION
CreteFill Pro 75 is a concrete filler for concrete joints. It is a two-part, moisture-curing, self-healing joint filler that provides a strong, durable, and long-lasting repair. It is used in conjunction with the RetroPlate 99 liquid densifier and sealer.

PRIMARY APPLICATIONS
• Interior and exterior floors
• Warehouse floors
• Commercial and retail floors
• Manufacturing plants
• Distribution centers
• Industrial facilities

FEATURES/BENEFITS
• Increases abrasion and increases durability of the concrete surface
• Provides a smooth, polished appearance
• Reduces dust and dirt
• Easy to apply and easy to maintain

TECHNICAL INFORMATION
Coverage: 225 sq. ft. per gallon
Drying Time: 24 hours
Application: Spray or brush

PACKAGING
CreteFill Pro 75 is packaged in 5-gallon buckets. Each bucket contains 1.5 gallons of Part A and 1.5 gallons of Part B.

STORAGE
CreteFill Pro 75 should be stored in a cool, dry place. The product has a shelf life of 12 months.

SAFETY
CreteFill Pro 75 is a low-VOC product. It is safe for use in occupied spaces. Always wear proper PPE when handling the product.

CONTACT
For more information, contact RetroPlate Systems at 888-942-3144 or visit our website at www.retroplatesystem.com.

RETRO PLATE

POLYUREA JOINT FILLER

DESCRIPTION
RetroPlate is a polyurea joint filler for concrete joints. It is a two-part, moisture-curing, self-healing joint filler that provides a strong, durable, and long-lasting repair. It is used in conjunction with the RetroPlate 99 liquid densifier and sealer.

PRIMARY APPLICATIONS
• Interior and exterior floors
• Warehouse floors
• Commercial and retail floors
• Manufacturing plants
• Distribution centers
• Industrial facilities

FEATURES/BENEFITS
• Unparalleled UV resistance
• Fast setting
• Easy to apply and easy to maintain

TECHNICAL INFORMATION
Coverage: 225 sq. ft. per gallon
Drying Time: 24 hours
Application: Spray or brush

PACKAGING
RetroPlate is packaged in 5-gallon buckets. Each bucket contains 1.5 gallons of Part A and 1.5 gallons of Part B.

STORAGE
RetroPlate should be stored in a cool, dry place. The product has a shelf life of 12 months.

SAFETY
RetroPlate is a low-VOC product. It is safe for use in occupied spaces. Always wear proper PPE when handling the product.

CONTACT
For more information, contact RetroPlate Systems at 888-942-3144 or visit our website at www.retroplatesystem.com.

RETRO PLATE

POLYUREA JOINT FILLER

DESCRIPTION
RetroPlate is a polyurea joint filler for concrete joints. It is a two-part, moisture-curing, self-healing joint filler that provides a strong, durable, and long-lasting repair. It is used in conjunction with the RetroPlate 99 liquid densifier and sealer.

PRIMARY APPLICATIONS
• Interior and exterior floors
• Warehouse floors
• Commercial and retail floors
• Manufacturing plants
• Distribution centers
• Industrial facilities

FEATURES/BENEFITS
• Unparalleled UV resistance
• Fast setting
• Easy to apply and easy to maintain

TECHNICAL INFORMATION
Coverage: 225 sq. ft. per gallon
Drying Time: 24 hours
Application: Spray or brush

PACKAGING
RetroPlate is packaged in 5-gallon buckets. Each bucket contains 1.5 gallons of Part A and 1.5 gallons of Part B.

STORAGE
RetroPlate should be stored in a cool, dry place. The product has a shelf life of 12 months.

SAFETY
RetroPlate is a low-VOC product. It is safe for use in occupied spaces. Always wear proper PPE when handling the product.

CONTACT
For more information, contact RetroPlate Systems at 888-942-3144 or visit our website at www.retroplatesystem.com.

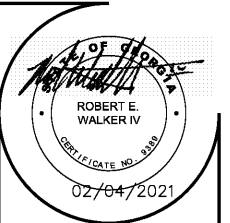

Robert E. Walker, IV
Architect

2225 FIRST AVE. SOUTH
SUITE 110
BIRMINGHAM, Alabama
35233
T-205.254.3212
F-205.254.3269

The following layout shows the required photos to be taken at completion. (Make sure the overhead lights are on for your photos.)

1. From each corner of the receiving area, facing the opposite corner.
2. Hall (inside entrance stores, one picture from each end of the hall).
3. Standing 10' from the entrance facing the entrance.

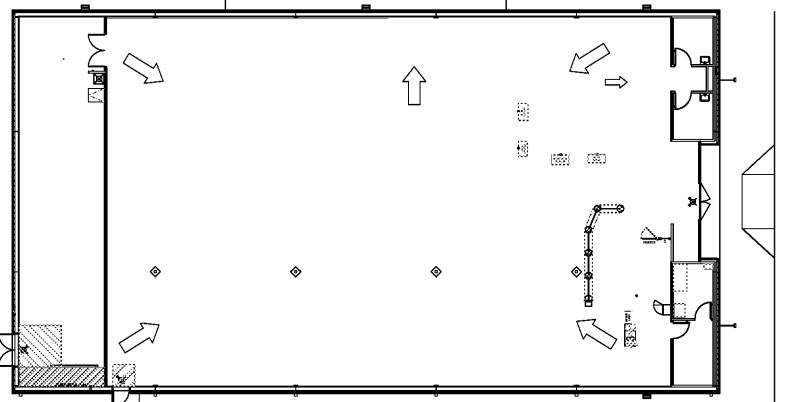

CONSTRUCTION DOCUMENTS

PROJECT NO.: 8095.97
ISSUED: 01/15/2021

CONCRETE SPECS

G1.1