

Client: Ethos Architecture - John Sponseller 303-374-8886, 303-815-0161 (cell); j.sponseller@ethos-architecture.com

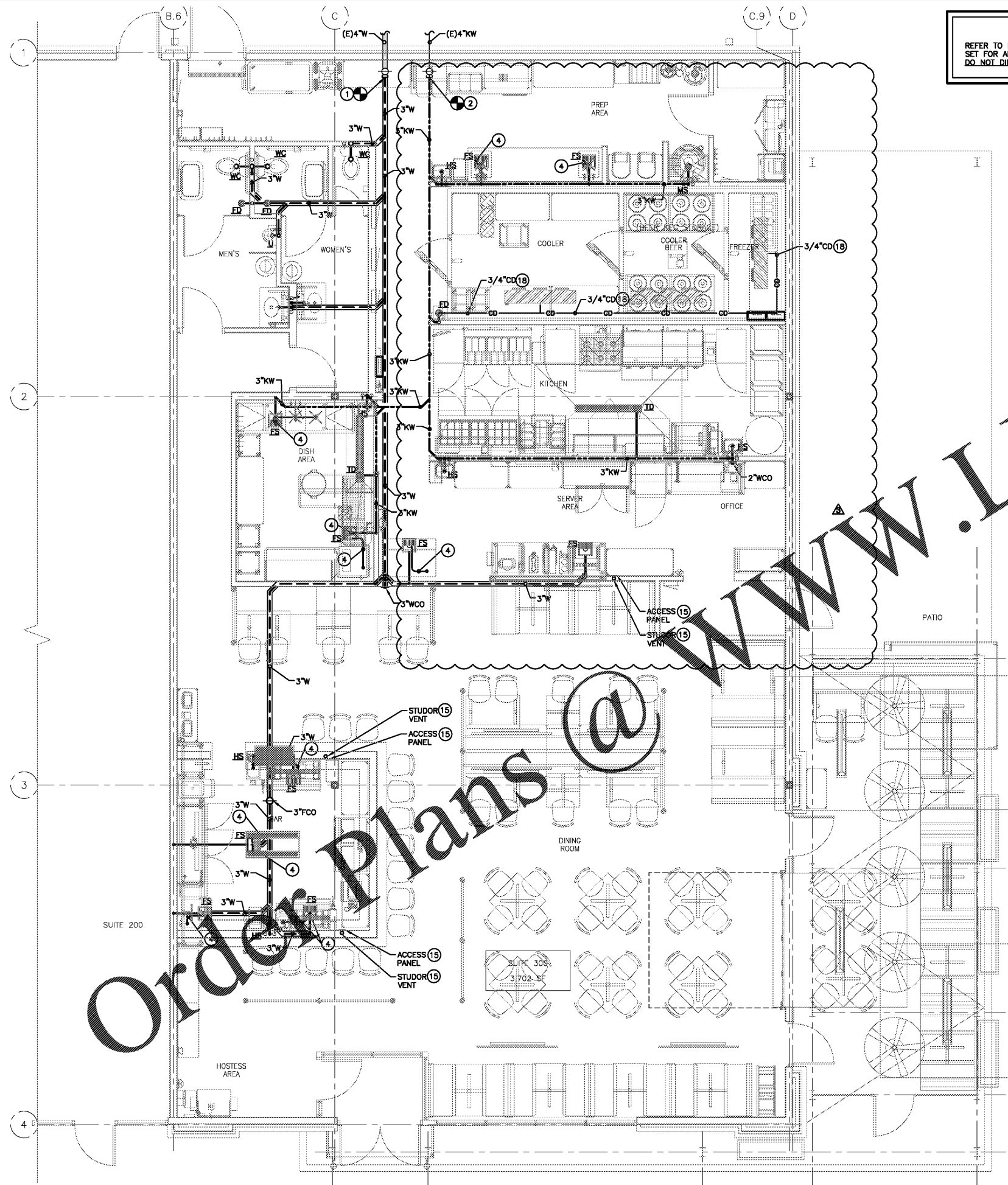

PLUMBING ROUGH-IN NOTE:
 REFER TO EQUIPMENT K-SHEETS IN ARCHITECTURAL DRAWING SET FOR ALL PLUMBING ROUGH-IN DIMENSIONS.
 DO NOT DIMENSION OFF OF P-SHEETS IN THIS DRAWING SET.

- PLUMBING SHEET NOTES**
- Field verify location of existing sanitary waste; verify all sizes, inverts & points-of-connection.
 - Field verify location of existing grease waste; verify all sizes, inverts & points of connection.
 - Field verify location and size of existing CW line prior to connecting new CW.
 - INDIRECT DRAIN/WASTE:** Route to air gap over floor sink
 - Provide 1/2"FW for appliances; provide shut-off valve and Watts model SD-3 backflow preventer with dual check valve at each appliance. Verify connection size with Mfr prior to ordering materials. Provide metallic, lead-free wye pattern strainer in place of standard, plastic strainer - verify compatible fittings with Mfr when ordering.
 - Provide HW (verify required inlet temperature with Mfr) to Dish Machine; provide shut-off valve and Watts model LFO08PCOT backflow preventer.
 - Provide HW (verify required inlet temperature with Mfr) to glass washer; provide shut-off valve and Watts model LFO08PCOT backflow preventer. Provide stainless steel flex after shut-off valve to glass washer to allow equipment to be moved for cleaning and maintenance.
 - SODA SYSTEM WATER FILTER:** Provide CW line with shut-off valve for water serving bag-in-box soda system (soda system by Others). Drop CW line down from above ceiling along surface of wall - do not route CW drop within wall. Locate shut-off valve 12" below drop ceiling - 9ft AFF. See Interior Elevation Details on Arch. sheets for more details. **IMPORTANT:** This filter serves the bag-in-box ONLY.
 - ICE/BEVERAGE MACHINE WATER FILTER:** Provide CW line with shut-off valve for water filter serving dedicated FW line to tea brewer, coffee brewer, and ice machine. Drop CW line down from above ceiling along surface of wall - do not route CW drop within wall. Locate shut-off valve 12" below drop ceiling - 9ft AFF. See Interior Elevation Details on Arch. sheets for more details. **IMPORTANT:** This is not the water filter that serves the bag-in-box soda system.
 - FILTERED WATER TO TEA, COFFEE BREWER, ICE MACHINE:** Route FW line from filter up along surface of wall - do not route FW riser within wall - to above drop ceiling, and over to equipment as necessary.
 - Route water piping down wall behind cabinetry/appliances to bar fixtures.
 - RECIRCULATING HW:** Route HWC piping to within 2ft of each Public Lav and H/S Hand Sink HW connection.
 - Provide CW with shut-off valve and Watts model SD-3 backflow preventer with dual check valve to glass riser. Verify connection size with Mfr prior to ordering materials. Provide metallic, lead-free wye pattern strainer in place of standard, plastic strainer - verify compatible fittings with Mfr when ordering.
 - Route Type K copper pipe underground to equipment as necessary. Insulate HW & HWC with 1"Armaflex direct bury closed-cell piping insulation.
 - STUDDOR VENT:** Locate per Architectural drawings. Provide perforated access panel per Arch.
 - Route FW down in wall for distribution to beverage equipment.
 - TEA/COFFEE BREWER:** Provide brass fittings and piping at FW connection to appliance. Do not use plastic push-connect fittings.
 - Route copper Condensate Drain from walk-in cooler/freezer to air gap over floor drain. Anchor condensate drain to walk-in wall with copper bell hangers sized properly for copper tube. Verify drain size with equipment Mfr prior to ordering materials.
 - NEW GAS PIPING AT 2PSI BY TENANT:** Verify gas requirement on new 2PSI gas piping. Pipe sizing based on $\pm 150ft$ TDL at 2PSI. Verify TDL, all gas inputs, and connection to existing 2psi gas service, prior to ordering piping.
 - NEW GAS PIPING AT 7"WC BY TENANT:** Verify gas requirement on new 7"WC gas piping. Pipe sizing based on $\pm 70ft$ TDL at 7"WC. Verify TDL, all gas inputs, and connection points to piping provided by Landlord, prior to ordering piping.
 - Gas piping on roof per code.
 - Gas piping in Tenant space. Verify height AFF prior to ordering materials.
 - GAS REGULATOR:** gas pressure reduction from 2psi to 7"WC. Where regulator is located within building envelope: vent to exterior per code.
 - EXISTING GAS REGULATOR:** Verify existing gas pressure regulator by Landlord - gas pressure reduction from 2psi to 7"WC.
 - 2"Auto-Gas Valve to close when Ansil system activates.
 - Route gas header down in wall behind kitchen equipment & provide quick-cann valve for each appliance.
 - EXISTING GAS SERVICE: PRIOR TO ESTIMATING COSTS AND ORDERING MATERIALS, CONTRACTOR SHALL VERIFY ALL THE FOLLOWING-** Connection to existing 2PSI gas service; existing gas meter location; TDL of gas inputs; Verify total gas requirement of 1,649 MBH = 394 MBH existing + 1,255 MBH new gas load.

Consultant:
 ARWIN PRIEST P.E., P.Eng.
 MECHANICAL * ENGINEER * ELECTRICAL
 242 MOUNTAIN CLOUD CIRCLE
 HIGHLANDS RANCH, CO 80126
 (303) 898-2664 pc3744@gmail.com

5280 Engineering
 www.DesignMEP.com
 720-320-1744 reg@5280engineering.com

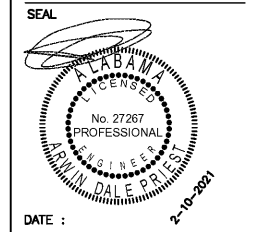

Bad Daddy's BURGER BAR
 GOOD TIMES RESTAURANTS, INC.
 141 Union Blvd, Suite 400
 Lakewood, CO 80228
 tel: (303) 384-1430

BAD DADDY'S BURGER BAR
 "EASTCHASE"
 MONTGOMERY, AL 36117

Issue Record:
 04.23.2019 FOR PLAN REVIEW

Revisions:
 A 02.10.2021 TO GO REVS

Drawn:
 DRAWN BY: E Long

Checked:
 CHECKED BY: R Bank

Project No.
 PROJECT#: 2019-029

Contractor:
 PLUMBING:
 WASTE PLAN, SHEET NOTES

1 SANITARY AND GREASE WASTE PLAN
 P-3 SCALE: 1/4" = 1'-0"

P-3
 of 3