

**GENERAL NOTES:**

1. COMPLETE EQUIPMENT SCHEDULE, SEE SHEETS K3-K5.4.
2. DIMENSIONS MEASURED TO FACE OF STUDS AT NEW WALLS & UNFINISHED EXISTING DEMISING WALLS, FINISH FACE AT EXISTING DEMISING WALLS WITH DRYWALL FINISH.
3. DOOR & FRAME FINISH SCHEDULE, SEE SHEET A600.

**KEY NOTES:**

1. PATIO RAILING, SEE DETAIL B/A410.
2. FINISH T.O. WALL AT 4'-9".
3. NOT USED.
4. METAL SCREEN (SUPPLIED BY BAD DADDY'S) SEE SHEET A430 FOR DIMENSIONS.
5. FRAME WALL FOR 10'-0" (FINISH TO FINISH) OPENING FOR FOOD WARMING SHELF, SEE ELEVATION 1/A210.
6. FRAME WALL WITH 6" STUDS.
7. PROVIDE SOUND BATT AT RESTROOM AND DEMISING WALLS, OWENS CORNING UNFACED GLASS FIBER ACOUSTIC INSULATION COMPLYING WITH ASTM C 665 TYPE 1, OR APPROVED EQUAL.
8. PROVIDE 3"X3" STEEL POST STIFFENER AT FREE ENDS OF WALL, EXPANSION ANCHOR TO SLAB, CONNECT TO WALL FRAMING.
9. TENANT DEMISING WALL PROVIDED BY LANDLORD GC.
10. GC TO PROVIDE PANIC HARDWARE & ALARM DEVICE ON SERVICE DOOR IF NOT PROVIDED, SEE DOOR SCHEDULE ON SHEET A600.
11. PROVIDE STAINLESS STEEL FLASHING TO COVER GAP BETWEEN COOLER AND ADJACENT WALL FRAMING.
12. GC TO COMPLY WITH STOREFRONT DOORS INSTALLED WITH PANIC HARDWARE.
13. STOREFRONT DOOR BY LANDLORD GC. HIGH LIFT OVERHEAD DOOR BY LANDLORD GC.
15. NOT USED.
16. FRAME WALL WITH 2 1/2" STUDS.
17. NEW COLUMN AT PATIO ROOF STRUCTURE. SEE STRUCTURAL DRAWINGS.
18. GC TO PROVIDE 5/8" GYP. BD TO DECK IF MISSING AT PUBLIC AREAS WITH EXPOSED CEILING.
19. PATIO ROOF DOWNSPOUT.
20. PROVIDE PATIO GATE WITH SPRING HINGE AND STRIKE PLATE. GATE W/IZ. DO NOT EASILY IN EXIT DIRECTION WHEN CLOSED (GATE DOES NOT HAVE A LATCH, SPRING ONLY HOLDS GATE IN CLOSED POSITION UNLESS PUSHED). INSTALL STRIKE PLATE WITHOUT HOLES TO GATE. GATE MAY BE PADLOCKED.
21. SHIPPING CONTAINER. SEE EXTERIOR ELEVATIONS STRUCTURAL DRAWINGS.

**FLOOR PLAN LEGEND**

- XX WALL TYPE
- # DOOR NO. SEE DOOR SCHEDULE ON SHEET A600
- X STOREFRONT WINDOW NO. SEE SHEET A600
- X AX EXTERIOR ELEVATION
- 1/AXXX DETAIL SECTION
- NEW INTERIOR PARTITION
- NEW INTERIOR PARTITION W/ SOUND BATT INSULATION
- EXISTING EXTERIOR OR DEMISING INSULATED WALL.

**WALL TYPES**

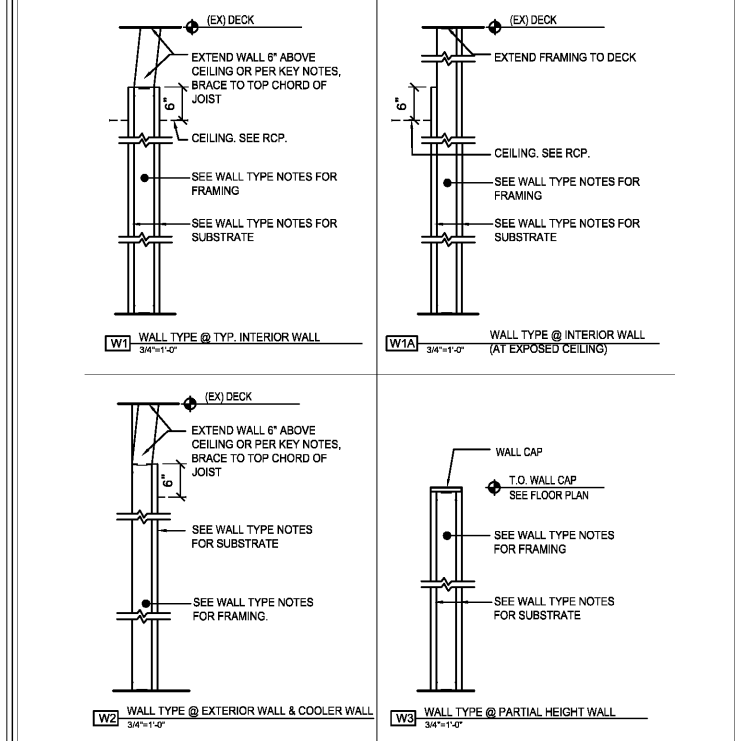

**WALL TYPE NOTES**

1. WALL SUBSTRATES: (ALL PLYWOOD SHEATHING AND WOOD BLOCKING TO BE FIRE-RETARDANT TREATED AT CONSTRUCTION TYPES OTHER THAN TYPE 5)
  - KITCHEN WALLS: 5/8" DENSHIELD 0'-0" TO 1'-6" AFF., 5/8" EXTERIOR PLYWOOD 1'-6" TO 6" ABOVE CEILING. KITCHEN WALLS TO INCLUDE PREP, DISH, SERVER, OFFICE & STORAGE AREAS.
  - PUBLIC AREAS: 5/8" GYP. BOARD. PROVIDE 5/8" FIRE-RETARDANT TREATED PLYWOOD AT BARN SIDING, WW-1.
  - BAR LOW WALLS: 5/8" PLYWOOD
  - WALLS AT HOOD: 5/8" DENSHIELD 16" BEYOND T.O. HOOD, 16" BEYOND ENDS OF HOOD.
  - DEMISING WALL: SUBSTRATE PER THIS LIST OF WALL TYPE NOTES.
  - BATHROOM WALLS: PROVIDE FIRE-RETARDANT TREATED 2X WOOD BACKING AT ALL WALL MOUNTED EQUIPMENT AND BATHROOM ACCESSORY ITEMS. SEE EQUIPMENT PLAN.
2. FRAMING:
  - WALL & PLATFORM FRAMING: 20 GA. 3-5/8" METAL STUDS AT 16" O.C. UNLESS NOTED OTHERWISE.
  - FURRING @ EXISTING WALLS: 20 GA. 2 1/2" FURRING STUDS AT 16" O.C. U.O.N.

CONSULTANT:  
**JOHN SPONSELLER, ARCHITECT**  
 8025 W. 25TH PL.  
 LAKEWOOD, CO 80214  
 TEL: (303) 815-0161

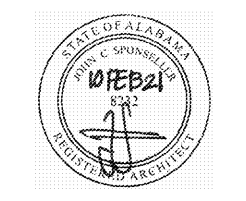

GOOD TIMES RESTAURANTS, INC.  
 141 Union Blvd., Suite 400  
 Lakewood, CO 80228  
 303-384-1430

BAD DADDY'S BURGER BAR  
 "EASTCHASE"  
 THE VENUE EASTCHASE  
 NWC EASTCHASE PKWY &  
 EASTCHASE LN.  
 MONTGOMERY, AL 36117

Issue Record:

4.23.2019	FOR PLAN REVIEW

Revisions:

- 5.6.2019 WALKIN BOX
- 7.1.2019 CANOPY REVS
- 2.10.2021 TO GO REVS

Drawn:  
 DRAWN BY: JS, KC

Checked:  
 CHECKED BY: JS

Project No.  
 PROJECT#: 19-207

Contractor:

**FLOOR PLAN**

A120

Date of Last Print:  
 2.10.2021

**1 FLOOR PLAN**  
 1/4" = 1'-0" NOTE: