

- DEMOLITION NOTES**
- 1 REMOVE MISSING AND/OR DAMAGED WOOD SLATS COMPLETE.
 - 2 REMOVE EXISTING AUTOMATIC SINGLE SLIDING DOOR ASSEMBLY AND AUTOMATIC DOOR SENSOR. EXISTING TRANSOM AND AUTOMATIC SLIDING DOOR OPERATOR TO REMAIN AND ALL INTERNAL OPERATING MECHANISMS TO BE REMOVED.
 - 3 REMOVE EXISTING VESTIBULE COMPLETE.
 - 4 REMOVE EXISTING GWB CEILING COMPLETE.
 - 5 REMOVE EXISTING LIGHT FIXTURES COMPLETE.
 - 6 REMOVE EXISTING ALUMINUM ENTRANCE MAT COMPLETE.
 - 7 REMOVE EXISTING DIRECTIONAL RAIL COMPLETE.
 - 8 FLOORING CONTRACTOR (TENANT HIRED) SHALL REMOVE EXISTING CARPET COMPLETE. GC SHALL NOT INCLUDE IN BID.
 - 9 FLOORING CONTRACTOR (TENANT HIRED) SHALL REMOVE EXISTING VCT COMPLETE. GC SHALL NOT INCLUDE IN BID.
 - 10 FLOORING CONTRACTOR (TENANT HIRED) SHALL REMOVE EXISTING VINYL PLANK FLOORING COMPLETE. GC SHALL NOT INCLUDE IN BID.
 - 11 REMOVE EXISTING BASE COMPLETE.
 - 12 REMOVE PORTION OF EXISTING WALL COMPLETE.
 - 13 REMOVE PORTION OF EXISTING WALL AS INDICATED FOR INSTALLATION OF DOOR IN NEW WORK.
 - 14 REMOVE PORTION OF EXISTING WALL AS INDICATED FOR INSTALLATION OF OPENING IN NEW WORK.
 - 15 REMOVE DOOR AND HARDWARE COMPLETE. FRAME TO REMAIN.
 - 16 REMOVE DOOR, HARDWARE AND FRAME COMPLETE.
 - 17 REMOVE EXISTING UTILITY SINK COMPLETE. FOR REMOVAL OF PLUMBING FIXTURES SEE PLUMBING SHEETS.
 - 18 REMOVE EXISTING CRACKED OR DAMAGED CERAMIC TILE FLOORING AND BASE COMPLETE.
 - 19 REMOVE EXISTING BASE CABINETS, COUNTER AND FIXTURE COMPLETE.
 - 20 REMOVE EXISTING SAFE COMPLETE.
 - 21 EXISTING ACT CEILING TO REMAIN. REMOVE DAMAGED OR DISCOLORED CEILING TILES.
 - 22 REMOVE EXISTING WALL FIXTURES AND FINISHES COMPLETE.
 - 23 REMOVE EXISTING RECESSED TRASH RECEPTACLE AND PAPER TOWEL DISPENSER COMPLETE.
 - 24 REMOVE EXISTING TOILET FIXTURES OR ACCESSORIES NOT IN COMPLIANCE WITH CURRENT HANDICAPPED CODES OR ADA LAW.
 - 25 REMOVE AND CAP EXISTING CONDUIT / OUTLETS COMPLETE TO BELT FINISH FLOOR.
 - 26 FOR REMOVAL AND/OR RELOCATION OF EXISTING ELECTRICAL PANELS, SEE ELECTRICAL SHEETS.
 - 27 REMOVE EXISTING DOWN THRU TELLER COUNTER COMPLETE.
 - 28 EXISTING LIGHT FIXTURES TO REMAIN. CONTRACTOR SHALL VERIFY BULB TYPE AND REMOVE BALLASTS IF REQUIRED. RETROFIT LED KIT. REFER TO SHEET E-10 FOR ADDITIONAL INFO.

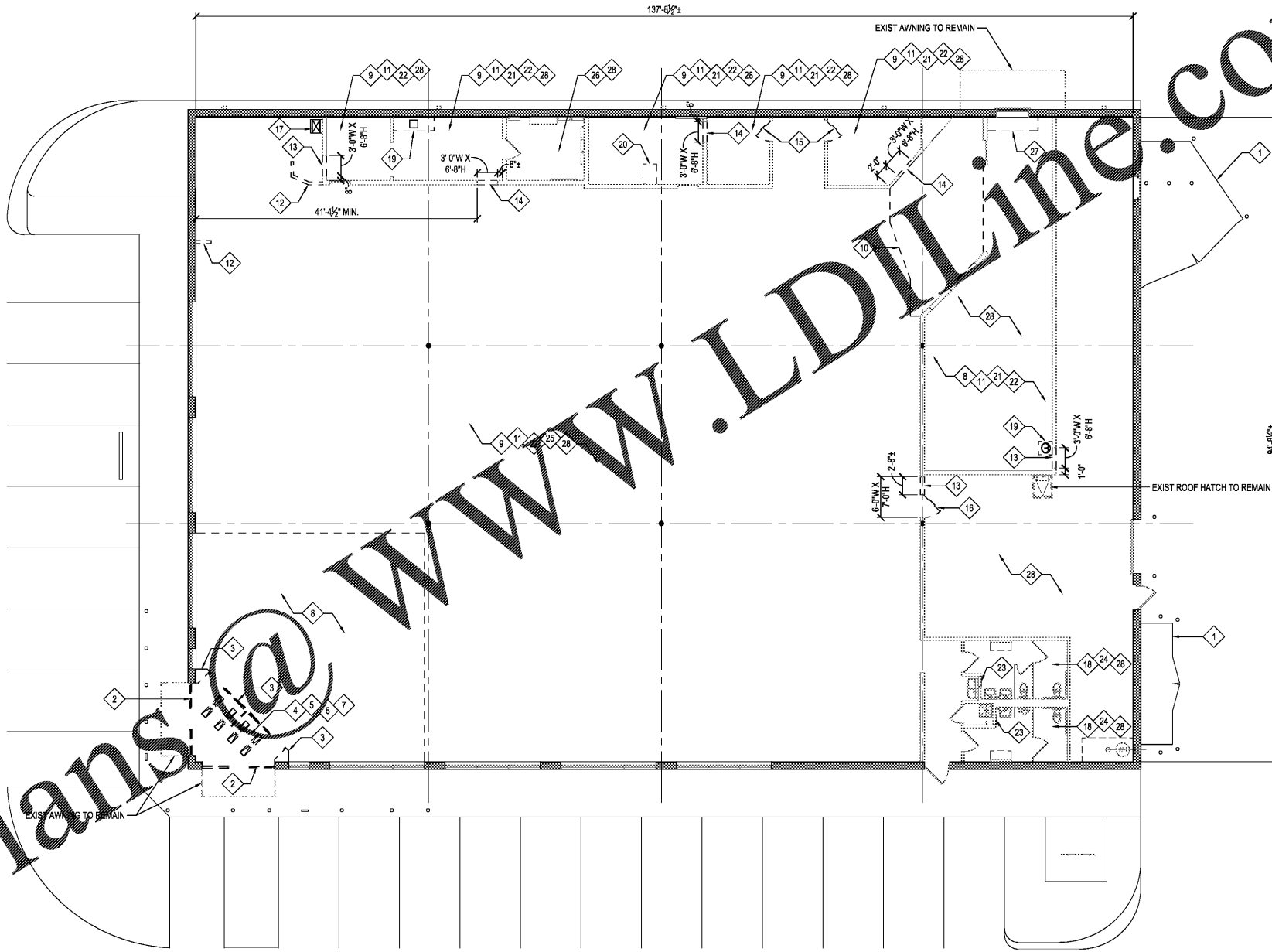

DEMOLITION PLAN
SCALE: 1/8" = 1'-0"
NORTH

Order Plans @ www.LDILLINE.com

--	--

	description
	by
	date
mark	revisions

000001	2110.02	inc	inc	DW
date	project	designed	drawn	checked



RRRM ARCHITECTS, PC
Robert S Berz, Jr, Architect
Duane M Harver, Architect
1317 Executive Blvd, Suite 200
Chesapeake, VA 23320
(757) 522-2828 Fax (757) 652-6883



project	FORMER WALGREENS, FDS #197103
drawing	DEMOLITION PLAN AND NOTES

sheet
D1