

Design No. U905
 Bearing Wall Rating-2 HR.
 Nonbearing Wall Rating-2HR.

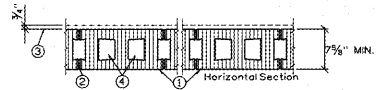

- Concrete Blocks-Bearing the UL Classification Marking. Various designs Classification D-2 (2 hr). See Concrete Blocks catalog lists of eligible manufacturers.
- Mortar-Blocks laid in full bed of mortar, nom. 3/4 in. thick, of not less than 2 1/4 and not more than 3 1/2 parts of clean sharp sand to 1 part Portland cement (proportioned by volume) and not more than 50 percent hydrated lime (by cement volume). Vertical joints staggered.
- Mortar Mixture-Alternate to Mortar-Item 2) Bearing the UL Classification Marking; not more than 130 lbs of sand and 5 gal of water to 75 lbs (one bag) of mortar mixture. Camacho Laboratories, Inc.
- Portland Cement Stucco or Gypsum Plaster-Vhr to classification if used. Where combustible members are framed in wall, plaster or stucco must be applied on the face opposite framing to achieve a max. classification of 1/2 hr.
- Loose Masonry-Fill-core spaces are filled with loose dry expanded slag, expanded clay or shale (rotary kiln process), water repellent vermiculite masonry fill insulation, or silicone treated perlite loose fill insulation, add 2 hr. to classification.

FLOOR/DOOR SPACE DESIGNATION	NUMBER AND ARRANGEMENT OF EXITS		TRAVEL DISTANCE		ARRANGEMENT MEANS OF EGRESS (1.3) SECTION 1015.2	
	REQUIRED	SHOWN ON PLANS	ALLOWABLE TRAVEL DISTANCE (TABLE 1015.1)	ACTUAL TRAVEL DISTANCE SHOWN ON PLANS	REQUIRED DISTANCE BETWEEN EXITS	ACTUAL DISTANCE SHOWN ON PLANS
SALES AREA	3	4	250'	180'	256' / 3 = 85'	235'
SERVICE/SHIPPING	2	2	250'	142'	242' / 3 = 81'	121'
MECHANICAL	1	2	75'	75'	N/A	N/A

(1) CORRIDOR DEAD ENDS (SECTION 1017.3).
 (2) BUILDINGS WITH SINGLE EXITS (TABLE 1015.2), SPACES WITH ONE MEANS OF EGRESS (TABLE 1015.1).
 (3) COMMON PATH OF TRAVEL (SECTION 1014.3).

USE GROUP OF SPACE DESIGNATION	AREA (1) SQ. FT.	AREA (2) PER OCCUPANT (TABLE 1004.1)	CALCULATED OCCUPANT LOAD (TABLE 1004.1)	EGRESS WIDTH PER OCCUPANT (TABLE 1005.1)		REQUIRED WIDTH (SECTION 1005.1)		ACTUAL WIDTH SHOWN ON PLANS	
				(1) (2)	(3)	STAIR LEVEL	STAIR LEVEL	STAIR LEVEL	STAIR LEVEL
SALES AREA - M	36,724	40	918	3	2	N/A	123	N/A	266'
SERVICE/SHIPPING - M	9,263	300	31	3	2	N/A	7	N/A	68'
MECHANICAL	570	300	2	3	2	N/A	1	N/A	72'

FOR SEE: 1 INCH = 25.4 mm, 1 SQUARE FOOT = 0.929m²
 (1) SEE TABLE 1004.1 TO DETERMINE WHETHER NET OR GROSS AREA IS APPLICABLE.
 (2) SEE DEFINITION "AREA, GROSS" AND "AREA, NET" (SECTION 1002).
 (3) MINIMUM STAIRWAY WIDTH (SECTION 1008.1); MIN. CORRIDOR WIDTH (SECTION 1017.3); MIN. EXIT WIDTH (SECTION 1008.1).
 (4) SEE SECTION 1004.5 FOR CONVERGING EXITS.
 (5) THE USE OF ONE MEANS OF EGRESS SHALL NOT REDUCE THE AVAILABLE CAPACITY OF THE TOTAL REQUIRED (SECTION 1005.1).
 (6) ASSEMBLY OCCUPANCIES (SECTION 1008).



bai - ARCHITECTS
 978 Trinity Road - Raleigh, North Carolina 27607 - (919) 857-7171 - bai-architects.com
 THE USE OF THESE PLANS AND SPECIFICATIONS SHALL BE RESTRICTED TO THE ORIGINAL USE FOR WHICH THEY WERE PREPARED AND NO REVISIONS THEREOF IS PERMITTED WITHOUT THE WRITTEN PERMISSION OF BAI ARCHITECTS. VISUAL CONTRACT WITH THESE PLANS AND SPECIFICATIONS SHALL CONSTITUTE FINAL ACCEPTANCE OF THE ACCEPTANCE OF THESE BUILDINGS.



NO.	DATE	COMMENTS/REVISIONS
01	06/03/20	FUTURE PLAN APPROVED
02	07/17/20	RELEASED FOR BIDDING/CONSTRUCTION

INTERIOR RENOVATION FOR
STORE #182 AT WALKERTOWN COMMONS SHOPPING CENTER
 5180 Ralston Road
 Wakeforest, North Carolina 27051
 RELEASED FOR CONSTRUCTION © 07/17/20

lowes THIS

T1.2
 LOWES FOODS
 ST. #182

Order Plans

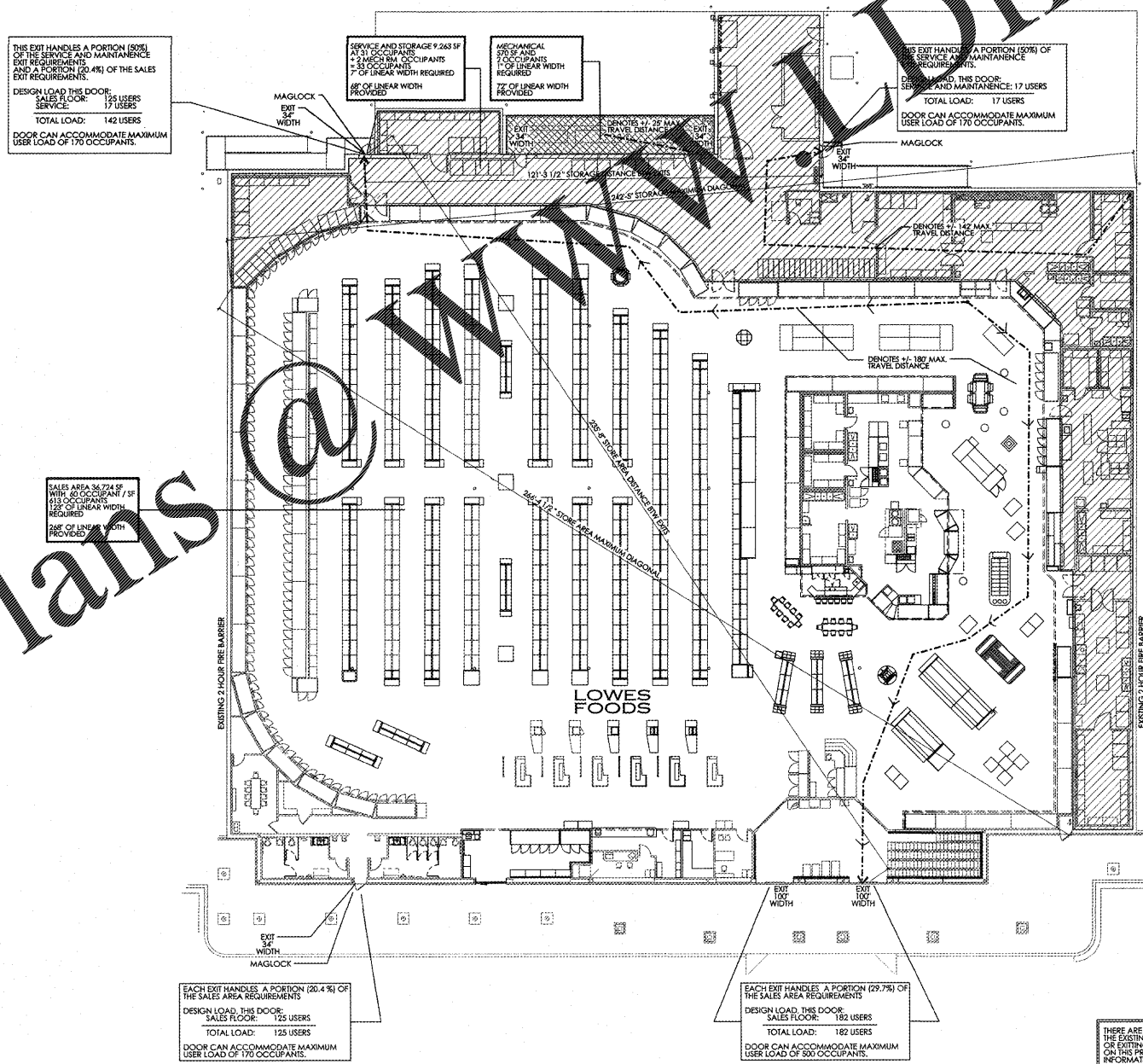

T1.2 LIFE SAFETY PLAN SCALE: 1/16"=1'