

Lancaster County, South Carolina
Indian Land Soccer Complex

10167 Hamisburg Road
Indian Land, SC 29707

Revisions:

Proj. No.: 80702
Date: 10/13/2020

Sheet Name:
Erosion & Sediment Control
Plan - Phase 1

L-501

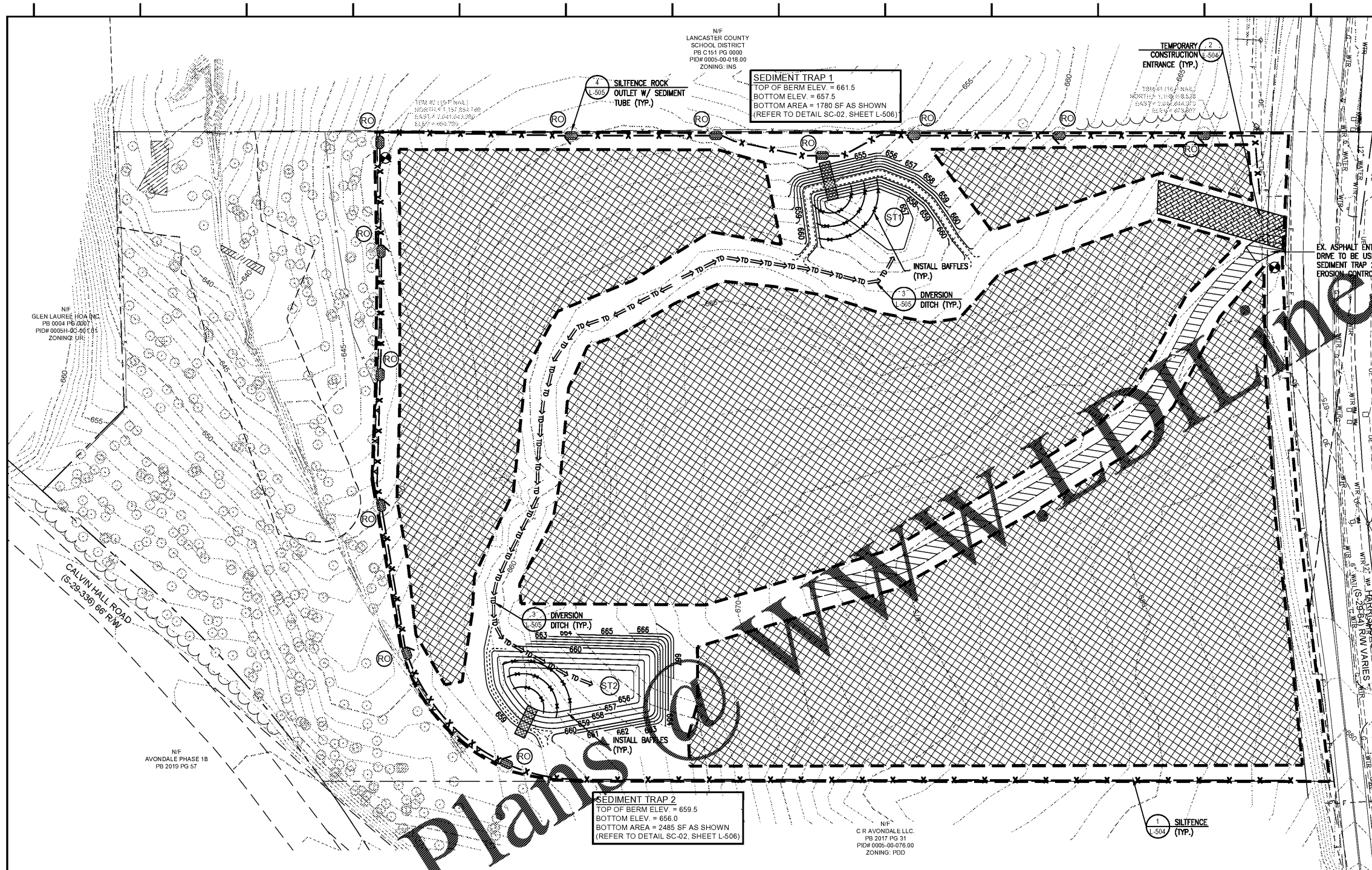
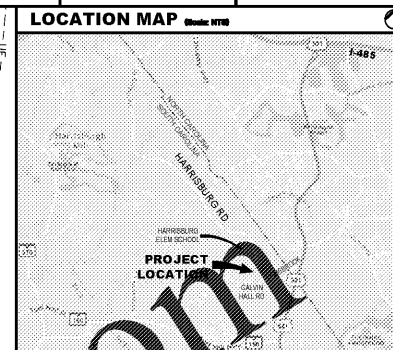

EX. ASPHALT ENTRANCE & GRAVEL DRIVE TO BE USED AS ACCESS TO SEDIMENT TRAP 2 DURING PH 1 EROSION CONTROL CONSTRUCTION.

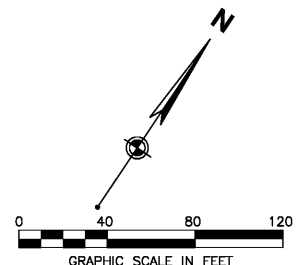

TEMPORARY SEEDING/ COVER REQUIREMENTS

TEMPORARY SEEDING IS USED ON EXPOSED SOIL SURFACES SUCH AS DENUDED AREAS, SOIL STOCKPILES, DIKES, DAMS, BANKS OF SEDIMENT BASINS, BANKS OF SEDIMENT TRAPS, AND TEMPORARY ROAD BANKS. TEMPORARY SEEDING PREVENTS AND LIMITS COSTLY MAINTENANCE OPERATIONS ON OTHER SEDIMENT CONTROL STRUCTURES. SEDIMENT CLEANOUT REQUIREMENTS FOR SEDIMENT BASINS, SEDIMENT TRAPS, AND SILT FENCE IS REDUCED IF THE DRAINAGE AREA IS SEEDED WHEN GRADING AND CONSTRUCTION OPERATION ARE NOT TAKING PLACE.

TEMPORARY STABILIZATION IS REQUIRED WITHIN 14 DAYS AFTER CONSTRUCTION ACTIVITY IS COMPLETE UNLESS CONSTRUCTION ACTIVITY IS GOING TO RESUME WITHIN 21 DAYS. COVER SEEDING AREAS WITH AN APPROPRIATE MULCH TO PROVIDE PROTECTION FROM THE WEATHER. WHEN THE TEMPORARY VEGETATION IS NOT GROWING QUICK ENOUGH OR THICK ENOUGH TO PREVENT EROSION, RE-SEED AS SOON AS POSSIBLE. KEEP SEEDING AREAS ADEQUATELY MOIST. IRRIGATE THE SEEDING AREA IF NORMAL RAINFALL IS NOT ADEQUATE FOR THE GERMINATION AND GROWTH OF SEEDINGS. WATER SEEDING AREAS AT CONTROLLED RATES THAT ARE LESS THAN THE RATE AT WHICH THE SOIL CAN ABSORB WATER TO PREVENT RUNOFF. RUNOFF OF IRRIGATION WATER WASTES WATER AND CAN CAUSE EROSION.

SEED SELECTION:
SEED SELECTION IS BASED ON GEOGRAPHICAL LOCATION, SOIL TYPE AND THE SEASON OF THE YEAR IN WHICH THE PLANTING IS TO BE DONE. APPENDIX C OF THE SCDHEC SEDIMENT CONTROL BMP HANDBOOK IS TO BE USED AS A GUIDE FOR SELECTING MATERIALS FOR CONVENTIONAL TILLAGE METHODS (PLOWING, SEEDBED PREPARATION, HYDROSEEDING, ETC).

THE CONTRACTOR IS TO SUBMIT ALL PROCEDURES, METHODS AND MATERIALS USED FOR TEMPORARY SEEDING OPERATIONS FOR THE OWNERS' & DESIGNERS APPROVAL PRIOR TO PERFORMING THE WORK

- INSPECTION AND MAINTENANCE:**
- INSPECT EVERY 7 CALENDAR DAYS AND WITHIN 24-HOURS AFTER EACH RAINFALL EVENT THAT PRODUCES 1/8-INCHES OR MORE OF PRECIPITATION.
 - COVER SEEDING WITH MULCH TO PROVIDE PROTECTION. FREQUENT INSPECTIONS ARE NECESSARY TO CHECK THAT CONDITIONS FOR GROWTH ARE GOOD.
 - SUPPLY TEMPORARY SEEDING WITH ADEQUATE MOISTURE. SUPPLY WATER AS NEEDED, ESPECIALLY IN ABNORMALLY HOT OR DRY WEATHER OR ON ADVERSE SITES. CONTROL WATER APPLICATION RATES TO PREVENT RUNOFF.
 - BASE SEED SELECTION ON LOCAL SPECIFICATIONS.
 - RE-SEED AREAS WHERE THE PLANTS DO NOT GROW QUICK ENOUGH, THICK ENOUGH, OR ADEQUATELY ENOUGH TO PREVENT EROSION SHOULD BE RE-SEEDING.

PHASE 1 SEQUENCING NOTES

- RECEIVE NPDES COVERAGE FROM SC DEPARTMENT OF HEALTH AND ENVIRONMENTAL CONTROL (SC DHEC).
- CONDUCT PRE-CONSTRUCTION MEETING FOR PROJECT TO REVIEW STORM WATER POLLUTION PREVENTION AND SEDIMENT CONTROL MEASURES.
- INSTALL STABILIZED CONSTRUCTION ENTRANCE. THE LOCATION MAY VARY WITH APPROVAL AT THE PRE-CONSTRUCTION MEETING. CLEAR FOR INSTALLATION OF INITIAL EROSION CONTROL DEVICES.
- INSTALL PERIMETER SILT FENCES WITH OUTLETS IN THE LOCATIONS SHOWN FOR THE INITIAL PHASE AND AS DIRECTED BY SC DHEC, ENGINEER OF RECORD OR LANCASTER COUNTY DURING THE PRE-CONSTRUCTION MEETING. IF IDENTIFIED ON THE PLANS, A DOUBLE ROW SILT FENCE SHALL BE MAINTAINED TO PROTECT THE WETLAND AND BUFFER AS MUCH AS PRACTICAL.
- INSTALL STAGING AREAS WITHIN THE CONSTRUCTION LIMITS AS REQUIRED FOR THE PROJECT. THE LOCATION SHALL BE APPROVED BY THE ENGINEER OF RECORD AND LANCASTER COUNTY.
- CONSTRUCT SEDIMENT TRAPS IN ACCORDANCE WITH THE APPROVED PLAN.
- CONSTRUCT TEMPORARY DIVERSION DITCHES AND RIP RAP OUTLET PROTECTION TO SEDIMENT TRAPS. INSTALL SEDIMENT TUBE(S) ACROSS FLOW CHANNEL(S) AT 45 FOOT MAXIMUM SPACING.
- CONTACT SC DHEC TO CONDUCT SITE INSPECTION PRIOR TO CONTINUATION. STATE INSPECTOR SHALL BE GIVEN 48 HOURS ADVANCE NOTIFICATION.

GENERAL NOTES

- SEE SHEET G-003 FOR ADDITIONAL EC NOTES.
- SEE SHEETS L-504 THRU L-507 FOR EROSION & SEDIMENT CONTROL DETAILS.
- SEE SHEET L-505 FOR SCDHEC STANDARD EROSION & SEDIMENT CONTROL NOTES.
- TEMPORARY DIVERSION DITCHES AND WATER BARS (IF USED) SHALL BE REPAIRED / RESHAPED AT THE END OF EACH WORK DAY TO MATCH THE STATUS OF CONSTRUCTION.
- PROVIDE GROUND COVER ON ALL AREAS THAT WILL NOT BE DISTURBED BY CONSTRUCTION WITHIN SEVEN (7) CALENDAR DAYS IN ACCORDANCE WITH THE STATE'S GROUND STABILIZATION SCHEDULE.
- CONTRACTOR SHALL DILIGENTLY AND CONTINUOUSLY MAINTAIN AND CORRECT ALL EROSION CONTROL DEVICES AND STRUCTURES TO INCLUDE NECESSARY REPAIRATION TO EXISTING CONDITIONS OUTSIDE THE LIMITS OF CONSTRUCTION AS A RESULT OF SITE CONSTRUCTION UNTIL SUCH TIME THAT FINAL STABILIZATION IS DEEMED ACCEPTABLE.
- SEDIMENT SHALL BE REMOVED / HAULED FROM THE SITE UNLESS AN APPROVED ON-SITE LOCATION IS IDENTIFIED BY THE OWNER. REMOVAL AND HAULING SHALL BE AT NO ADDITIONAL COST TO THE OWNER.
- SKIMMER UNIT SHALL BE MAINTAINED IN OPERATING CONDITION.
- EXCESS FILL MATERIAL AND TOPSOIL MAY BE STOCKPILED AND STORED AT A LOCATION APPROVED BY THE EROSION CONTROL INSPECTOR.
- STABILIZE SITE AS AREAS ARE BROUGHT TO FINISH GRADE. EROSION CONTROL MATING AS INDICATED ON THE PLANS SHALL BE INSTALLED AS SOON AS POSSIBLE AFTER FINAL GRADE IS ESTABLISHED TO LIMIT POTENTIAL FOR RILL EROSION.
- ALL EROSION CONTROL MEASURES SHALL BE CONSTRUCTED IN ACCORDANCE WITH THE SC DHEC BMP HANDBOOK, US DEPARTMENT OF AGRICULTURE, AND LANCASTER COUNTY.

LEGEND

EXISTING		EROSION CONTROL	
	TREE (6" OR LARGER)		LIMITS OF DISTURBANCE
	SIGN		SILT FENCE
	FIBER OPTICS MANHOLE		SILT FENCE ROCK OUTLET W/SEDIMENT TUBE
	FIBER OPTICS BOX		SEDIMENT TRAP
	UTILITY POLE		BASIN WEIR ELEVATION
	FIRE HYDRANT		BAFFLE
	WATER METER		TEMP. DIVERSION DITCH
	WATER LINE		RIPPRAP AT SEDIMENT TRAP OVERFLOW
	UNDERGROUND ELECTRIC		CONSTRUCTION ENTRANCE (24' X 100')
	OVERHEAD ELECTRIC		LIMITS OF NO DISTURBANCE DURING PHASE 1 EROSION CONTROL DEVICE INSTALLATION
	UNDERGROUND FIBER OPTICS		
	GAS LINE		
	TREE LINE		
	VEGETATION		
	TEMPORARY BENCHMARK		