

**GENERAL NOTES:**

A. TYPE 'UT' LIGHTING POLES, FIXTURES AND CIRCUITS PROVIDED, INSTALLED AND POWERED BY UTILITY. LOCATIONS SHOWN FOR REFERENCE. COORDINATE WITH UTILITY LIGHTING CONTRACTOR.

**REFERENCE KEYNOTES:**

- 1 (2) 6" PVC CONDUITS (1) FOR ELECTRICITY UTILITY HIGH VOLTAGE CABLE. PROVIDE BULLHEAD ON PULL ROPE. OTHER CONDUIT - SPARE.
- 2 PROVIDE AND INSTALL PEDESTAL LIGHTING FIXTURE TO SPORTS LIGHTING CONTROL PANEL. COORDINATE INSTALLATION WITH SPORTS LIGHTING CONTRACTOR. PROVIDE AND INSTALL PEDESTAL LIGHTING FIXTURES TO ENTRANCE SIGN. COORDINATE EXACT LOCATION OF SIGN WITH SIGN INSTALLATION. PROVIDE AND INSTALL EXTERIOR LIGHTING CONTROL DIAGRAM. DETAIL #5/E.
- 3 PROVIDE AND INSTALL (2) HAND HOLES. ONE HAND HOLE FOR SPORTS LIGHTING CIRCUITS AND ONE HAND HOLE FOR PEDESTAL LIGHTING AND FUTURE ELECTRICAL REQUIREMENTS.
- 4 PROVIDE (8) 2" CONDUITS WITH PULLSTRINGS FROM SPORTS LIGHTING CONTROL PANEL TO SPORTS LIGHTING HAND HOLE.
- 5 PROVIDE (2) 2" CONDUITS WITH PULLSTRINGS FROM PANEL 'A' AND (2) 2" CONDUITS WITH PULLSTRINGS FROM LIGHTING CONTROL PANEL TO HANDHOLE.
- 6 PROVIDE (2) #10G IN 2" CONDUIT FOR POWER TO ENTRANCE SIGN FROM PANEL 'A'. COORDINATE EXACT LOCATION OF CIRCUIT TERMINATION WITH SIGN INSTALLATION. PROVIDE PULL STRING IN CONDUIT.
- 7 PROVIDE (1) 2" CONDUIT WITH PULLSTRING FOR FUTURE COMMUNICATIONS AT ENTRANCE SIGN FROM TELECOM ROOM. PROTECT AND MARK CONDUIT LOCATION AT SIGN FOR FUTURE USE.
- 8 PROVIDE (2) 2" CONDUITS WITH PULLSTRINGS FROM ELECTRICAL PANELS FOR FUTURE SCOREBOARD POWER. PROVIDE HANDHOLES AS SHOWN ON PLANS.
- 9 PROVIDE (1) 2" CONDUIT WITH PULLSTRING FROM IRRIGATION CONTROLLER TO NEAREST LANDSCAPE AREA. MARK AND COORDINATE LOCATION WITH IRRIGATION SYSTEM INSTALLER.
- 10 PROVIDE AND INSTALL (2) IN-GRADE LED UPLIGHTS FOR FLAGPOLE LIGHTING. LIGHTS SHALL BE REMOTELY AIMABLE FOR ADJUSTMENT AFTER INSTALLATION. PROVIDE A GRAVEL BUFFER ZONE PER MANUFACTURER'S RECOMMENDATIONS AND INSTALL FIXTURE SLIGHTLY HIGHER THAN GRADE. COORDINATE INSTALLATION WITH LANDSCAPING.
- 11 PROVIDE (1) 2" CONDUIT WITH PULLSTRING TO GATE LOCATION. MARK AND PROTECT CONDUIT TERMINATION NEAR GATE FOR FUTURE USE.
- 12 PROVIDE CONDUIT AND WIRING TO IRRIGATION SYSTEM BOOSTER PUMP ASSEMBLY. COORDINATE EXACT CONNECTION REQUIREMENTS WITH IRRIGATION CONTRACTOR.



Lancaster County, South Carolina  
**Heath Springs Soccer Complex**

200 Boyd Falle Road  
Heath Springs, SC 29058

Revisions:

Proj. No.: 80703  
Date: 10/09/2020

Sheet Name:  
ELECTRICAL SITE  
PLAN

**ES-001**

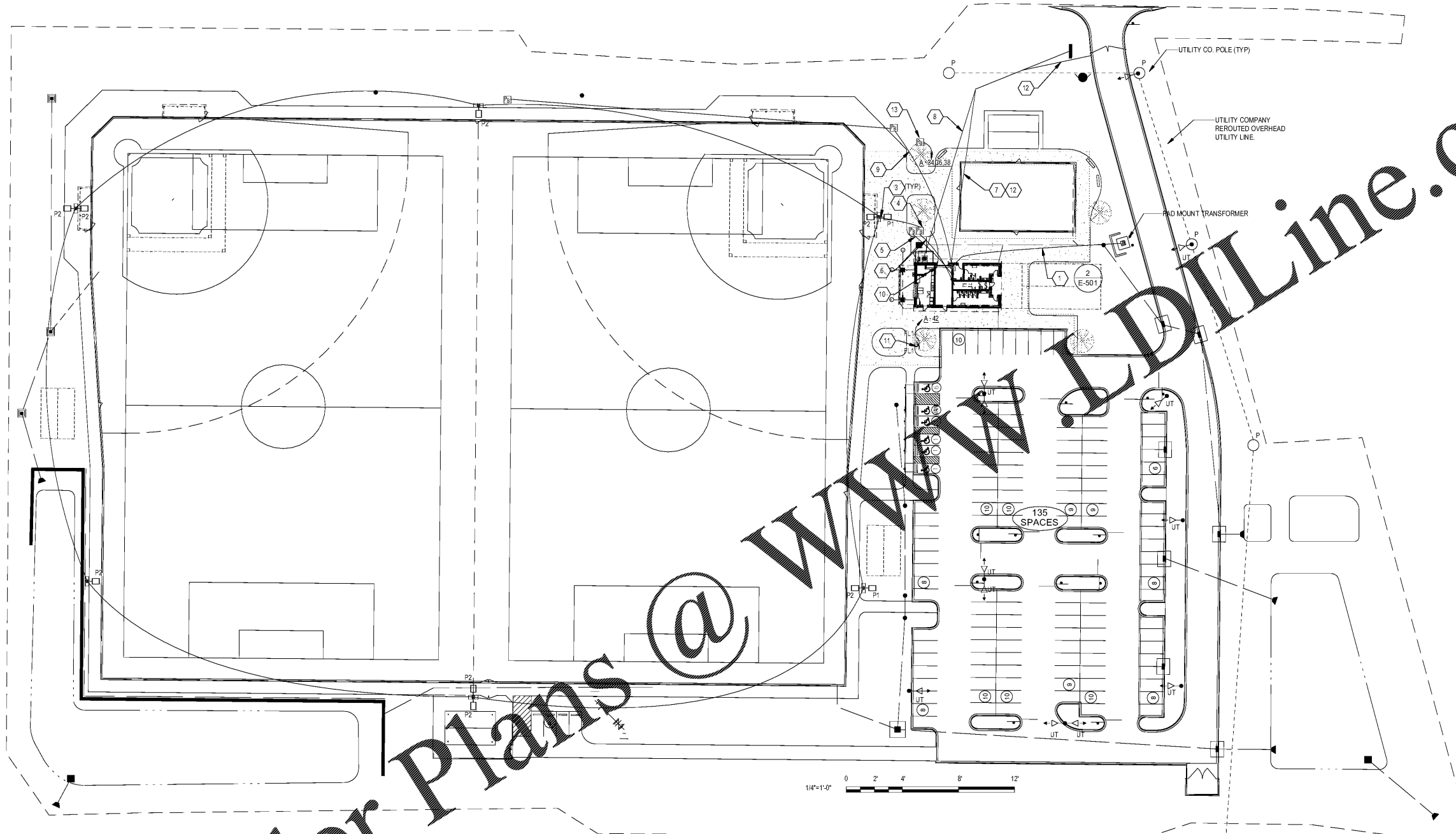

Order Plans @ [Woolpert@Woolpert.com](mailto:Woolpert@Woolpert.com)

**1 ELECTRICAL SITE PLAN**  
SCALE: 1" = 40'-0"

