

**ACCESSIBLE SIGNAGE (VAN)**

NOTES:

1. ALL ACCESSIBLE PARKING SPACES SHALL BE A MINIMUM 8' (96") WIDE.
2. TWO ACCESSIBLE PARKING SPACES MAY SHARE A COMMON ACCESS AISLE.

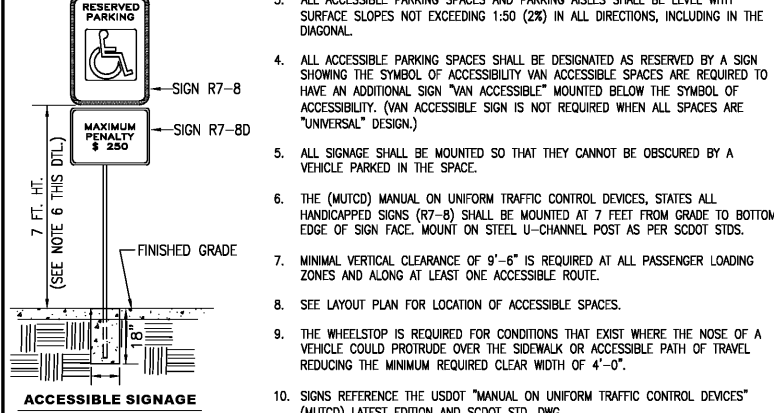

**ACCESSIBLE SIGNAGE (CAR)**

3. ALL ACCESSIBLE PARKING SPACES AND PARKING AISLES SHALL BE LEVEL WITH SURFACE SLOPES NOT EXCEEDING 1:50 (2%) IN ALL DIRECTIONS, INCLUDING IN THE DIAGONAL.
4. ALL ACCESSIBLE PARKING SPACES SHALL BE DESIGNATED AS RESERVED BY A SIGN SHOWING THE SYMBOL OF ACCESSIBILITY VAN ACCESSIBLE SPACES ARE REQUIRED TO HAVE AN ADDITIONAL SIGN "VAN ACCESSIBLE" MOUNTED BELOW THE SYMBOL OF ACCESSIBILITY. (VAN ACCESSIBLE SIGN IS NOT REQUIRED WHEN ALL SPACES ARE "UNIVERSAL" DESIGN.)
5. ALL SIGNAGE SHALL BE MOUNTED SO THAT THEY CANNOT BE OBTUSCED BY A VEHICLE PARKED IN THE SPACE.
6. THE (MUTCD) MANUAL ON UNIFORM TRAFFIC CONTROL DEVICES, STATES ALL HANDICAPPED SIGNS (R7-8) SHALL BE MOUNTED AT 7 FEET FROM GRADE TO BOTTOM EDGE OF SIGN FACE. MOUNT ON STEEL U-CHANNEL POST AS PER SCOOT STDS.
7. MINIMAL VERTICAL CLEARANCE OF 9'-6" IS REQUIRED AT ALL PASSENGER LOADING ZONES AND ALONG AT LEAST ONE ACCESSIBLE ROUTE.
8. SEE LAYOUT PLAN FOR LOCATION OF ACCESSIBLE SPACES.
9. THE WHEELSTOP IS REQUIRED FOR CONDITIONS THAT EXIST WHERE THE NOSE OF A VEHICLE COULD PROTRUDE OVER THE SIDEWALK OR ACCESSIBLE PATH OF TRAVEL REDUCING THE MINIMUM REQUIRED CLEAR WIDTH OF 4'-0".
10. SIGNS REFERENCE THE USDOT "MANUAL ON UNIFORM TRAFFIC CONTROL DEVICES" (MUTCD) LATEST EDITION AND SCOOT STD. DWG.

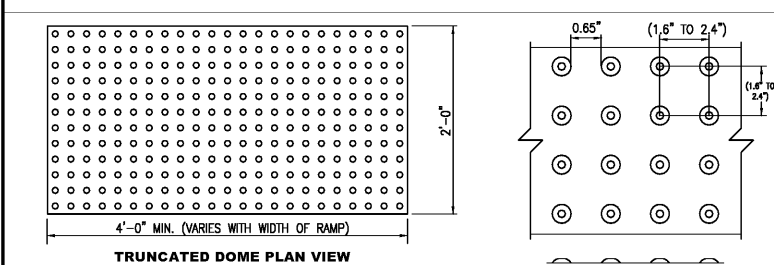

**TRUNCATED DOME SECTION**

NOTES:

1. ALL DETECTABLE WARNING DEVICES USED IN NEW CONSTRUCTION SHALL BE OF A RIGID PRECAST OR EMBEDDED PRODUCT APPROVED BY THE COUNTY ENGINEER.
2. WIDTH OF DETECTABLE WARNING AREA SHALL BE A MINIMUM OF FOUR (4) FEET AND VARY WITH WIDTH OF RAMP.
3. LENGTH OF DETECTABLE WARNING AREA SHALL BE 2 FEET REGARDLESS OF SECTION WIDTH.
4. DETECTABLE WARNING AREA CAN BE SQUARE WHERE USED IN A CURB RADIUS.
5. DETECTABLE WARNING DOMES SHALL BE ALIGNED ON A SQUARE GRID IN THE PREDOMINANT DIRECTION OF OF TRAVEL TO PERMIT WHEELS TO ROLL BETWEEN DOMES.
6. DETECTABLE WARNING AREA SHALL BE COLORED BLACK.
7. IF PAVERS ARE TO BE USED, PAVERS SHALL BE 6" THICK AND CAST FROM 5000 PSI CONCRETE.
8. MATS ARE TO BE RIGID WITH TURN DOWN EDGES EMBEDDED IN CONCRETE TO ELIMINATE TRIP HAZARD.
9. REFERENCE SCOOT STANDARD DRAWINGS NO. 720-901-01 THROUGH 720-901-04.

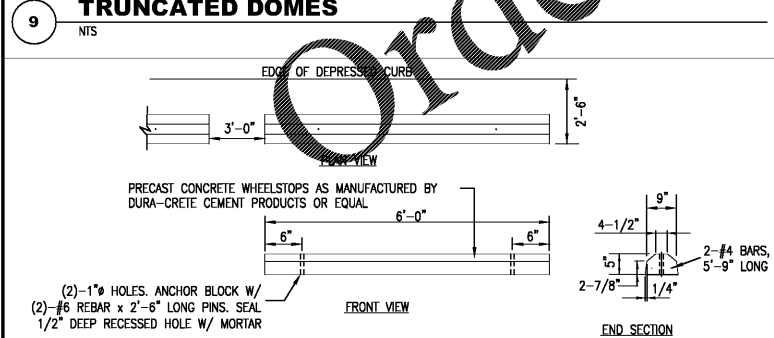

**WHEELSTOPS**

NTS

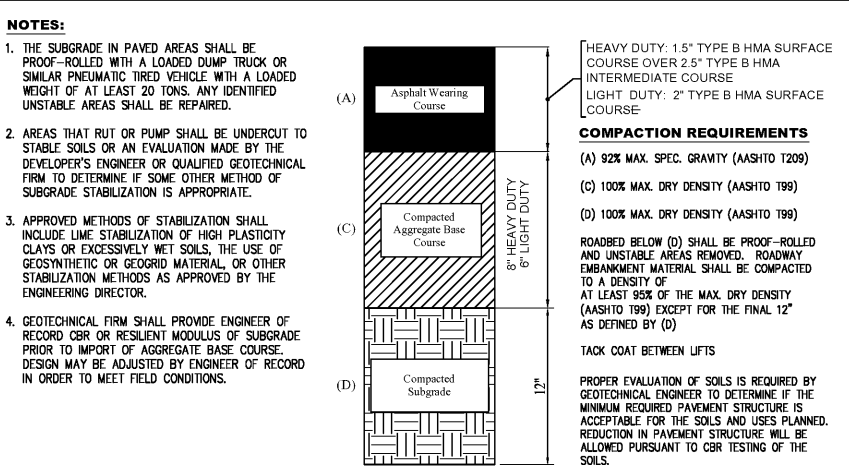

**ASPHALT PAVEMENT**

NTS

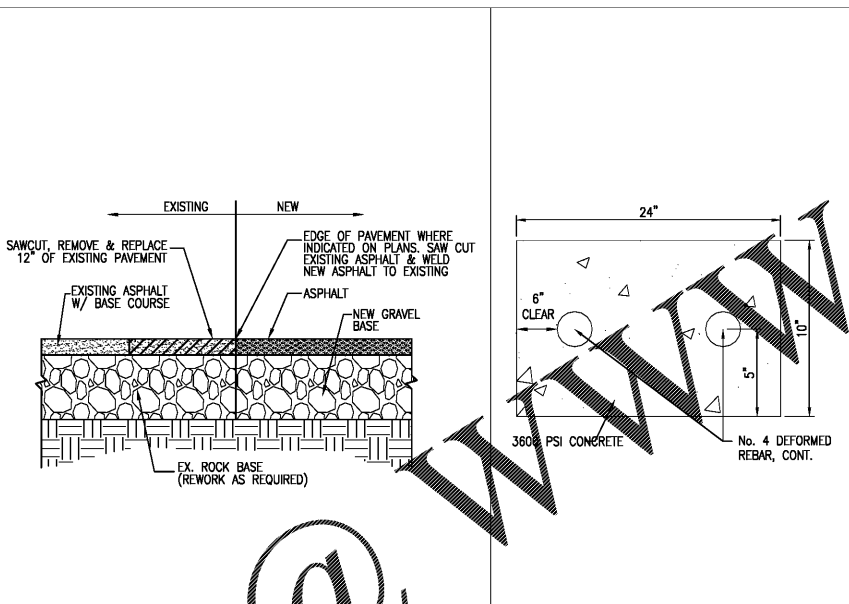

**ASPHALT CONNECTION**

NTS

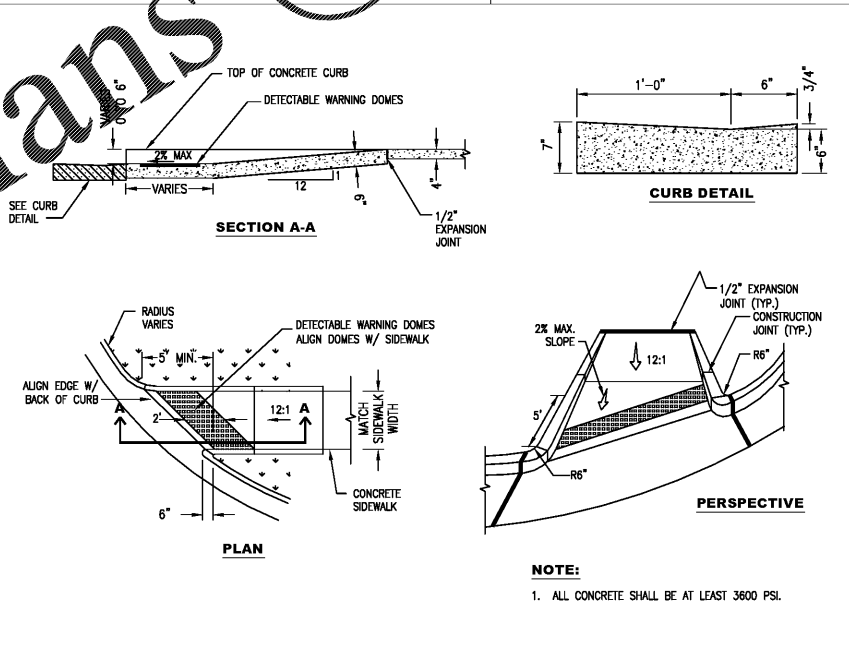

**DIRECTIONAL RAMP**

NTS

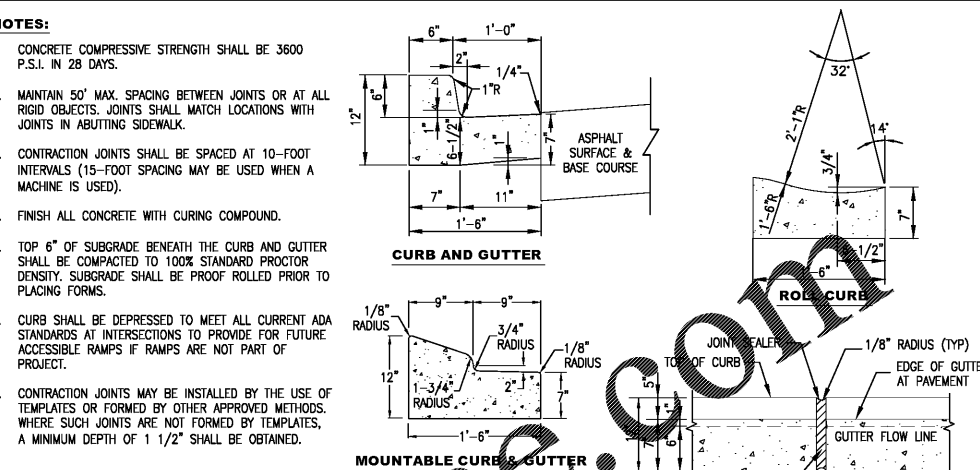

**18" CONCRETE CURB & GUTTER**

NTS

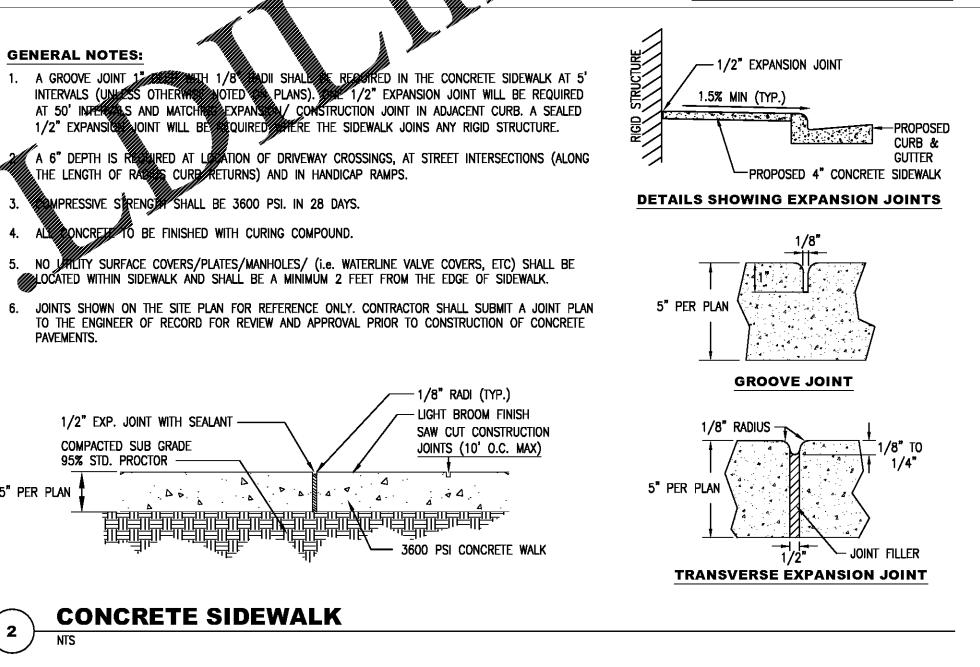

**CONCRETE SIDEWALK**

NTS

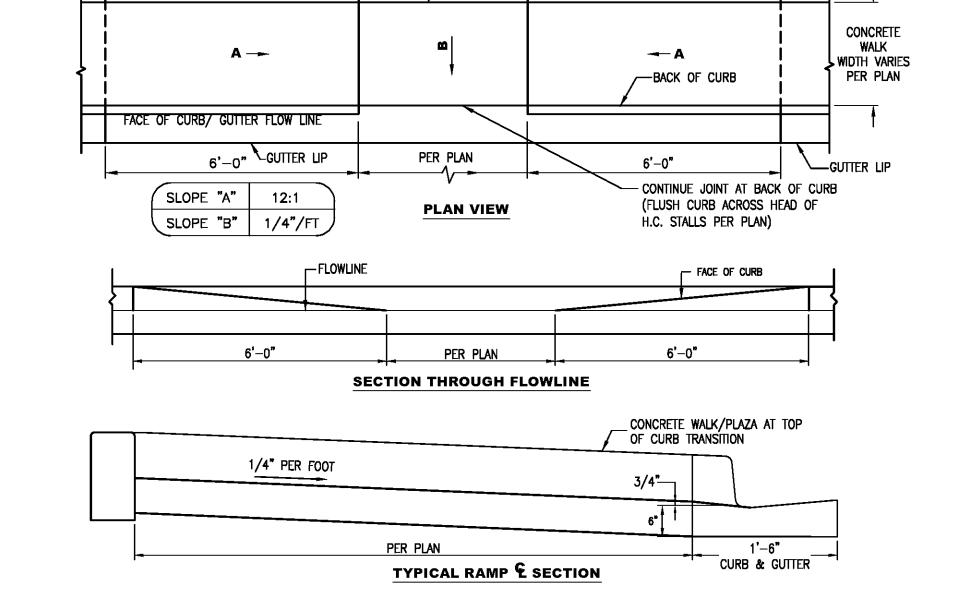

**DEPRESSED CURB**

NTS

