

Order Plans @ [www.lidline.com](http://www.lidline.com)

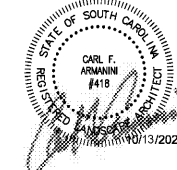

Lancaster County, South Carolina  
**Heath Springs Soccer Complex**

200 Boyd Fails Road  
Heath Springs, SC 29058

Revisions:

Proj. No.: 80703  
Date: 10/13/2020

Sheet Name:  
Grading  
Enlargement Plan  
& Drainage Details

**L-508**

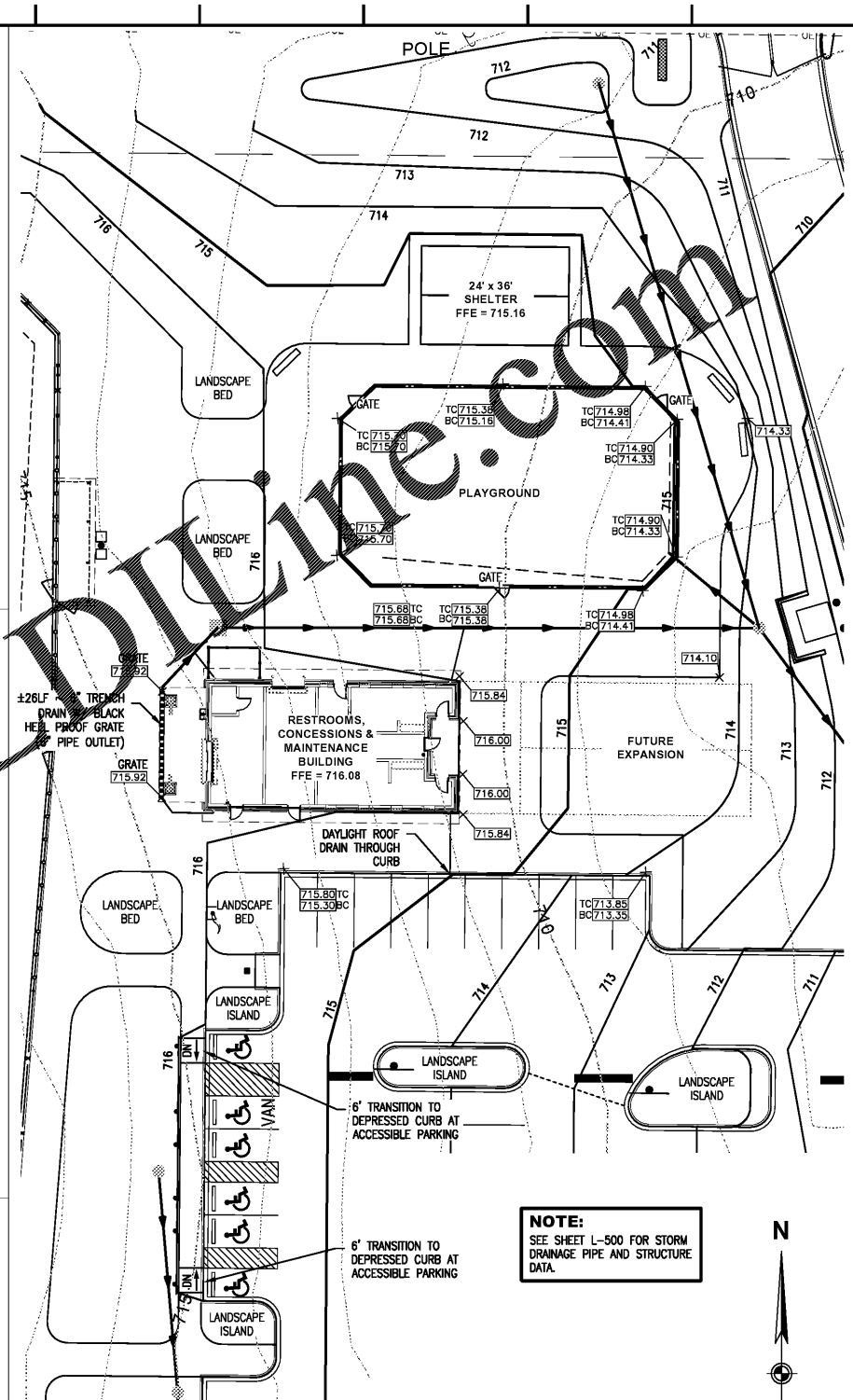

**NOTE:**  
SEE SHEET L-500 FOR STORM  
DRAINAGE PIPE AND STRUCTURE  
DATA.

LEGEND	
<b>EXISTING</b>	<b>NEW</b>
TREE (H-HARDWOOD/E-EVERGREEN)	PLAYGROUND SURFACE
SIGN	CONCRETE PAVEMENT
710 --- CONTOUR LINE	LIGHT DUTY ASPHALT PAVEMENT
	HEAVY DUTY ASPHALT PAVEMENT
	YARD INLET
	CATCH BASIN
	SPORTS LIGHTING
	ACCESSIBLE PARKING SIGN
	STORM PIPE
	COLLECTOR DRAIN
	TREE LINE
	665 --- CONTOUR LINE
	PROPOSED SPOT ELEVATION = 623.10
	HIGH PT (HP)
	TOP/BOTTOM OF CURB (TC/BC)

**1 Grading Enlargement Plan**  
SCALE: 1" = 20'  
PLAZA & PLAYGROUND