

STAGE 2:
INSTALL TEMP STRIPING, PVT MARKINGS & SIGNS.
SHIFT EXIST SIGNAL HEADS @ KIA PKWY FOR STAGE 2 TRAFFIC (COVER SIGNAL HEADS NOT IN USE).
SHIFT WB TRAFFIC OVER TO EB LANE AS SHOWN.
CONSTRUCT PROP PVT. MINUS 12.5MM SURFACE COURSE, DRAINAGE AND SHOULDER CONSTRUCTION FOR NORTH SIDE OF SR 18.
MAINTAIN ACCESS TO ALL DRIVEWAYS.

ESA - SEE ENVIRONMENTAL RESOURCES IMPACT TABLE
GENERAL NOTES FOR CONSTRUCTION RESTRICTIONS

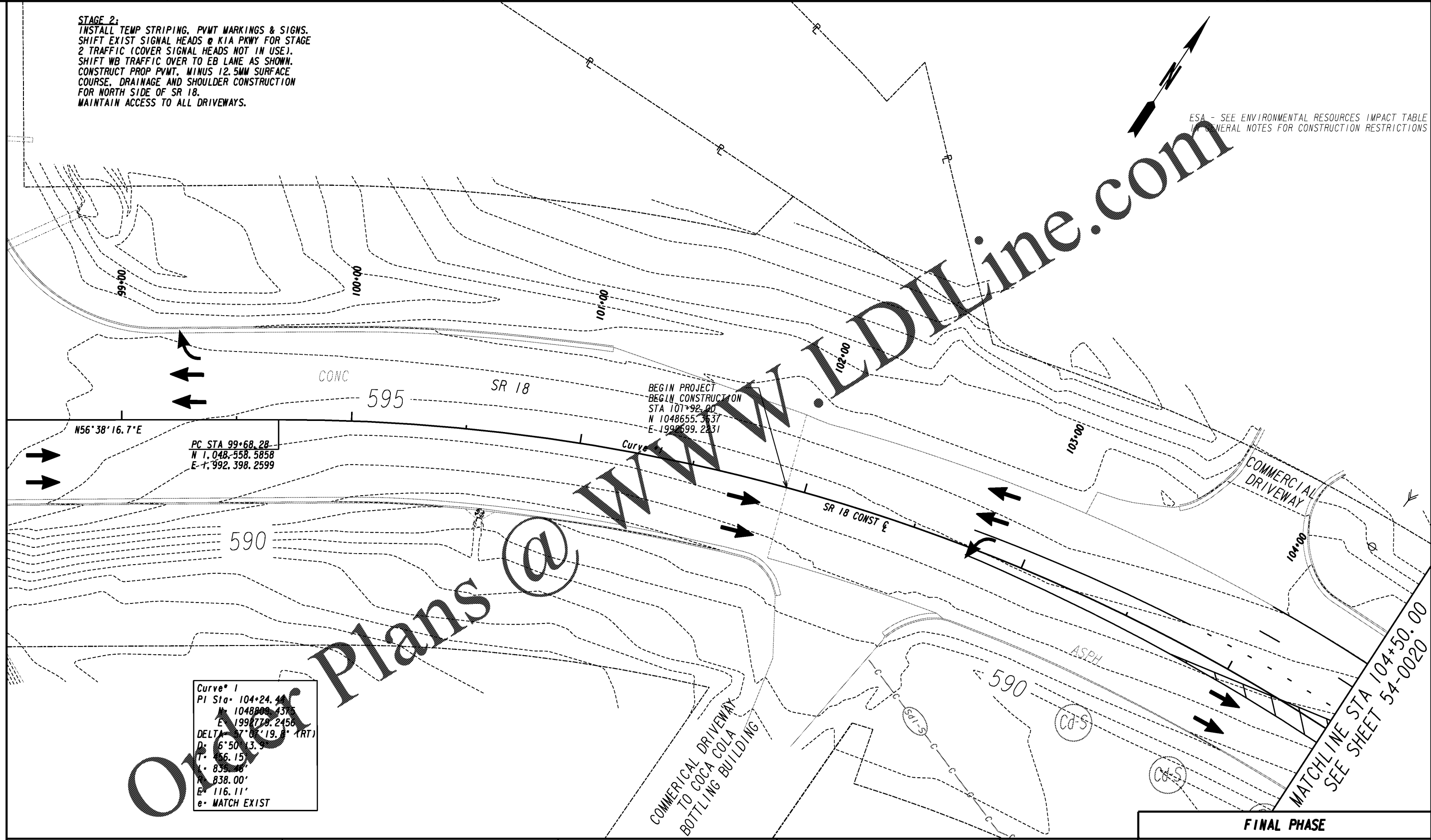

N56°38'16.7"E

PC STA 99+68.28
N 1,048,558.5858
E -1,992,398.2599

BEGIN PROJECT
BEGIN CONSTRUCTION
STA 101+92.00
N 1048655.3637
E -1998599.2231

Curve 1
PI Sta 104+24.41
N 1048800.4375
E 1998778.2458
DELTA 7°07'19.8" (RT)
D: 6°50'13.5"
L: 859.28'
R: 838.00'
E: 116.11'
e: MATCH EXIST

Plans @

PROPERTY AND EXISTING R/W LINE	-----e-----
REQUIRED R/W LINE	-----f-----
CONSTRUCTION LIMITS	-----g-----
EASEMENT FOR CONSTR	-----h-----
& MAINTENANCE OF SLOPES	-----i-----
EASEMENT FOR CONSTR OF SLOPES	-----j-----
EASEMENT FOR CONSTR OF DRIVES	-----k-----

BEGIN LIMIT OF ACCESS.....BLA	-----l-----
END LIMIT OF ACCESS.....ELA	-----m-----
LIMIT OF ACCESS	-----n-----
REQ'D R/W & LIMIT OF ACCESS	-----o-----
ORANGE BARRIER FENCE	-----p-----
ESA - ENV. SENSITIVE AREA (SEE ERIT TABLE)	-----q-----

INFRASTRUCTURE
CONSULTING & ENGINEERING
4940 PEACHTREE INDUSTRIAL BLVD., SUITE 310
NORCROSS, GEORGIA 30071



REVISION DATES	

FINAL PHASE		
BMP LOCATION DETAILS		
SR 18 BRIDGE REPLACEMENT @ LONG CAME CREEK		
TROUP COUNTY		
STAGE 2 STA 101+92.00 TO STA 104+50.00		
CHECKED:	DATE:	DRAWING No.
BACKCHECKED:	DATE:	54-0019
CORRECTED:	DATE:	
VERIFIED:	DATE:	