

ESA - SEE ENVIRONMENTAL RESOURCES IMPACT TABLE IN GENERAL NOTES FOR CONSTRUCTION RESTRICTIONS

END REQ'D R/W
BEGIN REQ'D R/W & L/A
STA 114+00.00, +13.40'LT

MATCHLINE STA 110+00.00
SEE SHEET 54-0014

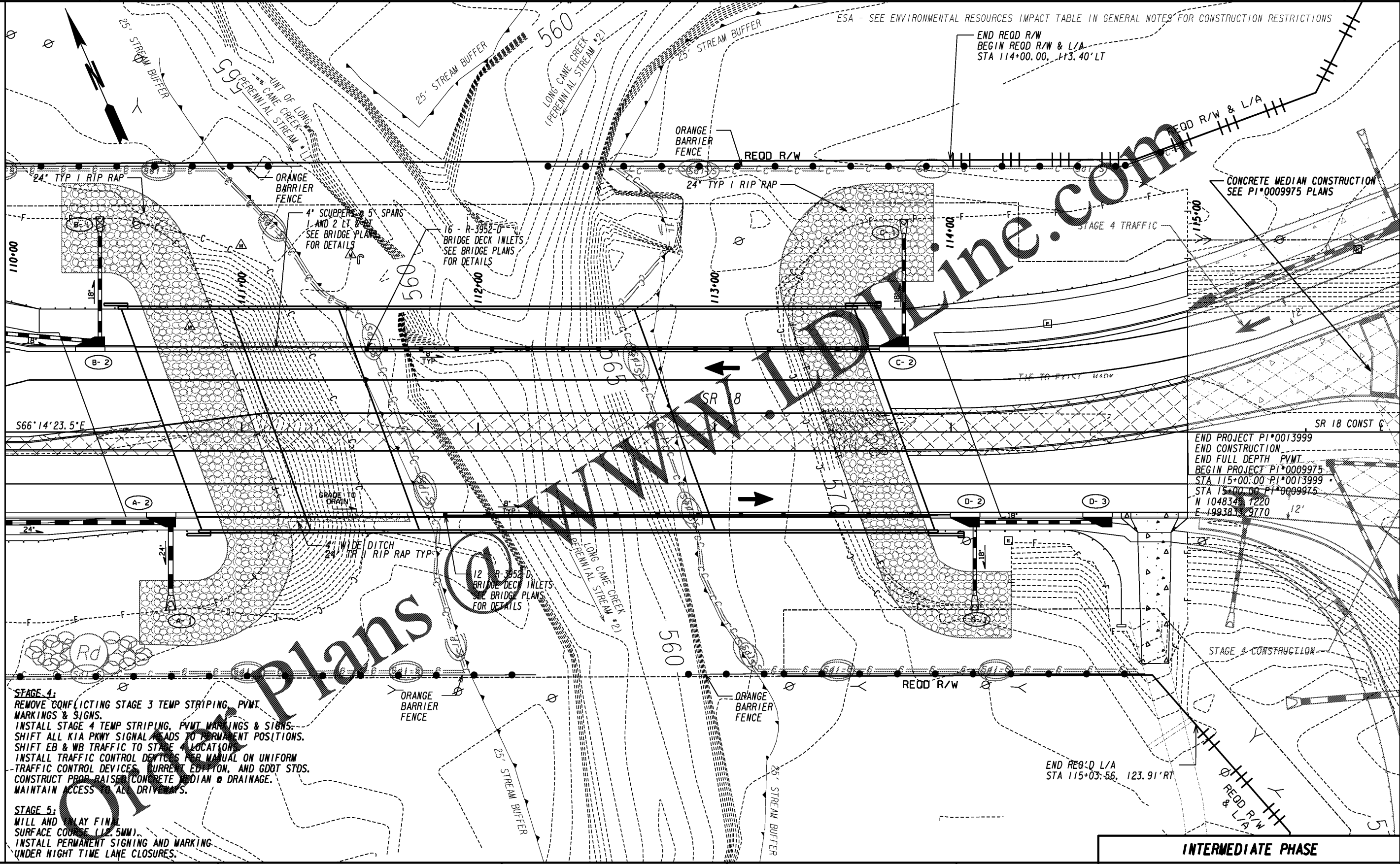

STAGE 4:
REMOVE CONFLICTING STAGE 3 TEMP STRIPING, PVMT MARKINGS & SIGNS.
INSTALL STAGE 4 TEMP STRIPING, PVMT MARKINGS & SIGNS.
SHIFT ALL KIA PKWY SIGNAL HEADS TO PERMANENT POSITIONS.
SHIFT EB & WB TRAFFIC TO STAGE 4 LOCATION.
INSTALL TRAFFIC CONTROL DEVICES PER MANUAL ON UNIFORM TRAFFIC CONTROL DEVICES, CURRENT EDITION, AND GDOT STDS.
CONSTRUCT PROP. RAISED CONCRETE MEDIAN & DRAINAGE.
MAINTAIN ACCESS TO ALL DRIVEWAYS.

STAGE 5:
MILL AND LAY FINAL SURFACE COURSE (1.25MM).
INSTALL PERMANENT SIGNING AND MARKING UNDER NIGHT TIME LANE CLOSURES.

END PROJECT PI*0013999
END CONSTRUCTION
END FULL DEPTH PVMT
BEGIN PROJECT PI*0009975
STA 115+00.00 PI*0013999
STA 15+00.00 PI*0009975
N 104834.7220
E 199383.9770

PROPERTY AND EXISTING R/W LINE	-----P-----
REQUIRED R/W LINE	-----R-----
CONSTRUCTION LIMITS	-----C-----
EASEMENT FOR CONSTR & MAINTENANCE OF SLOPES	-----F-----
EASEMENT FOR CONSTR OF SLOPES	-----S-----
EASEMENT FOR CONSTR OF DRIVES	-----D-----

BEGIN LIMIT OF ACCESS.....BLA	-----BLA-----
END LIMIT OF ACCESS.....ELA	-----ELA-----
LIMIT OF ACCESS	-----LOA-----
REQ'D R/W & LIMIT OF ACCESS	-----R/W-----
ORANGE BARRIER FENCE	-----OBF-----
ESA - ENV. SENSITIVE AREA (SEE ERIT TABLE)	-----ESA-----

INFRASTRUCTURE CONSULTING & ENGINEERING
4940 PEACHTREE INDUSTRIAL BLVD., SUITE 310
NORCROSS, GEORGIA 30071

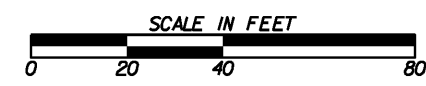

REVISION DATES	

INTERMEDIATE PHASE
BMP LOCATION DETAILS
SR 18 BRIDGE REPLACEMENT @ LONG CANE CREEK
TROUP COUNTY
STAGE 4/5 STA 110+00.00 TO STA 115+00.00

CHECKED:	DATE:	DRAWING No.
BACKCHECKED:	DATE:	54-0015
CORRECTED:	DATE:	
VERIFIED:	DATE:	