

STAGE 3:
 REMOVE STAGE 2 TEMP STRIPING, PVMT MARKINGS & SIGNS THAT DO NOT APPLY TO STAGE 3.
 INSTALL STAGE 3 TEMP STRIPING, PVMT MARKINGS & SIGNS. SHIFT EXIST SIGNAL HEADS @ KIA PKWY FOR STAGE 3 TRAFFIC (COVER SIGNAL HEADS NOT IN USE).
 SHIFT EB SR 18 TRAFFIC OVER TO WB LANE AS SHOWN. CONSTRUCT PROP PVMT, MINUS 12.5MM SURFACE COURSE, PROP DRAINAGE AND SHOULDER CONSTRUCTION FOR SOUTH SIDE OF SR 18.
 MAINTAIN ACCESS TO ALL DRIVEWAYS.

ESA - SEE ENVIRONMENTAL RESOURCES IMPACT TABLE
 GENERAL NOTES FOR CONSTRUCTION RESTRICTIONS

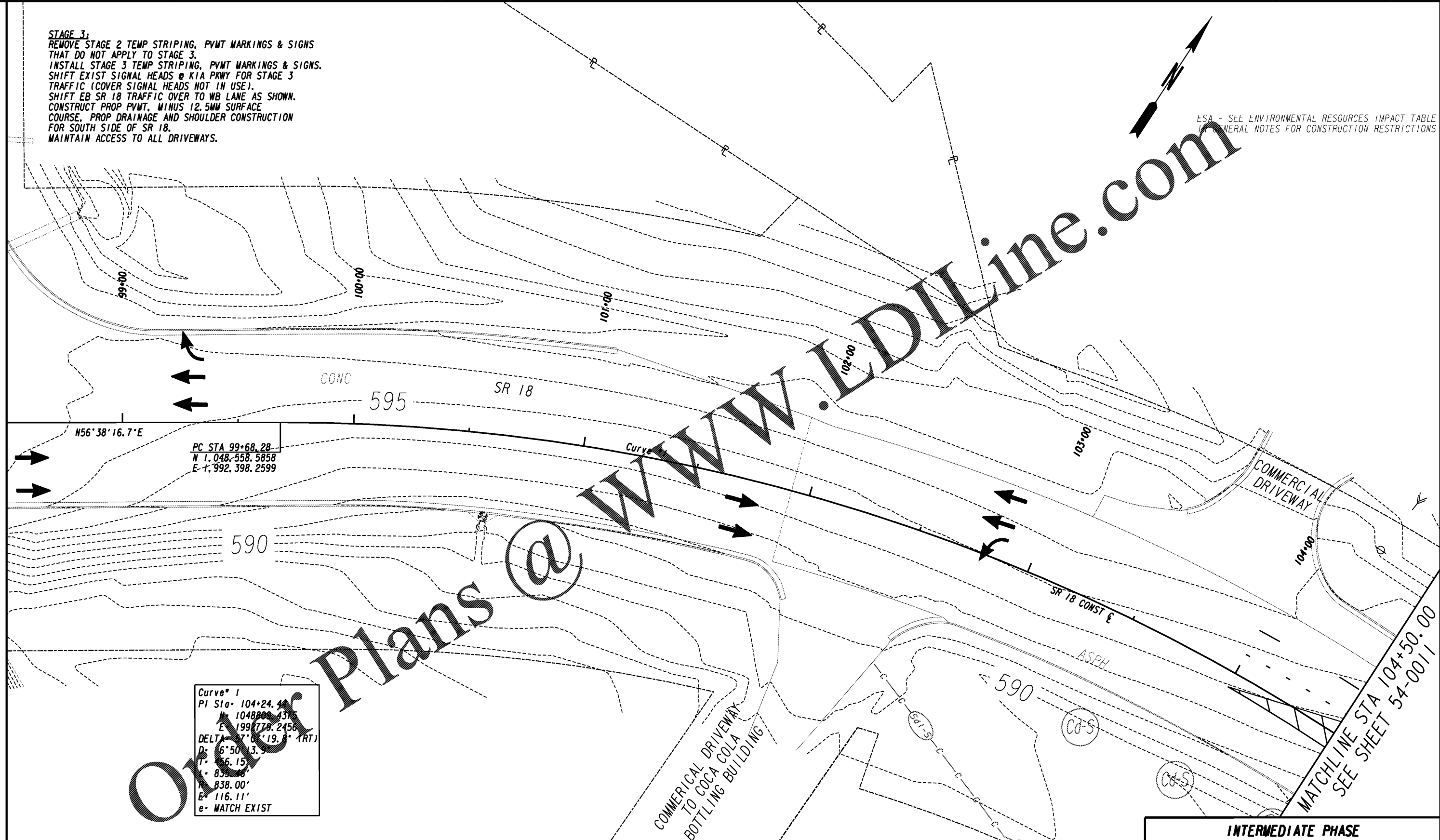

Curve 1

PI Sta	104+24.41
N	1048800.437
E	1998778.2458
DELTA	7°07'19.8" (RT)
D	6°50'13.5"
L	56.15'
e	839.28'
e	838.00'
e	116.11'
e	MATCH EXIST

PROPERTY AND EXISTING R/W LINE	-----e-----
REQUIRED R/W LINE	-----f-----
CONSTRUCTION LIMITS	-----g-----
EASEMENT FOR CONSTR & MAINTENANCE OF SLOPES	-----h-----
EASEMENT FOR CONSTR OF SLOPES	-----i-----
EASEMENT FOR CONSTR OF DRIVES	-----j-----

BEGIN LIMIT OF ACCESS.....BLA	-----k-----
END LIMIT OF ACCESS.....ELA	-----l-----
LIMIT OF ACCESS	-----m-----
REQ'D R/W & LIMIT OF ACCESS	-----n-----
ORANGE BARRIER FENCE	-----o-----
ESA - ENV. SENSITIVE AREA (SEE ERIT TABLE)	-----p-----

INFRASTRUCTURE CONSULTING & ENGINEERING
 4940 PEACHTREE INDUSTRIAL BLVD., SUITE 310
 NORCROSS, GEORGIA 30071

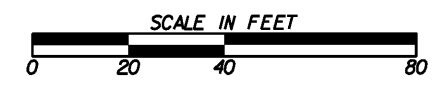

REVISION DATES	

INTERMEDIATE PHASE		
BMP LOCATION DETAILS		
SR 18 BRIDGE REPLACEMENT @ LONG CAME CREEK		
TROUP COUNTY		
STAGE 3 STA 101+92.00 TO STA 104+50.00		
CHECKED:	DATE:	DRAWING No.
BACKCHECKED:	DATE:	54-0010
CORRECTED:	DATE:	
VERIFIED:	DATE:	