

ESA - SEE ENVIRONMENTAL RESOURCES IMPACT TABLE IN GENERAL NOTES FOR CONSTRUCTION RESTRICTIONS

END REQ'D R/W
BEGIN REQ'D R/W & L/A
STA 114+00.00, +13.40' LT

PERMANENT CONSTRUCTION
SEE PI*0009975 PLANS

Ds1 Ds2

Ds1 Ds2

MATCHLINE STA 110+00.00
SEE SHEET 54-0008

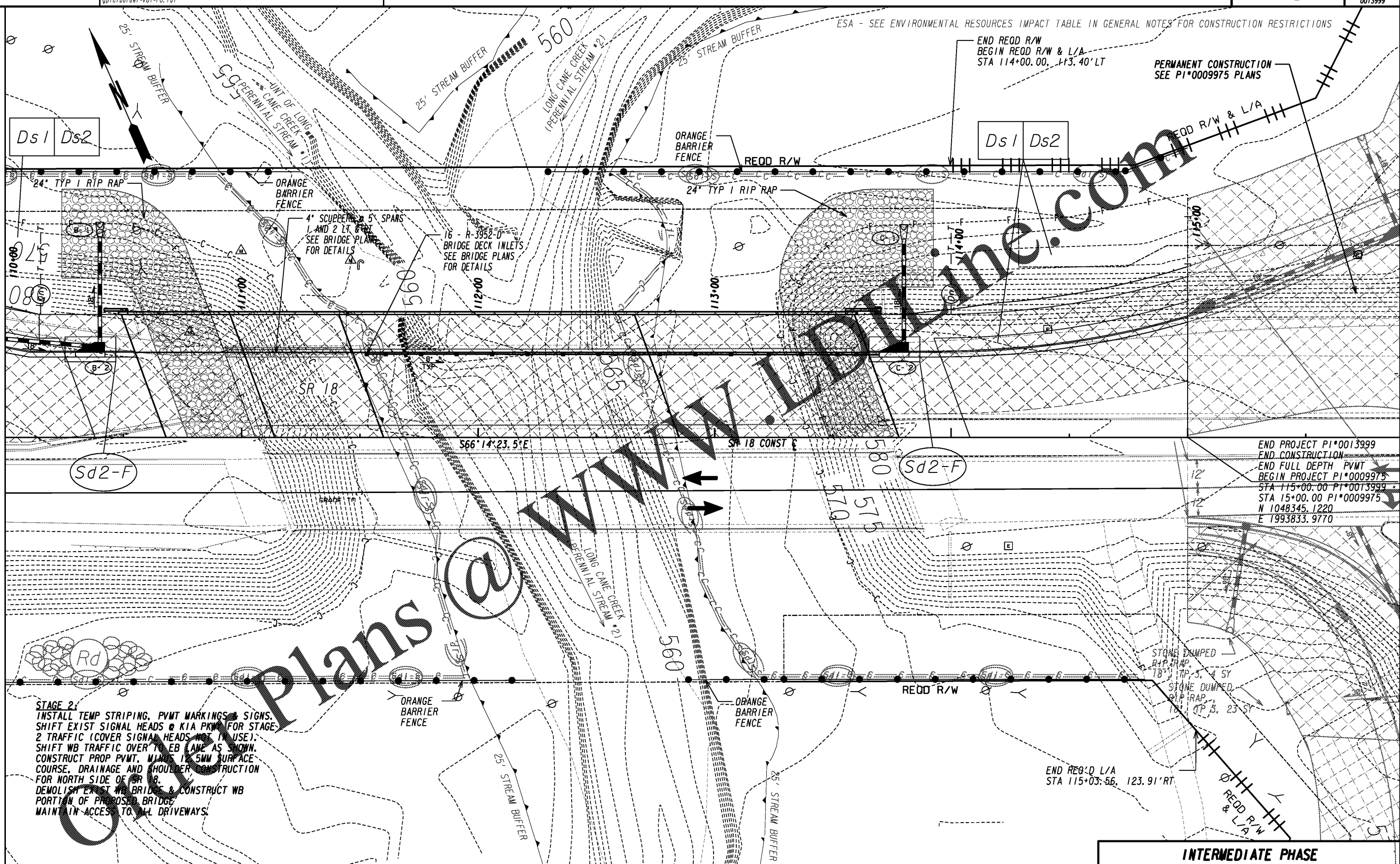

4" SCUPPERS & 5" SPANS
1 AND 2 LT 8 FT
SEE BRIDGE PLANS
FOR DETAILS

16 - R-3952-D
BRIDGE DECK INLETS
SEE BRIDGE PLANS
FOR DETAILS

END PROJECT PI*0013999
END CONSTRUCTION
END FULL DEPTH PVMT
BEGIN PROJECT PI*0009975
STA 115+00.00 PI*0013999
STA 15+00.00 PI*0009975
N 1048345.1220
E 1993833.9770

STAGE 2:
INSTALL TEMP STRIPING, PVMT MARKINGS & SIGNS.
SHIFT EXIST SIGNAL HEADS @ KIA PKWY FOR STAGE
2 TRAFFIC (COVER SIGNAL HEADS NOT IN USE).
SHIFT WB TRAFFIC OVER TO EB LANE AS SHOWN.
CONSTRUCT PROP PVMT, MAIN 1.5 MM SURFACE
COURSE, DRAINAGE AND SHOULDER CONSTRUCTION
FOR NORTH SIDE OF SR 18.
DEMOLISH EXIST WB BRIDGE & CONSTRUCT WB
PORTION OF PROPOSED BRIDGE.
MAINTAIN ACCESS TO ALL DRIVEWAYS.

PROPERTY AND EXISTING R/W LINE
REQUIRED R/W LINE
CONSTRUCTION LIMITS
EASEMENT FOR CONSTR
& MAINTENANCE OF SLOPES
EASEMENT FOR CONSTR OF SLOPES
EASEMENT FOR CONSTR OF DRIVES

-----e-----
BEGIN LIMIT OF ACCESS.....BLA
END LIMIT OF ACCESS.....ELA
LIMIT OF ACCESS
REQ'D R/W & LIMIT OF ACCESS
ORANGE BARRIER FENCE
ESA - ENV. SENSITIVE AREA
(SEE ERIT TABLE)

INFRASTRUCTURE
CONSULTING & ENGINEERING
4940 PEACHTREE INDUSTRIAL BLVD., SUITE 310
NORCROSS, GEORGIA 30071

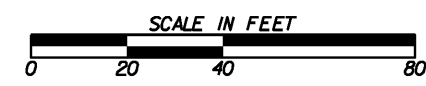

REVISION DATES	

INTERMEDIATE PHASE

BMP LOCATION DETAILS
SR 18 BRIDGE REPLACEMENT @ LONG CANE CREEK
TROUP COUNTY
STAGE 2 STA 110+00.00 TO STA 115+00.00

CHECKED:	DATE:	DRAWING No.
BACKCHECKED:	DATE:	54-0009
CORRECTED:	DATE:	
VERIFIED:	DATE:	